

# WMFB SERIES™ FLOOR BOXES

## WMFB Series Floor Boxes Ordering Information (continued)

### WMFB1SRKS1B Single-Gang Floor Box Assembly

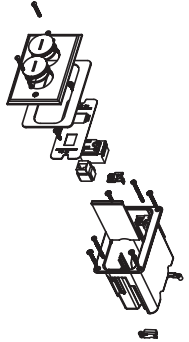

Includes single-gang box, divider, one 15A, 125V receptacle, one opening for communication device, and brass cover with two screw plugs. For hole cut dimensions, see installation instructions sheet.

**Box Dimensions:**  
2 1/8" W x 3 3/4" L x 3 7/8" D  
[54mm W x 95mm L x 98mm D]  
**Device Plate:**  
3 1/8" W x 4 15/16" L  
[79mm W x 125mm L]

### WMFB1SRB Single-Gang Floor Box Assembly

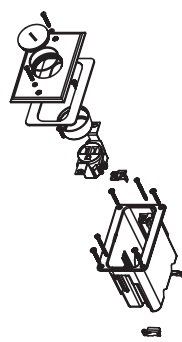

Includes single-gang box, one 15A tamper-resistant receptacle, and brass cover with one screw plug. For hole cut dimensions, see installation instructions sheet.

**Box Dimensions:**  
2 1/8" W x 3 3/4" L x 3 7/8" D  
[54mm W x 95mm L x 98mm D]  
**Device Plate:**  
3 1/8" W x 4 15/16" L  
[79mm W x 125mm L]

### WMFB1SRKS1N Single-Gang Floor Box Assembly

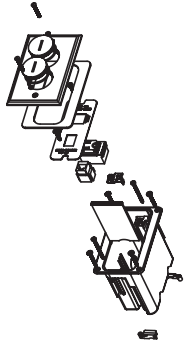

Includes single-gang box, divider, one 15A, 125V receptacle, one opening for communication device, and nickel cover with two screw plugs. For hole cut dimensions, see installation instructions sheet.

**Box Dimensions:**  
2 1/8" W x 3 3/4" L x 3 7/8" D  
[54mm W x 95mm L x 98mm D]  
**Device Plate:**  
3 1/8" W x 4 15/16" L  
[79mm W x 125mm L]

### WMFB1SRN Single-Gang Floor Box Assembly

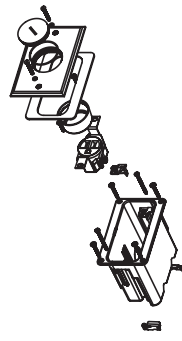

Includes single-gang box, one 15A tamper-resistant receptacle, and nickel cover with one screw plug. For hole cut dimensions, see installation instructions sheet.

**Box Dimensions:**  
2 1/8" W x 3 3/4" L x 3 7/8" D  
[54mm W x 95mm L x 98mm D]  
**Device Plate:**  
3 1/8" W x 4 15/16" L  
[79mm W x 125mm L]

### WMFB1DRB Single-Gang Floor Box Assembly

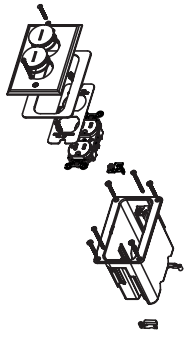

Includes single-gang box, one 15A, 125V tamper-resistant receptacle, and brass cover with two screw plugs. For hole cut dimensions, see installation instructions sheet.

**Box Dimensions:**  
2 1/8" W x 3 3/4" L x 3 7/8" D  
[54mm W x 95mm L x 98mm D]  
**Device Plate:**  
3 1/8" W x 4 15/16" L  
[79mm W x 125mm L]

### WMFB2DR2B Dual-Gang Floor Box Assembly

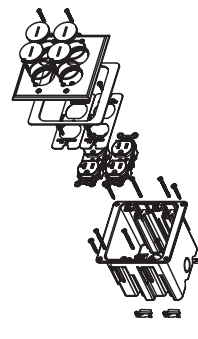

Includes dual-gang box, two 15A tamper-resistant duplex receptacles, and brass cover with four screw plugs. For hole cut dimensions, see installation instructions sheet.

**Box Dimensions:**  
3 1/4" W x 3 3/4" L x 3 7/8" D  
[83mm W x 95mm L x 98mm D]  
**Device Plate:**  
4 7/8" W x 5 1/16" L  
[124mm W x 129mm L]

### WMFB1DRN Single-Gang Floor Box Assembly

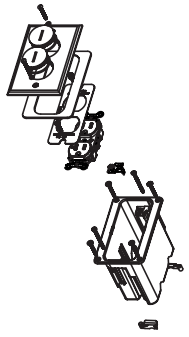

Includes single-gang box, one 15A, 125V tamper-resistant duplex receptacle, and nickel cover with two screw plugs. For hole cut dimensions, see installation instructions sheet.

**Box Dimensions:**  
2 1/8" W x 3 3/4" L x 3 7/8" D  
[54mm W x 95mm L x 98mm D]  
**Device Plate:**  
3 1/8" W x 4 15/16" L  
[79mm W x 125mm L]

### WMFB2DR2N Dual-Gang Floor Box Assembly

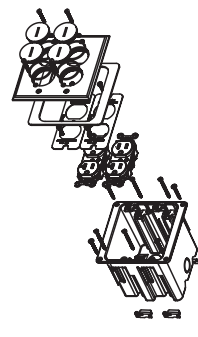

Includes dual-gang box, two 15A tamper-resistant duplex receptacles, and nickel cover with four screw plugs. For hole cut dimensions, see installation instructions sheet.

**Box Dimensions:**  
3 1/4" W x 3 3/4" L x 3 7/8" D  
[83mm W x 95mm L x 98mm D]  
**Device Plate:**  
4 7/8" W x 5 1/16" L  
[124mm W x 129mm L]