

CSA Certifications:
Class I, Div. 1 and 2
Groups B,C,D
Class II, Div. 1 and 2
Groups F*,G
Class III
NEMA 3,3R,7BCD,9F*G

20 Amp U-Line® ECCL Factory Sealed Cable Connectors

Dead-Front Safety Construction—Grounding thru Extra Pole and Shell.
 Choice of Aluminum or Thermoplastic Polyester Plug.

U.S. Pat. 4,391,480
 Patented Canada 1985

U.S. Pat. 3,346,709
 Patented Canada 1968



20 Amp Cable Connectors
 125VAC, 20A, 1 HP; 250VAC, 20A, 2HP



With Spring Cover	2W,3P	.538 to .639	ECCL2023	ECCL20232
Without Spring Cover	2W,3P	.538 to .639	ECC2023	ECC20232
Screw Cover Kit*			ULINEREC4XKIT	

Plugs for use with above Cable Connectors

These watertight plugs also fit NEMA 5-15R, 5-20R or 6-20R receptacles in nonclassified areas.



**Interchanger™
 ECP Plug
 (aluminum)**



**NCP Plug
 (Thermoplastic Polyester)**

Amps	Diagram	Wire/ Pole	Cable Dia., Inches	Cat. No. ECP Plug (Model D)		Cat. No. NCP Plug	
				125V	250V	125V	250V
15		2W,3P	.538 to .639	ECP-1523	—	NCP-1523	—
20		2W,3P	.538 to .639	ECP-2023	—	NCP-2023	—
20		2W,3P	.538 to .639	—	ECP-20232	—	NCP-20232

Applications

• For making up adapter sets for connecting portable devices having ECP U-Line Plugs to existing receptacles in non-hazardous areas. Completed adapter set consists of ECCL (or ECC), short flexible cord and plug to fit existing receptacle.

Features

- When plug is withdrawn, ECCL gasketed spring cover snaps shut to protect against moisture and combustible dust. With plug in use, gasket in receptacle throat “seals” around plug for protection against environment.
- Interior switch cylinder has neoprene O-ring at each end to seal out combustible dust and moisture.

- Cable clamp provides positive grip on cable. Furnished with 2 bushings to accommodate various cable sizes.
- Copper-free aluminum housing (4/10ths of 1% max. copper content).
- Epoxy powder coat.

Dimensions of U-Line Cable Connectors and Panel Mounting Receptacles

ECCL Dimensions

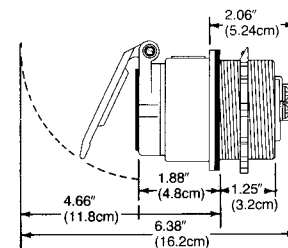
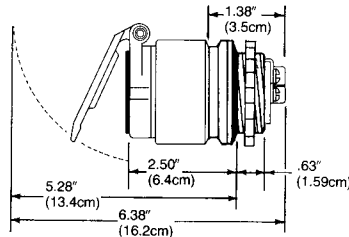
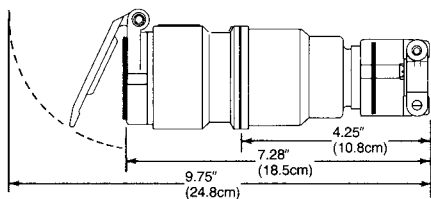

ECCL, ECH and ECHT Dimensions

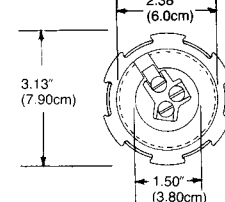
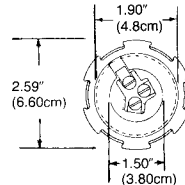
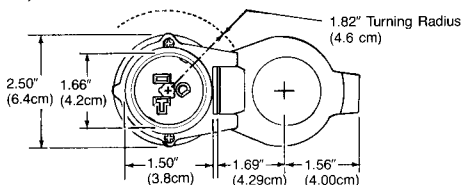

• NEMA Type 4X when screw cover kit is used and screw cover is fully engaged.

* Do not use where electrically conductive dusts are present (most coal dusts are *not* electrically conductive).

Effective June, 2008
 Copyright 2008



800-621-1506
 www.appletonelec.com