

Refrigeration Wrenches

Ratcheting Refrigeration Wrenches

- Fully reversible ratchet wrenches designed for refrigeration packing gland nuts and valve stem sockets.
- Also designed for beam-clamp installation.
- Wrenches are compact in size, with clearly marked sockets for four nut sizes.
- Quick-flip reversing lever permits instant ratchet reversal.
- Wrenches are ruggedly built and have polished chrome finish with smooth edges for comfort.



68310

Cat. No.	Socket Sizes	Length	Weight (lbs.)
68309	3/16" and 1/4" sq. x 1/2" and 9/16" hex	6-13/16" (173 mm)	.43
68310	3/16" and 5/16" sq. x 1/4" and 3/8" sq.	5-1/2" (140 mm)	.20
68310-24	24 pack of Cat. No. 68310	5-1/2" (140 mm)	4.70

Nylon Tie Tensioning Tools

Nylon Tie Tensioning Tools

NEW!

- Tensions up to 65 lbs. of force (30 kg).
- Maximum tie width of 15/32" (12 mm).
- Handle grips for comfort.
- Excess tie material is automatically cut off (Cat. No. 86571 only).



86571



86570

Cat. No.	Description	Weight (lbs.)
86570	nylon tie tensioning tool – manual	0.87
86571	nylon tie tensioning tool – automatic	1.01

Special-Purpose Knives

Serrated Duct Knife

NEW!

- Cuts duct board and flexible duct.
- Double-edged knife – regular and serrated.
- Cushion-grip handle for comfort.
- Includes puncture resistant nylon sheath with belt loop.



DK06



Cat. No.	Description	Weight (lbs.)
DK06	serrated stainless steel duct knife	0.53

Specialty Screwdrivers

11-in-1 Screwdriver/Nut Driver with Schrader® Valve Removal/Installation Bit

Additional Features:

- Versatile 11-in-1 tool for the professional.
- Includes unique style bit for installation/removal of common TR-4 Schrader® valves and aggressive thread extractor tip for backing out broken cores.
- Great for HVAC and other industrial applications.
- Cushion-grip handle for greater torque and comfort.
- Blast finish bit tips provide a firm hold and reduce cam out.



32527



NEW!

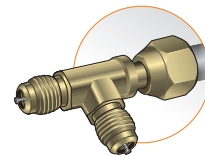

Cat. No.	Contains	Weight (lbs.)
32527	3/8", 5/16" and 1/4" nut drivers, #1 and #2 Phillips, #1 square and #2 square, 1/4" and 3/16" slotted, Schrader® valve core removal/installation – extractor	.44

All dimensions are in inches and (millimeters).

⚠WARNING: Always wear approved eye protection.

