

# STRAIGHT BLADE RECEPTACLES

Power Outlet Receptacles & Plugs 20, 30, 50, & 60A

RATING		RECEPTACLE/PLUG CONFIGURATION & NEMA NO.						
A.	V.		FLUSH RECEPTACLE	WALL PLATE <small>*For 2 screw mounting **For 4 screw mounting</small>	SURFACE RECEPTACLE	PLUG	ANGLE PLUG	CONNECTOR
			CATALOG NUMBERS					
<b>2 POLE, 3 WIRE GROUNDING</b>								
30	125	5-30		<b>3802</b> § AL/CU	1-Gang: <b>TP724*</b> 2-Gang: <b>SS702*</b> 2-Gang: <b>TP703**</b>		<b>D0531</b> .57"-1.26"	<b>D0533</b> .57"-1.26"
30	125	NEMA TT30		<b>3830</b> AL/CU	1-Gang: <b>TP724*</b> 2-Gang: <b>SS702*</b> 2-Gang: <b>TP703**</b>			
For recreational vehicles.								
30	250	6-30		<b>3801</b> AL/CU	1-Gang: <b>TP724*</b> 2-Gang: <b>SS702*</b> 2-Gang: <b>TP703**</b>		<b>D0631</b> .57"-1.26"	<b>3869</b>  <b>D0633</b> .57"-1.26"
50	125	5-50					<b>D0551</b> .57"-1.26"	<b>D0553</b> .57"-1.26"
50	250	6-50		<b>3804</b> § AL/CU	1-Gang: <b>TP724*</b> 2-Gang: <b>SS702*</b> 2-Gang: <b>TP703**</b>	<b>3852</b> # AL/CU	<b>D0651</b> .57"-1.26"	<b>3869</b>  <b>D0653</b> .57"-1.26"
<b>3 POLE, 3 WIRE NON-GROUNDING</b>								
30	125/250 Dryer	10-30		<b>3860</b> AL/CU	1-Gang: <b>TP724*</b> 2-Gang: <b>SS702*</b> 2-Gang: <b>TP703**</b>	<b>388</b> AL/CU	<b>1031</b>	<b>3861</b>
50	125/250 Range	10-50		<b>3890</b> § AL/CU	1-Gang: <b>TP724*</b> 2-Gang: <b>SS702*</b> 2-Gang: <b>TP703**</b>	<b>385</b> AL/CU	<b>1051</b> .57"-1.26"	<b>3861</b>  <b>1053</b> .32"-0.91"
<b>3 POLE, 4 WIRE GROUNDING</b>								
20	125/250	14-20		<b>3820</b>	1-Gang: <b>SS7*</b>			
30	125/250 Dryer	14-30		<b>3864</b> AL/CU <b>3864NA</b> †	2-Gang: <b>SS702*</b> 2-Gang: <b>TP703**</b>	<b>3884</b> #/388440‡ AL/CU	<b>1431</b> .57"-1.26"	<b>5746AN</b> <b>3867</b>
30	3ø, 250	15-30		<b>5740</b> AL/CU	2-Gang: <b>SS702*</b> 2-Gang: <b>TP703**</b>			<b>5741AN</b>
50	125/250 Range	14-50		<b>3894</b> § AL/CU <b>3894NA</b> †	2-Gang: <b>SS702*</b> 2-Gang: <b>TP703**</b>	<b>3854</b> #/385440‡ AL/CU	<b>1451</b> .57"-1.26"	<b>5745AN</b> <b>3867</b>
50	3ø, 250	15-50		<b>5750</b> AL/CU	2-Gang: <b>SS702*</b> 2-Gang: <b>TP703**</b>			<b>5751AN</b>
60	3ø, 250	15-60		<b>5760</b> AL/CU	2-Gang: <b>SS702*</b> 2-Gang: <b>TP703**</b>		<b>8462N</b>	<b>5761AN</b>
<b>4 POLE, 4 WIRE NON-GROUNDING</b>								
20	3øY, 120/208	18-20		<b>3822</b>	1-Gang: <b>SS7*</b>		<b>7251DF</b> .35"-1.05"	
60	3øY, 120/208	18-60		<b>3870</b> § AL/CU	2-Gang: <b>SS701**</b>		<b>D1861</b> .57"-1.26"	<b>8302AN</b>

‡ In bulk pack of 40 with plastic snap-in wire clamp.

§ Up to #3 AWG aluminum conductors.

# Up to #4 AWG aluminum conductors.

For further information consult Wall Plate Section P (for Stainless Steel versions of TP724 and TP703, refer to Pages P-14 and P-15).

† NAFTA-Compliant Receptacles are ideal for use on projects subject to the provisions of the Buy American Act.

All devices listed on this page conform to NEMA WD-1 and WD-6.

STRAIGHT BLADE RECEPTACLES

# STRAIGHT BLADE RECEPTACLES

Power Outlet Receptacles & Plugs 20, 30, 50, & 60A

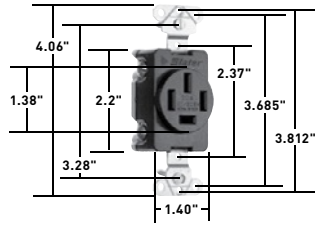

**3822**

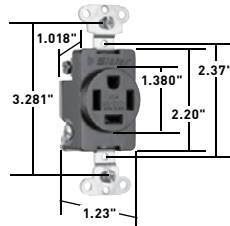

**3820**



**385 3854  
388 3884  
3852**

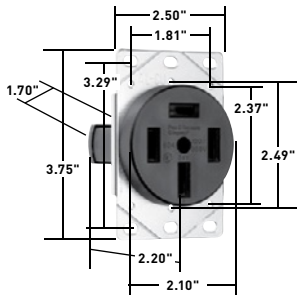

**3870**

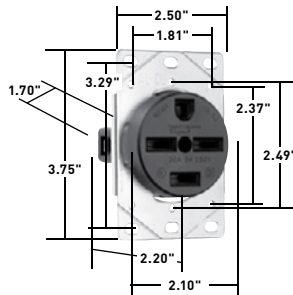

**3801 3802  
3804 3864  
3894 5740  
5750 5760**

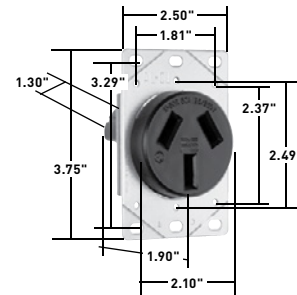

**3830  
3860  
3890**

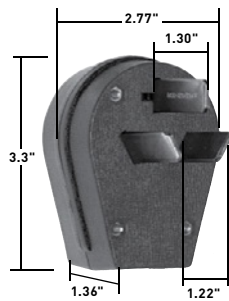

**3861**

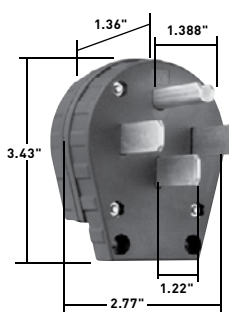

**3867**

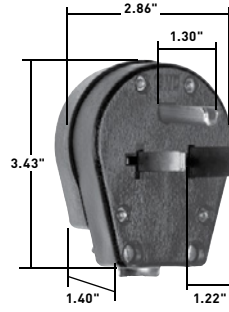

**3869**

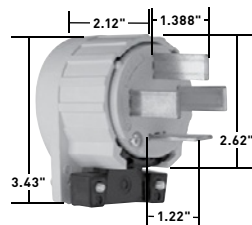

**5741AN 5751AN  
5745AN 5761AN  
5746AN 8302AN**

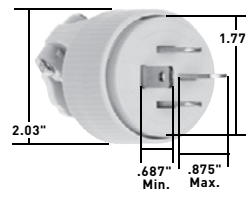

**7251DF**

STRAIGHT BLADE RECEPTACLES

# STRAIGHT BLADE RECEPTACLES

Power Outlet Receptacles & Plugs 20, 30, 50 & 60A



Flush Receptacle



Surface Receptacle



Angle Plug



Plug



Wall Plate

## Application

Power devices are for use in industrial, institutional, commercial, and certain residential applications to provide higher amperage power to equipment such as air conditioners, copiers, small welders, ranges, and dryers.

## Features

- Flush receptacle bodies are molded of arc-resistant plastic.
- All devices are of dead front design.
- Receptacles have double-wipe contacts of high performance copper-based alloy.
- Recommended stainless steel wall plates are listed with each flush receptacle.
- UL Listed for use with aluminum wiring.

RECEPTACLE AMP. RATING	AWG SIZE	MATERIAL
<b>CONDUCTOR SIZE &amp; MATERIAL FOR POWER OUTLET RECEPTACLES</b>		
20A	#14 – #10	Copper/Copper-clad
30A	#10 – #6	Copper/Copper-clad/Aluminum
50A	#10 – #6	Copper/Copper-clad/Aluminum
60A	#8 – #4	Copper/Copper-clad/Aluminum

AMPERE RATING	WITH NON-METALLIC SHEATHED CABLE	WITH CONDUIT
<b>RECOMMENDED BOX SIZES FOR FLUSH RECEPTACLES</b>		
30A	4" sq. x 2-1/8" deep	4-11/16" sq. x 2-1/8" deep
50A	4-11/16" sq. x 2-1/8" deep	2-g deep box [4" sq. x 2-1/2" deep]
60A	4-11/16" sq. x 2-1/8" deep with 1/2" raised ring	2-g deep box [4" sq. x 2-1/2" deep]

DESCRIPTION	COLOR	NYLON	METAL		WALL PLATES RECOMMENDED FOR THE FOLLOWING FLUSH RECEPTACLES	
		TRADEMASTER®	MATERIAL			
<b>ACCESSORIES – FLUSH RECEPTACLE WALL PLATES</b>						
<ul style="list-style-type: none"> <li>• 2.156" hole for 2.125" dia. device</li> <li>• 2 mtg. holes</li> </ul>	Ivory	TP724I			2 Pole, 3 Wire Grounded	
	White	TP724W			3801	3804
	Brown	TP724	Chrome	S384C	3802	3830
	Gray	TP724GRY				
	Black	TP724BK				
<ul style="list-style-type: none"> <li>• 2-5/32" hole for 2-1/8" dia. device</li> <li>• 2 mtg. holes</li> </ul>	Light Almond	TP724LA	302S/S	SS724	3 Pole, 3 Wire Ungrounded	
					3860	3860
<ul style="list-style-type: none"> <li>• 2.1563" hole for 2.125" dia. device</li> <li>• 4 mtg. holes</li> </ul>	Ivory	TP703I			3 Pole, 4 Wire Ungrounded	
	White	TP703W	Chrome	S3862C	3864	5740
	Brown	TP703	302S/S	SS703	3894	5750
	Gray	TP703GRY				5760
	Black	TP703BK				
Light Almond	TP703LA					

New Installations require 4 wire range and dryer outlets. Ref: 2002 NEC 250-134, 250-138  
 Existing Installations permitted to use 3 wire range and dryer outlets. Ref: 2002 NEC 250-140

# DEVICES & WALL PLATES

## Color Selection Chart

### Devices & Plastic Wall Plate Colors



Ivory    Light Almond    White    Green    Antique Brass    Dark Bronze    Nickel



Black    Blue    Brown    Gray    Orange    Red

See specific device and wall plate catalog charts for particular color availabilities.

### Metal Wall Plates

Metal Finish



Aluminum    Brass (Brushed)    Polished Brass    Stainless Steel    Brushed Bronze    Chrome

### Custom Metal Wall Plates Paint Finish Colors

Paint Color



Orange    Green    Gray    Yellow    Glossy Black    Brown    White



Primer    Red    Pink    Flat Black    Ivory    Light Almond    Blue

To order custom metal wall plates, see Pages P-40 – P-44.

**For additional colors consult factory.**