

## 8" Mounting Block



With built-in box for fan and fixture installations.

### FEATURES AND BENEFITS

- Ceiling medallion and electrical box combined
- Supports flood lights, smoke detectors, fans, light fixtures -any fixture needing a safe, strong installation.
- UV rated plastic
- For interior or exterior use
- Mounts directly to soffit or ceiling joist without the need to cut ceiling drywall
- Paintable
- UL rated: 70 lb fan, 200 lb fixture; CSA rated: 50 lb fan/fixture

CATALOG NUMBER	UPC/DCI/NAED MFG #018997	DESCRIPTION / CU. IN.	UNIT PKG	STD PKG	DIM A	DIM B	DIM C
MB8	42330	Flat Mount / 6.1 Cu. In.	1	10	8.000	3.792	.740

Refer to chart on page R-22 for load ratings and number of single conductors.

### PATENTED.

Note: Install fan or fixture (not included) in accordance with manufacturer's instructions and all local applicable electrical codes, using the parked screws provided.

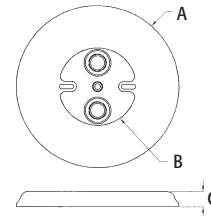

### MB8 INCLUDES...

Two #10 x 3" wood screws, one #8 x 1-1/2" wood screw, two KOs, and one NM94 non-metallic cable connector.

### INSTALLATION INSTRUCTIONS

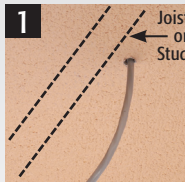

1 Locate the ceiling joist using a stud finder or similar device. Drill a hole approximately 1/2" in diameter, in the ceiling next to the joist. Remove desired knockout. Insert the cable connector into the opening. Pull the NM cable through the connector.



2 Using the #8 x 1-1/2" wood screws provided, mount the MB8 to the joist (through the ceiling).



3 Install the fixture or fan mounting bar (provided with the fixture or fan) directly to the joist with the (2) #10 x 3" wood screws and lock washers provided. Wire the fixture or fan following the instructions included with the product.