

MATERIAL: ALUMINUM
FINISH: TIN PLATING

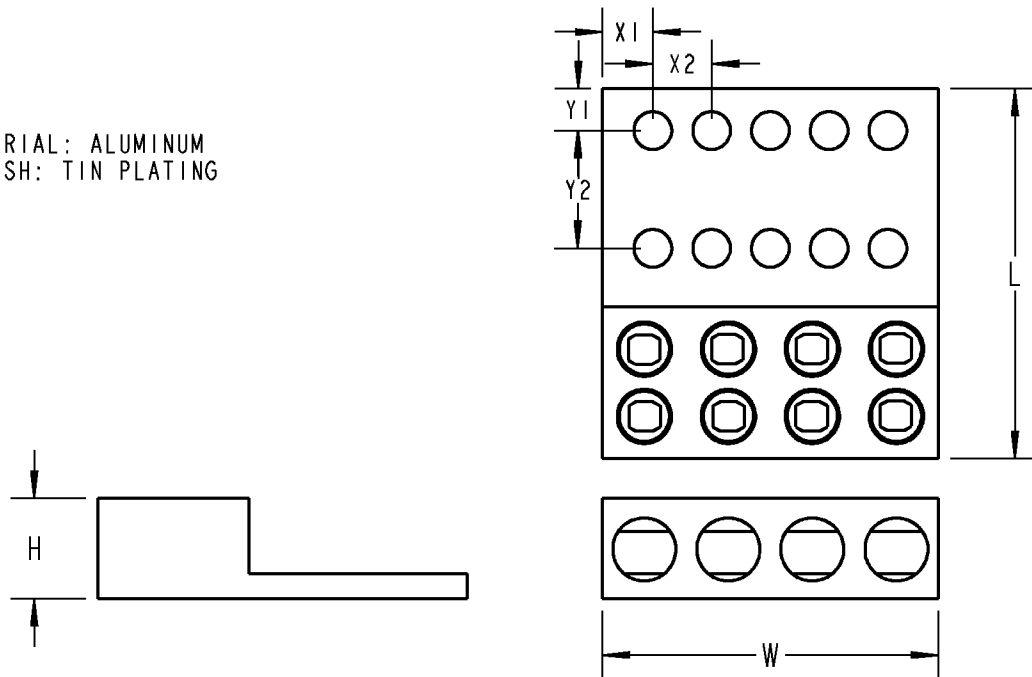

Cat No.	L	W	H	X1	X2	Y1	Y2	RANGE	Screws #	Holes #
ADR60-44D	5.5	5	1.5	.75	.875	.625	1.75	600 Kcmil to 2 awg	8	10
ADR60-32D	5.5	3.5	1.5	.875	.875	.625	1.75	600 Kcmil to 2 awg	6	6
ADR60-34D	5.5	3.5	1.5	.875	.875	.625	1.75	600 Kcmil to 2 awg	6	6
ADR60-22D	5.5	2.75	1.5	.5	.875	.625	1.75	600 Kcmil to 2 awg	4	6
ADR60-12D	5.5	1.375	1.5	.687	N/A	.625	1.75	600 Kcmil to 2 awg	2	2
ADR80-44D	5.97	6	1.813	2.125	1.75	.625	1.75	800 Kcmil to 300 awg	8	4
ADR80-34	5.97	4.125	1.813	1.188	.875	.625	1.75	800 Kcmil to 300 awg	6	6
ADR80-32	5.97	4.125	1.813	1.188	.875	.625	1.75	800 Kcmil to 300 awg	6	6
ADR80-22D	5.97	3	1.813	.625	.875	.625	1.75	800 Kcmil to 300 awg	4	6
ADR80-12D	5.97	1.5	1.813	.75	N/A	.625	1.75	800 Kcmil to 300 awg	2	2
ADR99-34	5.97	4.875	1.813	1.563	.875	.625	1.75	1000 Kmil to 350 Kcmil	6	6
ADR99-32	5.97	4.875	1.813	1.563	.875	.625	1.75	1000 Kmil to 350 Kcmil	6	6
ADR99-22D	5.97	3.25	1.813	.75	.875	.625	1.75	1000 Kmil to 350 Kcmil	4	6
ADR99-12D	5.97	1.625	1.813	.813	N/A	.625	1.75	1000 Kmil to 350 Kcmil	2	2

GENERAL NOTES

- ALL DIMENSIONS ARE FOR REFERENCE ONLY.
- DIMENSIONS IN BRACKETS [] ARE IN METRIC UNITS.

REVISIONS

- | | |
|---|--|
| 1 | SEE ERN (2009363) FOR APPROVAL SIGNATURES & RELEASE DATE. 02/13/08
PROJECT NO: BM400690 |
|---|--|

Thomas & Betts
www.tnb.com

DESCRIPTION:

**POWER CONNECTOR
AI LUG ADR FAMILY**

ORIGINAL PROJECT NO / (ERN NO)
BM400690 / (ERN NO:2009258)

SHEET NO:
1 OF 1

REV. NO:
1

DRAWING NO:
WSD-000390