

CATALOG NUMBERS:
P 60 3/4 2 CACP, P60 34-2CACP-AL

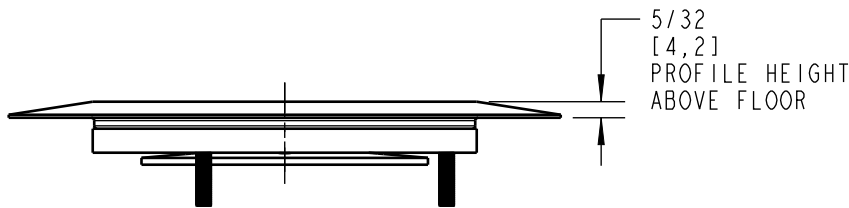
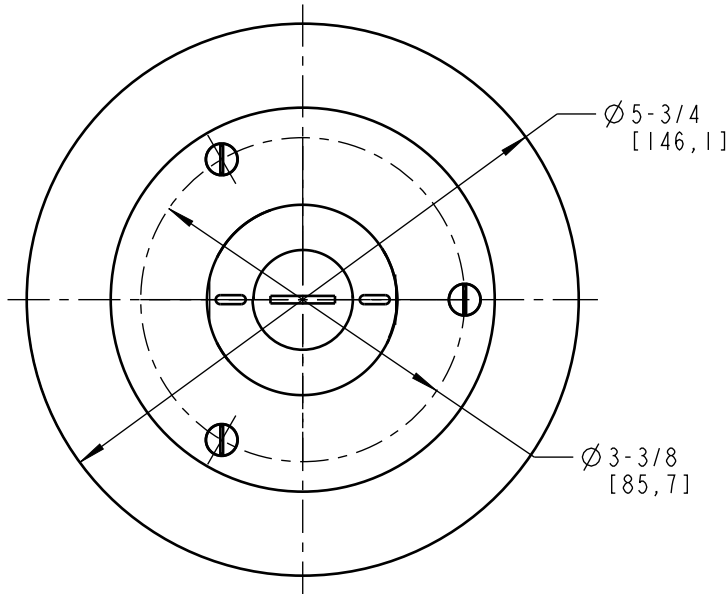
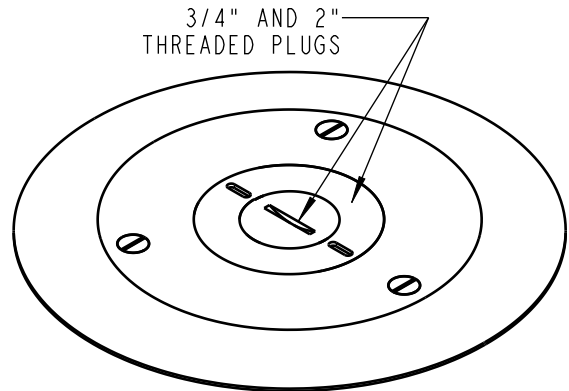

FEATURES:

1. FOR USE WITH 68P, 68 AND 600 SERIES FLOOR BOXES
3. FURNISHED COMPLETE WITH SEALING GASKET, AND 8-32 X 1 IN. MATCHING SCREWS
4. MOP TIGHT COVER, MEETS UL SCRUBWATER REQUIREMENTS FOR CARPET, TILE, AND WOOD FLOORS

CATALOG NUMBERS	MATERIAL	FINISH
P 60 3/4 2 CACP	SOLID BRASS	BRASS
P60 34-2CACP-AL	ALUMINUM	ALUMINUM

GENERAL NOTES

1. ALL DIMENSIONS ARE FOR REFERENCE ONLY.
2. DIMENSIONS IN BRACKETS [] ARE IN METRIC UNITS.

REVISIONS

A SEE ECN (****) FOR APPROVAL SIGNATURES & RELEASE DATE. PROJECT NO****

www.tnb.com

DESCRIPTION:

**CARPET PLATE, ROUND
 WITH 3/4 IN. AND 2 IN. PLUGS**

Thomas & Betts
 A Member of the ABB Group

ORIGINAL PROJECT NO / ECN NO

003V001056 / ECN000083908

SHEET NO:

1 OF 1

REV. NO:

A

DRAWING NO:

WSD-002608