

Carlton®

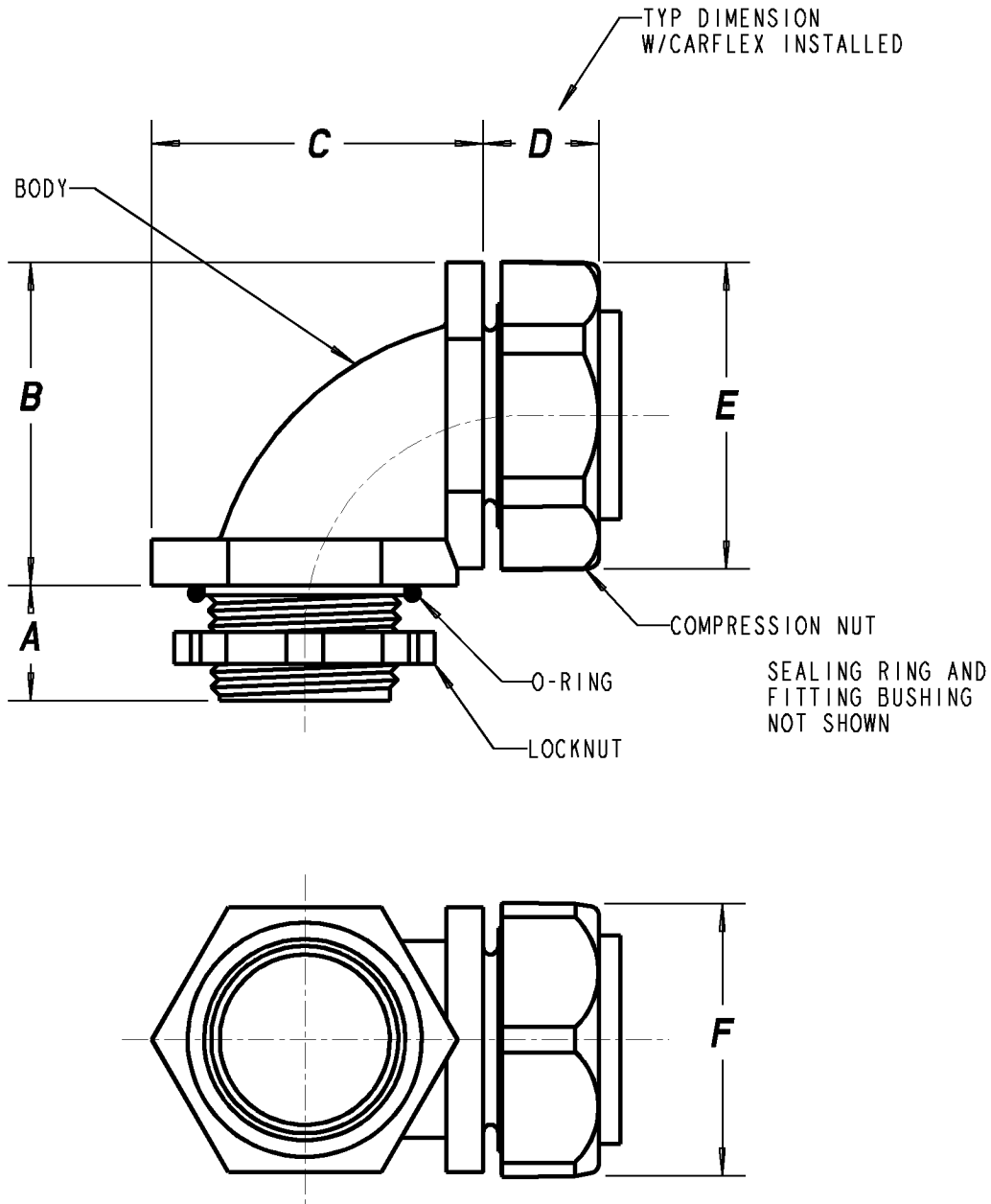

PART NO	SIZE	A	B	C	D	E	F	MAXIMUM HOLE SIZE
LT20G LT20GU	1 1/4"	.75 [19,1]	2.01 [51,1]	2.52 [64]	1.10 [27,9]	2.48 [63]	2.18 [55,4]	1.75 [44,5]
LT20H LT20HU	1 1/2"	.75 [19,1]	2.16 [54,9]	2.81 [71,4]	1.19 [30,2]	2.77 [70,4]	2.43 [61,7]	2.06 [52,3]

GENERAL NOTES

- ALL DIMENSIONS ARE FOR REFERENCE ONLY.
- DIMENSIONS IN BRACKETS [] ARE IN METRIC UNITS.

REVISIONS

*** SEE ERN (****) FOR APPROVAL SIGNATURES & RELEASE DATE.
PROJECT NO: ****

Thomas & Betts
www.tnb.com

DESCRIPTION: **90 DEGREE CARFLEX FITTING**

ORIGINAL PROJECT NO / (ERN NO)

/ ()

SHEET NO:

1 OF 3

REV. NO:

C

DRAWING NO:

WSD-AC03583

Carlton®

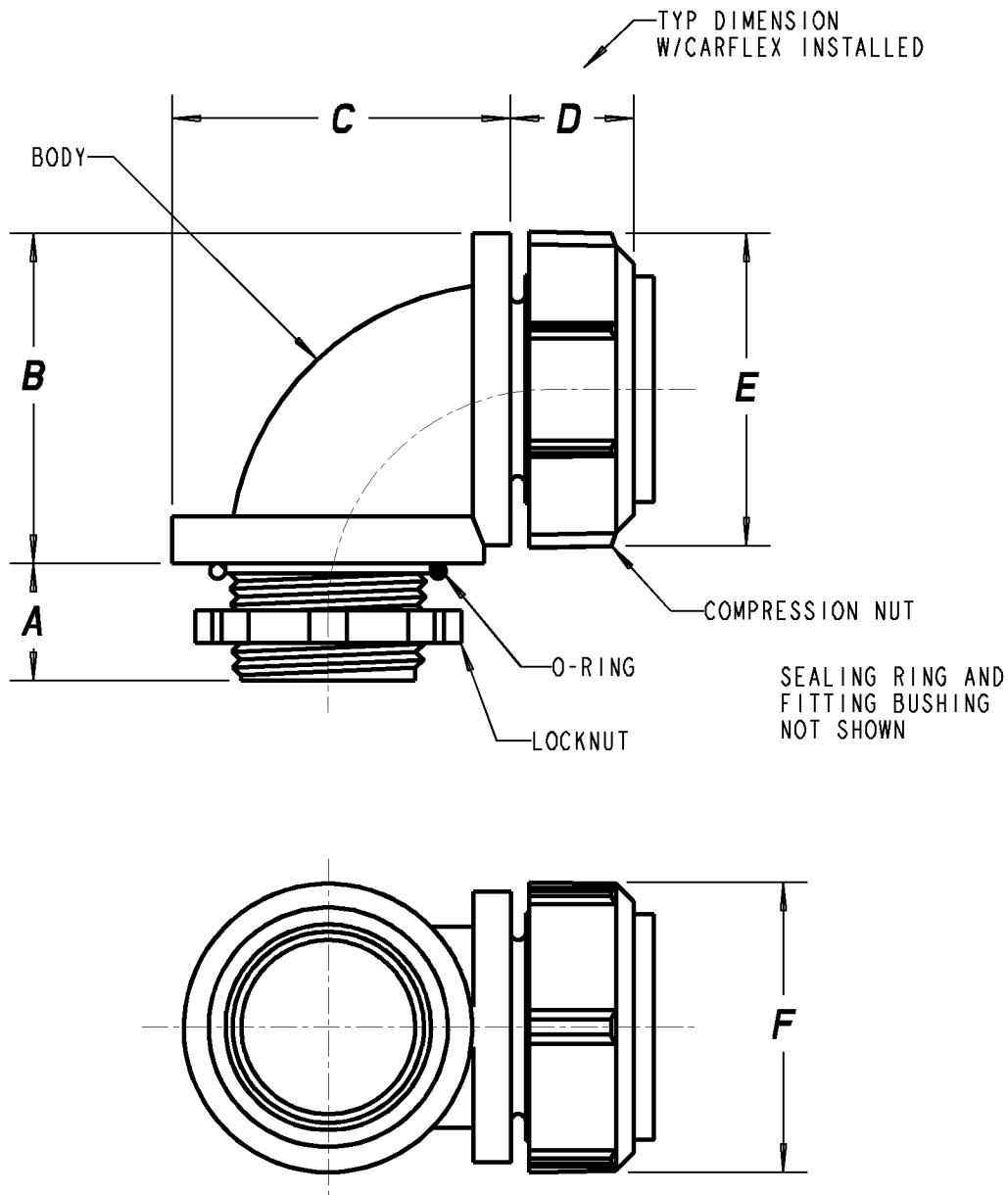

PART NO	SIZE	A	B	C	D	ØE	ØF	MAXIMUM HOLE SIZE
LT20J LT20JU	2"	.90 [22,8]	3.25 [82,6]	3.25 [82,6]	1.25 [31,8]	3.33 [84,6]	3.00 [76,2]	2.40 [60,9]

Thomas & Betts
www.tnb.com

DESCRIPTION: **90 DEGREE CARFLEX FITTING**

SHEET NO:
2 OF 3

REV. NO:
C

DRAWING NO:
WSD-AC03583

Carlton®

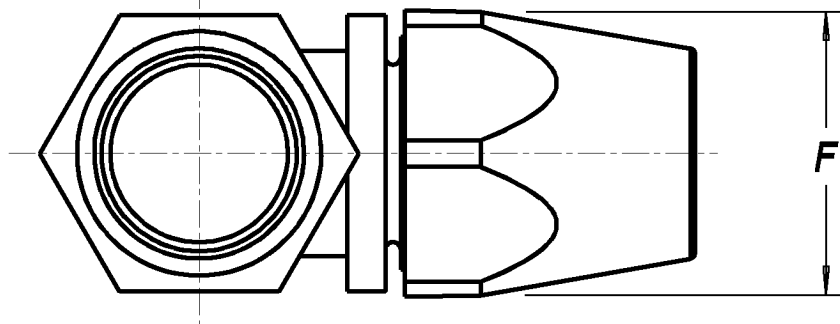
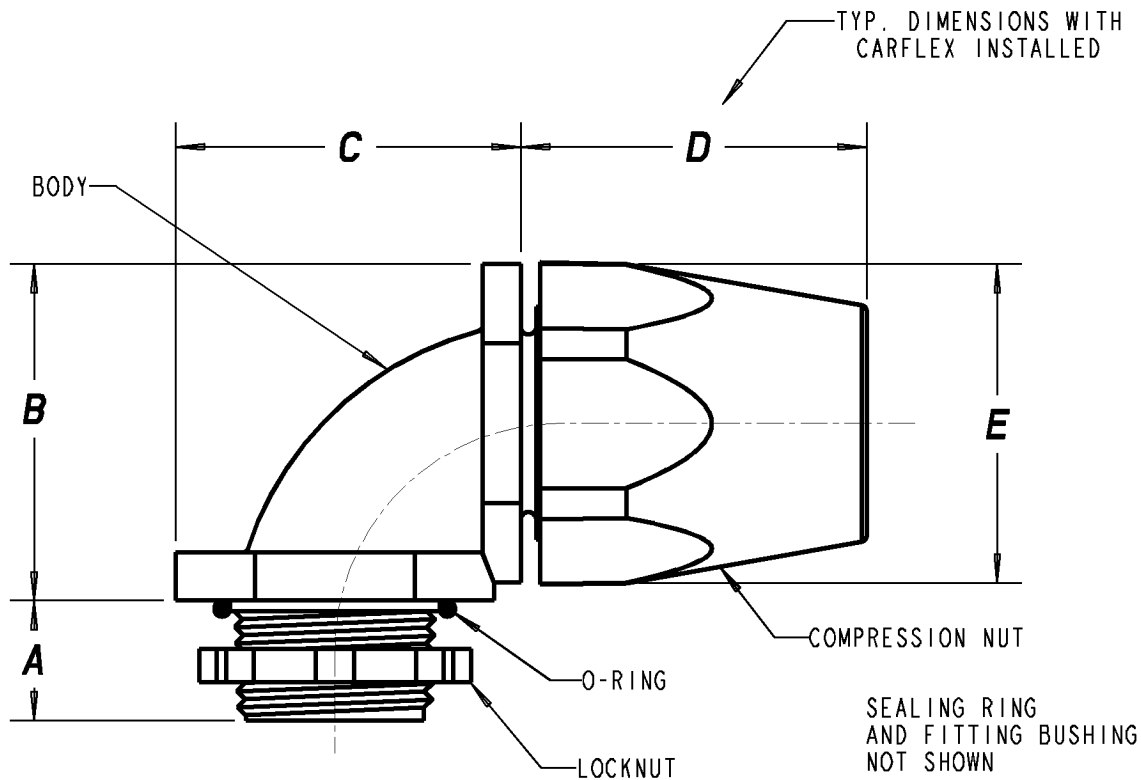

PART NO	SIZE	A	B	C	D	E	F	MAXIMUM HOLE SIZE
LT20C LT20C-CAR	3/8" [14]	.56 [14,2]	1.30 [33]	1.44 [36,5]	1.56 [39,6]	1.39 [25,3]	1.26 [32,0]	.91 [23,0]

Thomas & Betts
www.tnb.com

DESCRIPTION: **90 DEGREE CARFLEX FITTING**

SHEET NO:
3 OF 3

REV. NO:
C

DRAWING NO:
WSD-AC03583