

T&B Conduit Fittings

Rigid and Intermediate Metal Conduit Fittings

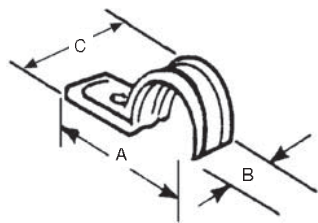

Elongated bolt hole makes alignment easy, even when holes in mounting surface are off center. Snap on features. Steel. Zinc plated

Pipe Straps—Steel

Cat. No.	Conduit Size	Dimensions (in.)			Screw Size
		A	B	C	
1210C†	3/8"	1-15/32	3/4	11/16	1/4"
1211C	1/2"	2	3/4	15/16	1/4"
1212C	3/4"	2-5/16	3/4	1"	1/4"
1213C	1"	3-13/16	3/4	1-17/64	1/4"
1214TB*	1-1/4"	2-31/32	1-9/16	1-9/16	3/8"
1215TB*	1-1/2"	3-23/32	1-13/16	1-13/16	3/8"
1216TB*	2"	4-7/16	2-5/16	2-5/16	3/8"

† Not snap on type.
U.L. not applicable.
* Not CSA Certified.

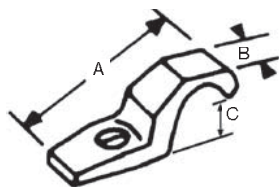

Malleable iron. Designed to fit each size of conduit snugly. High reinforcing ribs on each side increase strength, reduce weight.

Corrosion Resistant PVC Coated Rigid Conduit Straps



Cat. No.	Size	Bolt Size	Dimensions (in.)		
			A	B	C
1275CR	3/8"	1/4"	2	21/32	1/4
1276CR	1/2"	1/4"	2-13/32	25/32	1/2
1277CR	3/4"	1/4"	2-3/4	23/32	5/8
1278CR	1"	1/4"	3-5/32	3/4	13/16
1279CR	1-1/4"	3/8"	4-5/32	25/32	7/8
1280CR	1-1/2"	3/8"	4-9/16	1	1-7/32
1281CR	2"	1/2"	5-1/4	1-3/16	1-1/4

U.L. not applicable.