



Project:	Type:	QTY:
Product Code:		

Ø4"



Product Code

IP53 - RFL4BP - TRIM COLOR - INTENSITY - VOLTAGE
 W=White WW=3000K 120=120V, AC

Features + Specifications

Intended Use:

- Building interior
- Building exterior (ceiling recessed only)
- Damp location listed
- IC rated, approved and tested for direct contact with insulation materials

Construction:

- Die-cast aluminum one piece trim frame with built-in heat sink
- Opal PMMA lens with light glide technology for even light distribution
- Full metal top plate protects LED PCB
- Heavy duty installation springs ensure tight fitting to ceiling

Finish:

- W = Powder coat painted

Optical System:

- High brightness 2835 SMDs with LM80 certificate **6W**
- **WW** = 3000K CCT, **550 lumens** minimum with 80+ CRI
- L70 @ 30000hrs for ambient temperature <25°C
- PCB made from laminated heavy gauge copper materials

Electrical System:

- Constant current driver technology
- 120V line voltage dimmable with most dimmers
- Overheat protected, RoHS compliant

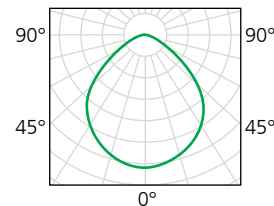
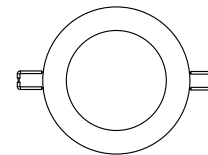
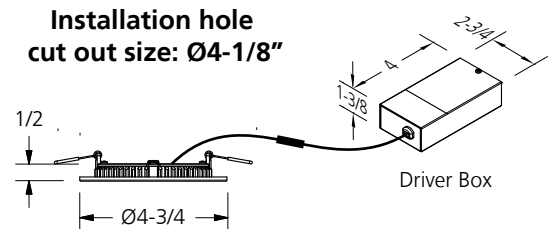

Right reserved for material and spec modification without prior notice.

Datecode 20161205

Warranty - Up To 3 Years

Certified to CSA C22.2 No.250.0 Conformed to UL 1598
 Certification Marks (where applicable) will be found on our luminaires and its components



www.iplighting.com

