



Project: _____

Fixture Type: _____

Location: _____

Contact/Phone: _____

4" IC 600 LUMEN LED DOWNLIGHT NEW CONSTRUCTION

IC 1 LED (G4 06LM) RECESSED HOUSING

HYPERBOLIC TRIMS



PRODUCT DESCRIPTION

Dedicated LED, Air-Loc® sealed new construction housing with integral light engine • Double wall, shallow housing construction allows for fit in 2 x 6 construction • Can be completely covered with insulation • Fully sealed housing stops infiltration and exfiltration of air, reducing heating and air cooling costs without the use of additional gaskets • LED housing is designed to provide 50,000 hours of life and is compatible with many standard Juno trims • 5 year limited warranty on LED components.

ENVIRONMENTALLY FRIENDLY, ENERGY EFFICIENT

- No harmful ultraviolet or infrared wavelengths
- No lead or mercury, RoHS compliant
- Comparable light output to 65W incandescent

PRODUCT SPECIFICATIONS

LED Light Engine LED array attached to high purity aluminum, thermally conductive inner housing provides superior heat transfer to ensure long life of the LED • Replaceable light engine mounts directly to inner housing assembly and incorporates the latest generation, high lumen output LED array • LEDs are binned within a 3-step MacAdam Ellipse exceeding ENERGY STAR® requirements for superior fixture to fixture color uniformity • 2700K, 3000K, 3500K, or 4000K color temperatures available • 90 CRI minimum.

Hyperbolic Optical System Patent pending unique hyperbolic reflector shape optimized for small, directional LED source provides unique aperture appearance with reduced brightness • NMC™ nano mixing chamber (provided with trim) with high reflectance white finish coupled with a high transmission diffusing lens conceals the LED and integrates with the hyperbolic trim to create a low glare, efficient system producing 600 lumens using less than 9W*.

Aesthetic Trim Selections Patent pending hyperbolic reflector available in clear Alzak®, haze, wheat haze, black Alzak® and white • Shadow free, knife edge design blends seamlessly into ceiling • Installs with push-in springs.

LED Driver Choice of dedicated 120 volt (120) driver or universal voltage (MVOLT) drivers that accommodate input voltages from 120-277 volts AC at 50/60Hz • Power factor > 0.9 at 120V input • 120 volt only driver is dimmable with the use of most incandescent, magnetic low voltage and electronic low voltage wall box dimmers • Universal voltage drivers are dimmable with the use of most 0-10V wall box dimmers • For a list of compatible dimmers, see [JUNOICLED-DIM](#) • Mounted inside housing for easy access from below ceiling

Life Rated for 50,000 hours at 70% lumen maintenance.

Labels ENERGY STAR® Certified when used with select trims • Certified to the high efficacy requirements of California T24 JA8-2016 with select trims • UL listed for U.S. and Canada through-branch wiring, damp locations • Union made • UL and cUL.

Testing All reports are based on published industry procedures; field performance may differ from laboratory performance.

Specifications subject to change without notice.

HOUSING FEATURES

Housing Designed for use in IC (insulated ceiling) or non-IC construction • Aluminum housing sealed for Air-Loc® compliance • Housing is vertically adjustable to accommodate up to a 1 1/2" ceiling thickness.

Junction Box Pre-wired junction box provided with (6) 1/2" and (1) 3/4" knockouts, (4) knockouts for 12/2 or 14/2 NM cable and ground wire • UL listed and cUL listed for through-branch wiring, maximum 6 #12 branch circuit conductors • Junction box provided with removable access plates • Knockouts equipped with pryout slots • Quick connect electrical connectors supplied as standard for fast, secure installation.

Mounting Frame 22-gauge die-formed galvanized steel mounting frame • Rough-in section (junction box, mounting frame, housing and bar hangers) fully assembled for ease of installation.

Real Nail 3 Bar Hangers Patented (US Patent D552,969) Real Nail® 3 bar hangers: telescoping system permits quick placement of housing anywhere within 24" O.C. joists or suspended ceilings • Includes removable nail for repositioning of fixture in wood joist construction • Integral T-bar notch and clip for suspended ceilings.

*Nominal input wattage @ 120-volt operation with dedicated 120-volt driver under stable operating conditions.



DIMENSIONS

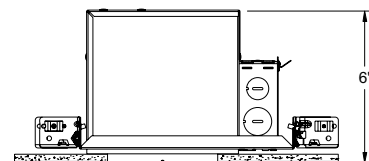
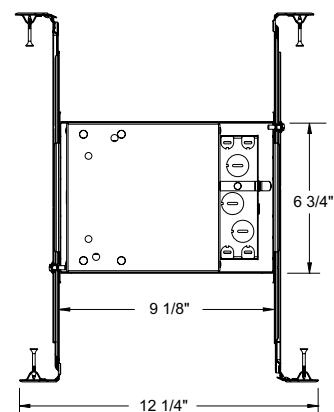

4 1/2" CEILING CUTOUT

4" IC 600 LUMEN LED DOWNLIGHT NEW CONSTRUCTION

IC1LED (G4 06LM) RECESSED HOUSING
HYPERBOLIC TRIMS

ELECTRICAL DATA

Dedicated 120V Only Driver Option (120 FRPC)

120V	
Input Power	8.6W (+/-5%)
Input Current	0.07A
Frequency	50/60Hz
EMI/RFI	FCC Title 47 CFR, Part 15, Class B (residential)
Minimum starting temp	-25°C

ELECTRICAL DATA

Universal Voltage

	MVOLT EZ10 and EZ1		MVOLT ZT10 and ZT1	
	120V	277V	120V	277V
Input Power	8.3W (+/-5%)	8.9W (+/-5%)	8.3W (+/-5%)	8.9W (+/-5%)
Input Current	0.07A	0.03A	0.07A	0.03A
Frequency	50/60Hz	50/60Hz	50/60Hz	50/60Hz
EMI/RFI	FCC Title 47 CFR, Part 15, Class B (residential)	FCC Title 47 CFR, Part 15, Class B (residential)	FCC Title 47 CFR, Part 15, Class B (residential)	FCC Title 47 CFR, Part 15, Class B (residential)
Minimum starting temp	-20°C	-20°C	-20°C	-20°C

ORDERING INFORMATION Housing and trim can be ordered together or separate, but will always ship separately.

Example: IC1LED G4 06LM 27K 90CRI 120 FRPC

Series	Generation	Lumens	Color Temperature	CRI	Voltage/Driver
IC1LED 4" LED IC New Construction Downlight	G4 Generation 4	06LM 600 Nominal Lumens	27K 2700K 30K 3000K 35K 3500K 40K 4000K	90CRI 90+ CRI	120 FRPC 120V Forward/Reverse Phase Cut, 5% dim MVOLT ZT10 Multi-Volt (120-277), 0-10V, 10% dim MVOLT ZT1 Multi-Volt (120-277), 0-10V, 1% dim MVOLT EZ10 Multi-Volt (120-277), eidoLED 0-10V, 10% dim MVOLT EZ1 Multi-Volt (120-277), eidoLED 0-10V, 1% dim



A+ Capable options indicated by this color background

Trim/Description



17HYP2 BWH¹	4" Hyperbolic Cone Trim - Black Cone, White Trim Ring
17HYP2 CWH	4" Hyperbolic Cone Trim - Clear Alzak® Cone, White Trim Ring
17HYP2 HZWH	4" Hyperbolic Cone Trim - Haze Cone, White Trim Ring
17HYP2 WHZABZ¹	4" Hyperbolic Cone Trim - Wheat Haze Cone, Classic Aged Bronze Trim Ring
17HYP2 WHZWH¹	4" Hyperbolic Cone Trim - Wheat Haze, White Trim Ring
17HYP2 WWH²	4" Hyperbolic Cone Trim - White, White Trim Ring

Trim Size: 5" O.D.

Alzak is a registered trademark of Alcoa Corp.

Note: In Canada when insulation is present, Type IC fixtures must be used.

¹ Not ENERGY STAR® Certified or T24 certified

² ENERGY STAR® Certified and T24 certified @ 30K with 120 driver and @ 35K, 40K with all drivers

4" IC 600 LUMEN LED DOWNLIGHT NEW CONSTRUCTION

IC1LED (G4 06LM) RECESSED HOUSING HYPERBOLIC TRIMS

PHOTOMETRICS

PHOTOMETRIC REPORT

Test Report #: PT06140404
Catalog No: IC1LED G4 06LM 35K
90CRI 120 with 17HYP2 HZWH Trim and
standard nano mixing chamber

Luminaire Spacing Criterion: 0.62

Luminaire LPW: 67

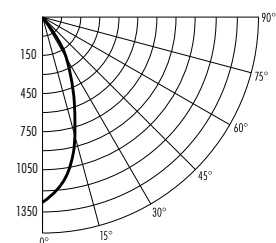

CANDLEPOWER DISTRIBUTION (Candelas)

Degrees	Vertical	0°
0	1329	
5	1233	
15	826	
25	442	
35	44	
45	3	
55	0	
65	0	
75	0	
85	0	
90	0	

Multiplier: 27K - 0.89
30K - 0.94
40K - 1.03

AVERAGE INITIAL FOOTCANDLES

Multiple Units (Square Array, 60'x60' room)
Ceiling 80% Wall 50% Floor 20%

Spacing	RCR1	RCR3	RCR5
4.0'	40	36	33
5.0'	26	23	21
6.0'	18	16	15
7.0'	14	13	12
8.0'	11	10	9
9.0'	9	8	7
10.0'	6	6	5

ZONAL LUMEN SUMMARY

Zone	Lumens	%Lamp	%Fixture
0-30°	533	N/A	92.8
0-40°	571	N/A	99.4
0-60°	574	N/A	100.0
0-90°	574	N/A	100.0

INITIAL FOOTCANDLES (One Unit, 8.6W, 38.3° Beam)

Distance to Illuminated Plane (Feet)	Footcandles Beam Center	Beam Diameter
4	83.1	2.8'
6	36.9	4.2'
8	20.8	5.6'
10	13.3	6.9'

LUMINANCE (Average cd/m²)

Degrees	Average Luminance
45	691
55	33
65	0
75	0
85	0

PHOTOMETRIC REPORT

Test Report #: PT06140402
Catalog No: IC1LED G4 06LM 35K
90CRI 120 with 17HYP2 CWH Trim and
standard nano mixing chamber

Luminaire Spacing Criterion: 0.56

Luminaire LPW: 70

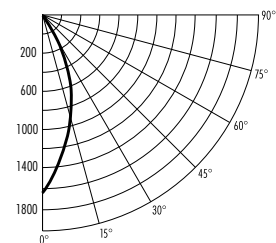

CANDLEPOWER DISTRIBUTION (Candelas)

Degrees	Vertical	0°
0	1627	
5	1457	
15	918	
25	438	
35	26	
45	1	
55	0	
65	0	
75	0	
85	0	
90	0	

Multiplier: 27K - 0.89
30K - 0.94
40K - 1.03

AVERAGE INITIAL FOOTCANDLES

Multiple Units (Square Array, 60'x60' room)
Ceiling 80% Wall 50% Floor 20%

Spacing	RCR1	RCR3	RCR5
4.0'	42	38	35
5.0'	27	24	22
6.0'	19	17	15
7.0'	15	14	13
8.0'	12	11	10
9.0'	9	8	8
10.0'	7	6	6

ZONAL LUMEN SUMMARY

Zone	Lumens	%Lamp	%Fixture
0-30°	575	N/A	95.0
0-40°	604	N/A	99.9
0-60°	605	N/A	100.0
0-90°	605	N/A	100.0

INITIAL FOOTCANDLES (One Unit, 8.6W, 34.2° Beam)

Distance to Illuminated Plane (Feet)	Footcandles Beam Center	Beam Diameter
4	101.7	2.5'
6	45.2	3.7'
8	25.4	4.9'
10	16.3	6.2'

LUMINANCE (Average cd/m²)

Degrees	Average Luminance
45	212
55	0
65	0
75	0
85	0

Fixtures tested to IES recommended standard for solid state lighting per LM-79-08. Photometric performance on a single unit represents a baseline of performance for the fixture. Results may vary in the field.