

## B427 Beam Clamp

- Design Load 1100 Lbs. (4.89 kN) when used in pairs
- Safety Factor of 5
- 2 1/2" (63.5) Max. Flange Thickness without channel
- 1/2"-13 x 1 1/2" Setscrew included
- Sold in pieces
- Standard finish: ZN
- Wt./C 92 Lbs. (41.7 kg)

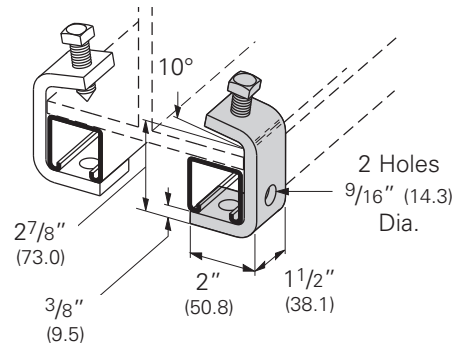

## B405 Suspension Member

- Standard finishes: ZN, GRN
- Wt./C 75 Lbs. (34.0 kg)

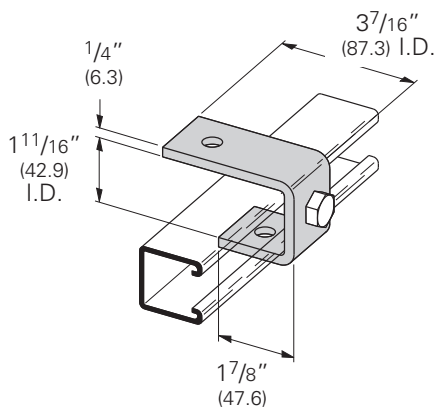

## B405A Suspension Member with Beam Clamp

- 7/8" (22.2) Max. Flange Thickness
- Includes:
  - 1 pc. B405 Suspension Member
  - 1 pc. B213 I-Beam Clamp
  - 1 pc. 1/2"-13 x 2 1/2" HHCS
  - 1 pc. 1/2"-13 Hex Nut
- Material: Malleable iron
- Standard finishes: ZN, GRN
- Wt./C 183 Lbs. (83.0 kg)

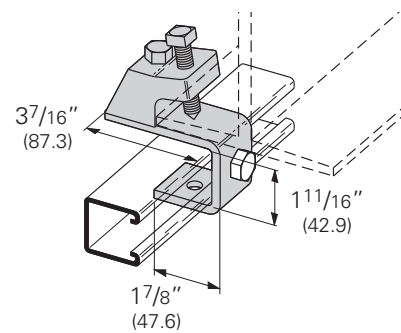

## B602A THRU B602C Beam Clamp with Gusset Assembly

- Safety Factor of 5
- 7/8" (22.2) Max. Flange Thickness
- Includes:
  - 1 pc. B451 Slotted Three Hole U Support with Gusset
  - 2 pcs. B213 I-Beam Clamp
  - 2 pcs. 1/2"-13 x 2 1/2" HHCS
  - 2 pcs. 1/2"-13 Hex Nuts
- Material: Malleable iron
- Standard finishes: ZN, GRN

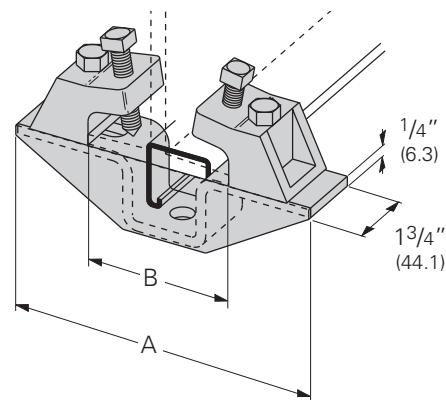

Part No.	A		For Flange Width B		Design Load		Wt./C	
	In.	mm	In.	mm	Lbs.	kN	Lbs.	kg
<b>B602A</b>	7 1/4"	(184.1)	2 3/8"-4 1/2"	(60.3-114.3)	1200	(5.34)	365	(165.1)
<b>B602B</b>	8 1/2"	(215.9)	3 3/4"-5 3/4"	(95.2-146.0)	1200	(5.34)	383	(173.7)
<b>B602C</b>	10 3/8"	(263.5)	5 5/8"-7 5/8"	(142.9-193.7)	1200	(5.34)	408	(185.0)

Reference page 113 for general fitting and standard finish specifications.