

Core & Coil (71A) MH 175W - 450W

CORE & COIL HID MH BAL 250W M58 120/277/347V KIT

The basic ballast is the open core and coil which is most often used as a component within a lighting luminaire. The core and coil also forms the nucleus of Philips Advance's five other ballast configurations.

Product data

General Information		Operating and Electrical	
ANSI Code	M58	Input Voltage	120/277/347 V
Lamp Type	250W MH	Input Frequency	60 Hz
Number of Lamps	1 piece/unit	Inp. Current (Open Circuit)	2.1/0.9/0.75 A
Circuit Type	CWA	Input Current (Starting)	2.2/1/0.8 A
Ballast Type	Magnetic HID	Input Current (Short Circuit)	1.9-2.7/0.8-1.2/0.65-1 A
Base Model	71A57A0	Secondary Short Circuit Current	2.25-2.75 A
Core Size	4 1/4 x 4 3/4 (2 coil)	Constant Wattage Deviation	10%
Suitable For Outdoor Use	Yes	Ballast Factor (Nom)	1
Ignitor Catalog Number	NA	Power Factor (Nom)	0.90
Ignitor Temperature Rating	NA	Nominal Open Circuit Voltage	315 V
Capacitor Value	15 MFD	Input Current (Operating) (Nom)	2.5/1.1/0.9 A A
Capacitor Catalog Number	7C150P40R	Input Power (Nom)	295 W
Capacitor Requirements	400V	Rated Lamp Watts	250 W
Capacitor Temperature Rating	105°C	Wiring	
Capacitor Diameter/Oval Dimensions	1.75 in	Wire Striplength	0.5 mm
Capacitor Height	3.75 in	Wire Length by Color	12"
Automatic Restart	No	Wire Type	Stranded

Core & Coil (71A) MH 175W - 450W

Remote Wiring Configuration Allowed	Yes
Max Ballast-Lamp Distance Remote Wiring	Determined by AWG used
Recommended Fuse Value	8/3/3 A

Approval and Application

Open Circuit Voltage Test (Volts)	280-345 V
Approbation Marks	ULR CSA certificate RoHS Compliant
Temperature Marking	A/A/A
UL Recognized	Yes
Hipot Test (1 Minute)	2000 V
Hipot Test (2 Seconds)	2500 V
UL Insulation Class	H(180°C)

UL Temperature Code	1029A
---------------------	-------

Product Data

Order product name	CORE & COIL HID 71A57A0001D
EAN/UPC - Product	781087098233
Order code	71A57A0001D
Numerator - Quantity Per Pack	1
Numerator - Packs per outer box	1
Material Nr. (12NC)	913700525309
Net Weight (Piece)	4.650 kg

Dimensional drawing

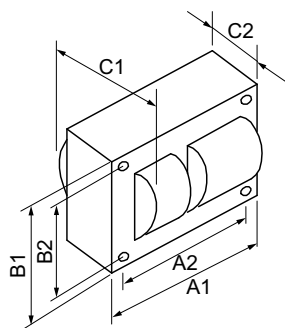

Product	C1	C2	A1	A2	B1	B2
CORE & COIL HID 71A57A0001D	3.1 in	1.64 in	4.8 in	4.4 in	4.3 in	3.9 in

MH BAL 250W M58 120/277/347V KIT

