



(BD2-V)

BD2 Series

**Multiple Position – 200 A per Position
200 A (Main Lugs) 600 V Max.**

Product Specifications

- Conductor range: Line: 6 AWG-250 kcmil, Load: 6 AWG-250 kcmil
- Aluminum tunnel type connectors for both load and line sides
- Factory prebussed from main lugs to each position
- Supplied with hub opening closure plate for underground service
- Combination overhead underground
- Supplied with screw type rings
- Weatherproof Type 3R enclosure
- **Primarily used in: All provinces**

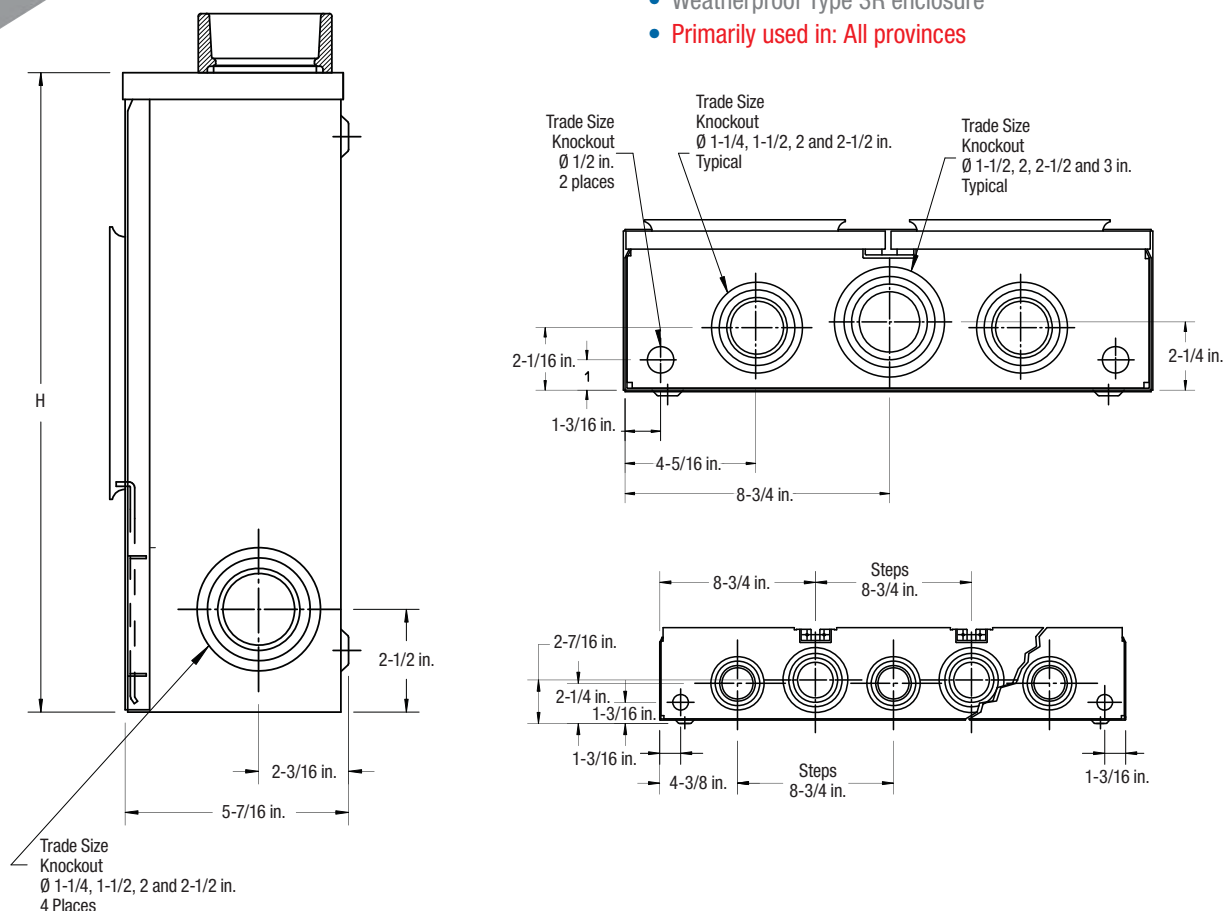

Note: Pattern for bottoms. Left hand entry is shown. For right-hand entry, unit is manufactured symmetrically with hub openings, knockout and line connections on right side.



Approved for copper or aluminum

Cat. No.		Meter Position	Dimensions (in.)			Weight Each	
			H	W	D	lb.	kg
4 JAW							
LEFT-HAND ENTRY	RIGHT-HAND ENTRY						
BD2-V	BD2-VH	2 position	15-1/2	17-1/2	5-7/16	23	10.4
BD3-V	BD3-VH	3 position		26-1/4		35	15.9
BD4-V	BD4-VH	4 position		35		47	21.3
BD2-VBC	—	2 position for British Columbia	20	17-1/2		27	12.2

BDA2-V Series

Multiple Position with Blank Compartment 200 A per position 200 A (Main Lugs) 600 V Max.

Product Specifications

- Conductor range: Line: 6 AWG-250 kcmil, Load: 6 AWG-250 kcmil
- Aluminum tunnel type connectors for load side
- Combination overhead and underground
- Hub opening closure plate for underground service
- Supplied with screw type rings
- Weatherproof Type 3R enclosure
- **Primarily used in: Ontario only**



(BDA2-V)

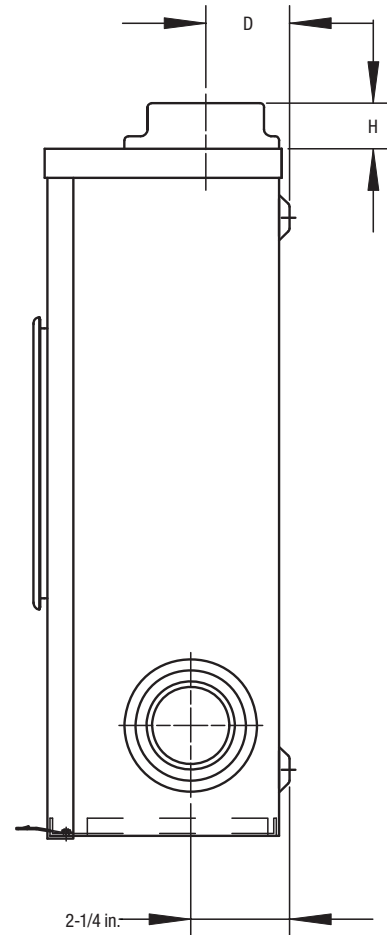
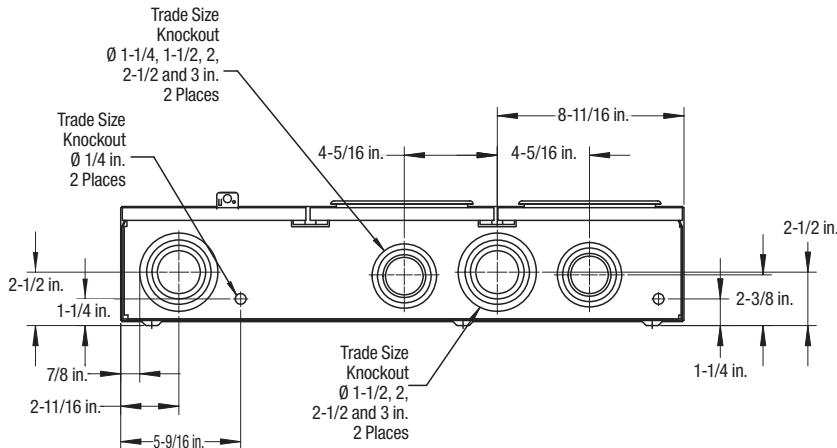

 Approved for copper or aluminum

Cat. No.		Meter Position	Dimensions (in.)			Weight Each	
			H	W	D	lb.	kg
4 JAW							
LEFT-HAND ENTRY	RIGHT-HAND ENTRY						
BDA2-V	BDA2-VH	2 position	15-5/8	26-3/16	5-1/4	31	14.6



(BDC2-VIL)

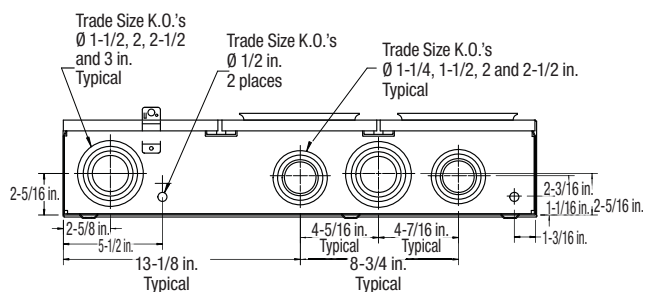
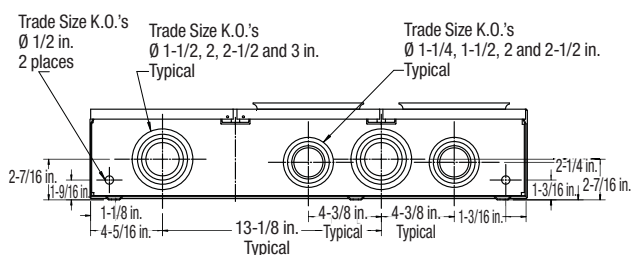
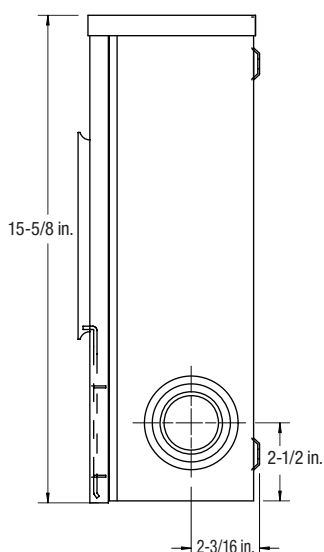

Note: Pattern for bottoms. Left hand entry is shown. For right-hand entry, unit is manufactured symmetrically with hub openings, knockouts for line connectors on right side.

BDC Series

Multiple Position with Blank Compartment
200 A per Position 200 A (Main Lugs)
600 V Max., Stud Type

Product Specifications

- Conductor Range: Line: Single 1/2 in. studs to accommodate compression lugs (supplied by utility), Load: 6 AWG-250 kcmil
- Aluminum tunnel type connectors for load sides
- For underground service only
- Factory prebussed from main lugs to each position
- Supplied with screw type sealing rings
- Weatherproof Type 3R enclosure
- Primarily used in: All provinces



Approved for copper or aluminum

For use in All Provinces

Cat. No.		Meter Position	Dimensions (in.)			Weight Each		
Left-Hand Entry	Right-Hand Entry		H	W	D	lb.	kg	
4 JAW								
BDC2-V	BDC2-VH	2 position	15-5/8	26-1/4	5-1/4	30	13.6	
BDC3-V	BDC3-VH	3 position		35		42	19.0	
BDC4-V	BDC4-VH	4 position		43-3/4		54	24.5	

Locking system outside meter section.



Approved for copper or aluminum

For use in Quebec

Cat. No.		Meter Position	Dimensions (in.)			Weight Each		
Left-Hand Entry	Right-Hand Entry		H	W	D	lb.	kg	
4 JAW								
BDC2-VIL	BDC2-VHIL	2 position		26-1/4		30	13.6	
BDC3-VIL	BDC3-VHIL	3 position	15-5/8	35	5-1/4	42	19.0	
BDC4-VIL	BDC4-VHIL	4 position		43-3/4		54	24.5	

Locking system inside meter section.



Approved for copper or aluminum

For use in British Colombia

Cat. No.		Meter Position	Dimensions (in.)			Weight Each		
Left-Hand Entry	Right-Hand Entry		H	W	D	lb.	kg	
4 JAW								
BDC2-VAILBC	BDC2-VAHILBC	2 position	20-3/4	26-1/4	5-1/4	30	13.6	
BDC3-VAILBC	BDC3-VAHILBC	3 position						
BDC4-VAILBC	BDC4-VAHILBC	4 position		35		42	19.0	

Locking system inside meter section, comes with tunnel type connector on line side.

BS4 Series

Multiple Position with Blank Compartment 200 A per Position 400 A (Main Lugs) 600 V Max.

Product Specifications

- Conductor range: Line: Dual rated connectors for 1 x 4 AWG-600 kcmil or 2 x 1/0 AWG-250 kcmil, Load: 6 AWG-250 kcmil
- Aluminum tunnel type connectors for both load and line sides
- Factory prebussed from main lugs to each position
- Combination overhead-underground
- Supplied with hub opening closure plate for underground service
- Larger hub opening requires use of 3 in., 3-1/2 in. or 4 in. hubs unless BS052 adapter plate is used
- Supplied with screw type rings
- Weatherproof Type 3R enclosure
- **Primarily used in: All provinces**

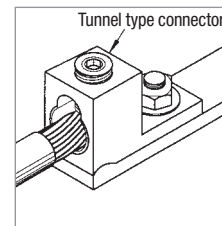
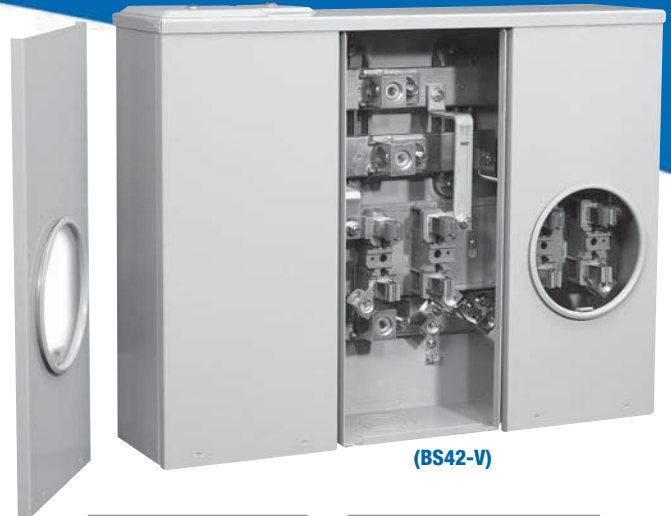

**TUNNEL TYPE CONNECTOR
TERMINATION LOAD AND LINE**

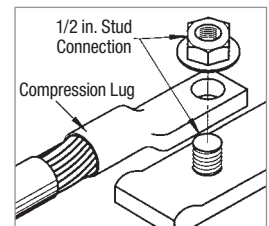

**COMPRESSION LUG TERMINATION
(WITH STUD CONNECTION)
500 KCMIL MAX. UNDERGROUND
APPLICATION COMPRESSION
CONNECTOR SUPPLIED BY UTILITY.**

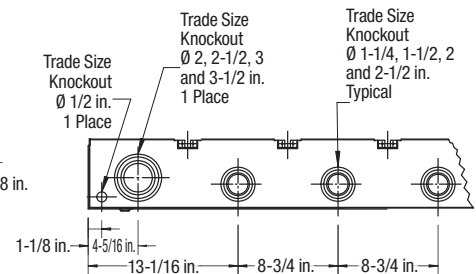
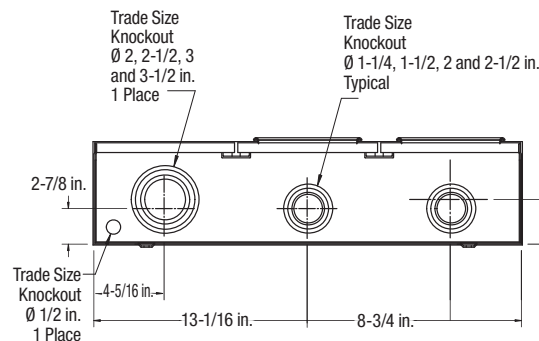
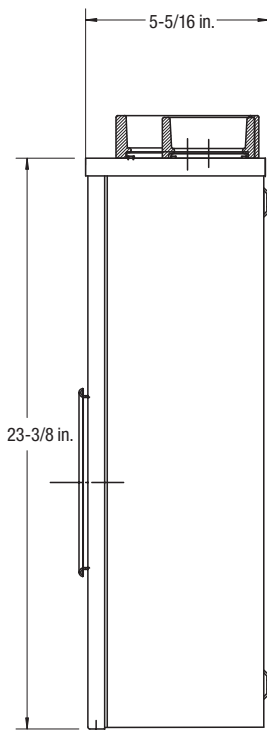

SP Approved for copper or aluminum

Cat. No.		Meter Position	Dimensions (in.)			Weight Each	
			H	W	D	lb.	kg
4 JAW							
LEFT-HAND ENTRY	RIGHT-HAND ENTRY						
BS42-V	BS42-VH	2 position	23-3/8	26-1/4	5-5/16	45	20.4
BS43-V	BS43-VH	3 position		35		59	26.8
BS44-V	BS44-VH	4 position		43-3/4		73	33.1
BS45-V	BS45-VH	5 position		52-1/2		87	39.5
BS46-V	BS46-VH	6 position		61-1/4		101	45.9