

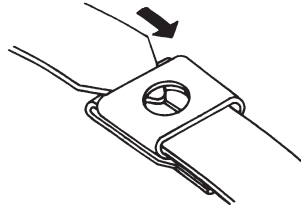

## Stainless Steel Cable Ties and Accessories

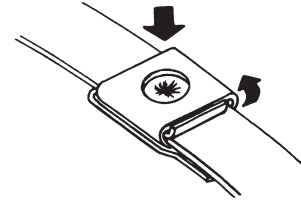

After wrapping the object to be tied, insert the free end of the tie through the buckle and into the tool.



Squeeze the handle of the tool to create the dual lock and cut off the tail. The cable tie forms a low-profile dual lock.



- The tail is formed into a fold lock behind the buckle
- The tool forces a dimple in the band into a hole in the buckle

### Dual Lock

Thomas & Betts has a complete package of stainless steel cable ties and accessories that are easy to apply and superior in quality. These products have been designed for tying, lashing and identification applications in demanding environments such as boiler rooms, chemical plants, refineries, pulp/paper mills, shipyards and offshore oil platforms. They are made of a variety of high-quality stainless steel materials which offer excellent corrosion resistance, high temperature and durability characteristics. There is also a variety of high-quality installation and identification tools to complete your cable tie accessory needs.

For cable bundling, I.D. tags and other general bundling applications – especially in hazardous environments – Thomas & Betts Stainless Steel Cable Ties provide a strong, safe, permanent installation with a unique, dual lock.

The Type 304 stainless steel ties are completely fireproof – no toxic fumes, no sagging cables. They are extremely resistant to corrosion and UV light, with the ability to withstand the harshest temperature extremes. Yet they are surprisingly economical.

The low-profile ties are fast and easy to apply. A quick squeeze of the installation tool forms two strong locks – a dimple lock and a fold lock.

Their two-piece configuration adds to its versatility. Available in standard lengths to wrap bundle diameters from 1 to 10 inches, Thomas & Betts Stainless Steel Cable Ties can be supplied in other lengths on special order.

Low-profile Thomas & Betts Stainless Steel Ties are fireproof and resist corrosion, UV light and extreme weather conditions for safe, permanent cable bundling.

### Installation Hand Tool

The installation hand tool is a lightweight, pocket size hand tool which quickly and easily applies the stainless steel cable ties.

To use, simply separate the pull-up handle from the body, push the release lever down and insert the clamp tail as far as possible. Squeeze the pull-up handle until the band is tight. Finally, move the pull-up handle to the locking/cut-off position by moving it away from the body as far as it will go. Then squeeze to form the dual lock and cut off the excess tail.

## Catalogue Number System

CABLE TIE TYPE
<b>SS</b> = Two-piece solid stainless steel cable tie, Type 304
<b>TYS</b> = Multi-lock stainless steel cable tie, Type 316
<b>SSR</b> = Reusable stainless steel cable tie, Type 200/300
<b>SSH</b> = Heavy-duty stainless steel clamp, Type 201
<b>TS</b> = Roller bar locking stainless steel cable tie, Type 302/304
<b>LS</b> = Ball locking stainless steel cable tie, Type 302/304/316

	Bundle Diameter	Tensile Strength	Width	Length	Weight
Cat. No.	For Bundle Dia. of (in./mm)	Tensile Strength (lb./N)	Width (in./mm)	Length (in./mm)	Weight (lb./kg)
<b>SS10-250</b>	2/51	200/890	0.25/6.35	10.0/254	1.1/4.89
<b>SS17-250</b>	4/101	200/890	0.25/6.35	16.5/419	1.8/8.00

## Stainless Steel Cable Ties and Accessories

### SS - Two-Piece Solid

Strong, slip-free ties with a unique dual lock

- Low-profile, single wrap ties
- No slipping
- Dual locking mechanism



Cat. No.	For Bundle Dia. of (in./mm)	Tensile Strength (lb./N)	Width (in./mm)	Length (in./mm)	Weight (lb./kg)	Std. Pkg.
<b>Mini Stainless Steel Cable Ties</b>						
<b>SS7-180</b>	1/25	100/444.8	0.18/4.5	6.5/165	0.70/0.32	100
<b>SS10-180</b>	2/51			10.0/254	0.90/0.41	
<b>SS16-180</b>	4/102			16.0/406	1.40/0.64	
<b>SS23-180</b>	6/152			22.5/572	1.85/0.84	
<b>SS29-180</b>	8/203			29.0/737	2.35/1.07	
<b>Standard Stainless Steel Cable Ties</b>						
<b>SS10-250</b>	2/51	250/1,112	0.25/6.35	10.0/254	1.10/0.50	100
<b>SS17-250</b>	4/102			16.5/419	1.80/0.82	
<b>SS23-250</b>	6/152			22.5/572	2.50/1.13	
<b>SS29-250</b>	8/203			29.0/737	3.20/1.45	
<b>SS35-250</b>	10/254			35.0/889	3.80/1.72	

304 Stainless Steel  
0.015 in. (0.38mm) Thickness  
**NOTE:** Other lengths available on special request.  
Add suffix -316 for 316 Stainless Steel.

### Mini Tie Installation Tool



Perfect for mini-sized stainless steel ties

- Pocket-sized, light weight
- Applies mini-size stainless steel ties

### Standard Tie Installation Tool

Pocket-sized hand tool for quick and easy cable tie installations

- Lightweight
- Applies standard-size stainless steel ties



Cat. No.	Description	Weight (lb./kg)	Std. Pkg.
<b>WTA290</b>	Hand tool to apply mini stainless steel cable ties; easy-to-use tool applies tension, locks tie with the dual lock, and cuts off band flush with top surface of buckle	1.17/0.53	1

Cat. No.	Description	Weight (lb./kg)	Std. Pkg.
<b>WTA250</b>	Hand tool to apply standard stainless steel cable ties; easy-to-use tool applies tension, locks tie with the dual lock, and cuts off band flush with top surface of buckle	1.17/0.53	1

## Stainless Steel Cable Ties and Accessories

### TYS - Multi-Lok™ Self-Locking



**Strong — holds in excess of 200 lb. — and self locking**

- Corrosion-resistant, providing a safe, strong, worry-free hold
- Unique, self-locking, multiple-locking system holds in excess of 200 lb.
- Manufactured from Type 316 stainless steel
- Available in two widths and various lengths

Cat. No.	Tensile Strength (lb./N)	Width (in./mm)	Length (in./mm)	Weight (lb./kg)	Std. Pkg.
<b>Type 316 Stainless Steel – Uncoated</b>					
<b>TYS6-280</b>	250/1,112	0.28/7.00	6/150	0.66/0.30	100
<b>TYS9-280</b>			9/225	0.99/0.45	
<b>TYS12-280</b>			12/300	1.32/0.60	
<b>TYS18-280</b>			18/450	1.76/0.80	
<b>TYS24-280</b>			24/610	2.64/1.20	
<b>TYS6-470</b>		0.47/12.00	6/150	1.10/0.50	
<b>TYS9-470</b>			9/225	1.65/0.75	
<b>TYS12-470</b>			12/300	2.20/1.00	
<b>TYS18-470</b>			18/450	2.97/1.35	
<b>TYS24-470</b>			24/610	4.29/1.95	

0.010 in. (0.245mm) Thickness

#### How it works:

As the free end of the Multi-Lok tie passes through the buckle, three separate teeth (four teeth in the 12mm Multi-Lok) mesh with corresponding slots in the band, automatically locking the tie as it is being tensioned.

- Nylon 11 weather-resistant coating is unaffected by UV sunlight, resistant to corrosion, chemicals, weathering and protects cable insulation
- Coated with halogen-free, non-toxic black nylon 11

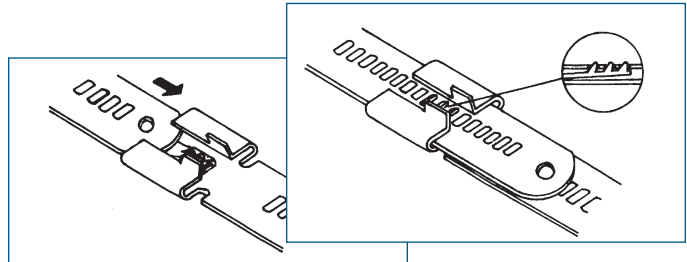

Cat. No.	Tensile Strength (lb./N)	Width (in./mm)	Length (in./mm)	Weight (lb./kg)	Std. Pkg.
<b>Type 316 Stainless Steel – Nylon 11 Coated</b>					
<b>TYS6-280C</b>	250/1,112	0.28/7.00	6/150	0.66/0.30	100
<b>TYS9-280C</b>			9/225	0.99/0.45	
<b>TYS12-280C</b>			12/300	1.32/0.60	
<b>TYS18-280C</b>			18/450	1.76/0.80	
<b>TYS24-280C</b>			24/610	2.64/1.20	
<b>TYS6-470C</b>		0.47/12.00	6/150	1.10/0.50	
<b>TYS9-470C</b>			9/225	1.65/0.75	
<b>TYS12-470C</b>			12/300	2.20/1.00	
<b>TYS18-470C</b>			18/450	2.97/1.35	
<b>TYS24-470C</b>			24/610	4.29/1.95	

0.010 in. (0.245mm) Thickness

## Stainless Steel Cable Ties and Accessories

### SSR - Reusable

Ties to use and reuse with quickness and ease!

- Made of high-strength, corrosion-resistant 200/300 Series stainless steel
- Coated with a non-toxic, halogen-free, low-smoke Nylon 11, protecting cables from damage or interference due to direct contact with the stainless steel
- Nylon 11 is also chemical and weather-resistant, UV-protective, extremely flexible at low temperature, user-friendly on installer's hands and easy on bundles
- Unique buckle design for quick, easy application and re-use

- Insert cable tie tail through holding tabs and locking emboss.
- Bend cable tie tail up.
- Insert cable tie tail back through holding tabs, creating as tight a bend as possible. For increased tensile strength follow steps #4 and #5.
- Bend cable tie tail up.
- Fold cable tie tail over holding tabs.

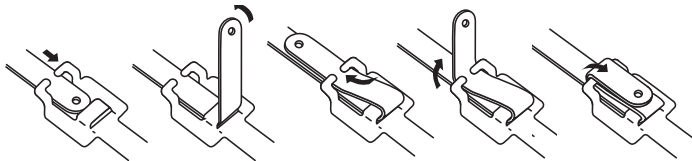

Cat. No.	Tensile Strength (lb./N)	Width (in./mm)	Length (in./mm)	Weight (lb./kg)	Std. Pkg.
<b>Reusable Stainless Steel Cable Ties – Coated</b>					
<b>SSR6-250C</b>	75/333.60	0.25/6.35	6/152	1.4/0.64	100
<b>SSR9-250C</b>			9/229	1.8/0.82	
<b>SSR12-250C</b>			12/305	2.1/0.95	
<b>SSR18-250C</b>			18/457	3.0/1.36	
<b>SSR24-250C</b>			24/610	3.7/1.68	
<b>SSR6-375C</b>	100/444.80	0.38/9.53	6/152	1.8/0.82	
<b>SSR9-375C</b>			9/229	2.0/0.91	
<b>SSR12-375C</b>			12/305	3.1/1.41	
<b>SSR18-375C</b>			18/457	4.4/2.00	
<b>SSR24-375C</b>			24/610	6.6/2.99	
<b>SSR30-375C</b>			30/762	7.0/3.18	
<b>SSR36-375C</b>			36/914	8.3/3.76	



**WTAE200**  
Cable Tie Tensioner



**WTAE201**  
Tensioning Hook



**DAS250**  
Pistol Grip Tensioning Tool

*(WTAE tools for use with type TYS – TYS C Series Cable ties)*

Cat. No.	Description	Weight (lb./kg)	Std. Pkg.
<b>Tensioning Tools</b>			
<b>WTAE200</b>	Cable Tie Tensioner: For tensioning Reusable Ties and Multi-Lok Ties	0.6/0.27	1
<b>WTAE201</b>	Tensioning Hook: For tensioning Reusable Ties and Multi-Lok Ties	0.1/0.05	
<b>DAS250</b>	Pistol Grip Tensioning Tool: For installing Multi-Lok, Ball Lock, & Roller Bar Lock SS Ties	1.0/0.45	

## Stainless Steel Cable Ties and Accessories



### SSH - Heavy Duty Clamp

Pre-assembled for single or double wrapping!

- Double-wrapped clamps provide extra strength
- Available in various lengths, widths, and thicknesses

Cat. No.	Max. Dia. Once Around (in./mm)	Max. Dia. Twice Around (in./mm)	Total Length (in./mm)	Tensile Strength Single Wrap (lb./N)	Band Width (in./mm)	Band Thickness (in./mm)	Weight (lb./kg)	Std. Pkg.
<b>Heavy-Duty Free-End Stainless Steel Clamps — Type 201</b>								
SSH10-250	2/50	—	10/25	450/2002	0.25/6.35	0.02/0.51	2.2/1.00	100
SSH16-250	3.5/88	1.5/38	16/40				3.1/1.41	
SSH16-375				900/4003	0.38/9.53	6.2/2.81		
SSH18-500	4/101	2/50	18/45	1,400/6228	0.5/12.70	0.03/0.76	10.5/4.76	
SSH19-250	5/127	2.5/63	19/48	450/2002	0.25/6.35	0.02/0.51	3.5/1.59	
SSH21-625	5/127	2.5/63	21/53	1,700/7562	0.63/15.88	0.03/0.76	15.1/6.85	
SSH24-750	6/152	3/76	24/60	2,000/8896	0.75/19.05	0.03/0.76	10.9/4.94	50
SSH27-250	7/177	3.5/88	27/68	450/2002	0.25/6.35		0.02/0.51	4.6/2.09
SSH31-500	8/203	4/101	31/78	1,400/6228	0.5/12.70	0.03/0.76	4.7/2.13	25
SSH34-250	9/228	4.5/114	34/86	450/2002	0.25/6.35	0.02/0.51	5.6/2.54	100
SSH37-750	10/254	5/127	37/93	2,000/8896	0.75/19.05	0.03/0.76	7.6/3.45	25
SSH44-375	12/304	6/152	44/112	900/4003	0.38/9.53		3.6/1.69	
SSH50-750	14/355	7/177	50/127	2,000/8896	0.75/19.05		9.7/4.40	
SSH56-625	16/406	8/203	56/142	1,700/7562	0.63/15.88		9.0/4.08	
SSH62-750	18/457	9/228	62/157	2,000/8896	0.75/19.05		11.6/5.26	
SSH69-625	20/508	10/254	69/175	1,700/7562	0.63/15.88		10.7/4.86	

Type 201 Stainless Steel  
Other Free-End Clamp sizes and metals are available on special order.

### Apply tension, cut and secure with confidence!



**WTJ020**

Lightweight pocket-sized tool to install 1/4 in. and 3/8 in. wide Free-End Clamps. This tool also applies tension and has a built-in cutter.



**WTC075**

Designed to install 1/4 in. to 5/8 in. wide Free-End Clamps. The lightweight, ratchet-action tool tension cuts and secures the buckle tab.



**WTC001**

A drop-forged tool with tensioning capability to do all 1/4 in. to 3/4 in. Free-End Clamp sizes.

Cat. No.	Description	Weight (lb./kg)	Std. Pkg.
<b>Installation Tools</b>			
WTJ020	Compact Free End Stainless Steel Cable Tie Installation Tool for 1/4 in. to 3/8 in. sizes	1.1/0.50	1
WTC075	Pistol Grip Free End Stainless Steel Cable Tie Installation Tool for 1/4 in. to 5/8 in. sizes	2.6/1.18	
WTC001	Free End Stainless Steel Cable Tie Installation Tool for all sizes	4.4/2.00	



## Stainless Steel Cable Ties and Accessories

### Specifications



Mini Stainless Steel Cable Ties



Standard Stainless Steel Cable Ties



Reusable Stainless Steel Cable Ties



Multi-Lok Ties — Uncoated



Multi-Lok Ties — Coated



Free-End Clamps

Cat. No.		Width (in./mm)	Length (in./mm)	Thickness (in./mm)	Max. Dia. Single Wrap (in./mm)	Max. Dia. Double Wrap (in./mm)								
<b>Specifications for Stainless Steel Ties</b>														
<b>SS7-180</b>		0.18/4.50	6.5/165	0.02/0.51	1.7/43	(single wrap only)								
<b>SS10-180</b>			10/254		2.8/71	-								
<b>SS16-180</b>			16/406		4.7/119									
<b>SS23-180</b>			22.5/572		6/152									
<b>SS29-180</b>			29.0/737		8/203		(single wrap only)							
<b>SS10-250</b>		10/254	2.1/53											
<b>SS17-250</b>		16.5/419	4.3/109											
<b>SS23-250</b>		22.5/572	6.5/165											
<b>SS29-250</b>		29/737	8.5/215											
<b>SS35-250</b>		35/889	10.5/265		0.02/0.51	N/A								
<b>SSR6-250C</b>		6/152	1.5/38											
<b>SSR9-250C</b>		9/229	2.5/63											
<b>SSR12-250C</b>		12/305	3.4/86											
<b>SSR18-250C</b>		18/457	5.4/137											
<b>SSR24-250C</b>		24/610	7.3/185											
<b>SSR6-375C</b>		6/152	1.5/38											
<b>SSR9-375C</b>		9/229	2.5/63											
<b>SSR12-375C</b>		12/305	3.4/86											
<b>SSR18-375C</b>		18/457	5.4/137											
<b>SSR24-375C</b>		24/610	7.3/185											
<b>SSR30-375C</b>		30/762	9.1/231											
<b>SSR36-375C</b>		36/914	11.0/280	5.3/135										
<b>Uncoated</b>		<b>Nylon 11 Coated</b>												
<b>TYS6-280</b>	<b>TYS6-280C</b>	0.28/7.00	6/152	0.01/0.25			1.9/48	(single wrap only)						
<b>TYS9-280</b>	<b>TYS9-280C</b>		9/229		2.8/71									
<b>TYS12-280</b>	<b>TYS12-280C</b>		12/305		3.8/96									
<b>TYS18-280</b>	<b>TYS18-280C</b>		18/457		5.7/144									
<b>TYS24-280</b>	<b>TYS24-280C</b>		24/610		7.6/193									
<b>TYS6-470</b>	<b>TYS6-470C</b>	0.47/12.00	6/152		0.01/0.25	1.9/48	(single wrap only)							
<b>TYS9-470</b>	<b>TYS9-470C</b>		9/229			2.8/71								
<b>TYS12-470</b>	<b>TYS12-470C</b>		12/305			3.8/96								
<b>TYS18-470</b>	<b>TYS18-470C</b>		18/457			5.7/144								
<b>TYS24-470</b>	<b>TYS24-470C</b>		24/610			7.6/193								
<b>SSH10-250</b>		0.25/6.35	10/250			0.02/0.51			2.0/50	N/A				
<b>SSH16-250</b>			16/400						3.5/88					
<b>SSH19-250</b>			19/480						5.0/127					
<b>SSH27-250</b>			27/680						7.0/177					
<b>SSH34-250</b>			34/860						9.0/228					
<b>SSH16-375</b>		0.38/9.53	16/400	0.02/0.51				3.5/88	1.5/38					
<b>SSH44-375</b>			44/1,120					12.0/304						
<b>SSH18-500</b>		0.5/12.70	18/460					0.03/0.76			4.0/101	2.0/5.0		
<b>SSH31-500</b>			31/780								8.0/203			
<b>SSH21-625</b>		0.63/15.88	21/530								0.03/0.76		5.0/127	2.5/64
<b>SSH56-625</b>			56/1,420		16.0/406									
<b>SSH69-625</b>			69/1,750		20.0/508									
<b>SSH24-750</b>		0.75/19.05	24/600		0.03/0.76		6.0/152						3.0/76	
<b>SSH37-750</b>			37/940				10.0/254							
<b>SSH50-750</b>			50/1,270				14.0/355							
<b>SSH62-750</b>			62/1,570			18.0/457								

**Specifications (cont'd)**

Cat. No.		Stainless Steel Type	Coating or Finish	Min. Loop Tensile Strength Single Wrap (lb./N)	Min. Loop Tensile Strength Double Wrap (lb./N)	Application Tools Used	Max. Dia. Single Wrap (in./mm)	
<b>Specifications for Stainless Steel Ties (cont'd)</b>								
SS7-180		304	Dull to Bright	100/445	(single wrap only)	WTA290	<ul style="list-style-type: none"> <li>• Wire/cable bundling</li> <li>• I.D. tagging</li> </ul>	
SS10-180								
SS16-180								
SS23-180								
SS29-180								
SS10-250								
SS17-250				200/890		WTA250		
SS23-250								
SS29-250								
SS35-250		200/300	Nylon 11 Coated (Uncoated or other colours available on special order)	75/334	300/1,334	WTAE200	<ul style="list-style-type: none"> <li>• Reusable</li> <li>• Cable bundling</li> <li>• Oil rigs</li> <li>• Telecommunications towers</li> <li>• Hazardous and corrosive environments</li> <li>• Cable trays</li> </ul>	
SSR6-250C								
SSR9-250C								
SSR12-250C								
SSR18-250C								
SSR24-250C								
SSR6-375C				100/445		500/2,224		WTAE201
SSR9-375C								
SSR12-375C								
SSR18-375C								
SSR24-375C								
SSR30-375C								
SSR36-375C					WTC075			
<b>Uncoated Nylon 11 Coated (cont'd)</b>								
TYS6-280	TYS6-280C	316	Uncoated or Nylon 11 Coated Black	250/1,112	(single wrap only)	WTAE200	<ul style="list-style-type: none"> <li>• Self-locking</li> <li>• Cable bundling</li> <li>• Hazardous and corrosive environments</li> </ul>	
TYS9-280	TYS9-280C							
TYS12-280	TYS12-280C							
TYS18-280	TYS18-280C							
TYS24-280	TYS24-280C							
TYS6-470	TYS6-470C							WTAE201
TYS9-470	TYS9-470C							
TYS12-470	TYS12-470C							
TYS18-470	TYS18-470C							
TYS24-470	TYS24-470C							WTC075
SSH10-250		201	Bright	450/2,002	1,200/5,338	WTJ020 WTC075 WTC001	<ul style="list-style-type: none"> <li>• Industrial hoses</li> <li>• Cable bundling</li> <li>• High strength</li> </ul>	
SSH16-250								
SSH19-250								
SSH27-250								
SSH34-250				900/4,003	2,400/10,675	WTC075 WTC001		
SSH16-375								
SSH44-375								
SSH18-500								
SSH31-500				1,400/6,227	3,300/14,678	WTC001		
SSH21-625								
SSH56-625								
SSH69-625								
SSH24-750				1,700/7,562	4,000/17,792	WTC001		
SSH37-750								
SSH50-750								
SSH62-750								
				2,000/8,896	5,000/22,240			

Ty-Rap® Stainless Steel Cable Ties have passed a variety of mechanical, environmental, and electrical tests. Other data can be made available upon request. S.S. Series also available in (316) Stainless.

## Stainless Steel Cable Ties and Accessories

### Tools and Accessories

**Boiler rooms, shipyards, or off-shore oil platforms — a match for any severe environment!**

- Stainless steel strap cable ties have been designed for high-temperature applications and for use in areas of harsh, corrosive environments
- Rated at 200-lb. tensile strength
- Smooth edges protect both the cable insulation and the installer



Cat. No.	Body Width (in.)	Length (in.)	Max. Wire Bundle Dia. (in.)	Tensile Strength (lb.)	Std. Pkg.
<b>Ty-Rap® Stainless Steel Strap Cable Ties</b>					
<b>TYS8</b>	0.310	10.65	2	200	100
<b>TYS14</b>	0.310	14.65	4	200	50
<b>TYS22</b>	0.310	22.65	6	200	50
<b>TYS28</b>	0.310	28.65	8	200	50

**Note:** Use WT3S Tool for tensioning  
Cannot be coated with any covering material  
Made of 316 stainless steel

### 1,000-ft. reel to cut your desired length!



Cat. No.	Description	Width (in./mm)	Tensile Strength (lb./N)	Std. Pkg.
<b>Ty-Rap® Stainless Steel Strapping on a Reel</b>				
<b>TYS1000</b>	1,000-ft. of strap, 2 reels of 500 ft. each	0.31/7.87	200/889.60	1

Stainless steel ties of virtually any length can be produced from the 1,000-ft. reel in combination with the matching head.

**Note:** Use WT3S tool for tensioning and cutoff

### A perfect mate with cable ties for tensioning



WT3S



DAS250

Cat. No.	Description	Std. Pkg.
<b>Ty-Rap® Stainless Steel Cable Tie Installation Tools</b>		
<b>WT3S</b>	Installs strapping ties	1
<b>DAS250</b>	Installs multi-lok, ball lock, and roller bar lock stainless steel ties	

### Lockable heads for stainless steel strapping

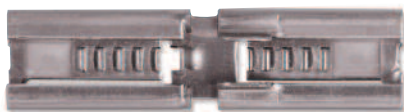

Cat. No.	Description	Std. Pkg.
<b>Ty-Rap® Stainless Steel Strapping Locking Heads</b>		
<b>TYS5200H</b>	Heads only for stainless strapping	50

### Long-lasting anchor hold



Cat. No.	Description	Std. Pkg.
<b>Ty-Rap® Stainless Steel Mounting Base</b>		
<b>TCS25</b>	Mounting bases for stainless steel ties	50





### Identify cable bundles with permanent, stainless steel imprintable tags

- Apply Type 304 stainless steel tags with stainless steel cable ties
- Easy-to-use — slip a tie through the slots in the tag and fasten with the installaton tool
- Works with 1/4 in. wide ties
- 0.015 in. Thickness

Cat. No.	Width (in./mm)	Length (in./mm)	Weight (lb./N)	Std. Pkg.
<b>I.D. Tagging System</b>				
<b>SSID100</b>	0.75/19.05	2.0/50.80	0.5/2.22	100
<b>SSID101</b>	1.50/38.10	2.5/63.50	1.2/5.34	
<b>SSID102</b>	0.75/19.05	3.5/88.90	0.8/3.56	

Packaging Quantity: 100/box

**Note:** Customized pre-embossed tags are available. Please consult Regional Sales Office for details.

Add suffix (316) for 316 Stainless Steel.

### No second guessing — quickly and accurately position I.D. tags!

- Imprint Thomas & Betts stainless steel I.D. tags
- Includes special tag holder for secure positioning and a 3/32 in. character imprinting wheel, standard (no substitutions allowed)



Cat. No.	Description	Weight (lb./N)
<b>I.D. Tagging System</b>		
<b>WTID200</b>	I.D. Tag Imprinter	29.5/131.2
<b>WTID290</b>	3/32 in. Character Imprinting Wheel	-
<b>WTID281</b>	1/8 in. Character Imprinting Wheel	
<b>WTID283</b>	3/16 in. Character Imprinting Wheel	
<b>WTID204</b>	(Kit) WTID200 and WTID283	

Packaging Quantity: 1/box

## Stainless Steel Cable Ties and Accessories

### S.S. Tape Embossing System



Cat. No.	Description	Weight	
		lb.	kg
<b>S.S. Tape Embossing System</b>			
<b>WTID400</b>	Hand-held tool for embossing S.S. I.D. Tap	2.57	1.17
<b>WTID405</b>	Replacement S.S. tape (21' long, 1/2" wide)	0.18	0.01

## Stainless Steel Cable Ties and Accessories

### LS - Heavy-Duty Ball-Lock Mechanism

Engineered to withstand the harshest environments!



LS-7.9-200-C



LS-4.6-200A

These one-piece, self-locking stainless steel cable ties offer quick and easy installation — no crimping or folding required — and a strong, reliable lock. Choose among a variety of sizes and materials to meet all of your wire and cable bundling needs, even in the most extreme environments.

#### Fast, easy installation

- Self-locking — no time-consuming crimping or folding required
- Stainless steel ball in low-profile, wedge-shaped head locks tie securely in place
- Angled tail enables fast, easy insertion
- Rounded edges and smooth surfaces protect installer's hands

#### Wide range of sizes

- Six standard lengths cover most applications with custom lengths available
- Two standard widths offer tensile strength of 100 lb. (444.8 N) or 250 lb. (1,112 N)

#### Three materials suit a variety of environments

- 302/304 grade stainless steel for standard applications
- 316 grade (marine-grade) stainless steel for extra corrosion resistance
- 316 grade (marine-grade) stainless steel, fully coated with low-smoke, halogen-free polyester to withstand continuous exposure to salt spray, sunlight, petroleum and chemicals

#### Typical Applications

- Offshore drilling
- Petrochemical processing
- Shipbuilding
- Food and beverage processing
- Pharmaceutical processing

#### Specifications

- Operating Temp. Range:  
Uncoated: -112°F to 1,000°F (-80°C to 538°C)  
Coated: -40°F to 302°F (-40°C to 150°C)
- Approvals/Standards: UL, CE, Lloyd's Register, Germanischer Lloyd, American Bureau of Shipbuilding, Det Norske Veritas, RoHS compliant

#### Application Tool

DAS-250 Hand Tool (adjustable tension, automatic cut off)



#### Ordering Information

Cat. No. Uncoated 302/304 Grade Stainless Steel	Cat. No. Uncoated 316 Grade Stainless Steel	Cat. No. Fully Coated 316 Grade Stainless Steel	Length (in./mm)	Width (in./mm)	Max. Bundle Dia. (in./mm)	Tensile Strength (lb./N)	Std. Pkg.
LS-4.6-200A	LS-4.6-200B	LS-4.6-200C	7.9/201	0.18/4.6	2/51	100/445	100
LS-4.6-360A	LS-4.6-360B	LS-4.6-360C	14.2/360		4/102		
LS-4.6-520A	LS-4.6-520B	LS-4.6-520C	20.5/520		6/152		
LS-4.6-680A	LS-4.6-680B	LS-4.6-680C	26.7/679		8/203		
LS-4.6-840A	LS-4.6-840B	—	33.0/838		10/254		
LS-7.9-200A	LS-7.9-200B	LS-7.9-200C	7.9/201		2/51		
LS-7.9-360A	LS-7.9-360B	LS-7.9-360C	14.2/360	4/102			
LS-7.9-520A	LS-7.9-520B	LS-7.9-520C	20.5/520	6/152			
LS-7.9-680A	LS-7.9-680B	LS-7.9-680C	26.7/679	8/203			
LS-7.9-840A	LS-7.9-840B	—	33.0/838	10/254			
LS-7.9-1010A	LS-7.9-1010B	—	41.3/1050	12.5/318			

## DELTEC™ Cable Support System

### Lashing Straps and Accessories

#### Strong, long-life and cost-saving method of securing communication cables

The Deltec™ Cable Support System is a user-friendly product designed to provide ease and flexibility in fastening communications cables to messenger strand. It is equally well suited for copper conductor cable, coaxial cable, fiber optic cable and innerduct in aerial applications.

The Deltec™ system answers your aerial cable needs with innovative design and state-of-the-art materials. This system includes weather-resistant acetal cable straps, marine grade locking devices, and base hanger accessories for specific applications where mounting is required.

Pre-assembled Deltec™ cable straps are available in standard lengths of 10 in. (254 mm), 13.5 in. (342.9 mm), and 27 in. (685.8 mm). Convenient 50 ft. (15.24 m) to 3500 ft. (1066.8 m) reels where specific lengths need to be established by the installer in the field are available. Additional "standard" lengths can be established for applications where higher volumes prevail.



#### Advantages of the Deltec™ System Include:

- Proven years of service
- No sharp edges — craft friendly Cable friendly!
- Ease of installation — one wrap, no re-treading or re-strap
- Lowers installation costs
- High tensile strength after fastening
- Total flexibility in lengths when using reel
- Stackable spacers accommodate all cable sizes — no need to stock multiple sizes of individual height spacers
- Spacer designed to retain strap on each side and cradle the cable, providing restricted movement of spacer and preventing damage to cable
- In situations where multiple cables are supported, the T&B® TCP360 stackable spacer may be rotated 90° and installed similarly to a single cable, yet provide the same restricting features (unlike those commonly used today)
- Month and year of manufacture stamped into strap material
- Squirrels and vermin won't eat it!

