

## Specification Guide

### Cable Fittings

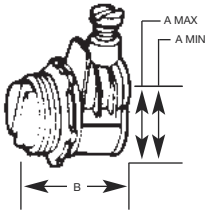

L-16



CI70 / CI72

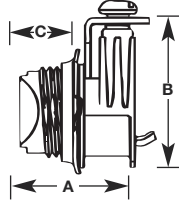

CI804 / CI816

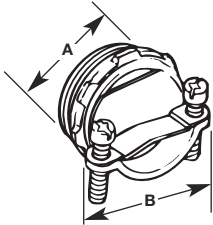

CI2060 / CI2061

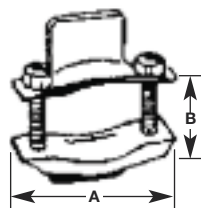

CI2104 / CI2116

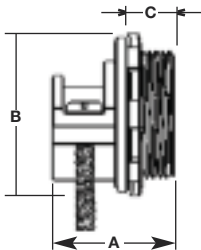

CI2163

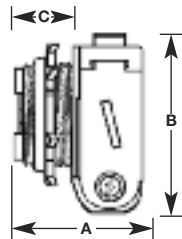

CI2166 / CI2172

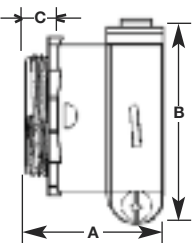

CI2173 / CI2174

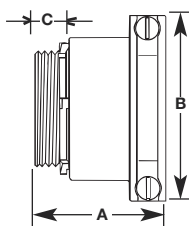

CI2175

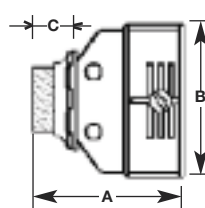

Cat. No.	Trade Size (in.)	Clamping Range (in.)		Dimensions (in.)		
		Min.	Max.	A	B	C
<b>One Screw Connectors (Zinc Alloy)</b>						
CI70	3/8	0.13	0.70	1	1-1/8	1/2
L-16	3/8	0.12	0.63	1	—	—
CI71	1/2	0.33	0.95	1-3/8	1-1/2	1/2
CI72	3/4	0.60	1.15	1-1/2	1-13/16	1/2
<b>Two Screw Connectors (Zinc Alloy)</b>						
CI804	3/8	0.18	0.64	7/8	1-1/16	—
CI806	3/4	0.41	0.82	1-3/8	1-3/16	
CI808	1	0.50	1.04	1-1/8	2	
CI810	1-1/4	0.56	1.06	1-5/16	2-3/16	
CI812	1-1/2	0.63	1.60	1-1/2	2-5/8	
CI816	2	0.86	2.06	1-9/16	3	—
<b>Two Screw Connectors (Steel)</b>						
CI2060	3/8	0.11	0.60	1-1/2	5/8	—
CI2061	3/4	0.15	0.90	1-3/4	13/16	
<b>Two Screw Connectors (Cast Aluminum Body and Clamp)</b>						
CI2104	1/2	0.45	0.59	1-3/16	1-3/8	19/32
CI2106	3/4	0.55	0.78	1-3/8	1-11/16	5/8
CI2108	1	0.69	1.01	1-1/2	1-15/16	3/4
CI2110	1-1/4	0.84	1.33	1-1/2	2-3/8	9/16
CI2112	1-1/2	1.06	1.57	1-9/16	2-3/4	5/8
CI2116	2	1.38	2.06	1-3/4	3-1/4	3/4
<b>One Screw Connector (Zinc Alloy)</b>						
CI2163	3/8	0.35	0.61	1	1-5/16	7/16
<b>One Screw Connectors (Aluminum)</b>						
CI2166	1/2	0.50	0.90	1-9/16	1-11/16	7/16
CI2167	3/4	0.71	1.10	1-11/16	1-7/8	7/16
CI2169	1	1.16	1.50	2	2-1/2	1/2
CI2170	1-1/4	1.32	1.77	2-3/8	2-7/8	5/8
CI2171	1-1/2	1.77	2.05	2-1/2	3-1/4	5/8
CI2172	2	2.10	2.54	2-11/16	3-3/4	11/16
<b>Two Screw Connectors (Aluminum)</b>						
CI2173	2-1/2	2.05	3.07	3-1/8	4-9/16	3/4
CI2174	3	2.25	3.57	3-3/8	5-5/16	15/16
<b>Duplex Connectors (Zinc Alloy)</b>						
CI2175	3/8	0.15	0.65	9/16	5/8	3/8

Technical improvements are constantly taking place in the electrical industry. Cable manufacturers are changing their products from time to time. Accordingly, it is strongly suggested that you verify the cable size with the cable manufacturer prior to selecting a fitting.

## Specification Guide

### Cable Connectors



CI2210 / CI2236

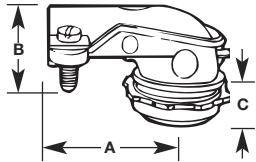

CI2238 / CI2240

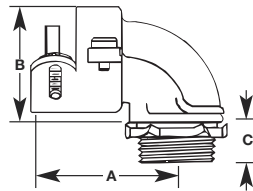

CI3360

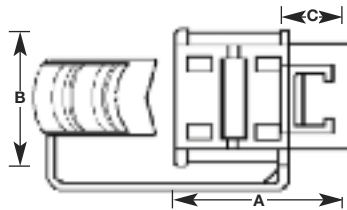

CI4004

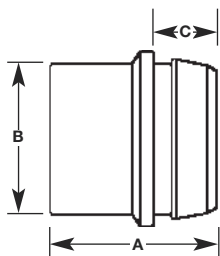

CI4000

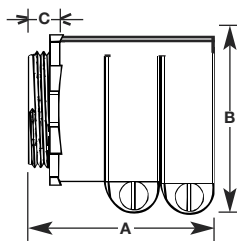

CI4090

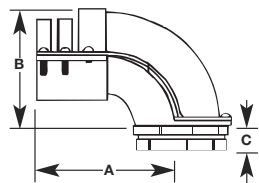

CI4040

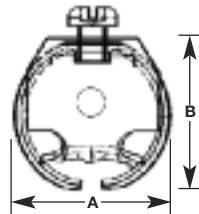

CI9049

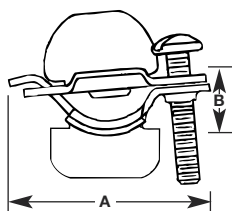

Cat. No.	Trade Size	Clamping Range		Dimensions		
		Min.	Max.	A	B	C
<b>90° Connectors (Zinc Alloy)</b>						
CI2210	3/8	0.40	0.63	1-3/8	3/4	3/8
CI2211	1/2	0.65	0.97	1-11/16	1-1/16	3/8
CI2214	3/4	0.77	1.12	1-3/4	1-1/8	1/2
CI2216	1	1.10	1.57	2	1-5/8	5/8
CI2218	1-1/4	1.27	1.75	3-3/8	2-1/8	5/8
CI2234	1-1/2	1.70	2.15	5-1/4	3-1/4	3/4
CI2236	2	2.00	2.62	5-3/8	3-1/4	3/4
<b>90° Connectors (Aluminum)</b>						
CI2238	2-1/2	2.50	3.08	6-1/4	5-1/2	3/4
CI2240	3	2.95	3.55	7-1/4	6-5/8	3/4
<b>Nonmetallic Connector</b>						
CI3360	1/2	0.30	0.60	1-5/16	1-1/16	7/16
<b>Two Screw Connector (Aluminum)</b>						
CI4000	4	4.40	4.55	4-7/8	5-3/4	7/8
<b>Nonmetallic Connector</b>						
CI4004	1/2	0.21	0.42	15/16	7/8	3/8
<b>One Screw Connectors (Steel)</b>						
CI4040	3/8	0.19	0.57	15/16	7/8	—
CI9049	3/8	0.13	0.37	1-3/8	5/16	—
<b>90° Connector (Aluminum)</b>						
CI4090	4	4.17	4.62	8-1/4	6	1

Technical improvements are constantly taking place in the electrical industry. Cable manufacturers are changing their products from time to time. Accordingly, it is strongly suggested that you verify the cable size with the cable manufacturer prior to selecting a fitting.