

FEATURES & SPECIFICATIONS

INTENDED USE — For applications that require the clean appearance of a low-profile, brightness-controlled wraparound. Provides broad distribution of light for offices, schools and corridors. **Certain airborne contaminants can diminish integrity of acrylic. [Click here for Acrylic Environmental Compatibility table for suitable uses.](#)**

CONSTRUCTION — Curved prismatic diffuser with linear side prisms minimize lamp image and provides high angle brightness control. Luminous end plates soften appearance for improved aesthetics.

ATTRIBUTES — Metal parts are die formed from code-gauge steel. Prismatic diffuser is 100% acrylic with sonically welded luminous ends. Continuous side flanges on fixture body provide light trap and continuous diffuser support to prevent accidental opening and simplify maintenance.

FINISH — Five stage iron-phosphate pretreatment assure superior paint adhesion and rust resistance.

ELECTRICAL — Thermally-protected, resetting, Class P, HPF, non-PCB, UL Listed, CSA Certified ballast is standard. Luminaire is suitable for damp locations. AWM, TFN or THHN wire used throughout, rated for required temperatures.

UL/CSA listed ballast disconnect w/strain relief and leads provided standard.

LISTINGS — UL Listed (standard). Optional: Canada CSA or C-UL. Mexico NOM.

WARRANTY — 1-year limited warranty. Complete warranty terms located at www.acuitybrands.com/CustomerResources/Terms_and_conditions.aspx

Note: Actual performance may differ as a result of end-user environment and application. Specifications subject to change without notice.

Catalog Number
Notes
Type

Low-Profile Wraparound



LB 3

T5 and T8
3 lamps
Wide body
4' or 8' length

Specifications

T8 Length:	24 (61.00) 48 (122.00) or 96 (243.90)
T5 Length:	46.5 (118.1) 22.5 (57.2)
Width:	15-3/8 (39.05)
Depth:	3 (7.62)

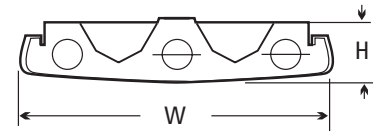

All dimensions are inches (centimeters) unless otherwise indicated.

ORDERING INFORMATION

For shortest lead times, configure product using standard options (shown in bold).

Example: LB 3 32 MVOLT GEB10IS

LB	3				
Series	Number of lamps	Lamp type	Voltage	Options	
LB 3 lamps, 15-3/8" wide <i>For tandem, double-length unit, add prefix T. Example: TLB</i>	3 <i>Not included</i>	32 32W T8 (48") 28 28W T5 (46.5") ¹ 54T5HO 54W T5HO (46-1/2") ¹	120 277 347 MVOLT	1/3 One, three-lamp ballast GEB10IS Electronic ballast, <10% THD, instant start GEB10PS Electronic ballast, <10% THD, program start EL Emergency battery pack (nominal 300 lumens See Life Safety Section). GLR Internal fast-blow fuse. ² GMF Internal slow-blow fuse. ² LSC Lens safety clips (2 per fixture). LP_ Lamped; specify lamp type and color CSA Listed and labeled to comply with Canadian Standards. SSR Specular silver interior finish (95% reflective).	

Accessories: Order as separate catalog number.	
SQ	Swivel-stem hanger (specify in 2" increments).
1B	Ceiling spacer (adjusts from 1-1/2" to 2-1/2" from ceiling).

Notes

- All T5 lamp types use GEB10PS ballast only.
- Must specify voltage.

LB 3 Low-Profile Wraparound, Wide Body

MOUNTING DATA

For unit or row installation, surface or stem mounting. Stem mounting not available on TLB units.

Individual installation — Four single-stem hangers required.

Row installation — Two hangers per fixture plus two per row required.

See ACCESSORIES below for hanging devices.

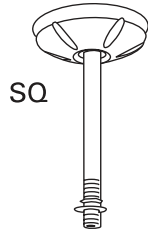
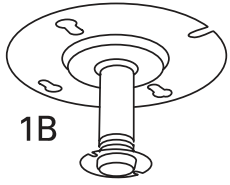

DIMENSIONS

Inches (centimeters). Subject to change without notice.

- A = 1/4 x 1/2 (.635 x 1.27) hole
- C = 7/8 (2.22) Dia. K.O.
- D = 11/16 (1.74) Dia. K.O.
- E = 2 (5.08) Dia. K.O. and 7/8 (2.22) Dia. K.O.

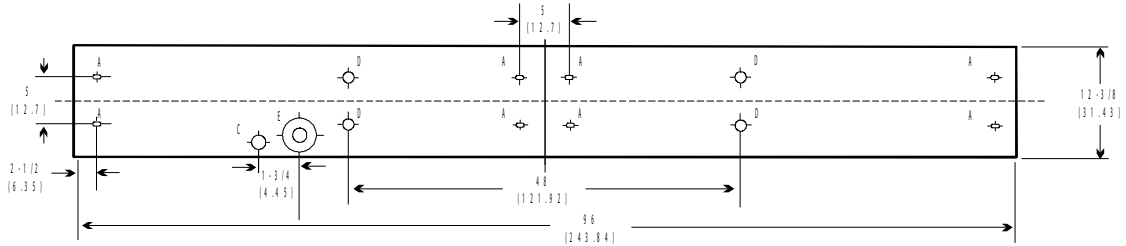
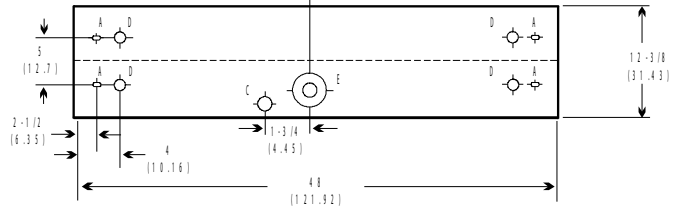

PHOTOMETRICS

Calculated using the zonal cavity method in accordance with IESNA LM41 procedure. Floor reflectances are 20%. Lamp configurations shown are typical. Full photometric data on these and other configurations available upon request.

LB 3 32

Report LTL 5638 – Lumens per lamp = 2900

S/MH (along) 1.2 (across) 1.3

Coefficient of Utilization

Ceiling	80%		70%		50%		0%			
	50%	30%	50%	30%	50%	30%	10%	0%		
0	87	87	87	84	84	84	79	79	79	67
1	80	77	74	77	74	71	70	67	65	57
2	74	68	63	71	66	62	62	59	56	49
3	68	61	55	65	59	54	56	51	48	43
4	63	54	48	60	53	47	50	45	42	37
5	57	49	42	55	47	41	45	40	36	32
6	53	44	37	51	43	37	41	35	32	28
7	49	39	33	47	38	33	37	32	28	25
8	45	35	29	44	35	29	33	28	24	22
9	42	32	26	40	31	25	30	25	21	19
10	39	29	23	37	28	23	27	22	19	16

Zonal Lumens Summary

Zone	Lumens	%Lamp	%Fixture
0-30	1786	20.5	27.5
0-40	2935	33.7	45.1
0-60	4808	55.3	73.9
0-90	5835	67.1	89.7
90-180	668	7.7	10.3
0-180	6503	74.8	100.0

Energy (Calculated in accordance with NEMA standard LE-5)

LER,FW	ANNUAL	LAMP	LAMP	BALLAST	
	ENERGY COST*	DESCRIPTION	LUMENS	FACTOR	WATTS
65	\$3.69	(3) 32W T8	2850	.88	87

*Calculated in accordance with NEMA Standard LE-5.