

TRAC 12

Project: _____

Fixture Type: _____

Location: _____

Contact/Phone: _____

Miniature Low Voltage Trac System

TRAPEZIA™ & GYRUS™

TL130-9, TL130-16 and TL140

PRODUCT DESCRIPTION

Trapezia suspends the MR16 lamp down from the trac with the grace of a trapeze artist. Slender 9-inch or 16-inch long tubes conceal lamp lead wires feeding into an elegantly sculpted die-cast lamp housing. The light airy appearance is great for display, exhibition and gallery lighting and the downward reach can make pendant mounting of trac unnecessary.

Gyrus combines dramatic aerodynamic styling with an integrated accessory holder that accepts up to two standard 2" diameter lenses and louvers. The snap-on design makes this an easy to accessorize fixture for more demanding display lighting applications.

Socket Ceramic bi-pin.

Aiming 90° vertical aiming capability and 358° rotation.

Labels UL listed, CSA certified.

Product specifications subject to change without notice.

Low Voltage MR16 - Trapezia™

Lamp 20-50W MR16 lamps • Must be used with MR16 lamps with integral lens (cover glass) except when combined with 2" accessories.

Construction Die-cast aluminum lamp housing with integral aiming handle
• Steel tubes conceal lamp lead wires.

Accessories May be used with up to two 2" accessories and/or Barn Doors simultaneously with Accessory Holder.

Catalog Number	Description	Finish	Lamp
TL130-9-WH	9" Rods	White	20-50W MR16CG with integral lens (cover glass), 12V or 24V
TL130-9-BL	9" Rods	Black	20-50W MR16CG with integral lens (cover glass), 12V or 24V
TL130-9-SL	9" Rods	Silver	20-50W MR16CG with integral lens (cover glass), 12V or 24V
TL130-16-WH	16" Rods	White	20-50W MR16CG with integral lens (cover glass), 12V or 24V
TL130-16-BL	16" Rods	Black	20-50W MR16CG with integral lens (cover glass), 12V or 24V
TL130-16-SL	16" Rods	Silver	20-50W MR16CG with integral lens (cover glass), 12V or 24V

ACCESSORIES

Cat. No.	Description	Cat. No.	Description	Cat. No.	Description
T7400SA, BL	Accessory Holder	T7470BL	Barn Doors	T7478	Linear Spread Lens
T741-6	Color Filters/Lenses	T7477	Prismatic Spread Lens	T7421	Uniformity Lens
T7401-18	Dichroic Lenses	T7420	Diffuse Spread Lens		
T7422	UV Filter Lens	T7459BL	Hexcell Louver		

See specification sheet [D1.2.2](#) for details.

Low Voltage MR16 - Gyrus™

Lamp 20-50W MR16 lamps.

Lens Glass lens included with lampholder • May be used with up to two 2" accessories simultaneously.

Construction Die-cast aluminum lamp housing • Extruded aluminum support stem conceals lamp lead wires.

Catalog Number	Description	Finish	Lamp
TL140WH	Gyrus™	White	20-50W MR16, 12V or 24V
TL140BL	Gyrus™	Black	20-50W MR16, 12V or 24V
TL140SL	Gyrus™	Silver	20-50W MR16, 12V or 24V

ACCESSORIES

Cat. No.	Description	Cat. No.	Description	Cat. No.	Description
T741-6	Color Filters/Lenses	T7477	Prismatic Spread Lens	T7478	Linear Spread Lens
T7401-18	Dichroic Lenses	T7420	Diffuse Spread Lens	T7421	Uniformity Lens
T7422	UV Filter Lens	T7459BL	Hexcell Louver		

See specification sheet [D1.2.2](#) for details.

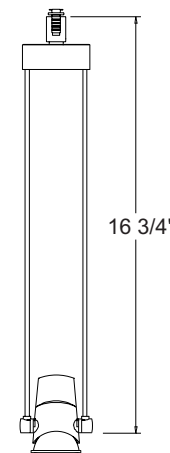
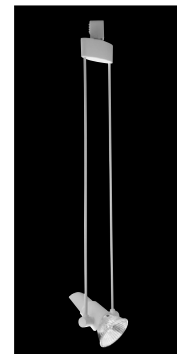

TL130-16

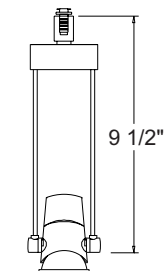
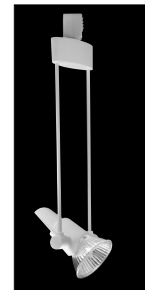

TL130-9

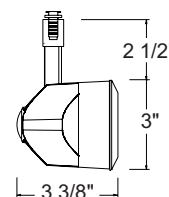

TRAC 12

Miniature Low Voltage Trac System

TRAPEZIA™ & GYRUS™

TL130-9, TL130-16 and TL140

CBCP • Centerbeam candlepower
FC • Footcandles at beam center (aim point)

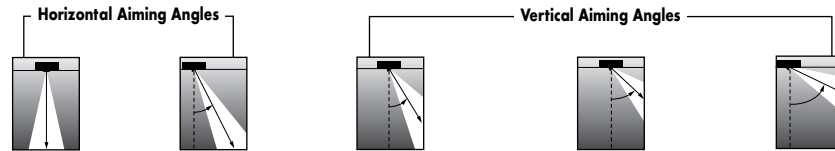

Lamp	Beam Type	Beam Spread°	Rated Life	CBCP	0°		30°			30°			45°				60°								
					MH	FC	L	W	FC	L	W	D	FC	X	L	W	FC	X	L	W	D	FC	X	L	W
Q35W MR16	SP	20°	5000	3900	4	244	1.4	1.4	158	1.9	1.6	2	122	3.5	3.1	1.4	345	2.0	1.5	1.0	4	158	2.3	1.9	1.6
					6	108	2.1	2.1	70	2.8	2.4	3	54	5.2	4.7	2.1	153	3.0	2.2	1.5	6	70	3.5	2.8	2.4
					8	61	2.8	2.8	40	3.8	3.3	4	31	6.9	6.2	2.8	86	4.0	2.9	2.0	8	40	4.6	3.8	3.3
					10	39	3.5	3.5	25	4.7	4.1	5	20	8.7	7.8	3.5	55	5.0	3.6	2.5	10	25	5.8	4.7	4.1
					12	27	4.2	4.2	18	5.7	4.9	6	14	10.4	9.3	4.2	38	6.0	4.4	3.0	12	18	6.9	5.7	4.9
					12	7	8.7	8.7	5	12.2	10.1	6	3	10.4	**	8.7	10	6.0	10.1	6.2	12	5	6.9	12.2	10.1
	FL	40°	5000	1000	4	63	2.9	2.9	41	4.1	3.4	2	31	3.5	9.6	2.9	88	2.0	3.4	2.1	4	41	2.3	4.1	3.4
					6	28	4.4	4.4	18	6.1	5.0	3	14	5.2	14.5	4.4	39	3.0	5.0	3.1	6	18	3.5	6.1	5.0
					8	16	5.8	5.8	10	8.1	6.7	4	8	6.9	19.3	5.8	22	4.0	6.7	4.1	8	10	4.6	8.1	6.7
					10	10	7.3	7.3	6	10.2	8.4	5	5	8.7	24.1	7.3	14	5.0	8.4	5.1	10	6	5.8	10.2	8.4
					12	7	8.7	8.7	5	12.2	10.1	6	3	10.4	**	8.7	10	6.0	10.1	6.2	12	5	6.9	12.2	10.1
					12	7	8.7	8.7	5	12.2	10.1	6	3	10.4	**	8.7	10	6.0	10.1	6.2	12	5	6.9	12.2	10.1
Q50W MR16	NSP	15°	6000	9100	4	638	1.0	1.0	414	1.3	1.1	2	319	3.5	2.1	1.0	902	2.0	1.0	0.7	8	104	4.6	2.6	2.3
					6	283	1.5	1.5	184	2.0	1.7	3	142	5.2	3.1	1.5	401	3.0	1.5	1.0	10	66	5.8	3.3	2.8
					8	159	2.0	2.0	104	2.6	2.3	4	80	6.9	4.1	2.0	225	4.0	2.0	1.4	12	46	6.9	3.9	3.4
					10	102	2.5	2.5	66	3.3	2.8	5	51	8.7	5.1	2.5	144	5.0	2.5	1.7	14	34	8.1	4.6	4.0
					12	71	2.9	2.9	46	3.9	3.4	6	35	10.4	6.2	2.9	100	6.0	3.0	2.1	16	26	9.2	5.3	4.5
					12	24	5.8	5.8	15	7.8	6.7	6	12	10.4	13.9	5.8	33	6.0	6.1	4.1	12	15	6.9	7.8	6.7
	NFL	25°	6000	3200	4	213	1.9	1.9	138	2.6	2.2	2	106	3.5	4.6	1.9	301	2.0	2.0	1.4	4	138	2.3	2.6	2.2
					6	94	2.9	2.9	61	3.9	3.3	3	47	5.2	7.0	2.9	134	3.0	3.1	2.0	6	61	3.5	3.9	3.3
					8	53	3.8	3.8	35	5.2	4.4	4	27	6.9	9.3	3.8	75	4.0	4.1	2.7	8	35	4.6	5.2	4.4
					10	34	4.8	4.8	22	6.5	5.5	5	17	8.7	11.6	4.8	48	5.0	5.1	3.4	10	22	5.8	6.5	5.5
					12	24	5.8	5.8	15	7.8	6.7	6	12	10.4	13.9	5.8	33	6.0	6.1	4.1	12	15	6.9	7.8	6.7
					12	24	5.8	5.8	15	7.8	6.7	6	12	10.4	13.9	5.8	33	6.0	6.1	4.1	12	15	6.9	7.8	6.7
FL	40°	6000	1700	4	116	2.9	2.9	75	4.1	3.4	2	58	3.5	9.6	2.9	164	2.0	3.4	2.1	4	75	2.3	4.1	3.4	
				6	51	4.4	4.4	33	6.1	5.0	3	26	5.2	14.5	4.4	73	3.0	5.0	3.1	6	33	3.5	6.1	5.0	
				8	29	5.8	5.8	19	8.1	6.7	4	14	6.9	19.3	5.8	41	4.0	6.7	4.1	8	19	4.6	8.1	6.7	
				10	19	7.3	7.3	12	10.2	8.4	5	9	8.7	24.1	7.3	26	5.0	8.4	5.1	10	12	5.8	10.2	8.4	
				12	13	8.7	8.7	8	12.2	10.1	6	6	10.4	**	8.7	18	6.0	10.1	6.2	12	8	6.9	12.2	10.1	
				12	13	8.7	8.7	8	12.2	10.1	6	6	10.4	**	8.7	18	6.0	10.1	6.2	12	8	6.9	12.2	10.1	

The beam spread in degrees and the beam "L" and "W" in the following tables are computed at 50% of centerbeam candlepower and represent areas of "effective illumination."

For additional Lamp Data, reference Juno Lighting Product Guide.

**Due to steep aiming angle, length of beam extends beyond 25'.

24V MR16 HALOGEN LAMPS WITH COVER GLASS

ANSI				
Cat. No.	Code	Watts	Description	Avg. Life (Hrs.)*
TL940-24V	-	35	Q35MR16/CG/NSP/24	1500
TL942-24V	-	35	Q35MR16/CG/NFL/24	1500
TL945-24V	-	50	Q50MR16/CG/NSP/24	1500
TL947-24V	-	50	Q50MR16/CG/FL/24	1500

*At rated voltage.



1300 S. Wolf Road • Des Plaines, IL 60018 • Phone (847) 827-9880 • Fax (847) 827-2925
 220 Chrysler Drive • Brampton, Ontario • Canada L6S 6B6 • Phone (905) 792-7335 • Fax (905) 792-0064
 Visit us at www.junolightinggroup.com

Printed in U.S.A. ©2009 Juno Lighting, LLC.