



FLEX 12

Flexible Low Voltage Trac System

CLOSE-TO-CEILING MOUNTING HARDWARE

TF31 and TF32

Project: _____

Fixture Type: _____

Location: _____

Contact/Phone: _____

PRODUCT DESCRIPTION

Ideal for low ceiling applications, Flex 12 Close-to-Ceiling feeds and supports offer a low profile mounting method that is simple to install. The low profile electrical feed cylinder and mechanical mini-support cylinder spaces the trac only $2\frac{1}{8}$ " from mounting surface. Because of its rigid, low profile mounting, the Close-to-Ceiling system is also ideal for wall mount applications that require the trac to be mounted very near the vertical mounting surface. One electrical feed is required per circuit. One mechanical support is required per 4' trac run and each additional 36" length of trac.

DIMENSIONS

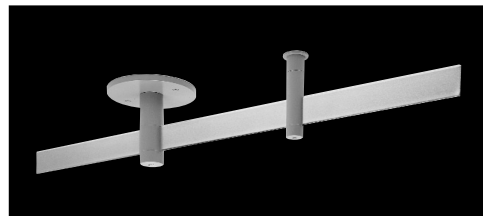

PRODUCT SPECIFICATIONS

Catalog Number TF31SL

Description Low Profile Electrical Feed Cylinder

- Electrically feeds and supports the trac within $2\frac{1}{8}$ " from the mounting surface
- Heavy gauge beryllium copper contacts
- Integral screw terminal connections accept up to 10 gauge solid wire
- Wiper-action contact system simplifies installation
- One Close-to-Ceiling Electrical Feed Cylinder required per 25 amp circuit
- Integral canopy mounts directly over standard 4" outlet box
- Silver finish.

Electrical Rated 25 amps at 12V (300VA) or 24V (600VA).

Labels UL listed, CSA certified • New York City Approved.

Product specifications subject to change without notice.

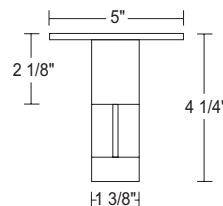

Catalog Number TF32SL

Description Low Profile Mechanical Mini-Support Cylinder

- Mechanically supports the trac within $2\frac{1}{8}$ " from the mounting surface
- One Close-to-Ceiling Mechanical Support Cylinder required per 4' trac run and each additional 36" length of trac
- Integral micro-canopy secures to mounting surface with toggle bolt (supplied) or 10-24 headless hanger screw
- Silver finish.

Labels UL listed, CSA certified • New York City Approved.

Product specifications subject to change without notice.

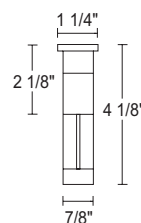

THIS SIDE INTENTIONALLY LEFT BLANK



1300 S. Wolf Road • Des Plaines, IL 60018 • Phone (847) 827-9880 • Fax (847) 827-2925
220 Chrysler Drive • Brampton, Ontario • Canada L6S 6B6 • Phone (905) 792-7335 • Fax (905) 792-0064
Visit us at www.junolightinggroup.com

Printed in U.S.A. ©2009 Juno Lighting, LLC.