

**JUNO**®

# FLEX 12

## Flexible Low Voltage Trac System UNIVERSAL LAMPHOLDER TF301, TF308, TF309 and TLP306

Project: \_\_\_\_\_

Fixture Type: \_\_\_\_\_

Location: \_\_\_\_\_

Contact/Phone: \_\_\_\_\_

### PRODUCT DESCRIPTION

The Universal halogen spotlight can be used alone for an “exposed lamp” aesthetic, or in combination with Metal Cone Shade, Luminous Scoop or Perforated Metal Scoop accessories. Flex 12 Universals may also be used with Decorative Pendant Shades (in a vertical downlight position only) - refer to specification sheet [D5.3.0](#) for shade selection. This selection of spotlights adds that touch of energy and color to liven up an interior. Available in MR16 styles that provide high intensity display and accent lighting. **Must be used with MR16 lamps with integral lens (cover glass).**

**Socket** Ceramic bi-pin.

**Lens** Not provided • For use only with MR16 lamps with integral lens (cover glass).

**Aiming** 90° vertical aiming capability and 358° rotation.

**Labels** UL listed, CSA certified • New York City Approved.

Product specifications subject to change without notice.

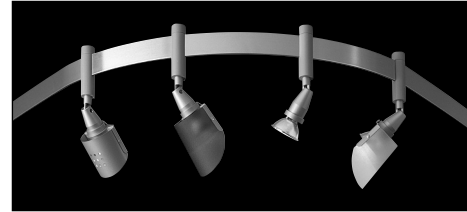

### Low Voltage MR16 - Universal

Catalog Number	Description	Finish	Lamp
TF301SL	Universal	Silver	20-50W MR16 with integral lens (cover glass), 12V or 24V

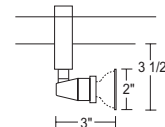

### Perforated Metal Scoop Accessory

Catalog Number	Description	Finish
TF308SL	Perforated Metal Scoop	Silver

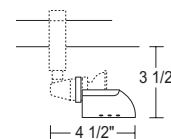

### Luminous Scoop Accessory

Catalog Number	Description	Finish
TF309WH	Luminous Scoop	White Frost
TF309BU	Luminous Scoop	Blue Frost
TF309YL	Luminous Scoop	Yellow Frost

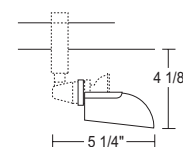

# FLEX 12

## Flexible Low Voltage Trac System UNIVERSAL LAMPHOLDER

### TF301, TF308, TF309 and TLP306

CBCP • Centerbeam candlepower  
FC • Footcandles at beam center (aim point)

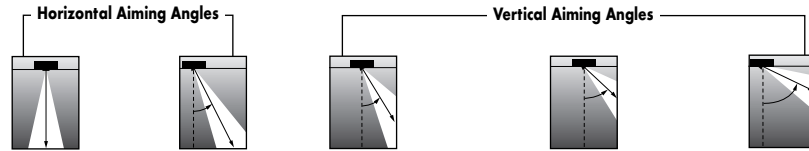

Lamp	Beam Type	Beam Spread°	Rated Life	CBCP	0°		30°			30°			45°				60°								
					MH	FC	L	W	FC	L	W	D	FC	X	L	W	FC	X	L	W	D	FC	X	L	W
Q35W MR16	SP	20°	5000	3900	4	244	1.4	1.4	158	1.9	1.6	2	122	3.5	3.1	1.4	345	2.0	1.5	1.0	4	158	2.3	1.9	1.6
					6	108	2.1	2.1	70	2.8	2.4	3	54	5.2	4.7	2.1	153	3.0	2.2	1.5	6	70	3.5	2.8	2.4
					8	61	2.8	2.8	40	3.8	3.3	4	31	6.9	6.2	2.8	86	4.0	2.9	2.0	8	40	4.6	3.8	3.3
					10	39	3.5	3.5	25	4.7	4.1	5	20	8.7	7.8	3.5	55	5.0	3.6	2.5	10	25	5.8	4.7	4.1
	FL	40°	5000	1000	4	63	2.9	2.9	41	4.1	3.4	2	31	3.5	9.6	2.9	88	2.0	3.4	2.1	4	41	2.3	4.1	3.4
					6	28	4.4	4.4	18	6.1	5.0	3	14	5.2	14.5	4.4	39	3.0	5.0	3.1	6	18	3.5	6.1	5.0
					8	16	5.8	5.8	10	8.1	6.7	4	8	6.9	19.3	5.8	22	4.0	6.7	4.1	8	10	4.6	8.1	6.7
					10	10	7.3	7.3	6	10.2	8.4	5	5	8.7	24.1	7.3	14	5.0	8.4	5.1	10	6	5.8	10.2	8.4
Q50W MR16	NSP	15°	6000	9100	4	638	1.0	1.0	414	1.3	1.1	2	319	3.5	2.1	1.0	902	2.0	1.0	0.7	8	104	4.6	2.6	2.3
					6	283	1.5	1.5	184	2.0	1.7	3	142	5.2	3.1	1.5	401	3.0	1.5	1.0	10	66	5.8	3.3	2.8
					8	159	2.0	2.0	104	2.6	2.3	4	80	6.9	4.1	2.0	225	4.0	2.0	1.4	12	46	6.9	3.9	3.4
					10	102	2.5	2.5	66	3.3	2.8	5	51	8.7	5.1	2.5	144	5.0	2.5	1.7	14	34	8.1	4.6	4.0
	NFL	25°	6000	3200	4	213	1.9	1.9	138	2.6	2.2	2	106	3.5	4.6	1.9	301	2.0	2.0	1.4	4	138	2.3	2.6	2.2
					6	94	2.9	2.9	61	3.9	3.3	3	47	5.2	7.0	2.9	134	3.0	3.1	2.0	6	61	3.5	3.9	3.3
					8	53	3.8	3.8	35	5.2	4.4	4	27	6.9	9.3	3.8	75	4.0	4.1	2.7	8	35	4.6	5.2	4.4
					10	34	4.8	4.8	22	6.5	5.5	5	17	8.7	11.6	4.8	48	5.0	5.1	3.4	10	22	5.8	6.5	5.5
	FL	40°	6000	1700	4	116	2.9	2.9	75	4.1	3.4	2	58	3.5	9.6	2.9	164	2.0	3.4	2.1	4	75	2.3	4.1	3.4
					6	51	4.4	4.4	33	6.1	5.0	3	26	5.2	14.5	4.4	73	3.0	5.0	3.1	6	33	3.5	6.1	5.0
					8	29	5.8	5.8	19	8.1	6.7	4	14	6.9	19.3	5.8	41	4.0	6.7	4.1	8	19	4.6	8.1	6.7
					10	19	7.3	7.3	12	10.2	8.4	5	9	8.7	24.1	7.3	26	5.0	8.4	5.1	10	12	5.8	10.2	8.4
					12	13	8.7	8.7	8	12.2	10.1	6	6	10.4	**	8.7	18	6.0	10.1	6.2	12	8	6.9	12.2	10.1

The beam spread in degrees and the beam "L" and "W" in the following tables are computed at 50% of centerbeam candlepower and represent areas of "effective illumination."

\*\*Due to steep aiming angle, length of beam extends beyond 25'.

For additional Lamp Data, reference Juno Lighting Product Guide.

### 24V MR16 HALOGEN LAMPS WITH COVER GLASS

ANSI				
Cat. No.	Code	Watts	Description	Avg. Life (Hrs.)*
TL940-24V	-	35	Q35MR16/CG/NSP/24	1500
TL942-24V	-	35	Q35MR16/CG/NFL/24	1500
TL945-24V	-	50	Q50MR16/CG/NSP/24	1500
TL947-24V	-	50	Q50MR16/CG/FL/24	1500

\*At rated voltage.



1300 S. Wolf Road • Des Plaines, IL 60018 • Phone (847) 827-9880 • Fax (847) 827-2925  
 220 Chrysler Drive • Brampton, Ontario • Canada L6S 6B6 • Phone (905) 792-7335 • Fax (905) 792-0064  
 Visit us at [www.junolightinggroup.com](http://www.junolightinggroup.com)

Printed in U.S.A. ©2009 Juno Lighting, LLC.