



TRAC-MASTER®

Avant Garde

OPEN BACK SPOTLIGHTS

T196, T696, T362, T363 and T368

Project: _____

Fixture Type: _____

Location: _____

Contact/Phone: _____

PRODUCT DESCRIPTION

The clean, functional lines of the open back allows maximum adjustability. Open Back Spotlights relamp from back and have floating socket mount and on/off switch. The minimum profile with stylized yoke design is ideal for retail and commercial applications.

Construction Die-formed steel.

Aiming 90° vertical aiming capability and 358° rotation.

Labels UL listed, CSA certified.

Product specifications subject to change without notice.



Low Voltage MR16

Lamp 12V, 50W maximum MR16 GU5.3/GX5.3 bi-pin.

Socket Ceramic bi-pin.

Transformer Must be ordered separately • Compatible with T537 or T538 12V electronic transformer for halogen lamps ([D1.2.1](#)) • Compatible with T537U universal 12V electronic transformer for LED or halogen lamps ([D1.2.5](#)) • Compatible with T539 12V electronic transformer for halogen lamps ([D1.2.0](#)) • Compatible with T542 or T543 12V magnetic transformer for LED or halogen lamps ([D1.2.0](#)).

Catalog Number	Finish	Lamp
T196WH	White	50W MR16 max.
T196BL	Black	50W MR16 max.
T196SC	Satin Chrome	50W MR16 max.

ACCESSORIES

Cat. No.	Description	Cat. No.	Description	Cat. No.	Description
T551-5	Color Filters	T557	Prismatic Spread Lens	T559	Linear Spread Lens
T5501-18	Dichroic Filters	T5520	Diffusion Lens	T5521	Uniformity Lens
T5522	UV Filter	T5559BL	Hexcell Louver		

See specification sheet [D1.2.2](#) for details.

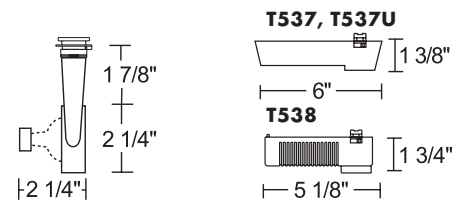

Low Voltage MR16

Lamp 12V, 75W maximum MR16 GU5.3/GX5.3 bi-pin.

Socket Ceramic bi-pin.

Transformer Must be ordered separately • Compatible with T537 or T538 12V electronic transformer for halogen lamps ([D1.2.1](#)) • Compatible with T537U universal 12V electronic transformer for LED or halogen lamps ([D1.2.5](#)) • Compatible with T539 12V electronic transformer for halogen lamps ([D1.2.0](#)) • Compatible with T542 or T543 12V magnetic transformer for LED or halogen lamps ([D1.2.0](#)).

Catalog Number	Finish	Lamp
T696WH	White	75W MR16 max.
T696BL	Black	75W MR16 max.

ACCESSORIES

Cat. No.	Description	Cat. No.	Description	Cat. No.	Description
T551-5	Color Filters	T557	Prismatic Spread Lens	T559	Linear Spread Lens
T5501-18	Dichroic Filters	T5520	Diffusion Lens	T5521	Uniformity Lens
T5522	UV Filter	T5559BL	Hexcell Louver		

See specification sheet [D1.2.2](#) for details.

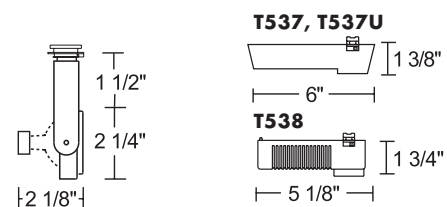

TRAC-MASTER®

Avant Garde

OPEN BACK SPOTLIGHTS**T196, T696 T362, T363 and T368****Line Voltage PAR20****Lamp** 120V, 50W maximum PAR20 medium base.**Socket** Medium base porcelain with nickel plated copper screw shell.

Adapter Copper alloy contacts provide precise spring action - no arcing and will not take a set • True, positive electrical ground • On/off switch included

- Patented embossed polarity arrows on bottom of adapter
- Spring-loaded positive latch with embossed polarity arrows secures trac light to trac
- "Pull-up" contact to up position for two-circuit application.

Catalog Number	Finish	Lamp
T362WH	White	50W PAR20 max.
T362BL	Black	50W PAR20 max.
T362SC	Satin Chrome	50W PAR20 max.

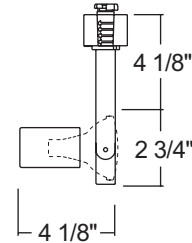
**Line Voltage PAR30****Lamp** 120V, 75W maximum PAR30 medium base.**Socket** Medium base porcelain with nickel plated copper screw shell.**Adapter** Refer to **T362**.

Catalog Number	Finish	Lamp
T363WH	White	75W PAR30 max.
T363BL	Black	75W PAR30 max.
T363SC	Satin Chrome	75W PAR30 max.
T363NA	Natural	75W PAR30 max.

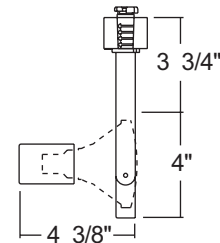
**Line Voltage PAR38****Lamp** 120V, 150W maximum PAR38 medium base.**Socket** Medium base porcelain with nickel plated copper screw shell.**Adapter** Refer to **T362**.

Catalog Number	Finish	Lamp
T368WH	White	150W PAR38 max.
T368BL	Black	150W PAR38 max.
T368SC	Satin Chrome	150W PAR38 max.
T368NA	Natural	150W PAR38 max.

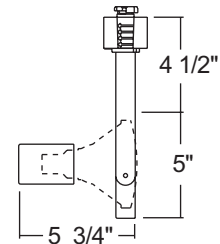
**ACCESSORIES**

Cat. No.	Description	Cat. No.	Description	Cat. No.	Description
T571-6	Color Filters	T579BL	Cube Cell Louver	T5721	Uniformity Lens
T5722	UV Filter	T5777	Prismatic Spread Lens	T5778	Linear Spread Lens
T5718	Color Correction Filter				

See specification sheet [D1.2.2](#) for details.

1300 S. Wolf Road • Des Plaines, IL 60018 • Phone (847) 827-9880 • Fax (847) 827-2925
 220 Chrysler Drive • Brampton, Ontario • Canada L6S 6B6 • Phone (905) 792-7335 • Fax (905) 792-0064
 Visit us at www.junolightinggroup.com

Printed in U.S.A. ©2014 Juno Lighting, LLC.