



TRAC-MASTER®

Classics

UNIVERSALS

T308, T80, T82, T301,
T620, T63, T64, T691 and T359

Project: _____

Fixture Type: _____

Location: _____

Contact/Phone: _____

PRODUCT DESCRIPTION

Universals offer a wide range of lamp options depending on the application.

Socket Medium base porcelain with nickel plated copper screw shell • Socket adjustable for proper lamp positioning (except T359).

Adapter Copper alloy contacts provide precise spring action - no arcing and will not take a set • True, positive electrical ground • On/off switch included
 • Patented embossed polarity arrows on bottom of adapter • Spring-loaded positive latch with embossed polarity arrows secures trac light to trac
 • "Pull-up" contact to up position for two-circuit application.

Labels UL listed, CSA certified.

Product specifications subject to change without notice.



Line Voltage Universal

Construction Drawn steel housing with steel yoke.

Aiming 90° vertical aiming capability and 358° rotation • One locking knob provided.

Catalog Number	Finish	Lamp
T308WH	White	27-50W R20/35-50W PAR20/45-85W BR30/35-75W PAR30/ 65-120W BR40/45-150W PAR38
T308BL	Black	27-50W R20/35-50W PAR20/45-85W BR30/35-75W PAR30/ 65-120W BR40/45-150W PAR38

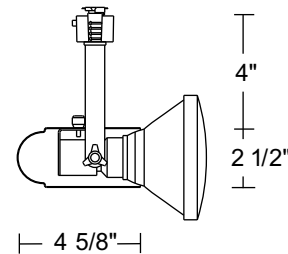

ACCESSORIES

Catalog Number	Finish	Description	Max. Lamp
T63WH	White, Black Baffle	Baffled Hood	75W PAR30L/65W BR30
T63BL	Black, Black Baffle	Baffled Hood	75W PAR30L/65W BR30
T64WH	White, Black Baffle	Baffled Hood	150W PAR38/120W BR40
T64BL	Black, Black Baffle	Baffled Hood	150W PAR38/120W BR40
T80BL	Black	Accordion Collar	65W BR30
T82WH	White, Black Baffle	Flare Reflector	50W R20/PAR20/65W BR30/75W A19

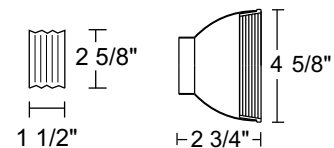
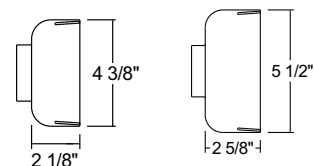

Line Voltage Universal

Construction Steel housing with Lexan® polycarbonate stem.

Aiming 90° vertical aiming capability and 358° rotation.

Catalog Number	Finish	Lamp
T301WH	White	27-50W R20/35-50W PAR20/45-85W BR30/35-75W PAR30/ 65-120W BR40/45-250W PAR38
T301BL	Black	27-50W R20/35-50W PAR20/45-85W BR30/35-75W PAR30/ 65-120W BR40/45-250W PAR38

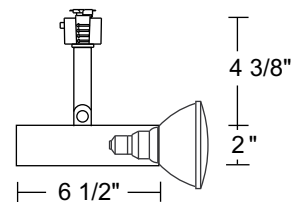

TRAC-MASTER®

Classics UNIVERSALS

T308, T80, T82, T301,
T620, T63, T64, T691 and T359

Economy Line Voltage Universal

Construction Steel housing with steel yoke.

Aiming 90° vertical aiming capability and 358° rotation.

Catalog Number	Finish	Lamp
T620WH	White	27-50W R20/35-50W PAR20/45-85W BR30/35-75W PAR30/ 65-120W BR40/45-150W PAR38
T620BL	Black	27-50W R20/35-50W PAR20/45-85W BR30/35-75W PAR30/ 65-120W BR40/45-150W PAR38

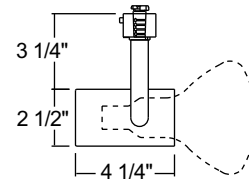

ACCESSORIES

Catalog Number	Finish	Description	Max. Lamp
T63WH	White, Black Baffle	Baffled Hood	75W PAR30/65W BR30
T63BL	Black, Black Baffle	Baffled Hood	75W PAR30/65W BR30
T64WH	White, Black Baffle	Baffled Hood	150W PAR38/120W BR40
T64BL	Black, Black Baffle	Baffled Hood	150W PAR38/120W BR40
T80BL	Black	Accordion Collar	65W BR30
T82WH	White, Black Baffle	Flare Reflector	50W R20/PAR20/65W BR30/75W A19

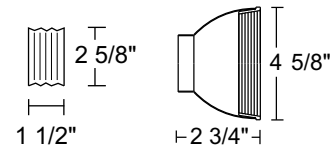
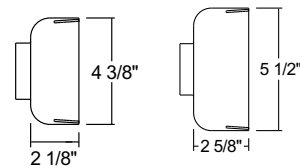

Hi-Tech Mini Swivel Universal

Construction Steel housing with slotted steel swivel.

Aiming 90° vertical aiming capability and 358° rotation • One locking knob provided.

Catalog Number	Finish	Lamp
T691WH	White	45-60W PAR16/35-50W PAR20/35-75W PAR30/45-150W PAR38
T691BL	Black	45-60W PAR16/35-50W PAR20/35-75W PAR30/45-150W PAR38
T691NA	Natural	45-60W PAR16/35-50W PAR20/35-75W PAR30/45-150W PAR38

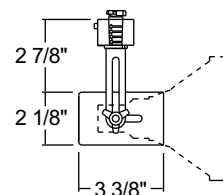

Mini Swivel Universal

Construction Porcelain socket mounted to low profile steel swivel.

Aiming 90° vertical aiming capability and 358° rotation.

Catalog Number	Finish	Lamp
T359WH	White	27-50W R20/35-50W PAR20/45-85W BR30/35-75W PAR30/ 65-120W BR40/45-250W PAR38

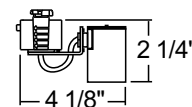

1300 S. Wolf Road • Des Plaines, IL 60018 • Phone (847) 827-9880 • Fax (847) 827-2925
220 Chrysler Drive • Brampton, Ontario • Canada L6S 6B6 • Phone (905) 792-7335 • Fax (905) 792-0064
Visit us at www.junolightinggroup.com

Printed in U.S.A. ©2010 Juno Lighting, LLC.