

PROJECT	TYPE
CATALOG NUMBER (FOR CUSTOM LENGTHS, PLEASE SEE ORDERING EXAMPLE BELOW)	

PRODUCT OVERVIEW

GM Lighting's new take on step lighting has resulted in this extensive collection of modern step lights that fit s standard junction boxes. Available in horizontal and vertical formats, open lensed, vertical and horizontal louvers, and in horizontal scoop formats. Perfect for step lighting, path lighting, deck lighting in stairs, posts or railings,

KEY FEATURES

- 120V
- Suitable for wet location
- No visible mounting hardware
- Mounts to standard J-box (by others)
- Optimized for indoor use
- 145 lumens

ELECTRICAL

- 120V
- Rated life: 50,000 hrs.

OPTICS

- 80+ CRI
- 3000K

CERTIFICATION

- ETL

WARRANTY

- 5 year warranty



Available in open lens
louvered lens (above) and scoop lens
(right) in either
horizontal or vertical formats.



PRODUCT ORDERING

Catalog Number	Format	Wattage	Lumens	CRI	Color Temp*	Finish
GSL-O-B	Horiz. or Vert.	2W	145	80+	3000K	Black
GSL-O-BN	Horiz. or Vert.	2W	145	80+	3000K	Brushed Nickel
GSL-O-WH	Horiz. or Vert.	2W	145	80+	3000K	White
GSL-LH-B	Horiz Louvered	2W	145	80+	3000K	Black
GSL-LH-BN	Horiz Louvered	2W	145	80+	3000K	Brushed Nickel
GSL-LH-WH	Horiz Louvered	2W	145	80+	3000K	White
GSL-LV-B	Vert. Louvered	2W	145	80+	3000K	Black
GSL-LV-BN	Vert. Louvered	2W	145	80+	3000K	Brushed Nickel
GSL-LV-WH	Vert. Louvered	2W	145	80+	3000K	White
GSL-H-B	Horiz. Scoop	2W	145	80+	3000K	Black
GSL-H-BN	Horiz. Scoop	2W	145	80+	3000K	Brushed Nickel
GSL-H-WH	Horiz. Scoop	2W	145	80+	3000K	White
GSL-V-B	Vert. Scoop	2W	145	80+	3000K	Black
GSL-V-BN	Vert. Scoop	2W	145	80+	3000K	Brushed Nickel
GSL-V-WH	Vert. Scoop	2W	145	80+	3000K	White

* Kelvin temperature (color) ±100K.

PRODUCT DIAGRAM

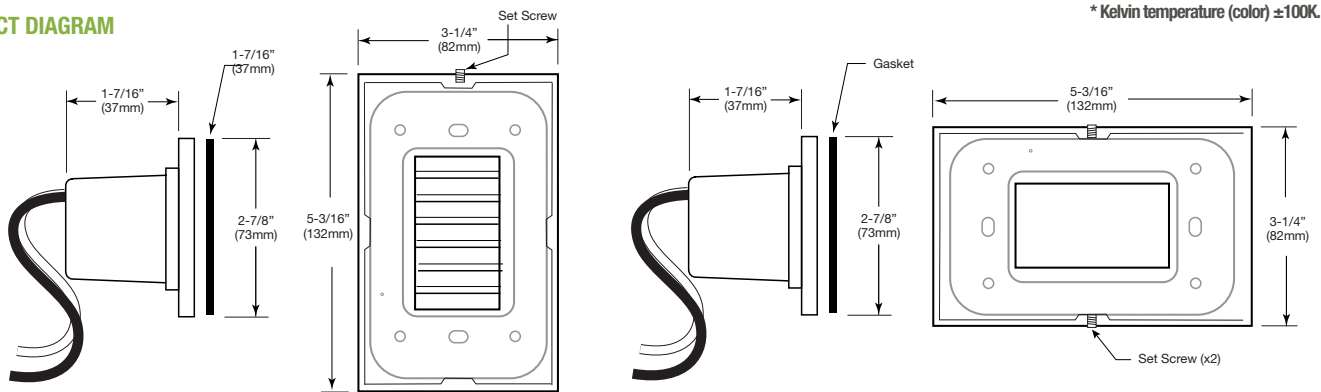

Shown
with Louvered
Lens