

NEER™ Connectors for Nonmetallic Sheathed Cable

NEC/CEC:
Listed for Ordinary Locations

Application

- Open throat type for nonmetallic sheathed cable.

Features

- Furnished with locknut.
- Male hub threads — NPS.

Standard Material/Finish

- Body: zinc diecast
- Clamp: steel/zinc plated
- Screw: steel/zinc plated

NEC/CEC Certifications and Compliances

- UL Standard: 514B
- UL Listed: E25015
- CSA Standard: C22.2 No. 18.3
- CSA Certified: 208044
- NEMA: FB-1

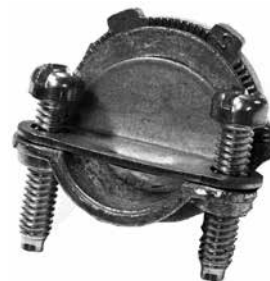

C-500

Illustrated Dimensions

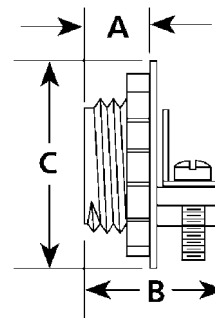

Trade Size (Inches)	Dimensions in Millimeters (Inches)			Nm Cable Range	Catalog Number
	A	B	C		
3/8 (1/2 knockout)	9.1 (0.36)	20.6 (0.81)	23.1 (0.91)	14-2 to 12-2	C-500
3/4	10.7 (0.42)	23.9 (0.94)	30.5 (1.20)	10-3 to 8-2	C-750
1	13.0 (0.51)	28.2 (1.11)	38.4 (1.51)	10-3 to 4-2	C-1001-R

Note:

- All connectors listed for use with a single cable only except for the C-500 which is also listed for use with two 14-2 AWG or two 12-2 AWG NM cables. C-500 also listed for flexible cord with a diameter range of 0.29in./ 7.4mm. to 0.45in./11.4mm.