

# Non-illuminated Selector Switches, 2-position

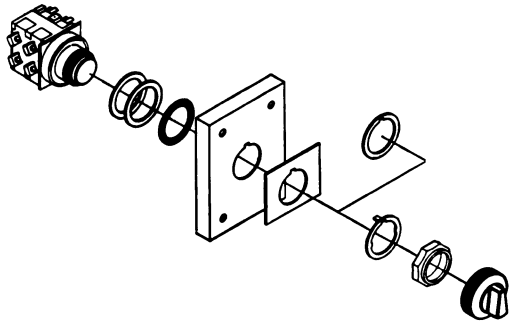

- Knob**
  - Interchangeable design
  - 5 colors: red, green, yellow, blue, black + levers in black and chrome for gloved-hand operation
- Operator With Cam**
  - 2-position forms
  - Multiple cam configurations allow optimum versatility
  - Maintained and spring return forms
- Contact Blocks**
  - Color coded for quick installation
  - Maximum of 6 single or 6 double contact blocks
  - Visible contacts for easy, accurate inspections
  - Special applications: gold flashed, reed switch

## Accessories

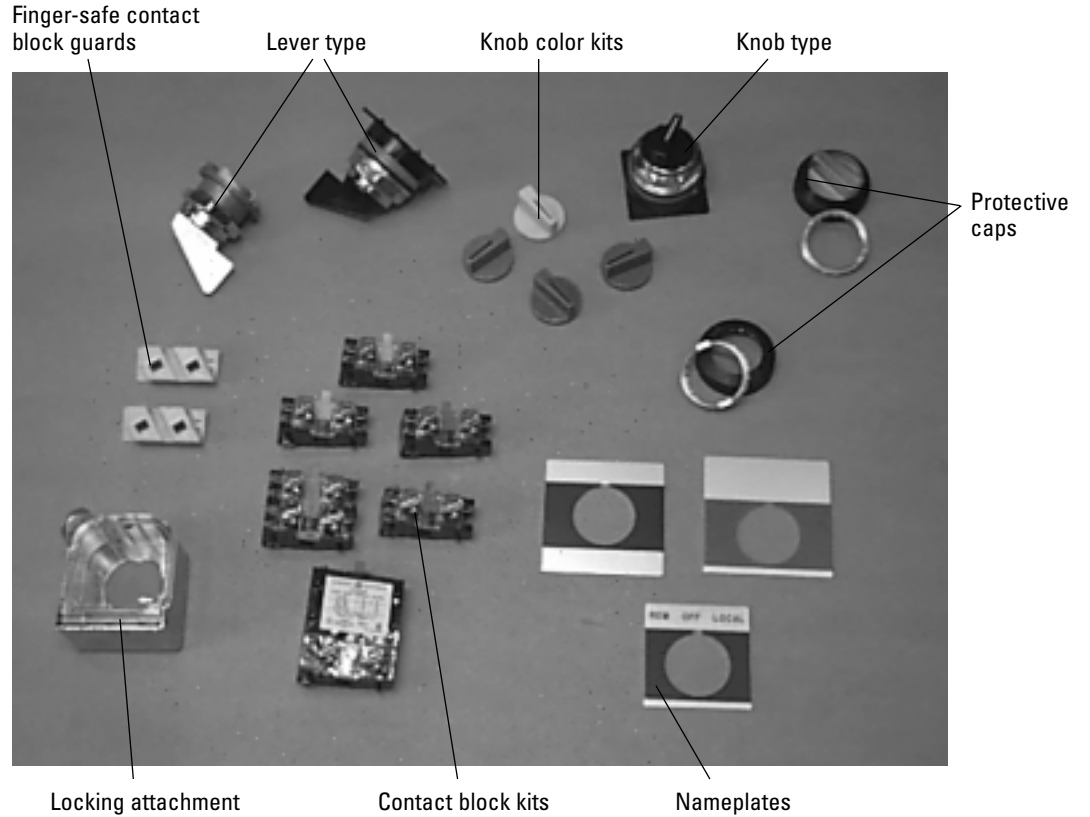

## Non-illuminated Selector Switches, 2-position

Type		Operation & Cam			Color		Contacts		Key Removal	Key Type
<b>C</b>	<b>R</b>	<b>1</b>	<b>0</b>	<b>4</b>	<b>P</b>	<b>S</b>				Used only with key-operated selector switches

**G** = Knob-operated  
**M** = Lever-operated  
**K** = Key-operated

**12** = Spring Return From Left  
**21** = Maintained  
**63** = Spring Return From Right

**Blank** = None  
**00** = None (Key-operated only)  
**91** = 1NO/1NC  
**92** = 2NO/2NC

**Blank** = Standard  
**51** = CH501

**A** = Chrome  
**B** = Black  
**E** = Yellow  
**G** = Green  
**L** = Blue  
**R** = Red

Availability		
Knob	Lever	Key
■	■	■
■	■	
■		
■		
■		

Key removal  
**C** = ↑  
**L** = ↖  
**M** = ↖ ↗  
**R** = ↗

Availability	
Maintained	Spring return to center ↑
	■
■	
■	
■	

### Operation & Cam

Operation	Operator Position			Type Of Contact	Contact Mounting Position
	Left ↖	Center ↑	Right ↗		
Spring return from left (12)	0	X		NC	Left or Right
	X	0		NO	Left or Right
Maintained (21)	X		0	NC	Left or Right
	0		X	NO	Left or Right
Spring return from right (63)		X	0	NC	Left or Right
		0	X	NO	Left or Right

**Note:** When using double contact block 91, NC contact is that closest to and mounted on the left side of the operator. When using double contact block 92, NC contact is that closest to the operator on each side.

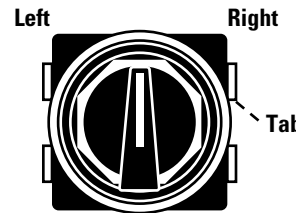

Always view left-right facing operator

**Tip for Quick Service:** For small quantity orders of 2-position selector switches with contact configurations other than 91 or 92, order operator and contact blocks separately. Cam 12 is normally stocked with black knob; cam 21 is normally stocked with black knob or chrome lever.

# Technical Data

## General specifications

<b>Standards &amp; approvals</b>	<b>UL Listed</b> - File Number E2403 <b>CSA Certified</b> - LR15492, Class 321103 <b>NEMA</b> - ICS2 - 1988 <b>IEC</b> 947.5.1 <b>VDE</b> 0660		
<b>Enclosure ratings</b>	All units are suitable for use in <b>NEMA Type 1, 3, 3R, 3S, 4, 4X, 12 and 13</b> applications when mounted in enclosures rated for those same applications. For some NEMA 4X applications, protective caps will provide improved corrosion resistance.		
<b>Finger protection at terminals</b>	<b>IP2X</b> according to IEC 529 Terminal identification per <b>CENELEC EN 50013</b>		
<b>Temperature range</b>	<u>Operating</u> -25° to +70° C -13° to +158° F	<u>Storage</u> -40° to +70° C -40° to 158° F	
<b>Climate suitability/humidity</b>	<u>Climate Type</u> Temperate Wet Hot Wet Variable Wet	<u>Temperature</u> 74°F (23°C) 74°F (23°C) 104°F (40°C) 74°-104v F (23° to 40° C)	<u>Relative Humidity</u> 50% 83% 92% 83%-92%
<b>Shock and vibration</b>	<b>Resistance to shock</b> - 50g, 11ms <b>Frequency range</b> - 1-100 Hz <b>Vibration amplitude</b> - 1-13.2 Hz - displacement ±1mm 13.2-100 Hz - acceleration ±0.7g		
<b>Operating force</b>		<u>Standard recessed push buttons</u>	<u>Standard flush push buttons</u>
	Without contact blocks	1.625 lbf	2.5 lbf
	With 1NO contact block	2.5 lbf	2.875 lbf
	With 2 NO contact blocks	3.5 lbf	3.5 lbf
	With 3 NO contact blocks	4.0 lbf	4.375 lbf
<b>Wire size</b>	22-12 AWG stranded or solid copper wire		
<b>Torque requirements</b>	Terminal screws: 10-14 in-lbs Contact block mounting screws: 10-14 in-lbs		