

ONE HOLE HYLUG™ CODE CONDUCTOR STANDARD BARREL (Continued)

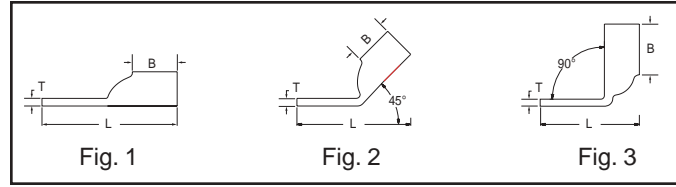
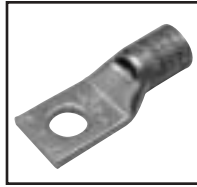

C-12

Catalog Number	Fig #	Conductor		Stud Hole Size	Tongue Width	Figure Dimensions			▲ Installation Tooling						Wire Strip Length
		AWG	MM ²			(B)	(T)	Dieless (# of crimps)	Mechanical	Hydraulic		Color Code	Die Index		
									MD6, OUR840, MD7-34R	BCT500HS, Y500CTHS	Y35, Y39, Y750, Y46*, PAT750				
YA28L2-90	3	4/0 AWG		1/4"	1.02"	.88"	.14"	1.04"	MY29-3 (1) MY29-11 (1) MRC840 (2) Y644M (1)	W28VT (2) W28RT (2) X28RT (2)	W28VT (2) W28RT (2) X28RT (3)	U28RT (1)	Purple	15	1-1/8"
YA28L3-BOX	1			5/16"	1.02"	.88"	.14"	2.08"							
YA28L3-45	2							2.01"							
YA28L3-90	3			3/8"	1.02"	.88"	.14"	1.16"							
YA28L4-BOX	1							2.21"							
YA28L4-45	2							2.14"							
YA28L4-90	3			3/4"	1.05"	.88"	.13"	1.29"							
YA28L56-BOX	1							2.90"							
YA28L56-45	2			1/2"	1.02"	.88"	.14"	2.81"							
YA28L56-90	3							1.97"							
YA28L-BOX	1							2.46"							
YA28L-45	2			3/8"	.76"	.88"	.16"	2.39"							
YA28L-90	3							1.54"							
YA28LNT38	1					2.79"									
YA29L2	1	250 kcmil		1/4"	1.11"	1.06"	.16"	2.17"	MY29-3 (1) MY29-11 (1) Y644M (1)	W29VT (2) X29RT (4)	W29VT (2) W29RT (2) X29RT (4)	U29RT (1)	Yellow	16	1-1/8"
YA29L2-45	2			3/8"	1.11"	1.06"	.16"	2.07"							
YA29L2-90	3							1.08"							
YA29L4	1			5/16"	1.11"	1.06"	.16"	2.42"							
YA29L4-45	2							2.32"							
YA29L4-90	3							1.33"							
YA29L7	1			7/8"	1.11"	1.06"	.14"	2.30"							
YA29L7-45	2							2.20"							
YA29L7-90	3			3/8"	.96"	1.06"	.16"	1.20"							
YA29LTC78	1							3.36"							
YA29LTC78-45	2			1/2"	1.11"	1.06"	.16"	3.23"							
YA29LTC78-90	3							2.26"							
YA29LNT38								2.96"							
YA29L-BOX	1					2.67"									
YA29L-45	2					2.57"									
YA29L-90	3					1.58"									
YA30L	1	300 kcmil	150	1/2"	1.20"	1.03"	.16"	2.69"	Y644M (1)	W30VT (2)	W30VT (2) W30RT (2)	U30RT (2) U28ART (2)	White	17	1-1/16"
YA30L-45	2			5/16"	1.20"	1.03"	.16"	2.60"							
YA30L-90	3							1.61"							
YA30L1	1			3/8"	1.20"	1.03"	.16"	2.31"							
YA30L1-45	2							2.22"							
YA30L1-90	3							1.24"							
YA30L24	1			7/8"	1.20"	1.03"	.16"	2.44"							
YA30L24-45	2							2.35"							
YA30L24-90	3			3/4"	1.20"	1.03"	.16"	1.36"							
YA30L27	1							3.37"							
YA30L27-45	2			5/8"	1.20"	1.03"	.16"	3.29"							
YA30L27-90	3							2.30"							
YA30L28	1			3/4"	1.20"	1.03"	.16"	3.12"							
YA30L7	1	2.94"													
YA30L7-45	2	1/2"	1.29"	1.06"	.18"	2.85"									
YA30L7-90	3					1.86"									
YA31L	1					2.75"									
YA31L-45	2					2.75"									
YA31L-90	3					1.65"									

* Use PUADP-1 adapter with "U" dies in Y46 HYPRESS™.
** P-RT die sets for use in Y46 HYPRESS™ only, PUADP-1 adapter not required.

*** The MM² conductor sizes listed are the recommendations for Class 2 conductor.
▲ See tooling section of this catalog for complete tool and die listings.

◆ For applications greater than 2000 Volts, consult cable manufacturer for voltage stress relief instructions.