

FEATURES & SPECIFICATIONS

INTENDED USE — Typical applications include corridors, lobbies, conference rooms and private offices.
CONSTRUCTION — Galvanized steel mounting/plaster frame; galvanized steel junction box with bottom-hinged access covers and spring latches. Reflectors are retained by torsion springs.

Vertically adjustable mounting brackets with commercial bar hangers provide 3-3/4" total adjustment. Two combination 1/2"-3/4" and four 1/2" knockouts for straight-through conduit runs. Capacity: 8 (4 in, 4 out). No. 12 AWG conductors, rated for 90°C.

Accommodates 12"-24" joist spacing.

Passive cooling thermal management for 25°C standard; high ambient (40°C) option available. Light engine and drivers are accessible from above or below ceiling.

Max ceiling thickness 1-1/2".

OPTICS — LEDs are binned to a 3-step SDCM; 80 CRI minimum.

LED light source concealed with diffusing optical lens.

General illumination lighting with 1.0 S/MH and 55° cutoff to source and source image.

Self-flanged anodized reflectors in specular, semi-specular, or matte diffuse finishes. Also available in white and black painted reflectors.

ELECTRICAL — Multi-volt (120-277V, 50/60Hz) 0-10V dimming drivers mounted to junction box, 10% or 1% minimum dimming level available.

0-10V dimming fixture requires two (2) additional low-voltage wires to be pulled.

70% lumen maintenance at 50,000 hours.

LISTINGS — Certified to US and Canadian safety standards. Damp location standard (wet location, covered ceiling optional). ENERGY STAR® certified product.

WARRANTY — 5-year limited warranty. Complete warranty terms located at:

www.acuitybrands.com/CustomerResources/Terms_and_conditions.aspx

Note: Actual performance may differ as a result of end-user environment and application.

All values are design or typical values, measured under laboratory conditions at 25 °C.

Specifications subject to change without notice.

| |
|----------------|
| Catalog Number |
| Notes |
| Type |

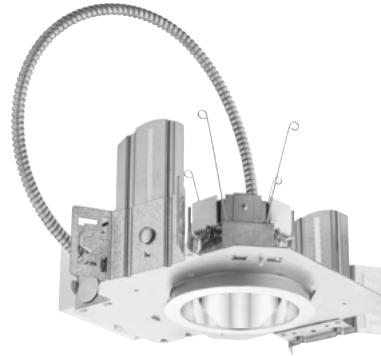

LDN4

**4" OPEN
Non-IC
New Construction Downlight**



A+ Capable options indicated by this color background.

ORDERING INFORMATION

Lead times will vary depending on options selected. Consult with your sales representative.

Example: LDN4 35/15 L04AR LSS MVOLT EZ1

| LDN4 Series | Color temperature | Lumens ¹ | Aperture/Trim Color | | Finish | Voltage |
|---------------|-------------------|---------------------|---------------------|-----------|-----------------------|-----------------------|
| LDN4 4" round | 27/ 2700K | 05 500 lumens | L04 | Downlight | AR Clear | MVOLT Multi-volt |
| | 30/ 3000K | 10 1000 lumens | LW4 | Wallwash | WR ² White | 120 120V |
| | 35/ 3500K | 15 1500 lumens | | | BR ² Black | 277 277V |
| | 40/ 4000K | 20 2000 lumens | | | | 347 ³ 347V |
| | 40/ 4000K | 25 2500 lumens | | | | |
| | 50/ 5000K | 30 3000 lumens | | | | |

| Driver | Options | |
|---|------------------------|--|
| GZ10 0-10V driver dims to 10% | SF ⁴ | Single fuse |
| GZ1 0-10V driver dims to 1% | TRW ⁵ | White painted flange |
| EZ10 0-10V eldoLED driver with smooth and flicker-free deep dimming performance down to 10% | TRBL ⁵ | Black painted flange |
| | EL ⁴ | Emergency battery pack with integral test switch |
| EZ1 0-10V eldoLED driver with smooth and flicker-free deep dimming performance down to 1% | ELR ⁴ | Emergency battery pack with remote test switch |
| | ELSD | Emergency battery pack with self-diagnostics, integral test switch |
| | ELRSD | Emergency battery pack with self-diagnostics, remote test switch |
| | E10WCP | Emergency battery pack, 10W Constant Power, CA Title 20 compliant with integral test switch |
| | E10WCPR | Emergency battery pack, 10W Constant Power, CA Title 20 compliant with remote test switch |
| | NPP16D ⁶ | nLight® network power/relay pack with 0-10V dimming for non-eldoLED drivers (GZ10, GZ1). |
| | NPP16DER ⁶ | nLight® network power/relay pack with 0-10V dimming for non-eldoLED drivers (GZ10, GZ1). ER controls fixtures on emergency circuit. |
| | N80 ⁷ | nLight™ Lumen Compensation |
| | NPS80EZ ⁶ | nLight® dimming pack controls 0-10V eldoLED drivers (EZ10, EZ1). |
| | NPS80EZER ⁶ | nLight® dimming pack controls 0-10V eldoLED drivers (EZ10, EZ1). ER controls fixtures on emergency circuit. |
| | HAO ¹⁰ | High ambient option (40°C) |
| | CP ¹¹ | Chicago Plenum |
| | WL | Wet Location, specify for exterior use applications |
| | RRL___ | RELOC®-ready luminaire connectors enable a simple and consistent factory installed option across all ABL luminaire brands. Refer to RRL for complete nomenclature. Available only in RRLA, RRLB, RRLAE, and RRLC12S. |
| | NLTAIR2 ⁹ | nLight® Air enabled |
| | NLTAIRER2 ⁹ | nLight® AIR Dimming Pack Wireless Controls. Controls fixtures on emergency circuit |
| | USPOM | US point of manufacture |

Notes

- Overall height varies based on lumen package; refer to dimensional chart on page 3.
- Not available with finishes.
- Not available with emergency options.
- Must specify voltage 120V or 277V.
- Available with clear (AR) reflector only.
- Specify voltage. ER for use with generator supply EM power. Will require an emergency hot feed and normal hot feed.
- Fixture begins at 80% light level. Must be specified with NPS80EZ or NPS80EZ ER. Only available with EZ10 and EZ1 drivers.
- Not available with CP, NPS80EZ, NPS80EZER, NPP16D, NPP16DER or N80 options.
- NLTAIR2 and NLTAIRER2 not recommended for metal ceiling installations.
- Fixture height is 5-11/16" for all lumen packages with HAO.
- Must specify voltage for 3000lm.

LDN4

PHOTOMETRY

| Distribution Curve | Distribution Data | Output Data | Coefficient of Utilization | Illuminance Data at 30" Above Floor for a Single Luminaire |
|--------------------|-------------------|-------------|----------------------------|--|
|--------------------|-------------------|-------------|----------------------------|--|

LDN4 35/10 L04AR, input watts: 12.69, delivered lumens: 1025.1, LM/W = 80.78, spacing criterion at 0= 1.04, test no. ISF 30712P31.

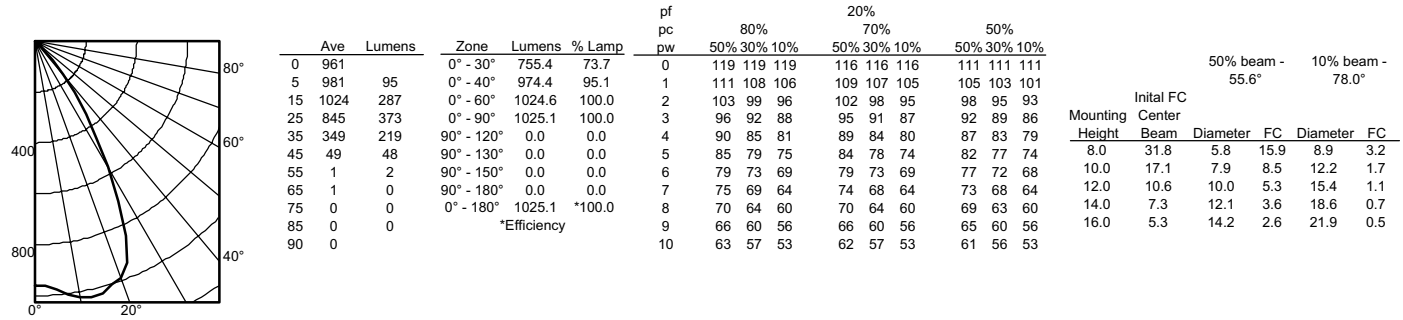

LDN4 35/15 L04AR, input watts: 20.44, delivered lumens: 1443.8, LM/W = 70.63, spacing criterion at 0= 1.04, test no. ISF 30712P28.

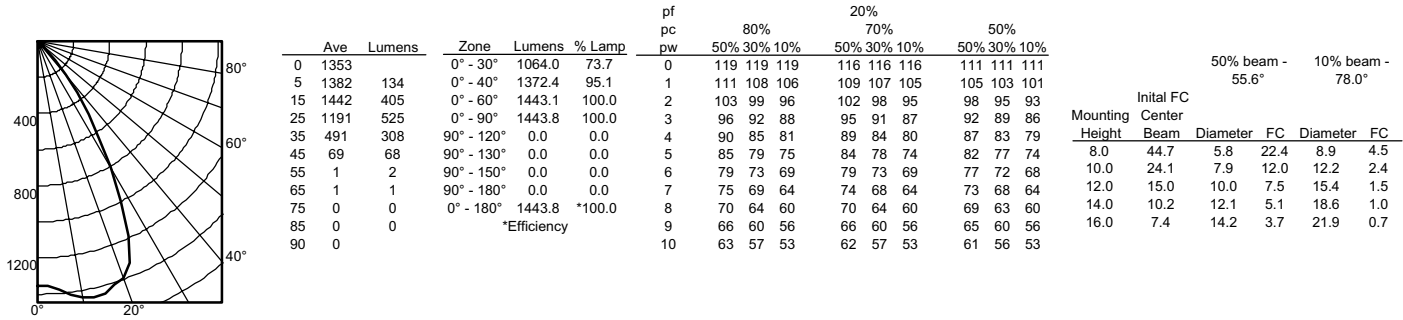

LDN4 35/20 L04AR, input watts: 22.52, delivered lumens: 1993.5, LM/W = 88.52, spacing criterion at 0= 1.04, test no. ISF 30712P25.

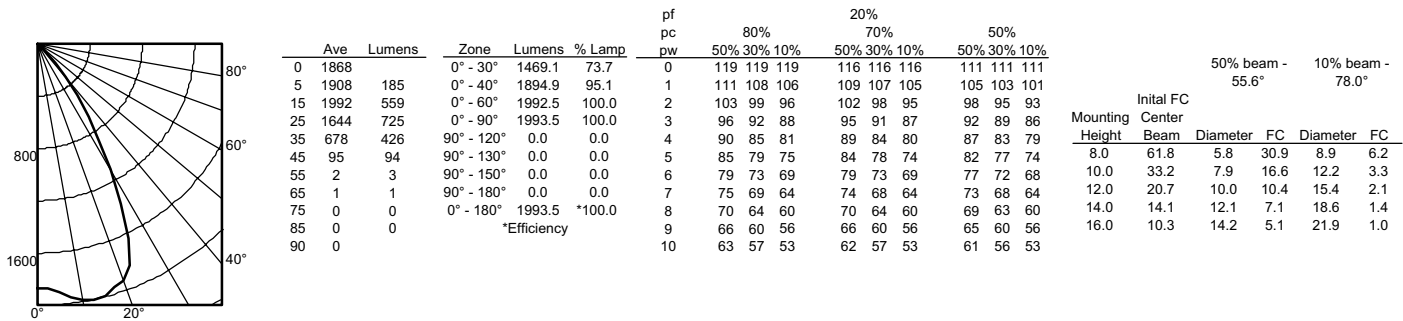

Accessories: Order as separate catalog numbers (shipped separately).

SCA4 Sloped ceiling adapter.
Degree of slope must be specified (5D, 10D, 15D, 20D, 25D, 30D). Refer to [TECH-190](#).

LDN4

* All dimensions are inches (centimeters) unless otherwise noted.

LDN4 1500 LUMEN

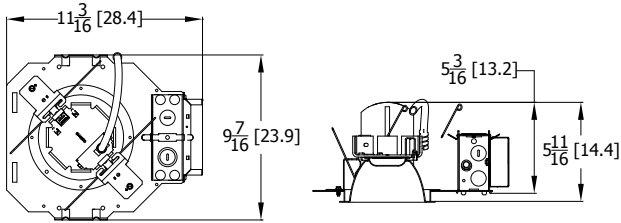

Aperture: 4-5/16 (11)
 Ceiling Opening: 5-1/8 (13)
 Overlap trim: 5-7/16 (13.8)

LDN4 3000 LUMEN

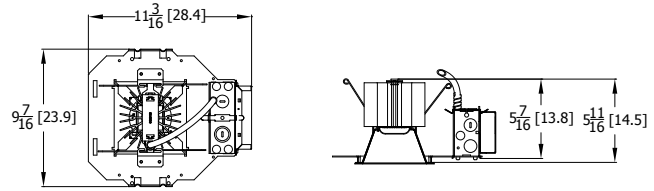

Aperture: 4-5/16 (11) Square
 Ceiling Opening: 5-1/8 (13) Square
 Overlap trim: 5-7/16 (13.8) Square

LDN4 CP

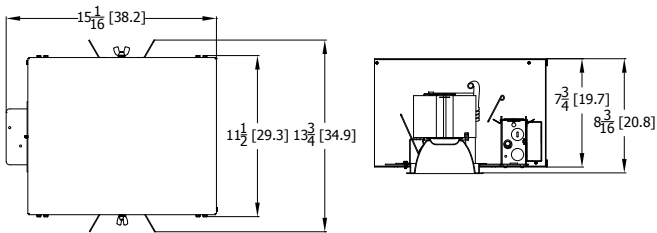

Aperture: 4-5/16 (11)
 Ceiling Opening: 5-1/8 (13)
 Overlap trim: 5-7/16 (13.8)

LDN4 EL-ELR

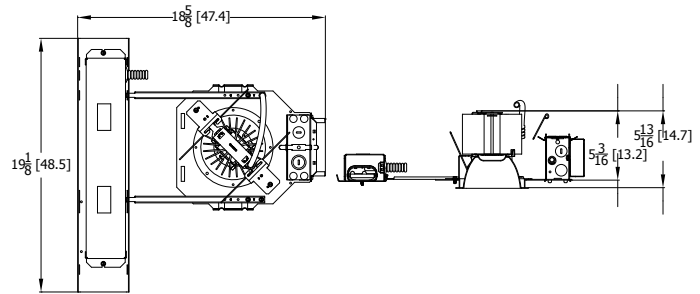

Aperture: 4-5/16 (11)
 Ceiling Opening: 5-1/8 (13)
 Overlap trim: 5-7/16 (13.8)

| LDN4 | | | |
|--------------|----------------|---------|------|
| Target Lumen | Lumens @ 3500K | Wattage | LPW |
| 500 | 688.8 | 8.5 | 80.8 |
| 1000 | 1025.1 | 12.7 | 80.7 |
| 1500 | 1443.8 | 20.4 | 70.8 |
| 2000 | 1993.5 | 22.5 | 88.6 |
| 2500 | 2659.0 | 30.1 | 88.3 |
| 3000 | 2860.1 | 34.8 | 82.2 |

HOW TO ESTIMATE DELIVERED LUMENS IN EMERGENCY MODE

Use the formula below to estimate the delivered lumens in emergency mode

Delivered Lumens = 1.25 x P x LPW

P = Output power of emergency driver. P = 10W for PS1055CP

LPW = Lumen per watt rating of the luminaire. This information is available on the ABL luminaire spec sheet.

The LPW rating is also available at Designlight Consortium.

| LUMEN OUTPUT MULTIPLIERS - CCT | | | | | |
|--------------------------------|-------|-------|-------|-------|-------|
| | 2700K | 3000K | 3500K | 4000K | 5000K |
| 80CRI | 0.950 | 0.966 | 1.000 | 1.025 | 1.101 |

| LUMEN OUTPUT MULTIPLIERS - FINISH | | | |
|-----------------------------------|------------|------------|------------|
| | Clear (AR) | White (WR) | Black (BR) |
| Specular (LS) | 1.0 | N/A | N/A |
| Semi-specular (LSS) | 0.950 | N/A | N/A |
| Matte diffuse (LD) | 0.85 | N/A | N/A |
| Painted | N/A | 0.87 | 0.73 |

Notes

- Tested in accordance with IESNA LM-79-08.
- Tested to current IES and NEMA standards under stabilized laboratory conditions.
- CRI: 80 typical.