

## FEATURES & SPECIFICATIONS

**INTENDED USE** — Typical applications include corridors, lobbies, conference rooms and private offices.  
**CONSTRUCTION** — Galvanized steel mounting/plaster frame; galvanized steel junction box with bottom-hinged access covers and spring latches. Reflectors are retained by torsion springs.

Vertically adjustable mounting brackets with commercial bar hangers provide 3-3/4" total adjustment. Two combination 1/2"-3/4" and four 1/2" knockouts for straight-through conduit runs. Capacity: 8 (4 in, 4 out). No. 12 AWG conductors, rated for 90°C.

Accommodates 12"-24" joist spacing.

Passive cooling thermal management for 25°C standard; high ambient (40°C) option available. Light engine and drivers are accessible from above or below ceiling.

Max ceiling thickness 1-1/2".

**OPTICS** — LEDs are binned to a 3-step SDCM; 80 CRI minimum.

LED light source concealed with diffusing optical lens.

General illumination lighting with 1.0 S/MH and 55° cutoff to source and source image.

Self-flanged anodized reflectors in specular, semi-specular, or matte diffuse finishes. Also available in white and black painted reflectors.

**ELECTRICAL** — Multi-volt (120-277V, 50/60Hz) 0-10V dimming drivers mounted to junction box, 10% or 1% minimum dimming level available.

0-10V dimming fixture requires two (2) additional low-voltage wires to be pulled.

70% lumen maintenance at 50,000 hours.

**LISTINGS** — Certified to US and Canadian safety standards. Damp location standard (wet location, covered ceiling optional). ENERGY STAR® certified product.

**WARRANTY** — 5-year limited warranty. Complete warranty terms located at:

[www.acuitybrands.com/CustomerResources/Terms\\_and\\_conditions.aspx](http://www.acuitybrands.com/CustomerResources/Terms_and_conditions.aspx)

**Note:** Actual performance may differ as a result of end-user environment and application.

All values are design or typical values, measured under laboratory conditions at 25 °C.

Specifications subject to change without notice.

Catalog Number
Notes
Type

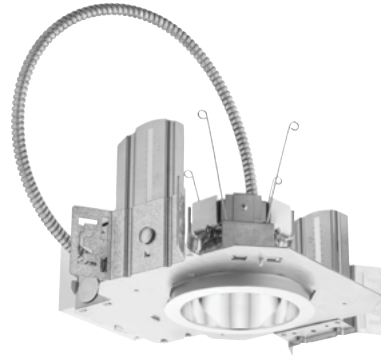

# LDN4

**4" OPEN  
Non-IC  
New Construction Downlight**



A+ Capable options indicated by this color background.

### ORDERING INFORMATION

Lead times will vary depending on options selected. Consult with your sales representative.

**Example:** LDN4 35/15 L04AR LSS MVOLT EZ1

LDN4 Series	Color temperature	Lumens <sup>1</sup>	Aperture/Trim Color		Finish	Voltage				
LDN4 4" round	27/ 2700K	05 500 lumens	L04	Downlight	AR	Clear	LSS	Semi-specular	MVOLT	Multi-volt
	30/ 3000K	10 1000 lumens	LW4	Wallwash	WR <sup>2</sup>	White	LD	Matte diffuse	120	120V
	35/ 3500K	15 1500 lumens			BR <sup>2</sup>	Black	LS	Specular	277	277V
	40/ 4000K	20 2000 lumens							347 <sup>3</sup>	347V
	40/ 4000K	20 2000 lumens								
	50/ 5000K	25 2500 lumens								
	30 3000 lumens									

Driver	Options	
GZ10 0-10V driver dims to 10%	SF <sup>4</sup>	Single fuse
GZ1 0-10V driver dims to 1%	TRW <sup>5</sup>	White painted flange
EZ10 0-10V eldoLED driver with smooth and flicker-free deep dimming performance down to 10%	TRBL <sup>5</sup>	Black painted flange
	EL <sup>4</sup>	Emergency battery pack with integral test switch
EZ1 0-10V eldoLED driver with smooth and flicker-free deep dimming performance down to 1%	ELR <sup>4</sup>	Emergency battery pack with remote test switch
	ELSD	Emergency battery pack with self-diagnostics, integral test switch
	ELRSD	Emergency battery pack with self-diagnostics, remote test switch
	E10WCP	Emergency battery pack, 10W Constant Power, CA Title 20 compliant with integral test switch
	E10WCPR	Emergency battery pack, 10W Constant Power, CA Title 20 compliant with remote test switch
	NPP16D <sup>6</sup>	nLight® network power/relay pack with 0-10V dimming for non-eldoLED drivers (GZ10, GZ1).
	NPP16DER <sup>6</sup>	nLight® network power/relay pack with 0-10V dimming for non-eldoLED drivers (GZ10, GZ1). ER controls fixtures on emergency circuit.
	N80 <sup>7</sup>	nLight™ Lumen Compensation
	NPS80EZ <sup>6</sup>	nLight® dimming pack controls 0-10V eldoLED drivers (EZ10, EZ1).
	NPS80EZER <sup>6</sup>	nLight® dimming pack controls 0-10V eldoLED drivers (EZ10, EZ1). ER controls fixtures on emergency circuit.
	HAO <sup>10</sup>	High ambient option (40°C)
	CP <sup>11</sup>	Chicago Plenum
	WL	Wet Location, specify for exterior use applications
	RRL___	RELOC®-ready luminaire connectors enable a simple and consistent factory installed option across all ABL luminaire brands. Refer to RRL for complete nomenclature. Available only in RRLA, RRLB, RRLAE, and RRLC12S.
	NLTAIR2 <sup>9</sup>	nLight® Air enabled
	NLTAIRER2 <sup>9</sup>	nLight® AIR Dimming Pack Wireless Controls. Controls fixtures on emergency circuit
	USPOM	US point of manufacture

#### Notes

- Overall height varies based on lumen package; refer to dimensional chart on page 3.
- Not available with finishes.
- Not available with emergency options.
- Must specify voltage 120V or 277V.
- Available with clear (AR) reflector only.

- Specify voltage. ER for use with generator supply EM power. Will require an emergency hot feed and normal hot feed.
- Fixture begins at 80% light level. Must be specified with NPS80EZ or NPS80EZ ER. Only available with EZ10 and EZ1 drivers.
- Not available with CP, NPS80EZ, NPS80EZER, NPP16D,

- NPP16DER or N80 options.
- NLTAIR2 and NLTAIRER2 not recommended for metal ceiling installations.
- Fixture height is 5-11/16" for all lumen packages with HAO.
- Must specify voltage for 3000lm.

PHOTOMETRY

Distribution Curve	Distribution Data	Output Data	Coefficient of Utilization	Illuminance Data at 30" Above Floor for a Single Luminaire
--------------------	-------------------	-------------	----------------------------	------------------------------------------------------------

LDN4 35/10 L04AR, input watts: 12.69, delivered lumens: 1025.1, LM/W = 80.78, spacing criterion at 0= 1.04, test no. ISF 30712P31.

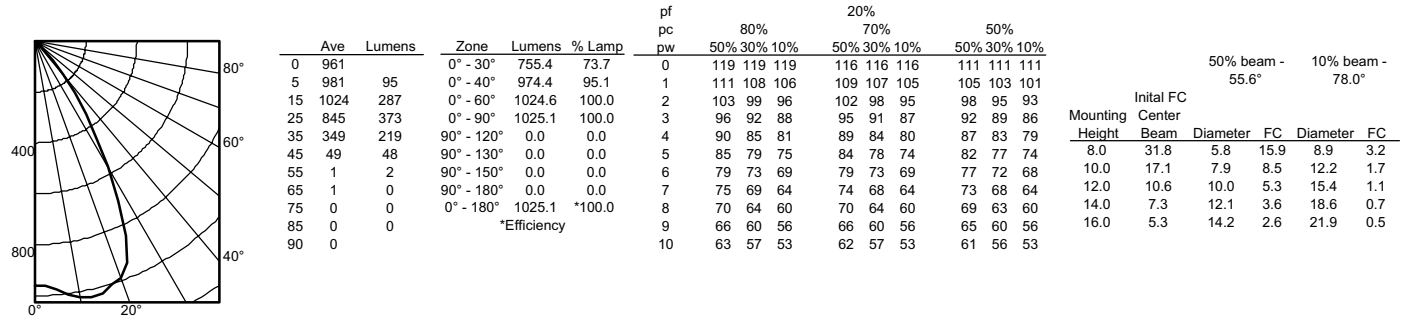

LDN4 35/15 L04AR, input watts: 20.44, delivered lumens: 1443.8, LM/W = 70.63, spacing criterion at 0= 1.04, test no. ISF 30712P28.

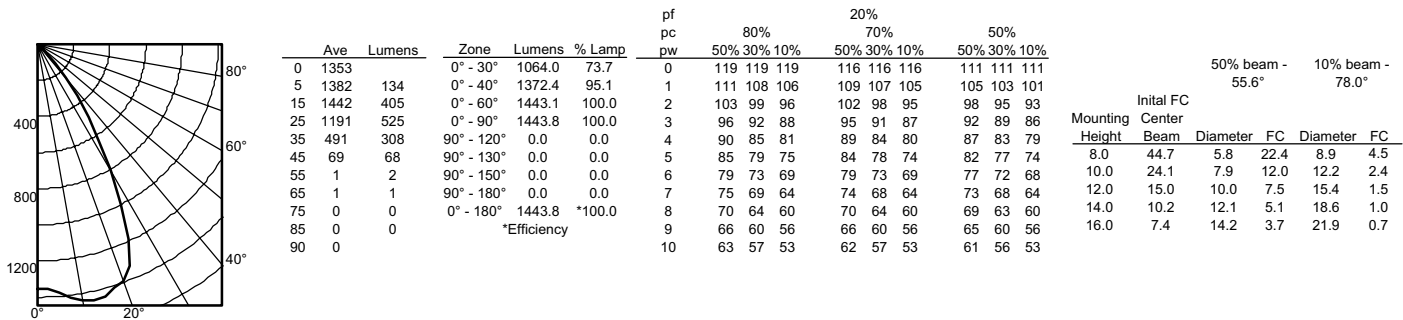

LDN4 35/20 L04AR, input watts: 22.52, delivered lumens: 1993.5, LM/W = 88.52, spacing criterion at 0= 1.04, test no. ISF 30712P25.

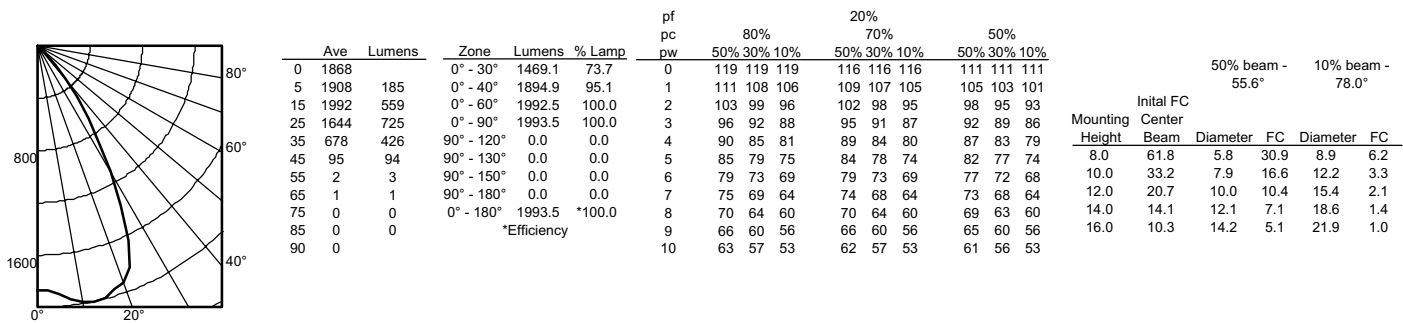

**Accessories:** Order as separate catalog numbers (shipped separately).

SCA4 Sloped ceiling adapter.  
Degree of slope must be specified (5D, 10D, 15D, 20D, 25D, 30D). Refer to [TECH-190](#).

# LDN4

\* All dimensions are inches (centimeters) unless otherwise noted.

**LDN4 1500 LUMEN**

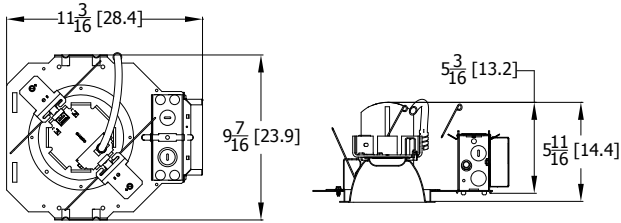

Aperture: 4-5/16 (11)  
Ceiling Opening: 5-1/8 (13)  
Overlap trim: 5-7/16 (13.8)

**LDN4 3000 LUMEN**

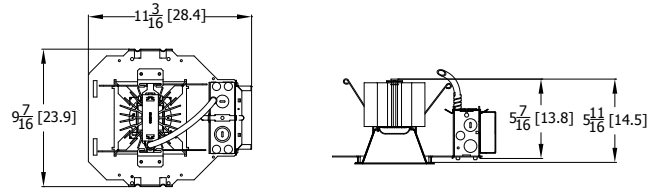

Aperture: 4-5/16 (11) Square  
Ceiling Opening: 5-1/8 (13) Square  
Overlap trim: 5-7/16 (13.8) Square

**LDN4 CP**

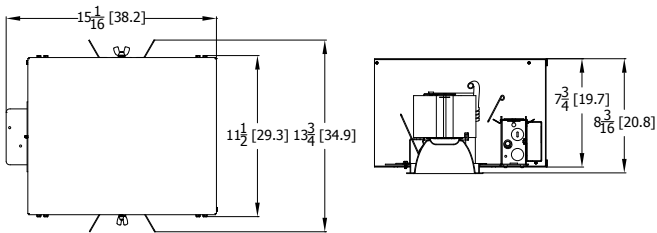

Aperture: 4-5/16 (11)  
Ceiling Opening: 5-1/8 (13)  
Overlap trim: 5-7/16 (13.8)

**LDN4 EL-ELR**

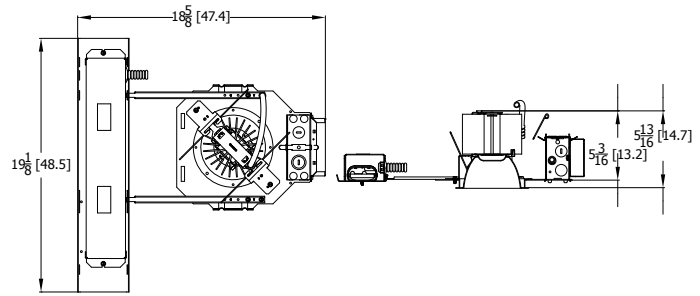

Aperture: 4-5/16 (11)  
Ceiling Opening: 5-1/8 (13)  
Overlap trim: 5-7/16 (13.8)

LDN4			
Target Lumen	Lumens @ 3500K	Wattage	LPW
500	688.8	8.5	80.8
1000	1025.1	12.7	80.7
1500	1443.8	20.4	70.8
2000	1993.5	22.5	88.6
2500	2659.0	30.1	88.3
3000	2860.1	34.8	82.2

## HOW TO ESTIMATE DELIVERED LUMENS IN EMERGENCY MODE

Use the formula below to estimate the delivered lumens in emergency mode

**Delivered Lumens = 1.25 x P x LPW**

P = Output power of emergency driver. P = 10W for PS1055CP

LPW = Lumen per watt rating of the luminaire. This information is available on the ABL luminaire spec sheet.

The LPW rating is also available at [Designlight Consortium](http://Designlight Consortium).

LUMEN OUTPUT MULTIPLIERS - CCT					
	2700K	3000K	3500K	4000K	5000K
80CRI	0.950	0.966	1.000	1.025	1.101

LUMEN OUTPUT MULTIPLIERS - FINISH			
	Clear (AR)	White (WR)	Black (BR)
Specular (LS)	1.0	N/A	N/A
Semi-specular (LSS)	0.950	N/A	N/A
Matte diffuse (LD)	0.85	N/A	N/A
Painted	N/A	0.87	0.73

### Notes

- Tested in accordance with IESNA LM-79-08.
- Tested to current IES and NEMA standards under stabilized laboratory conditions.
- CRI: 80 typical.