

Technical Information Bulletin

LED Outdoor Luminaires



Date: _____ Name of distributor: _____
 In hands date of project: _____ Client #: _____
 Project name/Number: _____ Name of end user: _____

ORDERING INFORMATION

Order code: 67690
Description: CAN/S2/60W/40K/120-277V/BRZ/CL/STD
UPC: 69549676909
Case quantity: 1/6



PHYSICAL DATA

Type: LED Garage & Canopy
Finish: Dark Bronze
Heat sink material: Diecast Aluminum
Lens material: Polycarbonate
Mounting: Surface Mount

PERFORMANCE DATA

Watts (W): 60
Volts (VAC): 120-277
Colour temp. (K): 4 000
Lumen output (lm): 7 800
Lumen per Watts (lm/W): 130
CRI: 72
Life L70 (hrs): 50 000
THD (%): 120 V: 12.3 277 V: 12.53
Power factor: 120 V: 0.9877 277 V: 0.9661
Frequency (Hz): 60
Operating temp. range: -40 °C to 40 °C (-40 °F to 104 °F)
B.U.G. rating: B2-U2-G2
Photocell: No

¹ Typical colour temperature range: +/- 5 %
² Lumen values are derived from photometric testing. Initial lumens range: +/- 10 %
³ Life hours are derived from IESNA LM80-08 testing report and projected per IESNA TM-21-11 extrapolations



DESCRIPTION AND OTHER OPTIONS

CAN		/	S2		/	60W		/	40K		/	120-277V		/	BRZ		/	CL		/	STD	
Type		Series		Watts		Colour Temperature		Volts		Finish		Lens Type		Brand								
CAN	Canopy	BLANK	Series 1	40W	40 watts	40K	4 000 K	120-277V	120-277 volts	BZ	Bronze	CL	Clear	STD	STANDARD							
		S2	Series 2	60W	60 watts	50K	5 000 K	347-480V	347-480 volts													

This lighting equipment complies with Canadian standard ICES-005 for use in residential applications.
 Data is based upon tests performed in a controlled environment and representative of relative performance.
 Actual performance can vary depending on operating conditions. Specifications are subject to change without notice.
 August 14, 2019

Technical Information Bulletin LED Outdoor Luminaires



ORDER CODE: 67690

TECHNICAL DRAWINGS AND DIMENSIONS

Length: 9 1/2" (241.8 mm)
Width: 9 1/2" (241.8 mm)
Depth: 3 3/16" (81 mm)
Weight: 6.17 lbs (2.8 kg)

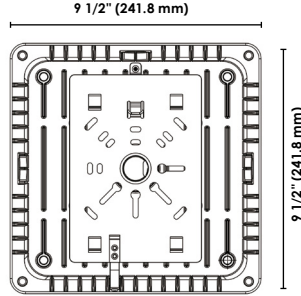
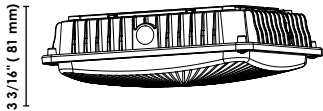

EASY MOUNT AND CLIP INSTALLATION

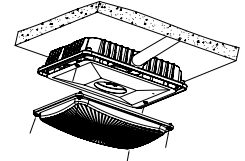
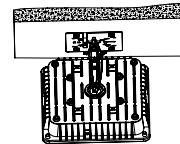
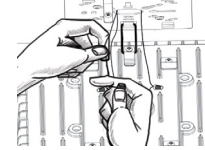

BEAM SPREAD*

Vertical spread - 156.4°
 Horizontal spread - 158.3°

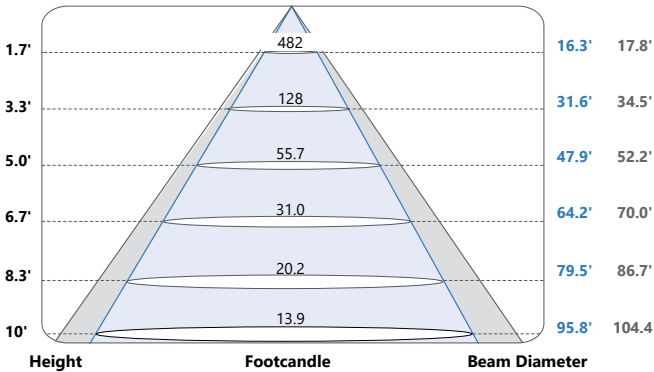

CANDELA DISTRIBUTION*

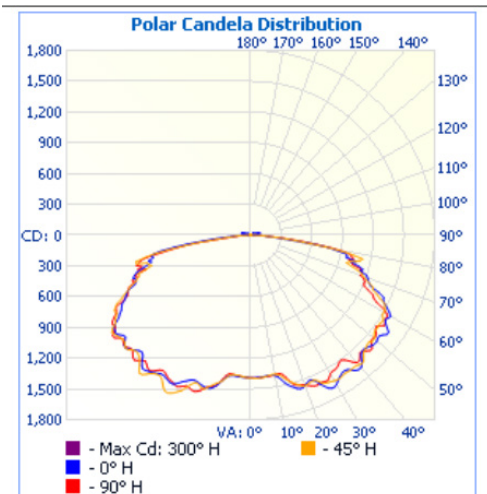

COEFFICIENTS OF UTILIZATION (ZONAL CAVITY METHOD)*

Coefficients Of Utilization - Zonal Cavity Method

Effective Floor Cavity Reflectance: 20%

RCC %:	80		70		50		30		10		0							
RW %:	70	50	30	0	70	50	30	0	50	30	20	50	30	20	50	30	20	0
RCR: 0	1.19	1.19	1.19	1.19	1.16	1.16	1.16	.99	1.11	1.11	1.11	1.06	1.06	1.06	1.01	1.01	1.01	.99
1	1.06	.99	.94	.89	1.03	.97	.92	.78	.92	.88	.85	.88	.85	.82	.84	.82	.79	.77
2	.94	.84	.75	.68	.91	.82	.74	.62	.78	.71	.66	.74	.69	.64	.71	.66	.62	.60
3	.84	.72	.62	.54	.81	.70	.61	.50	.67	.59	.52	.64	.57	.51	.61	.55	.50	.48
4	.76	.62	.52	.44	.73	.61	.51	.41	.58	.50	.43	.55	.48	.42	.53	.47	.41	.39
5	.69	.55	.44	.37	.67	.53	.44	.35	.51	.42	.36	.49	.41	.35	.47	.40	.35	.32
6	.63	.48	.38	.31	.61	.47	.38	.30	.45	.37	.31	.44	.36	.30	.42	.35	.30	.28
7	.58	.43	.34	.27	.57	.43	.33	.26	.41	.33	.26	.39	.32	.26	.38	.31	.26	.24
8	.54	.39	.30	.24	.52	.39	.30	.23	.37	.29	.23	.36	.28	.23	.34	.28	.23	.21
9	.50	.36	.27	.21	.49	.35	.27	.20	.34	.26	.20	.33	.25	.20	.32	.25	.20	.18
10	.47	.33	.24	.19	.46	.32	.24	.18	.31	.24	.18	.30	.23	.18	.29	.23	.18	.16

*Complete IES files available on our website

Qty	Description	Price

I accept the specifications of the luminaire configuration mentioned above.

Name: _____
 Company: _____
 Signature: _____

Date: _____