

Flexible cord and cable fittings

Specifications – Liquidtight fittings

—
01 2520 Series
—
02 2631 Series

Application

- A liquidtight fitting to connect flexible cord or power cable to a box or enclosure and provide adequate strain relief.

Features

- Liquidtight connection with box or enclosure is assured by:
 - (1) Taper-threaded hub on 2520 series for female hub application (A)
 - (2) Using sealing ring series 5262 with 2520 series for knockout application (B)
 - (3) Captivated sealing O-ring on 2631 series (C)
- Neoprene bushing makes liquidtight installation; applies pressure against cable the full length of bushing (D)
- Thermoplastic or stainless steel retaining ring (E)
 - (1) Will not abrade cord/cable jacket
 - (2) Reduces installing torque effort
- UL Listed for liquidtightness, strain relief and as an outlet bushing; CSA certified watertight

Standard material

- Gland, body: Steel/malleable iron/zinc die cast
- Retaining ring: Thermoplastic/stainless steel
- Bushing: Neoprene
- O-ring: Buna N

Standard finish

- Electro zinc plated and chromate coated

Range

- 2520 Series, straight 0.125 in. outside diameter to 3.200 in. outside diameter cord or cable
- 2200 Series, 45° 0.125 in. outside diameter to 1.485 in. outside diameter cord or cable
- 2267 Series, 90° 0.125 in. outside diameter to 1.875 in. outside diameter cord or cable cord/cable type S, SO, SV, ST, STO, SJ, SJO, SJT, SJTO, SVO and SVT

Conformity

- UL 514B
- CSA C22.2 No. 18.3
- NFPA 70-2008 (ANSI)



01



02



Gland

Retaining ring

(E)



Bushing

(D)

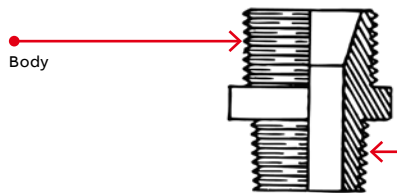

Body

(A)



Sealing gasket

(B)



Gland

Retaining ring

(E)

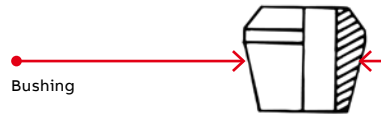

Bushing

(D)

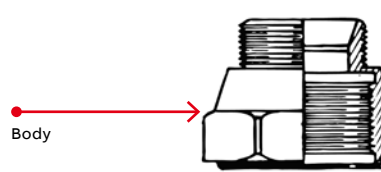

Body

(C)

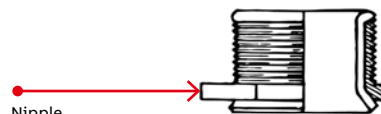

Nipple

01

02

Liquidtight strain-relief fittings

01 5262 Series
sealing ring gasket
sold separately

02 Fig. 1

03 Fig. 2

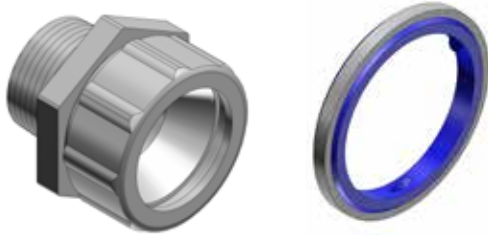

01

Liquidtight strain-relief fittings



Cat. no.	Cable size range min.-max. (in.)	Hub size (in.)	Throat dia. min. (in.)	Fig.	Dimensions (in.)		
					A	B	C
2516†	0.060–0.125	¼	23/64	2	53/64	17/16	15/32
2517†	0.120–0.250	¼	23/64	2	53/64	17/16	15/32
2518†	0.060–0.150	3/8	29/64	2	31/32	1½	15/32
2519†**	0.150–0.300	3/8	29/64	2	31/32	1½	15/32
2520	0.125–0.250	½	9/16	1	1½	1¼	5/8
2521	0.250–0.375	½	9/16	1	1½	1¼	5/8
2522	0.375–0.500	½	9/16	1	1½	1¼	5/8
2523	0.450–0.560	½	9/16	1	1½	1¼	5/8
2524*	0.500–0.625	½	5/8	1	1¾	1¾	5/8
2525*	0.625–0.750	½	5/8	1	1¾	1¾	5/8
2530	0.125–0.250	¾	13/16	1	1¾	1¾	9/16
2531	0.250–0.375	¾	13/16	1	1¾	1¾	9/16
2532	0.375–0.500	¾	13/16	1	1¾	1¾	9/16
2534	0.500–0.625	¾	13/16	1	1¾	1¾	9/16
2535	0.625–0.750	¾	13/16	1	1¾	1¾	9/16
2536*	0.750–0.880	¾	¾	1	1½	1½	5/8
2541	0.250–0.375	1	49/64	1	1¾	1¾	9/16
2542	0.375–0.500	1	49/64	1	1¾	1¾	9/16
2544	0.500–0.625	1	49/64	1	1¾	1¾	9/16
2545	0.625–0.750	1	49/64	1	1¾	1¾	9/16
2546	0.750–0.875	1	63/64	1	1½	1¾	23/32
2547	0.875–0.985	1	63/64	1	1½	1¾	9/16
2548*	0.880–1.065	1	29/32	1	2¾	2¾	23/32
2549*	1.065–1.205	1	29/32	1	2¾	2¾	23/32

Cat. no.	Cable size range min.-max. (in.)	Hub size (in.)	Throat dia. min. (in.)	Fig.	Dimensions (in.)		
					A	B	C
2558	0.880–1.065	1¼	17/64	1	2¾	2¾	13/16
2559	1.065–1.205	1¼	17/64	1	2¾	2¾	13/16
2556*	1.187–1.375	1¼	1¼	1	2½	2½	13/16
2557*	1.375–1.485	1¼	1¼	1	2½	2½	13/16
2562	0.812–1.000	1½	17/16	1	2½	2½	11/16
2563	1.000–1.187	1½	17/16	1	2½	2½	11/16
2564	1.187–1.375	1½	17/16	1	2½	2½	11/16
2565*	1.375–1.625	1½	129/64	1	2½	2½	13/16
2573	1.125–1.375	2	17/8	1	2½	2½	13/16
2574	1.375–1.625	2	17/8	1	2½	2½	11/16
2575	1.625–1.875	2	17/8	1	2½	2½	11/16
2576*	1.750–1.965	2	129/32	1	3¾	3½	27/32
2577*	1.937–2.187	2	129/32	1	3¾	3½	27/32
2584	1.750–1.965	2½	2	1	3¾	3¾	1½
2585*	1.937–2.187	2½	2	1	3¾	3¾	1½
2586*	2.156–2.360	2½	25/32	1	3½	4¼	1½
2587*	2.350–2.565	2½	25/32	1	3½	4¼	1½
2592	2.156–2.360	3	213/32	1	3½	4¼	1½
2593	2.350–2.565	3	213/32	1	3½	4¼	1½
2594	2.535–2.750	3	213/32	1	3½	4¼	1½
2595*	2.735–2.985	3	213/16	1	4½	4½	1½
2596*	2.970–3.220	3	213/16	1	4½	4½	1½

* Remove sufficient outer covering of cable to permit conductors to pass through fitting body

† UL not applicable

** Not CSA Certified

Complies with JIC standards

UL Listed as liquidtight strain-relief, and outlet bushing. CSA certified watertight when used with 5262 series sealing ring, gasket (sold separately)

Temperature rating: 105 °C

For wiremesh grips, refer to page B104

Diagrams

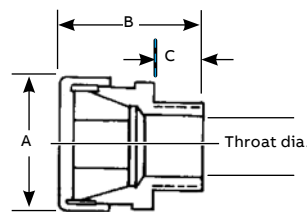

02

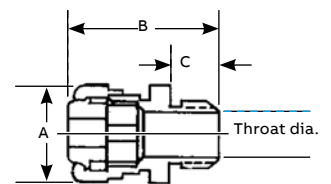

03

90° Strain-relief fittings



Swing radius 90°

With neoprene bushings, tapered hub threads, malleable iron.

90° Strain-relief fittings



Diagram	Cat. no.	Cable size range min.-max. (in.)	Hub size (in.)	Dimensions (in.)			Throat dia. (in.)
				A	B	C	
	2267	0.125–0.250	1/2	1 1/32	1 23/32	5/8	19/32
	2268	0.250–0.375	1/2	1 1/32	1 23/32	5/8	19/32
	2269	0.375–0.500	1/2	1 1/32	1 23/32	5/8	19/32
	2270	0.450–0.560	1/2	1 1/32	1 23/32	5/8	19/32
	2250*	0.500–0.625	1/2	1 3/8	1 11/16	9/16	39/64
	2251*	0.625–0.750	1/2	1 3/8	1 11/16	9/16	39/64
	2252	0.125–0.250	3/4	1 3/8	1 3/4	41/64	25/32
	2271	0.250–0.375	3/4	1 3/8	1 5/8	41/64	25/32
	2272	0.375–0.500	3/4	1 3/8	1 5/8	41/64	25/32
	2273	0.500–0.625	3/4	1 3/8	1 5/8	41/64	25/32
	2274*	0.620–0.750	3/4	1 3/8	1 5/8	41/64	25/32
	2253*	0.750–0.880	3/4	1 11/16	1 31/32	9/16	25/32
	2254	0.375–0.500	1	1 3/8	2	13/16	1
	2255	0.500–0.625	1	1 3/8	2	13/16	1
	2256*	0.625–0.750	1	1 3/8	2	13/16	1
	2275	0.750–0.875	1	1 11/16	2	13/16	1
	2276	0.875–0.985	1	1 11/16	2	13/16	1
	2257*	0.880–1.065	1	2 3/32	2 21/32	25/32	15/16
	2258*	1.065–1.205	1	2 3/32	2 21/32	25/32	15/16
	2277	0.880–1.065	1 1/4	2 3/32	2 7/8	27/32	1 5/16
	2278	1.065–1.205	1 1/4	2 3/32	2 7/8	27/32	1 5/16
	2279*	1.187–1.375	1 1/4	2 11/32	2 13/16	13/16	1 11/32
	2280*	1.375–1.485	1 1/4	2 11/32	2 13/16	13/16	1 11/32
	2281	0.812–1.000	1 1/2	2 11/32	2 7/8	13/16	1 15/32
	2282	1.000–1.187	1 1/2	2 11/32	2 7/8	13/16	1 15/32
	2283*	1.187–1.375	1 1/2	2 11/32	2 7/8	13/16	1 15/32
	2284	1.125–1.375	2	2 13/16	3 1/4	27/32	1 31/32
	2285	1.375–1.625	2	2 13/16	3 1/4	27/32	1 31/32
2286	1.625–1.875	2	2 13/16	3 1/4	27/32	1 31/32	

* Remove sufficient outer covering of cable to permit conductors to pass through fitting body
 Complies with JIC standards and Federal Specs W-F-406B, W-F-408B
 Meets Coast Guard CG293
 For wiremesh grips, refer to page B104