

JUNO®

Project: _____

Fixture Type: _____

Location: _____

Contact/Phone: _____

TRAC 12

Miniature Low Voltage Trac System

MR11 SPOTLIGHTS

TL110 AND TL112

PRODUCT DESCRIPTION

A selection of distinctive miniature MR11 halogen lampholders provides high intensity display and accent lighting using small scale, high-styled trac lights.

Transformer Refer to specification sheets [D3.1.2](#) and [D3.1.3](#).

Trac Refer to specification sheets [D3.1.0](#) and [D31.1](#).

Socket Ceramic bi-pin.

Lens Glass lens included with each lampholder.

Labels UL listed, CSA certified.

Specifications subject to change without notice.



Low Voltage MR11/Gimbal Ring

Aiming 90° vertical aiming capability and 358° rotation

- One locking knob provided.

Catalog Number	Description	Finish	Lamp
TL110 WH	Gimbal Ring	White	35W MR11, 12V or 24V
TL110 BL	Gimbal Ring	Black	35W MR11, 12V or 24V

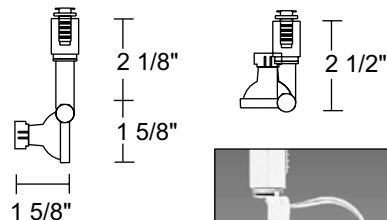

ACCESSORIES

Cat. No.	Description
HCLBL 138	Hexagonal Cell Louver - Black

See specification sheet [D1.2.2](#) for details.

Low Voltage MR11/Mini-Cylinder

Aiming 90° vertical aiming capability and 358° rotation

- Two locking knobs provided.

Catalog Number	Description	Finish	Lamp
TL112 WH	Mini-Cylinder	White	20W MR11, 12V or 24V
TL112 BL	Mini-Cylinder	Black	20W MR11, 12V or 24V
TL112 SC	Mini-Cylinder	Satin Chrome	20W MR11, 12V or 24V

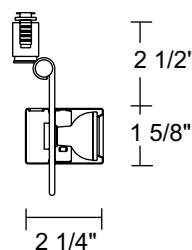

ACCESSORIES

Cat. No.	Description
HCLBL 138	Hexagonal Cell Louver - Black

See specification sheet [D1.2.2](#) for details.

TRAC 12

Miniature Low Voltage Trac System

MR11 SPOTLIGHTS

TL110 AND TL112

CBCP • Centerbeam candlepower
FC • Footcandles at beam center (aim point)

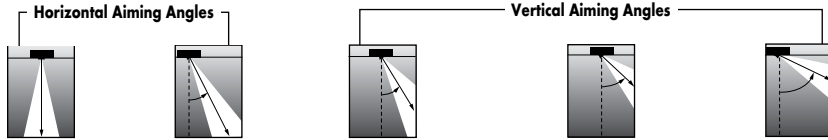

Lamp	Beam Type	Beam Spread°	Rated Life	CBCP	0°		30°			30°				45°				60°							
					MH	FC	L	W	FC	L	W	D	FC	X	L	W	FC	X	L	W	D	FC	X	L	W
20W MR11	SP	15°	3500	1760	2	440	0.5	0.5	286	0.7	0.6	1	220	1.7	1.1	0.5	622	1.0	0.5	0.4	2	286	1.2	0.7	0.6
					4	110	1.1	1.1	71	1.4	1.2	2	55	3.5	2.2	1.1	156	3.0	1.1	0.7	3	127	1.7	1.1	0.9
					6	49	1.6	1.6	32	2.1	1.8	3	24	5.2	3.3	1.6	69	3.0	1.6	1.1	4	71	2.3	1.4	1.2
					8	28	2.1	2.1	18	2.8	2.4	4	14	6.9	4.4	2.1	39	4.0	2.1	1.5	5	46	2.9	1.8	1.5
					10	18	2.6	2.6	11	3.5	3.0	5	9	8.7	5.6	2.6	25	5.0	2.7	1.9	6	32	3.5	2.1	1.8
	NFL	30°	3500	600	2	170	1.5	1.5	110	2.0	1.7	1	85	1.7	4.8	1.5	241	1.0	1.7	1.0	2	110	1.2	2.0	1.7
					4	43	2.9	2.9	28	4.1	3.4	2	21	3.5	9.6	2.9	60	2.0	3.4	2.1	3	49	1.7	3.0	2.5
					6	19	4.4	4.4	12	6.1	5.0	3	9	5.2	14.5	4.4	27	3.0	5.0	3.1	4	28	2.3	4.1	3.4
					8	11	5.8	5.8	7	8.1	6.7	4	5	6.9	19.3	5.8	15	4.0	6.7	4.1	5	18	2.9	5.1	4.2
					10	7	7.3	7.3	4	10.2	8.4	5	3	8.7	124.1	7.3	10	5.0	8.4	5.1	6	12	3.5	6.1	5.0

The beam spread in degrees and the beam "L" and "W" in the following tables are computed at 50% of centerbeam candlepower and represent areas of "effective illumination."