



# Xitanium LED drivers indoor Fixed (US)

Xitanium 12W/0.35A-33V 120V 50/60Hz

Xitanium LED drivers Indoor are specially designed to operate LED solutions for general lighting applications such as downlighting, spot/ accent lighting and linear lighting. The adjustable output current enables operation of various LED configurations from different LED manufacturers, as well as ensuring the solution can accommodate new LED generations – making it “future-proof”. Flexibility in luminaire design is assured thanks to an adjustable output current (AOC).

## Product data

### • General Characteristics

Input Frequency	50/60 Hz
Output Isolation	Yes
Material Number	LED120A0350C33F

### • Operating Characteristics

Efficiency Range	85 %
Output Power Range	12 W
Power Factor (100% load)	0.9 -
Input Power max	15 W
Output Voltage Range	2.8-33.0 V
Output Current Range (mA)	350
Total Harmonic Distortion IEC	20 %
Input Current max	130 (max) mA
Output Current Tolerance	-5 (min), 5 (max) %
Input Voltage Range (AC)	120 V
Open circuit voltage (DC)	40 (max) V

### • Temperature Characteristics

T-case maximum	85 (max) C
T-ambient	-20 (min), 60 (max) C

### • Product Dimensions

Length A1	132.0 mm
-----------	----------

Length A2	120.0 mm
Width B1	30.0 mm
Height C1	22.0 mm
Fixing Hole Diameter D1	4.3 mm
Height C2	1.5 mm

### • Approval&Application Chars

RoHS compliance	No
UL certificate	Yes
CSA certificate	Yes
EMI	FCC 47 subpart 18; Class B
Environmental standard	UL Damp & Dry

### • Product Data

Order code	913700507321
Full product code	913700507321
Full product name	Xitanium 12W/0.35A-33V 120V 50/60Hz
Order product name	LED120A0350C33FM
Pieces per pack	1
Packing configuration	140
Packs per outerbox	140
Bar code on pack - EAN1	781087025062
Bar code on outerbox - EAN3	50781087025067
Logistic code(s) - 12NC	913700507321
Net weight per piece	0.090 kg

**PHILIPS**

# Xitanium LED drivers indoor Fixed (US)

## Dimensional drawing

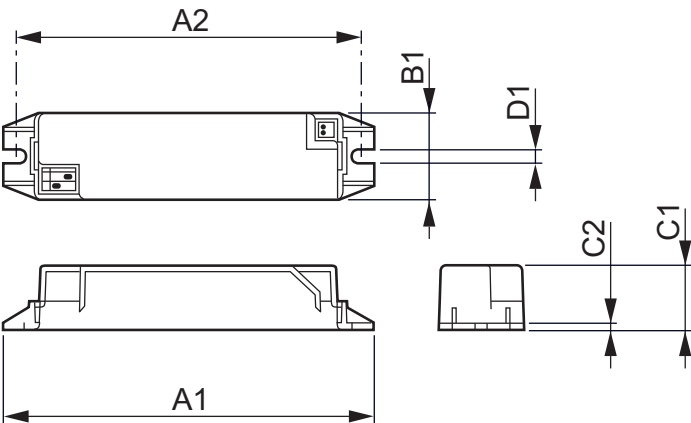

## Xitanium 12W/0.35A-33V 120V 50/60Hz

Product	A1 (Norm)	A2 (Norm)	B1 (Norm)	B2 (Norm)	C1 (Norm)	C2 (Norm)	D1 (Norm)
12W/0.35A-33V 120V 50/60Hz	132.0	120.0	30.0	-	22.0	1.5	4.3



© 2013 Koninklijke Philips N.V. (Royal Philips)  
All rights reserved.

Specifications are subject to change without notice. Trademarks are the property of Koninklijke Philips N.V. (Royal Philips) or their respective owners.

[www.philips.com/lighting](http://www.philips.com/lighting)

2013, June 1  
data subject to change