

NOMINAL LUMENS	DELIVERED LUMENS	WATTAGE
550	535	9W

Based on 3500K, 90+ CRI. Actual wattage may vary +/- 5%

INSTALLATION

Cut hole in ceiling. Insert luminaire into opening by squeezing spring clips on both sides of luminaire. The width in ceiling needed for the driver to fit is 3".

FEATURES

4" round regressed slim LED luminaire engineered for new construction, remodel or retrofit to accommodate insulated or dropped ceilings. Regressed lens delivers smooth, even comfortable illumination. Recessed housing not required for insulated ceilings. Remote driver allows easy installation and maintenance. Small aperture and shallow depth are ideal for unlimited applications.

LUMENS	550
CCT	27K, 30K, 35K, 40K, 50K and WDM (dim to warm technology 30K-22K)
CRI	90+
COLOR QUALITY	3-Step MacAdam Ellipse
CONSTRUCTION	Aluminum die-cast body and trim
TRIM OPTION	Round Indirect
TRIM COLORS	WH (White)
REFLECTOR COLORS	WH (White)
DIMMING	DIMTR (Triac)
EMERGENCY	16W high voltage inverter
LIFETIME	L70 at 50,000 Hours
PHOTOMETRIC TESTS	In Accordance with IES LM79-08, LM80 and TM-30, TM-21

- IC-rated and Air-Tight ready and may be in direct contact with insulation.
- Can be installed in shallow plenum spaces.
- May be installed in drywall or suspended ceilings.
- External driver mounted inside connection box; no j-box needed.
- Flicker-free 120V forward-phase Triac dimming down to 5%.
- Even illumination achieved with patent-pending optics and edge-lit LED technology.
- New construction rough-in plates and jumper cables available.
- Available in Dim to Warm (30K to 22K)



SLIM TRIM



ACCESSORIES



RL-ACC-SLIM-1-10F
10-ft long extension



RL-ACC-SLIM-1-20F
20-ft long extension

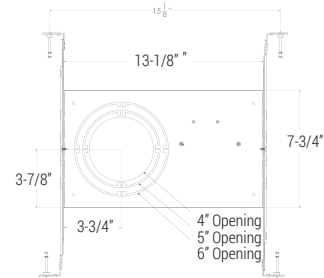

RL-UNV-4/5/6
For use with: 4", 5", 6"
Universal mounting plate

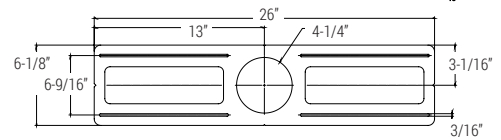
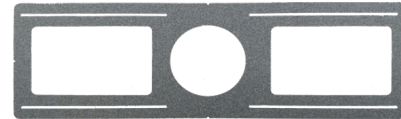

RL-ACC-SLIM-4-ROUGHPLATE
Rough-in plate for use with 4" downlights

EXAMPLE: **RL455-550L-DIMTR-120-30K-90-WH**

TYPE	LUMEN	CCT	CRI	FINISH
RL455	<input type="checkbox"/> 550L-DIMTR-120	<input type="checkbox"/> 27K	<input type="checkbox"/> 90+	<input type="checkbox"/> WH-White
	<input type="checkbox"/> 550L-277-347 (Non-Dimmable)	<input type="checkbox"/> 30K		
		<input type="checkbox"/> 35K		
		<input type="checkbox"/> 40K		
		<input type="checkbox"/> 50K		
		<input type="checkbox"/> WDM(30K-22K)		

RL-ACC-SLIM-1-10F

OPTIONS
<input type="checkbox"/> RL-ACC-SLIM-1-10F - 10ft Long Extension
<input type="checkbox"/> RL-ACC-SLIM-1-20F - 20ft Long Extension
<input type="checkbox"/> RL-UNV-4/5/6 - Universal Mounting Plate for 4", 5" and 6"
<input type="checkbox"/> RL-ACC-SLIM-4-ROUGHPLATE - 4" Mounting Plate

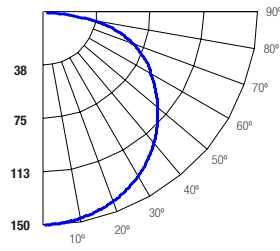
RL455-550L-DIMTR-120-35K-90-WH
TEST NO.: EL0119148
INPUT WATTS: 9
LUMENS: 535
CRI: 90
EFFICACY: 59
CCT: 3500K
SPACING CRITERIA: 1.48
Candle Power Distribution (Candelas)

Zonal Lumens Summary

Zone	Lumens	%Lamp	%Fixt
0-20	55.45	10.40	10.40
0-30	119.61	22.30	22.30
0-40	200.16	37.40	37.40
0-60	376.70	70.40	70.40
0-80	514.65	96.10	96.10
0-90	535.36	100.00	100.00

Luminance (Average candela/M²)

Angle in Degrees	Average		
	0°	45°	90°
45	19856	20068	20391
55	20735	21079	21706
65	22956	22985	24137
75	25922	27408	26412
85	7920	28217	27035

Lumens Per Zone

Zone	Lumens
0-10	14.23
10-20	41.22
20-30	64.16
30-40	80.54
40-50	88.55
50-60	87.99
60-70	79.09
70-80	58.86
80-90	20.71

Candela Tabulation

0	
0	150.10
5	149.17
15	144.73
25	137.20
35	126.12
45	111.67
55	94.59
65	77.16
75	53.36
85	5.49
90	0.38

Coefficients of Utilization - Zonal Cavity Method
 Effective Floor Cavity Reflectance 0.20

Cone of Light			
2	37.5	9.6	9.9
4	9.38	19.3	19.9
6	4.17	28.9	29.8
8	2.35	38.6	39.7
10	1.5	48.2	49.7
12	1.04	57.9	59.6

(FT.) Distance to Plane (FC) Initial Footcandle at Nadir (FT.) Beam Vert. Spread (FT.) Beam Horiz. Spread

BEAM DIA. MEASURED AT 50% OF NADIR F.C.

ROOM CAVITY RATIO	RC				70%				50%				30%				10%				0%			
	RW	70%	50%	30%	10%	70%	50%	30%	10%	50%	30%	10%	50%	30%	10%	50%	30%	10%	0%	30%	10%	0%		
0	119	119	119	119	116	116	116	116	111	111	111	106	106	106	102	102	102	100						
1	107	101	96	92	104	99	94	90	95	91	87	91	88	85	87	84	82	80						
2	96	87	79	73	93	85	78	72	81	75	70	78	73	68	75	70	67	64						
3	87	75	66	59	84	74	65	58	70	63	57	68	61	56	65	60	55	53						
4	79	66	56	49	77	65	56	49	62	54	48	60	53	47	57	51	47	44						
5	72	59	49	42	70	57	48	41	55	47	41	53	46	40	51	45	40	38						
6	67	52	43	36	65	51	42	36	50	41	35	48	41	35	46	40	35	33						
7	62	47	38	32	60	46	38	31	45	37	31	43	36	31	42	36	31	29						
8	57	43	34	28	56	42	34	28	41	33	28	40	33	27	38	32	27	25						
9	53	39	31	25	52	39	31	25	38	30	25	36	30	25	35	29	24	23						
10	50	36	28	23	49	36	28	22	35	27	22	34	27	22	33	27	22	20						

RC - Ceiling Cavity Reflectance

RW - Wall Reflectance