

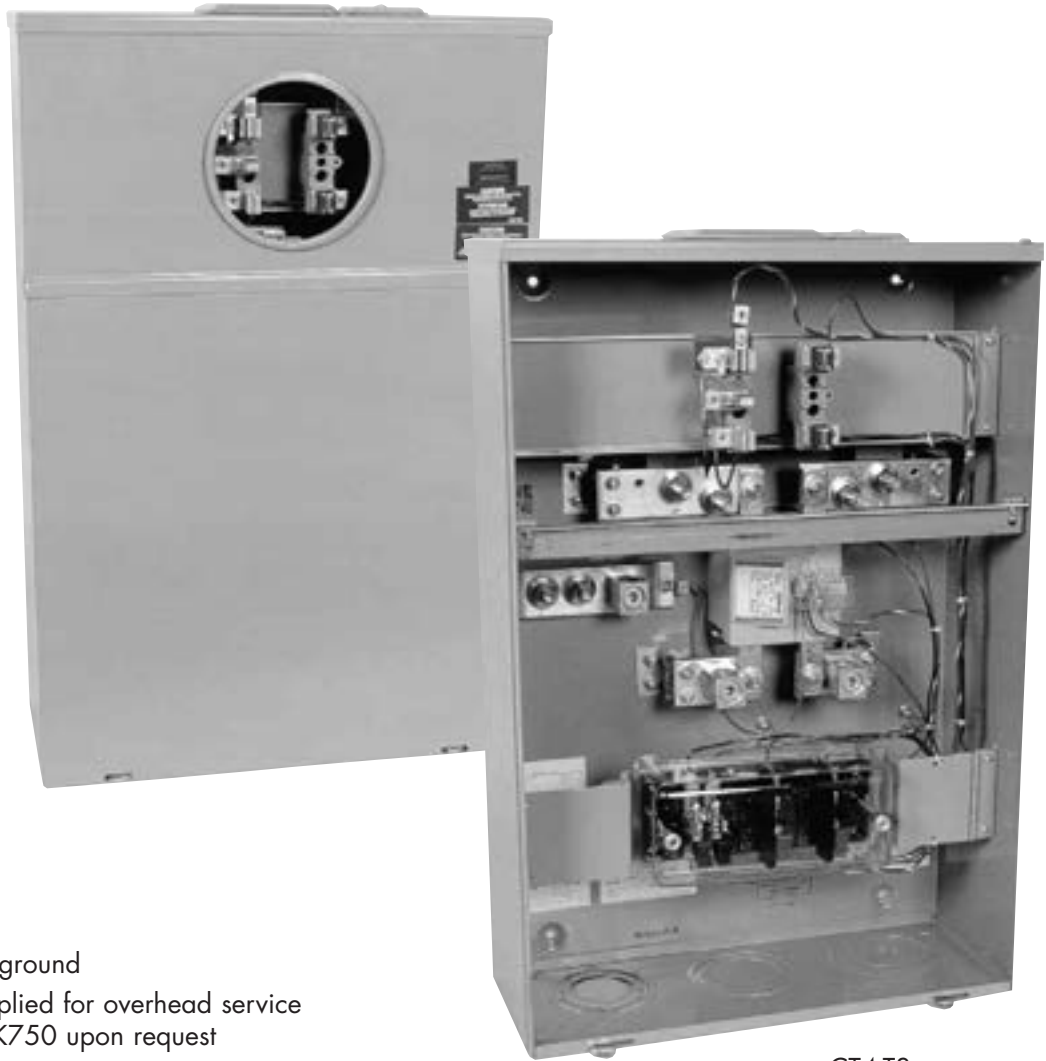

CT4 Series

400 AMP METER SOCKET 120/240 VOLT, Single Phase



CT4-TS

- Overhead/Underground
- Tunnel lug kit supplied for overhead service LK250, LK500, LK750 upon request
- Line side - double $\frac{1}{2}$ " studs to accommodate compression lugs for underground service (1 x 500 MCM or 2 x 250 MCM)
Load side - one #4 - 600 MCM
or two 1/0 - 250 MCM tunnel type connectors
Neutral - $\frac{1}{2}$ " studs to accept two 500 MCM compression type lugs
- lugs, one #4 - 600 MCM or
two 1/0 - 250 MCM
- Dimensions, 30" x 20" x 8" or 36" x 20" x 8"
Weight, 75 lbs. or 80 lbs.
Ko's 3" - 3 $\frac{1}{2}$ ", 4"
- CSA approved

CT4 Series



400 AMP METER SOCKET 120/240 VOLT, Single Phase

CATALOGUE #	ENCL. SIZE	JAWS	BY-PASS	CT RATIO	TEST SWITCH	WIRE	REGION
CT4	36"	5	Yes	No	No	Yes	Ontario
CT4-2	36"	5	Yes	200:5	No	Yes	Ontario
CT4-3	36"	5	Yes	300:5	No	Yes	Ontario
CT4-4	36"	5	Yes	400:5	No	Yes	Ontario
CT4-M	36"	4	Yes	No	No	Yes	Ontario
CT4-TS	30"	4	No	400:5	Yes	Yes	Ontario
CT4-TS-OT	30"	4	Yes	No	Yes	No	Ottawa
CT4-TS5	36"	5	Yes	400:5	Yes	Yes	Ontario
CT4-TSHO	36"	5	No	No	Yes	Yes	Hydro One
CT4-TSMB	36"	5	No	No	Yes	Yes	Manitoba
CT4-TSB	30"	5	Yes	400:5	Yes	Yes	Ontario
CT4-TSB-NB	30"	5	No	400:5	Yes	Yes	New Brunswick
CT4-TSB-PE	30"	5	No	300:5	Yes	Yes	P.E.I.
CT4-TSB-PE7	36"	5	No	300:5	Yes	Yes	P.E.I.
CT4-TSB2	30"	5	Yes	200:5	Yes	Yes	Ontario
CT4-TSB3	30"	5	Yes	300:5	Yes	Yes	Ontario
CT4-BC	36"	5	No	No	No	No	British Columbia
CT4-BC-INK	36"	5	No	No	No	No	British Columbia
CT4-NS	30"	4	No	No	No	Yes	Nova Scotia
CT4-NS7	36"	4	No	No	No	Yes	Nova Scotia
CT4-S	36"	5	Yes	No	No	Yes	Saskatchewan
	Accessories						
CT4-PMK	Pole Bracket for 30" enclosure						
CT4-PMK36	Pole Bracket for 36" enclosure						
	Overhead Service Conversion Kits supplied on request						
LK250	Twin 250 MCM lug kit						
LK500	Single 500 MCM lug kit						
LK750	Single 750 MCM lug kit						

- Overhead/Underground
- Hub plate supplied for underground service
- Lug kit supplied separately for overhead service
- Line side - double 1/2" studs to accommodate compression lugs for underground service (1 x 500 MCM or 2 x 250 MCM)
Load side - one #4 - 600 MCM or two 1/0 - 250 MCM tunnel type connectors
Neutral - 1/2" studs to accept one 500 MCM compression type lugs
- lugs, one #4 - 600 MCM or two 1/0 - 250 MCM
- CT, three wire current transformer provides low current for service metering proportional to higher current draw approved by CCA Canada
- CSA approved



CT4 Series

400 AMP METER SOCKET 120/240 VOLT, Single Phase c/w circuit breaker

CATALOGUE #	TYPE	DESCRIPTION	DIMENSIONS (IN.)			WEIGHT
			H	W	D	
CT4-WS-BC	U/G	5 Jaw, c/w 400 AMP 65kA rated circuit breaker	42	26	8 ¹ / ₄	110 lbs.
CT4-WSOH-BC	O/H	5 Jaw, c/w 400 AMP 65kA rated circuit breaker	50	16	8 ¹ / ₄	68 lbs.
CT4PMK-WS CT4PMKWSOH		Accessories Pole Bracket for CT4-WS-BC Pole Bracket for CT4-WSOH-BC				

- 400 Amp - 120/240 VOLT
- All in One Transformer Rated
- Combination meter socket & Siemens 400A 240V 65 KA breaker
- CSA enclosure 3R
- Load and line side terminations: tunnel type connectors, dual rated for 1 x 600 kcmil or 2 x 250 kcmil
- Provision for test switch (Supplied by Hydro)
- Provision for current transformer (Supplied by Hydro)
- Secondary circuit wiring not included (secondary circuit wired by Hydro)

KNOCKOUT CODE	CONDUIT SIZE
K	2", 2 ¹ / ₂ ", 3"
P	2", 2 ¹ / ₂ ", 3", 3 ¹ / ₂ ", 4"
AA	1 ¹ / ₂ "

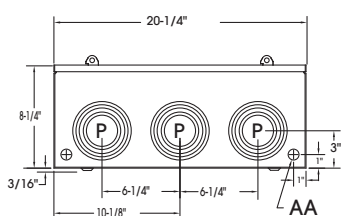

CT4-SERIES

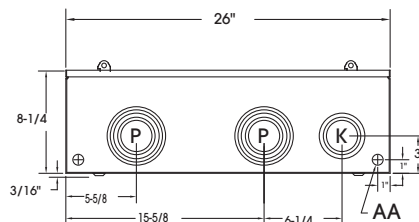

CT4-WS

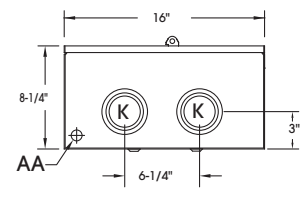

CT4-WSOH