

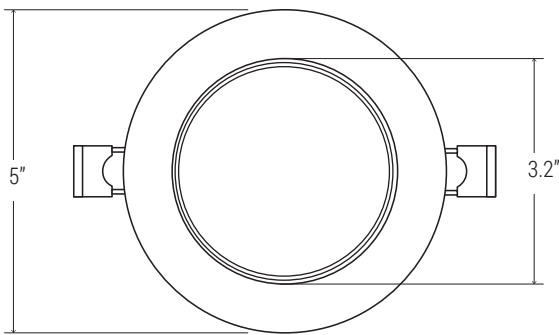

EASY 5 COLORS
SELECTOR
2700K • 3000K • 3500K • 4000K • 5000K

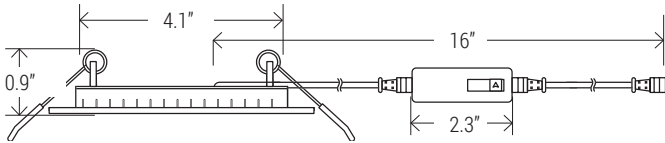
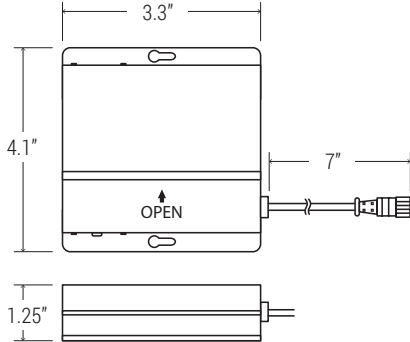

FEATURES

4" round baffle slim multi-CCT LED luminaire engineered for new construction, remodel or retrofit to accommodate insulated or dropped ceilings. Baffle trim delivers glare-free comfortable illumination. Easily access field-adjustable 5-Color SeleCCTor switch by lowering the luminaire from the opening. Remote driver allows easy installation and maintenance. Small aperture and shallow depth are ideal for unlimited applications.

LUMENS	550, 700
CCT	27K/30K/35K/40K/50K
CRI	90+
COLOR QUALITY	3-Step MacAdam Ellipse
CONSTRUCTION	Aluminum die-cast body and trim
TRIM OPTION	Round Baffle
TRIM COLORS	WH (White) , BK(Black)
DIMMING	DIMTR (Triac)
EMERGENCY	16W high voltage inverter
LIFETIME	L70 at 50,000 Hours
PHOTOMETRIC TESTS	In Accordance with IES LM79-08, LM80 and TM-30, TM-21

- IC-rated and Air-Tight ready and may be in direct contact with insulation.
- Can be installed in shallow plenum applications.
- Can be installed in drywall or suspended ceilings.
- Flicker-free forward-phase Triac dimming down to 5%.
- New construction rough-in plates and jumper cables available.

NOMINAL LUMENS	DELIVERED LUMENS	WATTAGE
700	833	12W
550	564	9W

Based on 4000K, 90+ CRI. Actual wattage may vary +/- 5%

INSTALLATION

Cut hole in ceiling. Insert luminaire into opening by squeezing spring clips on both sides of luminaire. The width in ceiling needed for the driver to fit is 3".

SLIM TRIM



EXAMPLE: **RL479-550L-DIMTR-120-27K/30K/35K/40K/50K-90-WH**

TYPE	LUMEN	CCT	CRI	FINISH
RL479	<input type="checkbox"/> 550L-DIMTR-120 <input type="checkbox"/> 700L-DIMTR-120	<input type="checkbox"/> 27K/30K/35K/40K/50K	<input type="checkbox"/> 90+	<input type="checkbox"/> WH-White <input type="checkbox"/> BK-Black

ACCESSORIES



RL-ACC-SLIM-1-10F
10-ft long extension



RL-ACC-SLIM-1-20F
20-ft long extension

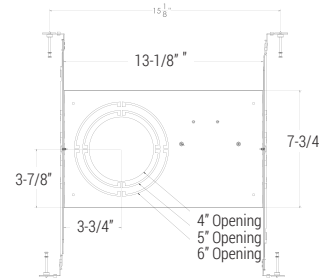

RL-UNV-4/5/6
For use with: 4", 5", 6"
Universal mounting plate

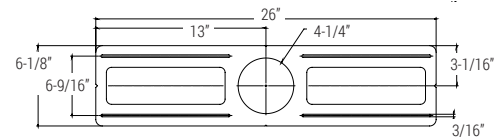

RL-ACC-SLIM-4-ROUGHPLATE
Rough-in plate for use with 4" downlights

RL-ACC-SLIM-1-10F

OPTIONS
<input type="checkbox"/> RL-ACC-SLIM-1-10F - 10ft Long Extension <input type="checkbox"/> RL-ACC-SLIM-1-20F - 20ft Long Extension <input type="checkbox"/> RL-UNV-4/5/6 - Universal Mounting Plate for 4", 5" and 6" <input type="checkbox"/> RL-ACC-SLIM-4-ROUGHPLATE - 4" Mounting Plate

RL479-550L-DIMTR-120-27K-30K-35K-40K-50K-90-WH

TEST NO.: **EL12031903**

INPUT WATTS: **9.01936**

LUMENS: **564**

CRI: **90**

EFFICACY: **63**

CCT: **4000K**

SPACING CRITERIA: **1.20**

Candle Power Distribution (Candelas)

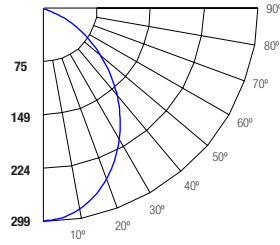

Zonal Lumens Summary

Zone	Lumens	%Lamp	%Fixt
0-20	105.38	18.70	18.70
0-30	214.91	38.10	38.10
0-40	334.29	59.30	59.30
0-60	517.84	91.80	91.80
0-80	563.36	99.90	99.90
0-90	563.38	99.90	99.90

Luminance (Average candela/M²)

Angle in Degrees	Average		
	0°	45°	90°
45	64597	65570	68136
55	47952	49295	52518
65	27361	29394	33208
75	2090	3293	8345
85	79	79	79

Lumens Per Zone

Zone	Lumens
0-10	27.99
10-20	77.39
20-30	109.53
30-40	119.38
40-50	106.83
50-60	76.71
60-70	38.75
70-80	6.77
80-90	0.02

Candela Tabulation

Q	Candela
0	298.66
5	295.21
15	273.12
25	234.98
35	186.96
45	133.44
55	80.35
65	33.78
75	1.58
85	0.02
90	0.02

Coefficients of Utilization - Zonal Cavity Method

Effective Floor Cavity Reflectance 0.20

Cone of Light			
2	74.7	3.7	3.7
4	18.7	7.5	7.5
6	8.3	11.2	11.2
8	4.67	14.9	15
10	2.99	18.7	18.7
12	2.07	22.4	22.4
(F.T.) Distance to Plane	(F.C.) Initial Footcandle at Nadir	(F.T.) Beam Vert. Spread	(F.T.) Beam Horiz. Spread

BEAM DIA. MEASURED AT 50% OF NADIR F.C.

ROOM CAVITY RATIO	RW	80%				70%				50%				30%				10%				0%			
		70%	50%	30%	10%	70%	50%	30%	10%	50%	30%	10%	50%	30%	10%	50%	30%	10%	50%	30%	10%	0%			
0	0	119	119	119	119	116	116	116	116	111	111	111	106	106	106	102	102	102	100	100	100	100			
1	1	111	108	104	101	109	105	102	100	101	99	96	97	95	94	94	92	91	89	89	89	89			
2	2	103	96	91	86	101	94	89	85	91	87	83	88	84	81	85	82	80	78	78	78	78			
3	3	95	86	80	74	93	85	79	73	82	77	72	79	75	71	77	73	70	68	68	68	68			
4	4	88	78	70	65	86	77	70	64	74	68	63	72	67	62	70	65	62	60	60	60	60			
5	5	82	70	63	57	80	69	62	56	67	61	56	65	60	55	64	59	55	53	53	53	53			
6	6	76	64	56	50	74	63	56	50	61	55	50	60	54	49	58	53	49	47	47	47	47			
7	7	71	59	51	45	69	58	50	45	56	50	45	55	49	44	54	48	44	42	42	42	42			
8	8	66	54	46	41	65	53	46	41	52	45	41	51	45	40	50	44	40	38	38	38	38			
9	9	62	50	42	37	61	49	42	37	48	42	37	47	41	37	46	41	37	35	35	35	35			
10	10	58	46	39	34	57	46	39	34	45	38	34	44	38	34	43	37	34	32	32	32	32			

RC - Ceiling Cavity Reflectance

RW - Wall Reflectance

RL479-700L-DIMTR-120-27K-30K-35K-40K-50K-90-WH

TEST NO.: **EL103019124**

INPUT WATTS: **11.7625**

LUMENS: **833**

CRI: **90**

EFFICACY: **71**

CCT: **4000K**

SPACING CRITERIA: **1.20**

Candle Power Distribution (Candelas)

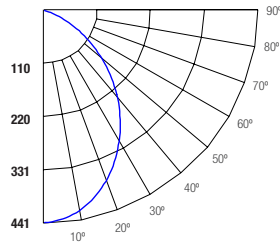

Zonal Lumens Summary

Zone	Lumens	%Lamp	%Fixt
0-20	155.51	18.70	18.70
0-30	317.26	38.10	38.10
0-40	493.87	59.30	59.30
0-60	766.02	92.00	92.00
0-80	832.28	99.90	99.90
0-90	832.30	99.90	99.90

Luminance (Average candela/M²)

Angle in Degrees	Average		
	0°	45°	90°
45	96475	96872	100052
55	72057	72934	76819
65	41308	43009	47715
75	3597	5052	9866
85	79	79	79

Lumens Per Zone

Zone	Lumens
0-10	41.31
10-20	114.20
20-30	161.75
30-40	176.61
40-50	158.46
50-60	113.68
60-70	56.78
70-80	9.49
80-90	0.02

Candela Tabulation

Q	Candela
0	440.43
5	435.35
15	402.84
25	347.24
35	277.24
45	199.29
55	120.74
65	51.00
75	2.72
85	0.02
90	0.02

Coefficients of Utilization - Zonal Cavity Method

Effective Floor Cavity Reflectance 0.20

Cone of Light			
2	100	3.8	3.7
4	27.5	7.5	7.5
6	12.2	11.2	11.2
8	6.88	15.1	15
10	4.4	18.8	18.7
12	3.06	22.6	22.5
(F.T.) Distance to Plane	(F.C.) Initial Footcandle at Nadir	(F.T.) Beam Vert. Spread	(F.T.) Beam Horiz. Spread

BEAM DIA. MEASURED AT 50% OF NADIR F.C.

ROOM CAVITY RATIO	RW	80%				70%				50%				30%				10%				0%			
		70%	50%	30%	10%	70%	50%	30%	10%	50%	30%	10%	50%	30%	10%	50%	30%	10%	50%	30%	10%	0%			
0	0	119	119	119	119	116	116	116	116	111	111	111	106	106	106	102	102	102	100	100	100	100			
1	1	111	108	104	101	109	105	102	100	101	99	96	97	95	94	94	92	91	89	89	89	89			
2	2	103	96	91	86	101	95	89	85	91	87	83	88	84	81	85	82	80	78	78	78	78			
3	3	95	86	80	74	93	85	79	73	82	77	72	79	75	71	77	73	70	68	68	68	68			
4	4	88	78	70	65	86	77	70	64	74	68	63	72	67	62	70	65	62	60	60	60	60			
5	5	82	70	63	57	80	69	62	56	67	61	56	66	60	55	64	59	55	53	53	53	53			
6	6	76	64	56	50	74	63	56	50	62	55	50	60	54	49	58	53	49	47	47	47	47			
7	7	71	59	51	45	69	58	50	45	56	50	45	55	49	44	54	48	44	42	42	42	42			
8	8	66	54	46	41	65	53	46	41	52	45	41	51	45	40	50	44	40	38	38	38	38			
9	9	62	50	42	37	61	49	42	37	48	42	37	47	41	37	46	41	37	35	35	35	35			
10	10	58	46	39	34	57	46	39	34	45	38	34	44	38	34	43	37	34	32	32	32	32			

RC - Ceiling Cavity Reflectance

RW - Wall Reflectance