

# Pilot and Signaling Devices

## Heavy-Duty 22.5 mm Watertight/Oiltight Push Buttons

## Section 9

### C-2000

Multi Function

Illuminated

600 VAC Max., 300 VDC Max.

10 Amps Continuous AC, 2.5 Amps Continuous DC

#### Selection Process

Select operator below + Select power supply from pages 9-92 & 9-93 + Select contact block from page 9-93 + Select nameplate, if required, from pages 9-95 to 9-97 = Complete unit

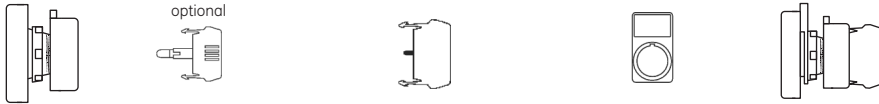

#### NEMA 1 Operators

Color	Special Function Type	Marking	Product Number
Black Top - Red Bottom	Flush	None	P9DPLNRG00
Black Top - Red Bottom	Flush	Top—I, Bottom—O	P9DPLNRG01
Black Top - Red Bottom	Flush Top, Extended Bottom	None	P9DPLNRS00
Black Top - Red Bottom	Flush Top, Extended Bottom	Top—I, Bottom—O	P9DPLNRS01
Green Top - Red Bottom	Flush	None	P9DPLVRG00
Green Top - Red Bottom	Flush	Top—I, Bottom—O	P9DPLVRG01
Green Top - Red Bottom	Flush Top, Extended Bottom	None	P9DPLVRS00
Green Top - Red Bottom	Flush Top, Extended Bottom	Top—I, Bottom—O	P9DPLVRS01

Multi Function Push Buttons

#### Accessories

Description	Operator Type	Product Number
Silicone rubber boot For conversion to NEMA 3, 3R, 3S, 4, 4X, 12 & 13, and IP66	Flush	080CPDT
Silicone rubber boot For conversion to NEMA 3, 3R, 3S, 4, 4X, 12 & 13, and IP66	Flush Top/Extended Bottom	P9ADCST

#### Outlines and Dimensions (in/mm) (For Estimating Only)

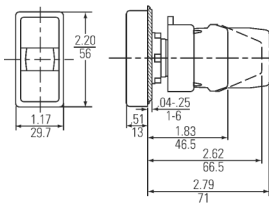

Double Push Button (Top & Bottom Flush)

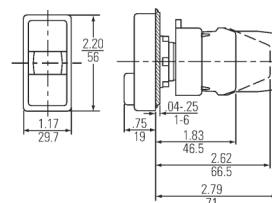

Double Push Button (Top Flush & Bottom Extended)

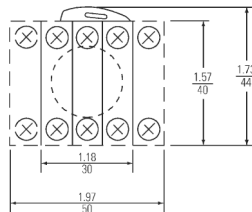

Typical Back Side View



Accessories: See page 9-102 to 9-111  
 Technical Data: See page 9-119 to 9-125

# Pilot and Signaling Devices Heavy-Duty 22.5 mm Watertight/Oiltight Accessories C-2000

## Section 9

Power Supplies and Contact Blocks

600 VAC Max., 300 VDC Max.

10 Amps Continuous AC, 2.5 Amps Continuous DC

### Full Voltage Power Supplies AC/DC

Bulb Type	Terminal type	Lamp Operational Mode	Voltage	Product Number
Incandescent	Screw Terminal	Steady	No lamp	P9PDNV0
Incandescent	Screw Terminal	Steady	6V	P9PDNVA
Incandescent	Screw Terminal	Steady	12V	P9PDNVB
Incandescent	Screw Terminal	Steady	24V	P9PDNVD
Incandescent	Screw Terminal	Steady	48V	P9PDNVG
Incandescent	Screw Terminal	Steady	60V	P9PDNVH
Incandescent	Screw Terminal	Steady	130V	P9PDNVL
Incandescent	Screw Terminal	Flashing	24V	P9PDMVD
Incandescent	Screw Terminal	Flashing	120V	P9PDMVJ
Incandescent	Screw Terminal	Panel Test	No lamp	P9PDTV0
Incandescent	Screw Terminal	Panel Test	6V	P9PDTVA
Incandescent	Screw Terminal	Panel Test	12V	P9PDTVB
Incandescent	Screw Terminal	Panel Test	24V	P9PDTVD
Incandescent	Screw Terminal	Panel Test	48V	P9PDTVG
Incandescent	Screw Terminal	Panel Test	60V	P9PDTVH
Incandescent	Screw Terminal	Panel Test	130V	P9PDTVL
Incandescent	Quick-Connect Terminal	Steady	No lamp	P9PDNF0
Incandescent	Quick-Connect Terminal	Steady	6V	P9PDNFA
Incandescent	Quick-Connect Terminal	Steady	12V	P9PDNFB
Incandescent	Quick-Connect Terminal	Steady	24V	P9PDNFD
Incandescent	Quick-Connect Terminal	Steady	48V	P9PDNFG
Incandescent	Quick-Connect Terminal	Steady	60V	P9PDNFH
Incandescent	Quick-Connect Terminal	Steady	130V	P9PDNFL
LED	Screw Terminal	Steady	6V	P9PDNVAL*
LED	Screw Terminal	Steady	12V	P9PDNVBL*
LED	Screw Terminal	Steady	24V	P9PDNVDL*
LED	Screw Terminal	Steady	48V	P9PDNVGL*
LED	Screw Terminal	Steady	120V <sup>2</sup>	P9PDNVJL*
LED	Screw Terminal	Flashing	24V	P9PDMVDL*
LED	Screw Terminal	Flashing	120V <sup>2</sup>	P9PDMVJL*
LED	Screw Terminal	Panel Test	6V	P9PDTVAL*
LED	Screw Terminal	Panel Test	12V	P9PDTVBL*
LED	Screw Terminal	Panel Test	24V	P9PDTVDL*
LED	Screw Terminal	Panel Test	48V	P9PDTVGL*
LED	Screw Terminal	Panel Test	120V <sup>2</sup>	P9PDTVJL*
LED	Quick-Connect Terminal	Steady	6V	P9PDNFAL*
LED	Quick-Connect Terminal	Steady	12V	P9PDNFBL*
LED	Quick-Connect Terminal	Steady	24V	P9PDNFDL*
LED	Quick-Connect Terminal	Steady	48V	P9PDNFGL*
LED	Quick-Connect Terminal	Steady	120V <sup>2</sup>	P9PDNFJL*
Neon	Screw Terminal	Steady	110V	P9PDNVIN <sup>1</sup>
Neon	Screw Terminal	Steady	220V	P9PDNVMN
Neon	Screw Terminal	Panel Test	110V	P9PDTVIN <sup>1</sup>
Neon	Screw Terminal	Panel Test	220V	P9PDTVMN <sup>1</sup>
Neon	Quick-Connect Terminal	Steady	110V	P9PDNFIN <sup>1</sup>
Neon	Quick-Connect Terminal	Steady	220V	P9PDNFMN
Integrated LED	Screw Terminal	Steady	24 VAC/DC	P9PLNVD*
Integrated LED	Screw Terminal	Steady	120V	P9PLNVJ*
Integrated LED	Screw Terminal	Steady	230V	P9PLNVN*
Integrated LED	Screw Terminal	Flashing	24 VAC/DC	P9PLFVD*
Integrated LED	Screw Terminal	Flashing	120V	P9PLFVJ*
Integrated LED	Screw Terminal	Flashing	230V	P9PLFVN*

<sup>1</sup>Neon bulbs are recommended for use only with clear, red, and yellow lenses.

<sup>2</sup>AC only

### Transformer Power Supplies 50/60 Hz AC

Bulb Type	Terminal type	Lamp Operational Mode	Voltage	Product Number
Incandescent	Screw Terminal	Steady	48V	P9PTNVG
Incandescent	Screw Terminal	Steady	60V	P9PTNVH
Incandescent	Screw Terminal	Steady	110-120V	P9PTNVJ
Incandescent	Screw Terminal	Steady	220-250V	P9PTNVN
Incandescent	Screw Terminal	Steady	277-280V	P9PTNVR
Incandescent	Screw Terminal	Steady	380V	P9PTNVU
Incandescent	Screw Terminal	Steady	415-440V	P9PTNVW
Incandescent	Screw Terminal	Steady	480-500V	P9PTNVY
Incandescent	Screw Terminal	Steady	550-600V	P9PTNVZ
Incandescent	Screw Terminal	Flashing	48V	P9PTMVG
Incandescent	Screw Terminal	Flashing	60V	P9PTMVH
Incandescent	Screw Terminal	Flashing	110-120V	P9PTMVJ
Incandescent	Screw Terminal	Flashing	220-250V	P9PTMVN
Incandescent	Screw Terminal	Flashing	277-280V	P9PTMVR
Incandescent	Screw Terminal	Flashing	380V	P9PTMVU
Incandescent	Screw Terminal	Flashing	415-440V	P9PTMVW
Incandescent	Screw Terminal	Flashing	480-500V	P9PTMVG
Incandescent	Screw Terminal	Flashing	550-600V	P9PTMVZ
LED	Screw Terminal	Steady	48V	P9PTNVGL*
LED	Screw Terminal	Steady	60V	P9PTNVHL*
LED	Screw Terminal	Steady	110-120V	P9PTNVJL*
LED	Screw Terminal	Steady	220-250V	P9PTNVNL*
LED	Screw Terminal	Steady	277-280V	P9PTNVRL*
LED	Screw Terminal	Steady	380V	P9PTNVUL*
LED	Screw Terminal	Steady	415-440V	P9PTNVWL*
LED	Screw Terminal	Steady	480-500V	P9PTNVYL*
LED	Screw Terminal	Steady	550-600V	P9PTNVZL*
LED	Screw Terminal	Flashing	48V	P9PTMVG
LED	Screw Terminal	Flashing	60V	P9PTMVHL*
LED	Screw Terminal	Flashing	110-112V	P9PTMVJL*
LED	Screw Terminal	Flashing	220-250V	P9PTMVNL*
LED	Screw Terminal	Flashing	277-280V	P9PTMVRL*
LED	Screw Terminal	Flashing	380V	P9PTMVUL*
LED	Screw Terminal	Flashing	415-440V	P9PTMVWL*
LED	Screw Terminal	Flashing	480-500V	P9PTMVG
LED	Screw Terminal	Flashing	550-600V	P9PTMVZL*

Complete product number by inserting color code digit in place of asterisk (\*).

#### \*LED Colors

LED Color	Red	Green	Yellow	Orange	Blue	White
Color Code	R	V	G	A	L	B



Outlines and Dimensions: See page 9-94

# Pilot and Signaling Devices Heavy-Duty 22.5 mm Watertight/Oiltight Accessories

## Section 9

### C-2000

Power Supplies and Contact Blocks

600 VAC Max., 300 VDC Max.

10 Amps Continuous AC, 2.5 Amps Continuous DC

#### Resistor Power Supplies AC/DC

Bulb Type	Terminal type	Lamp Operational Mode	Voltage	Product Number
Incandescent	Screw Terminal	Steady	110-120V	P9PRNVJ
Incandescent	Screw Terminal	Steady	220-240V	P9PRNVN
Incandescent	Screw Terminal	Steady with Diode	220-240V	P9PRDVN
Incandescent	Screw Terminal	Steady Long Life	110-120V	P9PRLVJ
Incandescent	Screw Terminal	Panel Test	220-240V	P9PRTVN

#### Full-Voltage Power Supplies Low-Level Energy (Reed)

Bulb Type	Terminal type	Lamp Operational Mode	Voltage	Product Number
Incandescent	Quick-Connect Terminal	Steady	-	P9PDHF <sup>1</sup>

<sup>1</sup>For use with Reed Logic flange only.

#### Contact Blocks

Terminal type	Contact Block Type	Contact Configuration	Product Number
Screw Terminal	Standard	1NO	P9B10VN
Screw Terminal	Standard	1NC	P9B01VN
Screw Terminal	Standard	1NO-1NC	P9B11VN
Screw Terminal	Standard	2NO	P9B20VN
Screw Terminal	Standard	2NC	P9B02VN
Screw Terminal	Early Make	1NO	P9B10VA
Screw Terminal	Late Opening	1NC	P9B01VR
Screw Terminal	Base Mount	1NO	P9B10BN
Screw Terminal	Base Mount	1NC	P9B01BN
Quick-Connect Terminal	Standard	1NO	P9B10FN
Quick-Connect Terminal	Standard	1NC	P9B01FN
Quick-Connect Terminal	Reed	1NO	P9B10FH <sup>2</sup>
Quick-Connect Terminal	Reed	1NC	P9B01FH <sup>2</sup>

<sup>2</sup>Requires special flange (P9ACFSM).

Order on page 9-110.

