

## FLEXIBLE METAL CONDUIT - ALUMINUM

# CSA RAY-FLEX™ Aluminum Type FAC (5700 Series)

### Description

- Heavy wall flexible aluminum conduit

### Applications

*Suitable for use in:*

- Flexible Aluminum Conduit (FAC): A raceway of circular cross-section made of helically wound, interlocked aluminum strip.
- Accordance with CEC Rule 12-1000 Rigid and Flexible Metal Conduit
- Installation in or on buildings or portions of buildings of either combustible or non-combustible construction per CEC 12-1002(1)
- Support shall be provided in accordance with CEC 12-1010(3)
- Hoistways per CEC 12-1014(1)
- Wiring under raised floors for data processing and similar systems per CEC 12-020(2)
- Class I Zone 2 where flexibility is required per CEC 18.152(6)

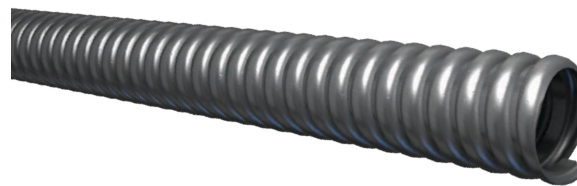

### Specifications

- CSA Certified to CSA C22.2 No.56
- Use in hazardous locations as per CEC Class I, Zone 2 & Div.2, Class II Div. 1 & 2, Class III Div. 1 & 2
- Made in USA of US and/or imported materials

Ratings	
C22.1	Canadian Electrical Code, Part I – Safety Standard for Electrical Installations Rule 12-1000
C22.2 No. 56	CSA Standard for Flexible Metal Conduit and Liquid-Tight Flexible Metal Conduit Master Contract 157782, File Number LL15035
NEC® Articles:	348, 390.15, 501.10(B)(2), 502.10(A)(2), 503.10(A)(2), 511.7(A)(1), 620.21, 645.5(D)(2), 680.21, 680.23, 680.25, 680.27, 680.42, 695.6(E) and 695.14(E)

### ORDERING INFORMATION

### PRODUCT DIMENSIONS/BEND RADIUS

Product Code	Catalog Number	Trade Size in.(mm)	Coil Length (meters)	Reel Length (meters)	Approximate Weight (kg/meter)	Internal Diameter Min. mm (In.)	Internal Diameter Max. mm (In.)	External Diameter Min. mm (In.)	External Diameter Max. mm (In.)	Bend Radius mm (in.)
5712-75-00	ALUC0312M0075W	5/16 (10)	75	–	0.09	7.92 (0.312)	N/A	11.94 (.470)	12.95 (0.510)	89 (3.5)
5712-80-00	ALUC0312M0300R	5/16 (10)	–	300	0.09	7.92 (0.312)	N/A	11.94 (.470)	12.95 (0.510)	89 (3.5)
5701-75-00	ALUC0375M0075W	3/8 (12)	75	–	0.10	9.53 (0.375)	9.98 (0.393)	14.22 (0.560)	15.49 (0.610)	102 (4.0)
5701-80-00	ALUC0375M0300R	3/8 (12)	–	300	0.10	9.53 (0.375)	9.98 (0.393)	14.22 (0.560)	15.49 (0.610)	102 (4.0)
5713-75-00	ALUC0437M0075W	7/16 (14)	75	–	0.11	11.10 (0.437)	N/A	N/A	17.15 (0.675)	114 (4.5)
5713-80-00	ALUC0437M0300R	7/16 (14)	–	300	0.11	11.10 (0.437)	N/A	N/A	17.15 (0.675)	114 (4.5)
5702-21-00	ALUC0500M0030W	1/2 (16)	30	–	0.25	15.88 (0.625)	16.38 (0.645)	21.84 (0.860)	23.37 (0.920)	152 (6.0)
5702-80-00	ALUC0500M0300R	1/2 (16)	–	300	0.25	15.88 (0.625)	16.38 (0.645)	21.84 (0.860)	23.37 (0.920)	152 (6.0)
5703-21-00	ALUC0750M0030W	3/4 (21)	30	–	0.30	20.62 (0.812)	21.21 (0.835)	26.54 (1.045)	28.07 (1.105)	203 (8.0)
5703-35-00	ALUC0750M0150R	3/4 (21)	–	150	0.30	20.62 (0.812)	21.21 (0.835)	26.54 (1.045)	28.07 (1.105)	203 (8.0)
5703-80-00	ALUC0750M0300R	3/4 (21)	–	300	0.30	20.62 (0.812)	21.21 (0.835)	26.54 (1.045)	28.07 (1.105)	203 (8.0)
5704-21-00	ALUC1000M0030W	1 (27)	30	–	0.47	25.40 (1.000)	26.42 (1.040)	33.02 (1.300)	35.05 (1.380)	254 (10.0)
5704-35-00	ALUC1000M0150R	2 (27)	–	150	0.47	25.40 (1.000)	26.42 (1.040)	33.02 (1.300)	35.05 (1.380)	254 (10.0)
5705-15-00	ALUC1250M0015W	1-1/4 (35)	15	–	0.58	31.75 (1.250)	33.02 (1.300)	39.37 (1.550)	41.40 (1.630)	318 (12.5)
5705-75-00	ALUC1250M0075R	1-1/4 (35)	–	75	0.58	31.75 (1.250)	33.02 (1.300)	39.37 (1.550)	41.40 (1.630)	318 (12.5)
5706-15-00	ALUC1500M0015W	1-1/2 (41)	15	–	0.76	38.10 (1.500)	40.00 (1.575)	46.99 (1.850)	49.53 (1.950)	381 (15.0)
5706-57-00	ALUC1500M0045R	1-1/2 (41)	–	45	0.76	38.10 (1.500)	40.00 (1.575)	46.99 (1.850)	49.53 (1.950)	381 (15.0)
5707-15-00	ALUC2000M0015W	2 (53)	15	–	0.98	50.80 (2.000)	52.83 (2.080)	59.69 (2.350)	62.23 (2.450)	508 (20.0)
5707-21-00	ALUC2000M0030R	3 (53)	–	30	0.98	50.80 (2.000)	52.83 (2.080)	59.69 (2.350)	62.23 (2.450)	508 (20.0)
5708-15-00	ALUC2500M0015W	2-1/2 (63)	15	–	1.46	63.50 (2.500)	N/A	72.64 (2.860)	77.72 (3.060)	635 (25.0)
5709-15-00	ALUC3000M0015W	3 (78)	15	–	1.67	76.20 (3.000)	N/A	85.34 (3.360)	90.42 (3.560)	762 (30.0)
5710-15-00	ALUC3500M0015W	3-1/2 (91)	15	–	1.89	88.90 (3.500)	N/A	98.04 (3.860)	103.12 (4.060)	889 (35.0)
5711-15-00	ALUC4000M0015W	4 (103)	15	–	2.10	101.60 (4.000)	N/A	110.74 (4.360)	115.82 (4.560)	1016 (40.0)