

Champ VMV HID luminaires

Cl. I, Div. 2, Groups A, B, C, D
Restricted Breathing Cl. I,
Div. 2 & Zone 2 (with suffix
S826)

Cl. II, Groups E, F, G
Cl. III & Simultaneous
Presence (HPS 50W, 70W)
Marine & Wet Locations
3, 3R, 4, 4X; IP56 to IP66

3L

Family tree:

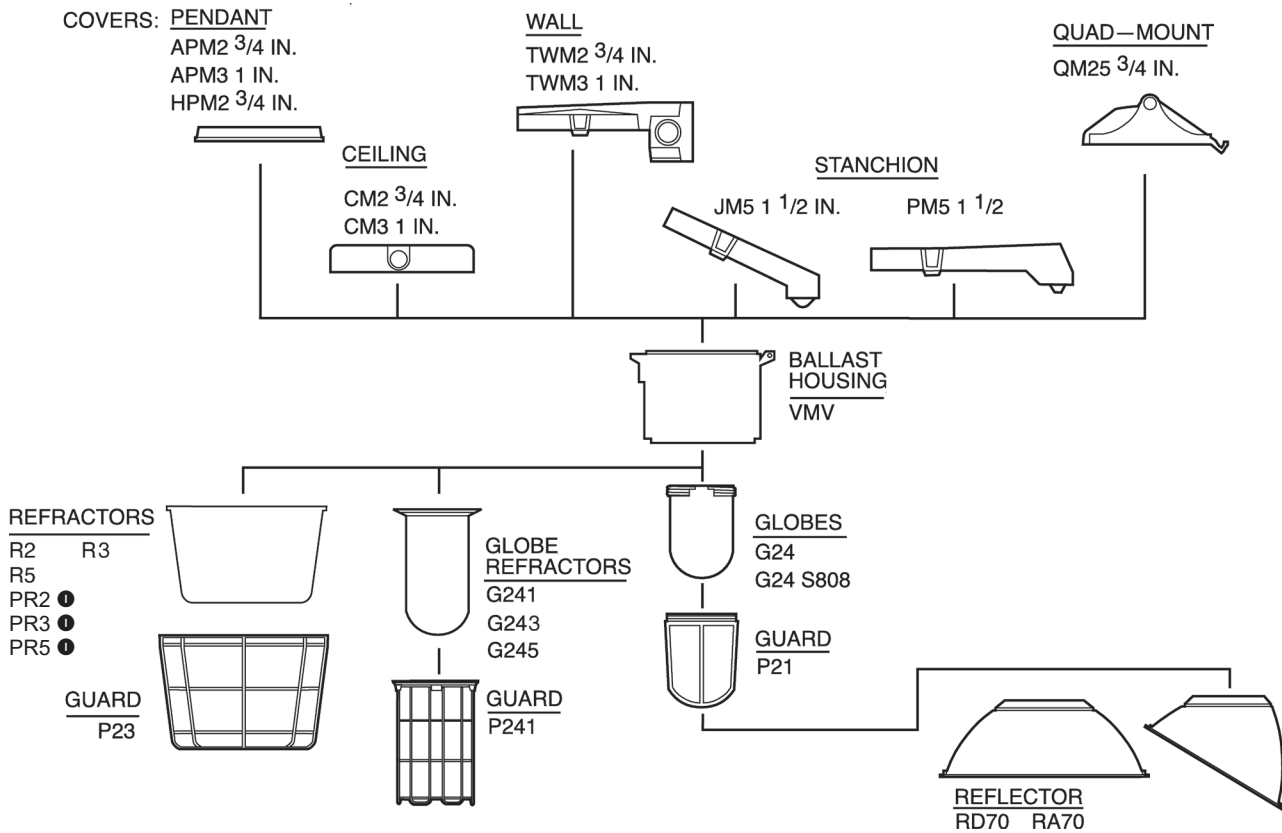

Plastic refractors are for non-hazardous areas only (50-100W max.)

Champ VMV HID luminaires

Cl. I, Div. 2, Groups A, B, C, D
Restricted Breathing Cl. I,
Div. 2 & Zone 2 (with suffix
S826)

Cl. II, Groups E, F, G
Cl. III & Simultaneous
Presence (HPS 50W, 70W)
Marine & Wet Locations
3, 3R, 4, 4X; IP56 to IP66

3L

Temperature performance data:

Cat. #	Lamp		Rated ambient °C	Class I, Div. 2			Group	Class II, Div. 1		Class I, Zone 2		Supply wire suitable for °C	
	Watts	Type		Globe (G24, G241, G245)	Globe (G24) with reflector (RA70, RD70)	Reflector (R2, R3, R5)		Globe (G24) with or without reflector (RA70, RD70)	Simult. Pres. Class I, Div. 1; Class II, Div. 1	Restricted breathing suffix S826 with globe (G24, G241, G245)	Factory sealed suffix S865 AEx nA nR II	Globe (G24, G241, G245)	Reflector (R2, R3, R5)
VMVM70	70	MH	40	T3A	T3A	T3A	–	T3A	–	T5	T3	90	90
VMVM70	70	MH	55	T3	T3	T3	–	T3	–	T4	T3	90	90
VMVM70	70	MH	65	T3	T3	T3	–	T3	–	T4	T3	90	90
VMVM100	100	MH	40	T2D	T2D	T2D	–	T2D	–	T4	T3	90	90
VMVM100 S849	100	MH	40	T2	T2	T2	–	T2	–	T4	T3	75	75
VMVM100	100	MH	55	T2D	T2D	T2D	–	T2D	–	T4	T3	90	90
VMVM150	150	MH	40	T2A	T2A	T2B	–	T2A	–	T3	T3	90	90
VMVM175	175	MH	40	T2A	T2A	T2B	–	T2A	–	T3	T3	90	90
VMVS50	50	HPS	40	T3A	T3A	T3B	EFG	T4A	T3A	T5	T3	75	65
VMVS50	50	HPS	55	T3A	T3A	T3A	EFG	T4	T3	T5	T3	75	75
VMVS50	50	HPS	65	T3	T3	T3	EFG	T4	T2D	T5	T3	75	75
VMVS70	70	HPS	40	T3	T3	T3B	EFG	T3C	T2C	T4	T3	75	65
VMVS70	70	HPS	55	T3	T3	T3	EFG	T3C	T2B	T4	T3	90	90
VMVS100	100	HPS	40	T2C	T2C	T2D	EFG	T3A	T2A	T4	T3	90	75
VMVS100	100	HPS	55	T2B	T2B	T2C	EFG	–	–	T3	T3	105	90
VMVS150	150	HPS	40	T2A	T2A	T2B	–	–	–	T3	T3	90	85
VMVS150	150	HPS	55	T2	T2	T2A	–	–	–	T3	T3	105	105

The Class I, Division 2 T-codes apply to luminaires without the restricted breathing (S826) or factory sealed (S865) options. These luminaires are listed to UL844. UL844 specifies how the temperatures are measured.

The Class I, Zone 2 T-codes are for luminaires that are additionally listed to UL60079-15 that specify a different method for measuring temperatures. Since NEC 501.1 states that equipment "...for use in Class I, Zone 0, 1 or 2 locations shall be permitted in Class I, Division 2 locations..." then these luminaires are suitable for Class I, Division 2 but with cooler temperature ratings. They also have the advantage of meeting the more rigorous mechanical tests of UL844.

Champ VMV HID luminaires

Cl. I, Div. 2, Groups A, B, C, D
Restricted Breathing Cl. I,
Div. 2 & Zone 2 (with suffix
S826)

Cl. II, Groups E, F, G
Cl. III & Simultaneous
Presence (HPS 50W, 70W)
Marine & Wet Locations
3, 3R, 4, 4X; IP56 to IP66

3L

Dimensions (in inches):

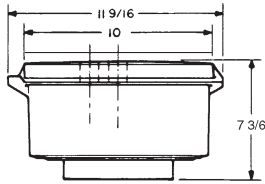

Pendant mount

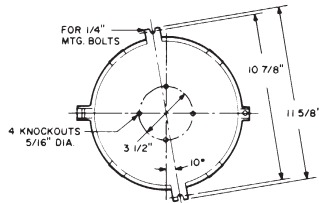

Ceiling mount top view

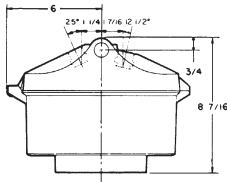

Quad mount

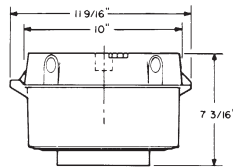

Ceiling mount (5 hubs, 4 plugged)

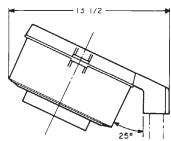

Stanchion mount 25° angle

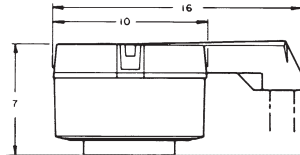

Stanchion mount straight

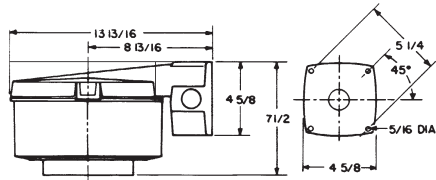

Wall mount (5 hubs, 4 plugged)

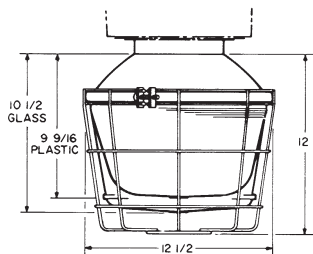

Luminaire with refractors,
guard

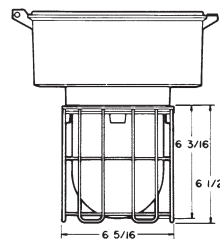

Compact refractor

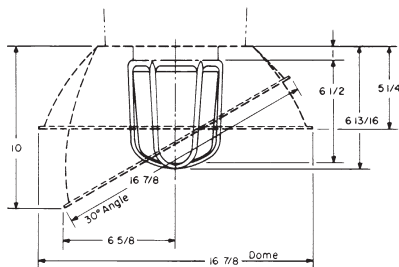

Globe, guard, reflectors

Net luminaire weights:

Luminaire series	Lamp watts				
	50	70	100	150	175
Luminaire with globe, guard (lbs.):					
VMVS	13.50	14.50	14.50	14.50	
VMVM		13.00	13.25		15.50
Luminaire with glass refractor (lbs.):					
VMVS	21.75	22.75	22.75	22.75	
VMVM		21.00	21.50		23.75

Type	Weight (lbs.)	Type	Weight (lbs.)
Add mounting modules:			
Pendant	1.25	Quad	3.50
Flexible pendant	1.50	Stanchion 25° angle	3.50
Ceiling	2.75	Stanchion straight	4.50
Wall	4.50		
Add reflectors:			
Dome	1.50	30° angle	1.50

Deduct: 0.50 lbs. for fixture without P21 guard

3L