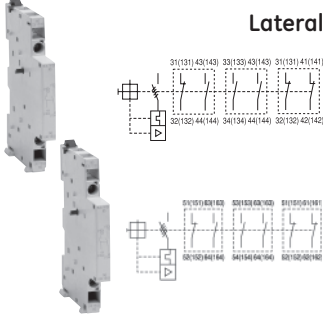
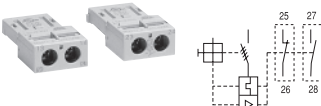

### Auxiliary contact blocks

	Description	For use with	Type	Cat. no.	Ref. no.	Pack.
<b>Frontal</b> 	Maximum 2 auxiliary contact blocks per manual motor starter	GPS1... and GPS2...	1 NO	<b>GPAC10FBA</b>	101303	10
		GPS1... and GPS2...	1 NC	<b>GPAC01FBA</b>	101304	10
<b>Lateral</b> 	Two contacts Side mounting on the <b>left</b>	GPS1... and GPS2...	1 NO + 1 NC	<b>GPAC11LLA</b>	101305	10
		GPS1... and GPS2...	2 NO	<b>GPAC20LLA</b>	101306	10
		GPS1... and GPS2...	2 NC	<b>GPAC02LLA</b>	101307	10
	Two contacts Side mounting on the <b>right</b>	GPS1... and GPS2...	1 NO + 1 NC	<b>GPAC11LRA</b>	101308	10
		GPS1... and GPS2...	2 NO	<b>GPAC20LRA</b>	101309	10
		GPS1... and GPS2...	2 NC	<b>GPAC02LRA</b>	101310	10

### Alarm contact block

	Description	For use with	Type	Cat. no.	Ref. no.	Pack.
	Frontal mounting on the <b>right</b> Single contact	GPS1... and GPS2...	1 NO	<b>GPAL10FRA</b>	101311	10
		GPS1... and GPS2...	1 NC	<b>GPAL01FRA</b>	101312	10

### Auxiliary / alarm contact block

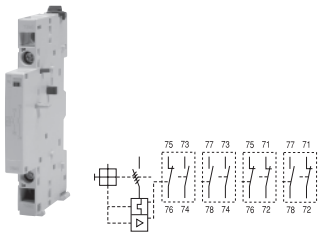
	Description	For use with	Type	Cat. no.	Ref. no.	Pack.
	Side mounting on the <b>left</b> (front alarm contact block can not be used at the same time) Two contacts	GPS1... and GPS2...	1 NO(Alarm)+1 NO(Aux)	<b>GPAD1010LLA</b>	101313	10
		GPS1... and GPS2...	1 NO(Alarm)+1 NC(Aux)	<b>GPAD1001LLA</b>	101314	10
		GPS1... and GPS2...	1 NC(Alarm)+1 NO(Aux)	<b>GPAD0110LLA</b>	101315	10
		GPS1... and GPS2...	1 NC(Alarm)+1 NC(Aux)	<b>GPAD0101LLA</b>	101316	10

### Short-circuit alarm contact block

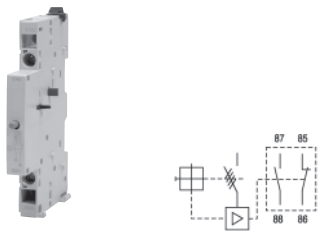
	Description	For use with	Type	Cat. no.	Ref. no.	Pack.
	Side mounting on the <b>left</b> Two contacts NO + NC Mechanical indication marking	GPS1... and GPS2...	1 NO + 1 NC	<b>GPAE11LLA</b>	101317	10

Order codes

Intro

A

B

C

D

E

F

G

H

I

J/X



**Shunt trip device**

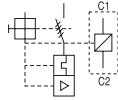

Description	For use with	Coil voltage	Cat. no.	Ref. no.	Pack.
Side mounting on the <b>right</b> Can not be used together with the undervoltage trip device	GPS1... and GPS2...	24V 50/60Hz	GPASLRAA1	101318	5
	GPS1... and GPS2...	48V 60Hz	GPASLRAAF	101319	5
	GPS1... and GPS2...	48V 50Hz / 60V 60Hz	GPASLRAAG	101320	5
	GPS1... and GPS2...	110/127V 50Hz / 120V 60Hz	GPASLRAAJ	101321	5
	GPS1... and GPS2...	208V 60Hz	GPASLRAAM	101322	5
	GPS1... and GPS2...	220/230V 50Hz / 240/260V 60Hz	GPASLRAAN	101323	5
	GPS1... and GPS2...	240V 50Hz / 277V 60Hz	GPASLRAAR	101324	5
	GPS1... and GPS2...	380/400V 50Hz	GPASLRAAU	101325	5
	GPS1... and GPS2...	415/440V 50Hz / 460/480V 60Hz	GPASLRAAW	101326	5
	GPS1... and GPS2...	500V 50Hz / 600V 60Hz	GPASLRAAY	101327	5
	GPS1... and GPS2...	24 to 60Vdc	GPASLRADD	101328	5
	GPS1... and GPS2...	110 to 240Vdc	GPASLRADJ	101329	5
	GPS1... and GPS2...	100V 50/60Hz	GPASLRAA11	101194	5

**Undervoltage trip device**

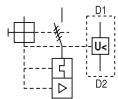

Description	For use with	Coil voltage	Cat. no.	Ref. no.	Pack.
Side mounting on the <b>right</b> Can not be used together with the shunt trip device	GPS1... and GPS2...	24V 50Hz	GPAULRAAD	101330	10
	GPS1... and GPS2...	24V 60Hz	GPAULRAAC	101331	10
	GPS1... and GPS2...	48V 50Hz	GPAULRAAG	101332	10
	GPS1... and GPS2...	48V 60Hz	GPAULRAAF	101333	10
	GPS1... and GPS2...	110/127V 50Hz / 120V 60Hz	GPAULRAAJ	101334	10
	GPS1... and GPS2...	208V 60Hz	GPAULRAAM	101335	10
	GPS1... and GPS2...	220/230V 50Hz / 240/260V 60Hz	GPAULRAAN	101336	10
	GPS1... and GPS2...	240V 50Hz / 277V 60Hz	GPAULRAAR	101337	10
	GPS1... and GPS2...	380/400V 50Hz	GPAULRAAU	101338	10
	GPS1... and GPS2...	415/440V 50Hz / 460/480V 60Hz	GPAULRAAW	101339	10
	GPS1... and GPS2...	500V 50Hz / 600V 60Hz	GPAULRAAY	101340	10
	GPS1... and GPS2...	100V 50/60Hz	GPAULRAA11	102625	10

**With 2NO early make auxiliary contacts**

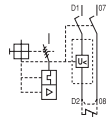

Description	For use with	Coil voltage	Cat. no.	Ref. no.	Pack.
Side mounting on the <b>right</b> Can not be used together with the shunt trip device	GPS1*S...	24V 50Hz	GPAU20LTAAD	101341	10
	GPS1*S...	24V 60Hz	GPAU20LTAAC	101342	10
	GPS1*S...	48V 50Hz	GPAU20LTAAG	101343	10
	GPS1*S...	48V 60Hz	GPAU20LTAAF	101344	10
	GPS1*S...	110/127V 50Hz / 120V 60Hz	GPAU20LTAAJ	101345	10
	GPS1*S...	208V 60Hz	GPAU20LTAAM	101346	10
	GPS1*S...	220/230V 50Hz / 240/260V 60Hz	GPAU20LTAAN	101347	10
	GPS1*S...	240V 50Hz / 277V 60Hz	GPAU20LTAAR	101348	10
	GPS1*S...	380/400V 50Hz	GPAU20LTAAU	101349	10
	GPS1*S...	415/440V 50Hz / 460/480V 60Hz	GPAU20LTAAW	101350	10
	GPS1*S...	500V 50Hz / 600V 60Hz	GPAU20LTAAY	101351	10
	GPS1*S...	100V 50/60Hz	GPAU20LTA11	110360	10

**With 2NO early make auxiliary contacts**

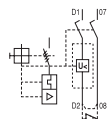

Description	For use with	Coil voltage	Cat. no.	Ref. no.	Pack.
Side mounting on the <b>right</b> Can not be used together with the shunt trip device	GPS1*H and GPS2...	24V 50Hz	GPAU20LCAAD	101352	10
	GPS1*H and GPS2...	24V 60Hz	GPAU20LCAAC	101353	10
	GPS1*H and GPS2...	48V 50Hz	GPAU20LCAAG	101354	10
	GPS1*H and GPS2...	48V 60Hz	GPAU20LCAAF	101355	10
	GPS1*H and GPS2...	110/127V 50Hz / 120V 60Hz	GPAU20LCAAJ	101356	10
	GPS1*H and GPS2...	208V 60Hz	GPAU20LCAAM	101357	10
	GPS1*H and GPS2...	220/230V 50Hz / 240/260V 60Hz	GPAU20LCAAN	101358	10
	GPS1*H and GPS2...	240V 50Hz / 277V 60Hz	GPAU20LCAAR	101359	10
	GPS1*H and GPS2...	380/400V 50Hz	GPAU20LCAAU	101360	10
	GPS1*H and GPS2...	415/440V 50Hz / 460/480V 60Hz	GPAU20LCAAW	101361	10
	GPS1*H and GPS2...	500V 50Hz / 600V 60Hz	GPAU20LCAAY	101362	10
	GPS1*H and GPS2...	100V 50/60Hz	GPAU20LCA11	112185	10

**Terminal protector**

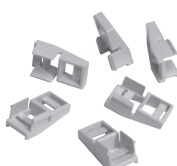

101509

107182



Description	For use with	Cat. no.	Ref. no.	Pack.
Snap-in tabs for screw mounting (set of 10)	GPS1*	GPAKS1A	101509	1
IP20 terminal covers	GPS2*	GPAPT2A	107182	50
DIN rail vibration clamps	GPS1* / GPS2*	GPVDA	101514	2
Panel vibration clamps	GPS1* / GPS2*	GPVPA	101515	2
Increases vibration resistance of GPS1* from 5G to 8G (5-150 Hz) in all directions. One clamp must be mounted on each side which increases total mounting width by 22 mm (0.87"). For vibration resistance of GPS2*, contact customers service.				



### External handle operator

	Description	For use with	Type	Cat. no.	Ref. no.	Pack.	
	Used for distance mounting on a panel Lockable with 1, 2 or 3 padlocks diameter 4 to 8 mm Two types: standard and emergency applications ON/OFF/TRIPPING position marking Protection degree: IP54 Shaft mounting depths: 139.8 - 289.8 mm for GPA1HAB, GPA1HAR 161 - 311.1 mm for GPA2HAB, GPA2HAR Package parts and quantities: 1 handle unit 1 shaft 1 shaft guide 1 latch (screws) 4 mounting screws	GPS1*H...	Standard (black)	<b>GPA1HAB</b>	101363	5	
		GPS1*H ...	Emergency (red/yellow)	<b>GPA1HAR</b>	101364	5	
		GPS2...	Standard (black)	<b>GPA2HAB</b>	101502	5	
		GPS2 ...	Emergency (red/yellow)	<b>GPA2HAR</b>	101503	5	

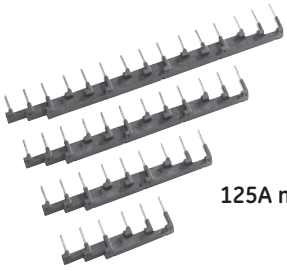
### Busbar system

	Description	For use with	Connection	Cat. no.	Ref. no.	Pack.
 <p><b>3-phase feed-in terminals</b></p>	Main feeding terminal Upper connection	GPS1...	Terminal capacity: 25 mm <sup>2</sup> Pin	<b>GPB1FA</b>	107186	10
		GPS2...	Terminal capacity: 50 mm <sup>2</sup> Pin	<b>GPB2FA</b>	107187	10
		GPS1...	Terminal capacity: 25mm <sup>2</sup> Fork	<b>SFVB8</b>	254537	1
 <p><b>Main busbar 63A max.</b></p>	Modular spacing 45 mm	for 2 GPS1... + frontal auxiliaries	Pin	<b>GPB1B02A</b>	101390	5
		for 3 GPS1... + frontal auxiliaries	Pin	<b>GPB1B03A</b>	101391	5
		for 4 GPS1... + frontal auxiliaries	Pin	<b>GPB1B04A</b>	101392	5
		for 5 GPS1... + frontal auxiliaries	Pin	<b>GPB1B05A</b>	101393	5
	Modular spacing 54 mm	for 2 GPS1... + 9mm lateral aux.	Pin	<b>GPB1B12A</b>	101394	5
		for 3 GPS1... + 9mm lateral aux.	Pin	<b>GPB1B13A</b>	101395	5
		for 4 GPS1... + 9mm lateral aux.	Pin	<b>GPB1B14A</b>	101396	5
		for 5 GPS1... + 9mm lateral aux.	Pin	<b>GPB1B15A</b>	101397	5
Modular spacing 63 mm	for 2 GPS1... + 18mm lateral aux. or 2 x 9mm lateral auxiliary	Fork	<b>GPB1B22A</b>	101398	10	
	for 4 GPS1... + 18mm lateral aux. or 2 x 9mm lateral auxiliary	Fork	<b>GPB1B24A</b>	101399	10	
Modular spacing 55 mm	for 2 GPS2... + frontal auxiliaries	Pin	<b>GPB2B02A</b>	101400	1	
	for 3 GPS2... + frontal auxiliaries	Pin	<b>GPB2B03A</b>	101401	1	
	for 4 GPS2... + frontal auxiliaries	Pin	<b>GPB2B04A</b>	101402	1	
Modular spacing 64 mm	for 2 GPS2... + 9mm lateral aux.	Pin	<b>GPB2B12A</b>	101403	1	
	for 3 GPS2... + 9mm lateral aux.	Pin	<b>GPB2B13A</b>	101404	1	
	for 4 GPS2... + 9mm lateral aux.	Pin	<b>GPB2B14A</b>	101405	1	
Modular spacing 73 mm	for 2 GPS2... + 18mm lateral aux. or 2 x 9mm lateral auxiliary	Pin	<b>GPB2B22A</b>	101406	1	
	for 4 GPS2... + 18mm lateral aux. or 2 x 9mm lateral auxiliary	Pin	<b>GPB2B24A</b>	101407	1	
 <p><b>Busbar cover</b></p>	Touch guard for non used space	GPS1...	Pin	<b>GPB1GA</b>	101408	10
		GPS1...	Fork	<b>GPB1GAF</b>	101511	1
		GPS2...	Pin	<b>GPB2GA</b>	101409	10
 <p><b>Terminal cover type E</b></p>	For compliance UL508E	GPS1...H	-	<b>GPAPT1E</b>	107315	1
		When using a Surion GPS1*BH as a manual self-protected combination motor starter (Type E). Cover enables compliance with NEC Section 430-52, 1" over air creepage and over surface clearance, phase to phase on the line side.				

Order codes

Intro

A

B

C

D

E

F

G

H

I

J/X

