

## LTNM COUPLINGS

Southwire<sup>®</sup> SIMPush<sup>™</sup> LTNM couplings are used in dry or wet locations to connect the end of two UL-approved Type B LTNM conduits. Removable and reusable with SIMPush<sup>™</sup> removal tool.

### FEATURES:

- Durable PVC construction
- PVC internal stiffener for LTNM only
- Internally coated with lubricating grease
- Tested to 100 removal cycles for reuse
- Locking teeth are constructed from zinc-plated steel

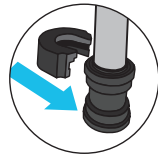
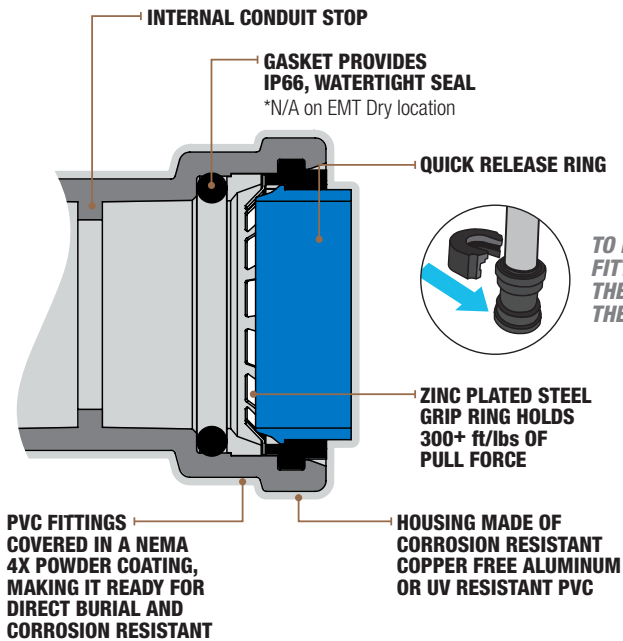

*TO REMOVE THE SIMPush<sup>™</sup> FITTING, SIMPLY SLIDE THE REMOVAL TOOL ONTO THE COLLAR AND PULL*

## 1/2" – 1"



**CERTIFICATIONS/RATINGS:**  
**NEMA FB RATED (4X)**  
**E-FILE #: E474447**



PVSC050, PVSC075, PVSC100

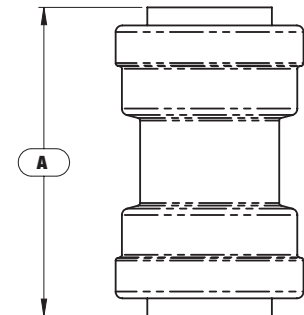
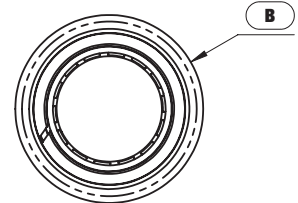

Stock #	Model #	Trade Size	Quantity Per Box	H (in.) A	W (in.) B	L (in.) B	Associated Removal Tool Model #	Removal Tool Included
<b>CONTRACTOR PACK</b>								
67599602	LTNM-CP-050WT	1/2"	30	2.325	1.419	1.419	PLT-RT-1P	YES
67599702	LTNM-CP-075WT	3/4"	24	2.437	1.653	1.653	PLT-RT-1P	YES
67599802	LTNM-CP-100WT	1"	20	2.543	1.929	1.929	PLT-RT-100	YES

Project Name:
Contractor:
Address: