

TC Cable Connector

Tray Cable

Class I, Division 2, Groups A, B, C, D
 Class II, Division 2, Groups E, F, G
 Class III, Division 2
 NEMA Type 4X

Applications

- Type TC cable connector is suitable for use with type (TC) tray cable in ordinary, wet and hazardous locations including:
 - Class I, Division 2, where permitted by code
 - Class I, Zone 1 AEx e and Ex e, where permitted by code
 - Ingress protection to NEMA 4X and IP66/67/68

Features

- The unique use of the seal insert, enables each gland size to terminate the widest range available in a single hub size.
- Continuous operating temperature: -60 °C/-76 °F to 110 °C/230 °F.
- Jacket sealing technique: compensating displacement seal
- Sealing area(s) — cable outer jacket

Material/Finish

- Connector: copperfree (4/10 of 1% max) aluminium, stainless steel or electroless nickel plated brass in NPT (standard) and metric thread forms

Options

- Adaptor/reducer, earth tag

Certifications and Compliances

- Design Specification: BS 6121:Part 1989, UL514B, UL2225, CSA 22.2 No. 30, CAN/CSA E60079-0, CAN/CSA E60079-7
- ATEX Certification/Code of Protection Category: SIRA09ATEX1092X
ATEX II 2 GD, Ex d IIC Gb, Ex e IIC Gb, Ex ta IIIC Da
- IECEx Approval Number/Code of Protection Category: IECEx SIR 09.0042X
Exd IIC Gb, Exe IIC Gb, Exta IIIC Da
- cCSAus Certification Number: CSA.09.2220601X

Entry Thread C		Cable Range A Insert (Inches/Millimeters)		Cable Range B No Insert (Inches/Millimeters)		Order Reference		
NPT	NPT Option	Min	Max	Min	Max	Aluminium	NP Brass	Stainless Steel *
1/2"	—	—	—	0.13/3.3	0.28/7.1	TC050028	TC050028NB	TC050028SS
—	3/4"	—	—	0.13/3.3	0.28/7.1	TC075028	TC075028NB	TC075028SS
1/2"	—	0.26/6.6	0.41/10.4	0.41/10.4	0.55/13.9	TC050055	TC050055NB	TC050055SS
—	3/4"	0.26/6.6	0.41/10.4	0.41/10.4	0.55/13.9	TC075055	TC075055NB	TC075055SS
3/4"	—	0.47/11.9	0.61/15.5	0.61/15.5	0.79/20.1	TC075079	TC075079NB	TC075079SS
—	1"	0.47/11.9	0.61/15.5	0.61/15.5	0.79/20.1	TC100079	TC100079NB	TC100079SS
1"	—	0.67/17.0	0.85/21.6	0.85/21.6	1.04/26.4	TC100104	TC100104NB	TC100104SS
—	1-1/4"	0.67/17.0	0.85/21.6	0.85/21.6	1.04/26.4	TC125104	TC125104NB	TC125104SS
1-1/4"	—	0.92/23.4	1.10/27.9	1.10/27.9	1.27/32.3	TC125127	TC125127NB	TC125127SS
—	1-1/2"	0.92/23.4	1.10/27.9	1.10/27.9	1.27/32.3	TC150127	TC150127NB	TC150127SS
1-1/2"	—	1.22/30.9	1.37/34.8	1.37/34.8	1.50/38.1	TC150150	TC150150NB	TC150150SS
—	2"	1.22/30.9	1.37/34.8	1.37/34.8	1.50/38.1	TC200150	TC200150NB	TC200150SS
2"	—	—	—	1.40/35.6	1.74/44.2	TC200174	TC200174NB	TC200174SS
—	2-1/2"	—	—	1.40/35.6	1.74/44.2	TC250174	TC250174NB	TC250174SS
2"	—	—	—	1.63/41.4	1.97/50.0	TC200197	TC200197NB	TC200197SS
—	2-1/2"	—	—	1.63/41.4	1.97/50.0	TC250197	TC250197NB	TC250197SS
2-1/2"	—	—	—	1.86/47.2	2.20/55.9	TC250220	TC250220NB	TC250220SS
—	3"	—	—	1.86/47.2	2.20/55.9	TC300220	TC300220NB	TC300220SS
2-1/2"	—	—	—	2.13/54.1	2.44/61.9	TC250244	TC250244NB	TC250244SS
—	3"	—	—	2.13/54.1	2.44/61.9	TC300244	TC300244NB	TC300244SS
3"	—	—	—	2.40/60.9	2.68/68.1	TC300268	TC300268NB	TC300268SS
—	3-1/2"	—	—	2.40/60.9	2.68/68.1	TC350268	TC350268NB	TC350268SS
3-1/2"	—	—	—	2.62/66.5	3.15/80.0	TC350315	TC350315NB	TC350315SS
—	4"	—	—	2.62/66.5	3.15/80.0	TC400315	TC400315NB	TC400315SS
4"	—	—	—	2.99/75.9	3.54/89.9	TC400354	TC400354NB	TC400354SS

* Priced by quote only. Contact your factory representative for assistance.

TC Cable Connector

Tray Cable

Class I, Division 2, Groups A, B, C, D
 Class II, Division 2, Groups E, F, G
 Class III, Division 2
 NEMA Type 4X

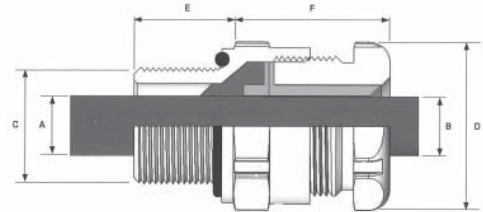

Across Flats D	Across Corners D	Min. Thread Length E	Nominal Assembly Length F	Approx. Weight Aluminum (Oz/G)
1.20/30.5	1.30/33.0	0.78/19.8	0.79/20.1	1.94/55.0
		0.80/20.3		1.94/55.0
1.20/30.5	1.30/33.0	0.78/19.8	0.79/20.1	1.69/48.0
		0.80/20.3		1.69/48.0
1.48/37.6	1.60/40.6	0.80/20.3	0.98/24.9	3.17/90.0
		0.98/24.9		
1.81/45.9	1.95/49.5	0.98/24.9	0.98/24.9	3.88/110.0
		1.00/25.4		
2.05/52.1	2.21/56.1	1.00/25.4	1.18/29.9	4.94/140.0
		1.03/26.2		
2.36/59.9	2.55/64.8	1.03/26.2	1.26/32.0	6.00/170.1
		1.06/26.9		
2.95/74.9	3.19/81.0	1.06/26.9	1.26/32.0	8.64/245.0
		1.57/39.9		
2.95/74.9	3.19/81.0	1.06/26.9	1.65/41.9	8.29/235.0
		1.57/39.9		
3.54/89.9	3.82/97.0	1.57/39.9	1.65/41.9	13.58/385.0
		1.63/41.4		
3.54/89.9	3.82/97.0	1.57/39.9	1.69/42.9	13.58/385.0
		1.63/41.4		
4.33/109.9	4.68/118.9	1.63/41.4	1.69/42.9	26.63/755.0
		1.68/42.7		
4.84/122.9	5.23/132.8	1.68/42.7	2.28/57.9	34.22/970.1
		1.73/43.9		
5.25/133.4	5.67/144.0	1.73/43.9	2.28/57.9	38.80/1100.0