

ITEM NO.	DESCRIPTION	QTY.
1	VISUAL FAULT LOCATOR WITH DUST CAP	1
2	1.25mm FERRULE ADAPTER	1
3	AA BATTERIES	2
4	RUBBER END BUMBERS	2
5	WRIST STRAP	1
6	BELT CASE	1

CATALOG NUMBER	DESCRIPTION
OFVFLKT1	VISUAL FAULT LOCATOR FOR LC, SC, ST, FC, MU

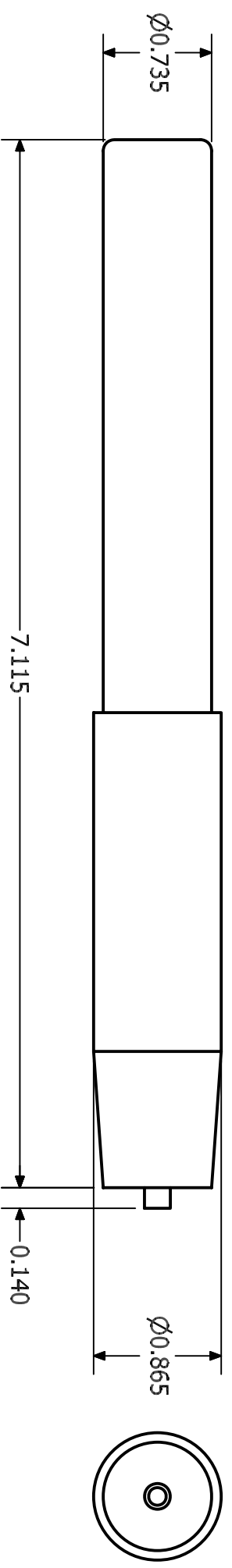
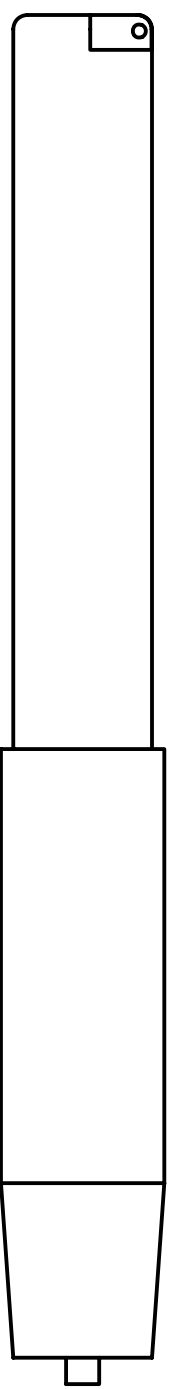

NOTES:
 1. SPECIFICATION SUBJECT TO CHANGE WITHOUT NOTICE
 2. WAVELENGTH TO BE 650nm ± 5 nm, LASER TO BE CLASS IIIa
 3. FIBER-COUPLED OUTPUT: 0db TYPICAL, -3.5db MINIMUM (SINGLEMODE FIBER)
 4. OPERATING TEMPERATURE: -10°C TO 50°C

REV.	ECN	DATE	DESCRIPTION	CHG BY	APPD BY
1	16453	9/27/10	INITIAL RELEASE	CG	

Created on AUTOCAD		DIMENSIONING AND TOLERANCE PER ANSI Y14.5M-1982 UNLESS OTHERWISE SPECIFIED, DIMENSIONS ARE IN INCHES (MM). TOLERANCES .XX = ± 0.01 (.25) .XXX = ± 0.005 (.127) .XXXX = ± 0.0025 (.0635) ANGLE TOL. $\pm 1^\circ$	
IN ACCEPTING OUR DRAWINGS, BLUEPRINTS, OR SUPPORTING DOCUMENTATION FOR QUOTATION OR OTHER PURPOSES, YOU AGREE NOT TO DISCLOSE TO OTHERS THE IDEAS, INFORMATION, OR DESIGNS SHOWN HEREIN, AND THAT YOU WILL MAKE NO USE OF SAME WITHOUT PERMISSION		PROJECT REFERENCE: 2009-035	HUBBELL Hubbell Premise Wiring HUBBELL INCORPORATED (Delaware) 14 Lord's Hill Road, Stonington, Connecticut 06378
DRAWN BY: C. GRIBBLE 9/27/10		MATERIAL: SEE TABULATION	TITLE: VISUAL FAULT LOCATOR WITH 1.25mm AND 2.5mm FERRULE ADAPTERS
CHECKED BY:		APPROVED BY:	SIZE: B DRAWING NO. HWS775274C SCALE: NTS
			REV. 1 SHEET 1 OF 1