

THIS COPY IS PROVIDED ON A RESTRICTED BASIS AND IS NOT TO BE USED IN ANY WAY DETRIMENTAL TO THE INTERESTS OF PANDUIT CORP.

PANDUIT PART NUMBER	WEIGHT
WGEXS**	.40 LBS (182.9 g)

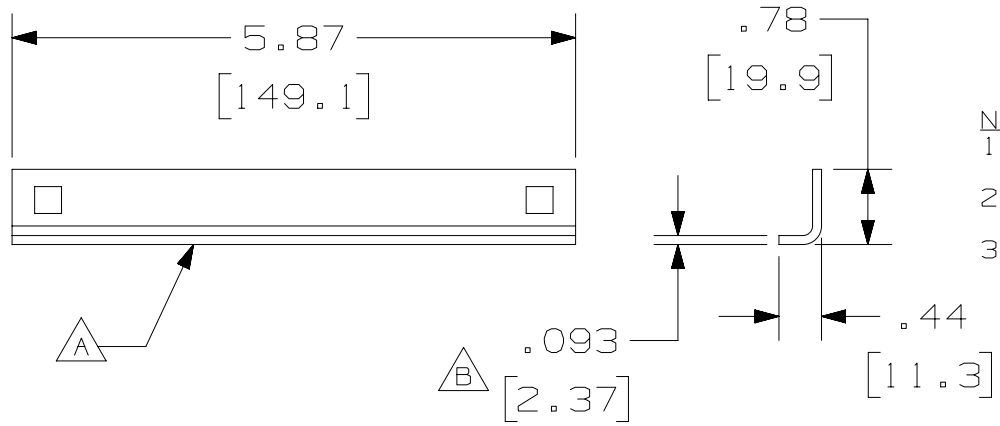

EXPANSION SPLICE BRACKET

NOTES:

1. SEE CURRENT CATALOG FOR ADDITIONAL PART SUFFIXES TO INDICATE PACKAGE QUANTITY.
2. THE WYR-GRID EXPANSION SPLICE IS USED TO CONNECT TWO WYR-GRID PATHWAYS TOGETHER.
3. THE WYR-GRID EXPANSION SPLICE PACKAGE CONTAINS A PAIR OF EXPANSION SPLICE BRACKETS AND FOUR EXPANSION SPLICE CLIPS. EACH WYR-GRID EXPANSION SPLICE CONSIST OF:  
TWO (2) WYR-GRID EXPANSION SPLICE BRACKET  
FOUR (4) WYR-GRID EXPANSION SPLICE CLIP  
FOUR (4) 1/4-20 X 3/4 ROUND HEAD SQUARE NECK SCREW

4. FOUR (4) 1/4-20 HEX KEPS NUT  
THE BLACK VERSION OF THIS PART WILL NOT PROVIDE A BONDED CONNECTION BETWEEN TRAY SECTIONS.
5. ALL DIMENSIONS IN PARENTHESES ARE METRIC.

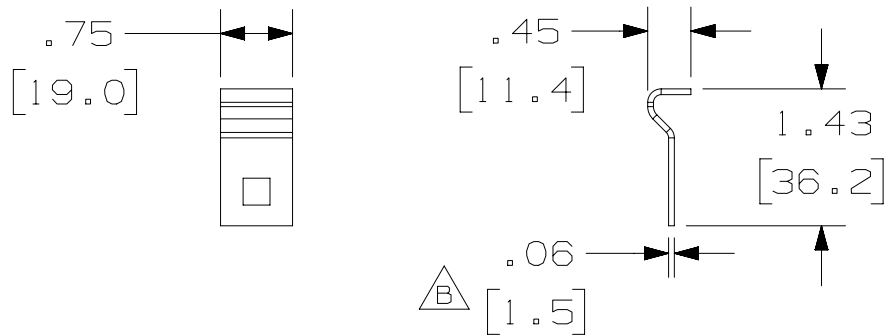

EXPANSION SPLICE CLIP

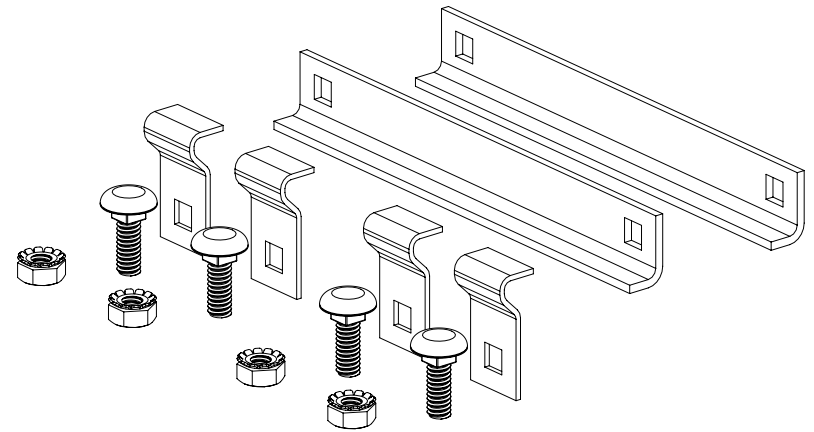

02A	03-26-15	SSP	DWW		D. ADDED NOTE 4 TO GENERAL NOTES C. ADDED TOLERANCES B. ADDED DIMENSION A. REVISED EXPANSION SPLICE	V09000ID			
01A	01-06-15	SSP	DWW	AJCH	RELEASED TO PRODUCTION	V09000EK			
REV	DATE	BY	CHK	APR	DESCRIPTION	ECN			

TITLE		WYR-GRID EXPANSION SPLICE (WGEXS**)	
CUSTOMER DRAWING			
ITEM REVISION NAME		13D413BG/02	
DATASET FILE NAME		13D413BG_DC/02A WGEXS	
UNLESS OTHERWISE SPECIFIED, DIMENSIONAL TOLERANCES ARE: IN [ mm ]		MATERIAL:	
.x ± .xxx ± .010 [ .25 ]		STEEL	
.xx ± .025 [ .66 ] ANGLES ±		DRAWING NUMBER:	
THIRD ANGLE PROJECTION		13D413BG-DC	
DRAWN BY	DATE	CHK	SCALE
SSP	01-06-15	DWW	NONE
SHT 1 OF 1		SIZE	
		A	