

RIGID PVC CONDUIT FITTINGS

ISSUE DATE:
DATE D'EMISSION: 2009 10 01

6X6X6 JUNCTION BOXES

SUPERCEDES:
REPLACE: 2004 07 15

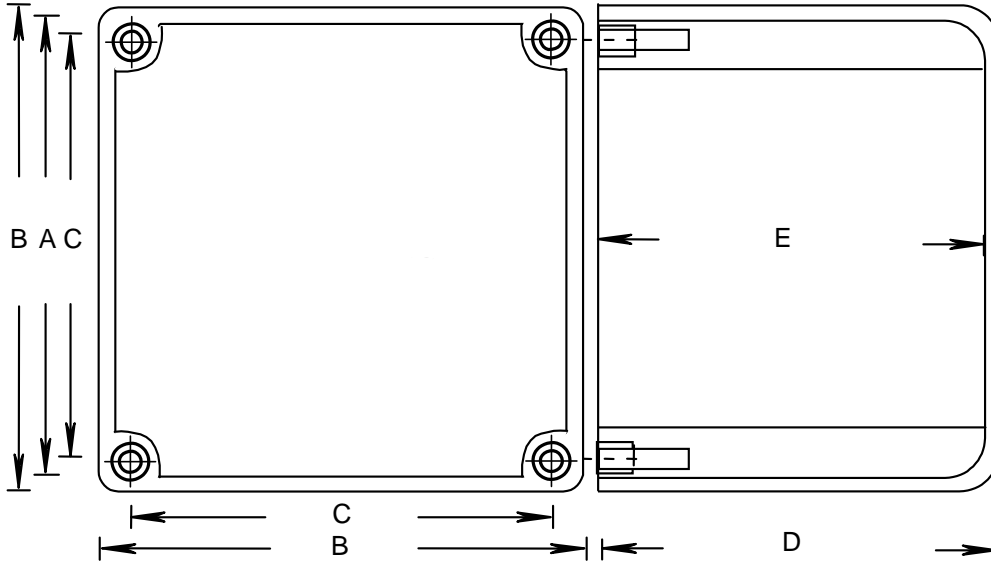

PRODUCT CODE	PART NUMBER	NOMINAL SIZE		A		B		C	
		(in)	(mm)	(in)	(mm)	(in)	(mm)	(in)	(mm)
077698	JB 666	6	155	6.000	152	6.375	162	5.813	148
077078*	JB 664 ORENCO	6	155	6.000	152	6.375	162	5.813	148
077697	JB664	6	155	6.000	152	6.375	162	5.813	148
076262	AMJB 664 ALLIED	6	155	6.000	152	6.375	162	5.813	148
076263	AMJ666 ALLIED	6	155	6.000	152	6.375	162	5.813	148
076691	J666 STAHLIN	6	155	6.000	152	6.375	162	5.813	148

PRODUCT CODE	PART NUMBER	NOMINAL SIZE		D		E		VOLUME	
		(in)	(mm)	(in)	(mm)	(in)	(mm)	(cu. in)	(cu. cm)
077698	JB 666	6	155	6.185	157	6.000	152	211.0	3460.4
077078*	JB 664 ORENCO	6	155	4.150	105	3.490	89	138.0	2263.2
077697	JB664	6	155	4.150	105	3.490	89	138.0	2263.2
076262	AMJB 664 ALLIED	6	155	4.150	105	3.490	89	138.0	2263.2
076263	AMJ666 ALLIED	6	155	6.185	157	6.000	152	211.0	3460.4
076691	J666 STAHLIN	6	155	6.185	157	6.000	152	211.0	3460.4

PRODUCT CODE	PART NUMBER	NOMINAL SIZE		GASKET CODE	INSERT CODE	SCREW CODE	M.FEET CODE
		(in)	(mm)				
077698	JB 666	6	155	097734	072539 (8)	072513 (8)	097747(4)
077078*	JB 664 ORENCO	6	155	097734	072539 (2)	072513 (2) 074564 (4)	097747(4)
077697	JB664	6	155	097734	072539 (8)	072513 (8)	097747(4)
076262	AMJB 664 ALLIED	6	155	097734	072539 (8)	072513 (8)	097747(4)
076263	AMJ666 ALLIED	6	155	097734	072539 (8)	072513 (8)	097747(4)
076691	J666 STAHLIN	6	155	097734	072539 (8)	072513 (8)	097747(4)

COVER DIMENSIONS

