

# Stainless steel cable ties and accessories

## Ties, accessories and tools

ABB has a complete package of stainless steel cable ties and accessories that are easy to apply and superior in quality.

### Stainless steel cable ties and accessories

These products have been designed for tying, lashing and identification applications in demanding environments such as boiler rooms, chemical plants, refineries, pulp/paper mills, shipyards and offshore oil platforms. They are made of a variety of high-quality stainless steel materials which offer excellent corrosion resistance, high temperature and durability characteristics. There is also a variety of high-quality installation and identification tools to complete your cable tie accessory needs. For cable bundling, I.D. tags and other general bundling applications – especially in hazardous environments – ABB Stainless steel cable ties provide a strong, safe, permanent installation with a unique, dual lock.

The Type 304 stainless steel ties are completely fireproof – no toxic fumes, no sagging cables. They are extremely resistant to corrosion and UV light, with the ability to withstand the harshest temperature extremes. Yet they are surprisingly economical.

The low-profile ties are fast and easy to apply. A quick squeeze of the installation tool forms two strong locks – a dimple lock and a fold lock. Their two-piece configuration adds to its versatility. Available in standard lengths to wrap bundle diameters from 1 to 10 inches, ABB Stainless steel cable ties can be supplied in other lengths on special order.

Low-profile ABB stainless steel ties are fireproof and resist corrosion, UV light and extreme weather conditions for safe, permanent cable bundling.

### Installation hand tool

The installation hand tool is a lightweight, pocket size hand tool which quickly and easily applies the stainless steel cable ties.

To use, simply separate the pull-up handle from the body, push the release lever down and insert the clamp tail as far as possible. Squeeze the pull-up handle until the band is tight. Finally, move the pull-up handle to the locking/cut-off position by moving it away from the body as far as it will go. Then squeeze to form the dual lock and cut off the excess tail.

### Cable tie type

- SS** = Two-piece solid stainless steel cable tie, Type 304
- TYS** = Multi-lock stainless steel cable tie, Type 316
- SSH** = Heavy-duty stainless steel clamp, Type 201
- TS** = Roller bar locking stainless steel cable tie, Type 302/304
- LS** = Ball locking stainless steel cable tie, Type 302/304/316

—  
01 Dual Lock  
The tail is formed into a fold lock behind the buckle. The tool forces a dimple in the band into a hole in the buckle.

—  
02 After wrapping the object to be tied, insert the free end of the tie through the buckle and into the tool.

—  
03 Squeeze the handle of the tool to create the dual lock and cut off the tail. The cable tie forms a low-profile dual lock.

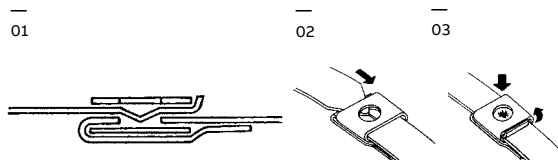

## Stainless steel cable ties and accessories

### Two-Piece solid – Type SS



#### Characteristics

- Strong, slip-free ties with a unique dual lock
- Low-profile, single wrap ties
- Dual locking mechanism
- No slipping
- Perfect for bundling cables and wires and identification labeling

#### Technical information

- Material - Moulding: 304 Stainless Steel  
Add suffix -316 for 316 Stainless Steel.
- Temperature range: -80°C to +538°C  
(-112°F to +1000°F)

### Two-Piece solid – Type SS



E49405

Cat. n°.	Wire bundle dia.		Length L		Width W		Tensile Strength		Std. pkg. [pcs]
	[mm]	[in.]	[mm]	[in.]	[mm]	[in.]	[lb]	[N]	
<b>Mini stainless steel cable ties</b>									
SS7-180	25	1.00	165	6.5	4.5	0.18	100	445	100
SS10-180	51	2.00	254	10.0	4.5	0.18	100	445	100
SS16-180	102	4.00	406	16.0	4.5	0.18	100	445	100
SS23-180	152	6.00	572	22.5	4.5	0.18	100	445	100
SS29-180	203	8.00	737	29.0	4.5	0.18	100	445	100
<b>Standard stainless steel cable ties</b>									
SS10-250	51	2.00	254	10.0	6.35	0.25	250	1,112	100
SS17-250	102	4.00	419	16.5	6.35	0.25	250	1,112	100
SS23-250	152	6.00	572	22.5	6.35	0.25	250	1,112	100
SS29-250	203	8.00	737	29.0	6.35	0.25	250	1,112	100
SS35-250	254	10.00	889	35.0	6.35	0.25	250	1,112	100

Description of materials and properties: see pages C132 to C144

#### Tooling



**WTA290**  
Hand tool to apply mini stainless steel cable ties;  
See page C51.



**WTA250**  
Hand tool to apply standard stainless steel cable ties;  
See page C51.

#### Diagram

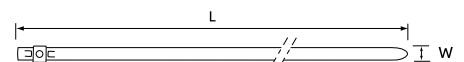

## Stainless steel cable ties and accessories

### Multi-Lok™ self-locking – Type TYS



#### Characteristics

- Corrosion-resistant, providing a safe, strong, worry-free hold
- Unique, self-locking, multiple-locking system holds in excess of 250 lb
- Without slip
- Perfect for bundling cables in corrosive and hazardous environments

#### Technical information

- Material - Moulding: Type 316 stainless steel
- Version without and with coating
- Polyamide 11 weather-resistant coating is unaffected by UV sunlight, resistant to corrosion, chemicals, weathering and protects cable insulation
- Coating is halogen-free and non-toxic
- Temperature range:  
Uncoated: -40°C to 300°C (-40°F to 572°F)  
Coated: -60°C to 165°C (-76°F to 329°F)



#### Multi-Lok self-locking – Type TYS

Cat. n°	Wire bundle dia.		Length L		Width w		Tensile Strength		Std. pkg. [pcs]
	[mm]	[in.]	[mm]	[in.]	[mm]	[in.]	[lb]	[N]	
<b>Acier inoxydable 316 – Uncoated</b>									
TYS6-280	25 - 33	0.98 - 1.30	150	6.0	7.0	0.28	250	1,112	100
TYS9-280	25 - 57	0.98 - 2.24	225	9.0	7.0	0.28	250	1,112	100
TYS12-280	25 - 81	0.98 - 3.19	300	12.0	7.0	0.28	250	1,112	100
TYS18-280	25 - 129	0.98 - 5.08	450	18.0	7.0	0.28	250	1,112	100
TYS24-280	25 - 180	0.98 - 7.09	610	24.0	7.0	0.28	250	1,112	100
TYS6-470	25 - 33	0.98 - 1.30	150	6.0	12.0	0.47	250	1,112	100
TYS9-470	25 - 57	0.98 - 2.24	225	9.0	12.0	0.47	250	1,112	100
TYS12-470	25 - 81	0.98 - 3.19	300	12.0	12.0	0.47	250	1,112	100
TYS18-470	25 - 129	0.98 - 5.08	450	18.0	12.0	0.47	250	1,112	100
TYS24-470	25 - 180	0.98 - 7.09	610	24.0	12.0	0.47	250	1,112	100
<b>Acier inoxydable 316 – Polyamide 11 coated</b>									
TYS6-280C	25 - 33	0.98 - 1.30	150	6.0	7.0	0.28	250	1,112	100
TYS9-280C	25 - 57	0.98 - 2.24	225	9.0	7.0	0.28	250	1,112	100
TYS12-280C	25 - 81	0.98 - 3.19	300	12.0	7.0	0.28	250	1,112	100
TYS18-280C	25 - 129	0.98 - 5.08	450	18.0	7.0	0.28	250	1,112	100
TYS24-280C	25 - 180	0.98 - 7.09	610	24.0	7.0	0.28	250	1,112	100
TYS6-470C	25 - 33	0.98 - 1.30	150	6.0	12.0	0.47	250	1,112	100
TYS9-470C	25 - 57	0.98 - 2.24	225	9.0	12.0	0.47	250	1,112	100
TYS12-470C	25 - 81	0.98 - 3.19	300	12.0	12.0	0.47	250	1,112	100
TYS18-470C	25 - 129	0.98 - 5.08	450	18.0	12.0	0.47	250	1,112	100
TYS24-470C	25 - 180	0.98 - 7.09	610	24.0	12.0	0.47	250	1,112	100

Description of materials and properties: see pages C132 to C144

#### Tooling



**WTAE200**  
Cable Tie Tensioner  
See page C51.

#### How it works

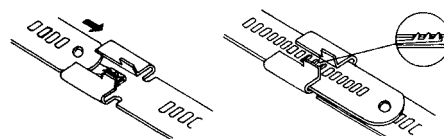

As the free end of the Multi-Lok tie passes through the buckle, three separate teeth (four teeth in the 12 mm Multi-Lok) mesh with corresponding slots in the band, automatically locking the tie as it is being tensioned

#### Diagram

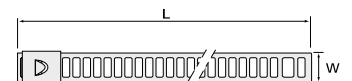

## Stainless steel cable ties and accessories

### Heavy-duty clamp – Type SSH



#### Characteristics

- Double-wrapped clamps provide extra strength
- This unique clip design makes application quick and easy
- Perfect for industrial piping and bundling of cables with high tensile strength

#### Technical information

- Material - Moulding: 201 Stainless Steel

### Heavy-duty clamp – Type SSH

Cat. n°.	Max. wire bundle dia.								Tensile strength				Std. pkg. [pcs]
	Once around		Twice around		Length		Width		Once around		Twice around		
	[mm]	[in.]	[mm]	[in.]	[mm]	[in.]	[mm]	[in.]	[lb]	[N]	[lb]	[N]	
SSH10-250	50	2.0	-	-	254	10.1	6.3	0.25	450	2,002	1,200	5,337	100
SSH16-250	88	3.5	38	1.5	406	16.0	6.3	0.25	450	2,002	1,200	5,337	100
SSH18-500	101	4.0	50	2.0	457	18.0	12.7	0.50	1,400	6,227	3,300	14,679	100
SSH21-625	127	5.0	63	2.5	533	21.0	15.9	0.63	1,700	7,562	4,000	17,793	100
SSH31-500	203	8.0	101	4.0	787	31.0	12.7	0.50	1,400	6,227	3,300	14,679	25
SSH34-250	228	9.0	114	4.5	864	34.0	6.3	0.25	450	2,002	1,200	5,337	100
SSH37-750	254	10.0	127	5.0	940	37.0	19.1	0.75	2,000	8,896	5,000	22,241	25
SSH44-375	304	12.0	152	6.0	1 118	11.8	9.5	0.38	900	4,003	2,400	10,676	25
SSH50-750	355	14.0	177	7.0	1 270	50.0	19.1	0.75	2,000	8,896	5,000	22,241	25
SSH56-625	406	16.0	203	8.0	1 422	56.0	15.9	0.63	1,700	7,562	4,000	17,793	25
SSH62-750	457	18.0	228	9.0	1 575	62.0	19.1	0.75	2,000	8,896	5,000	22,241	25
SSH69-625	508	20.0	254	10.0	1 753	69.0	15.9	0.63	1,700	7,562	4,000	17,793	25

Description of materials and properties: see pages C132 to C144

### Tooling



#### WTJ020

Compact free end stainless steel cable tie installation tool. See page C51.



#### WTC075

Pistol grip free end stainless steel cable tie installation tool. See page C52.



#### WTC001

Free end stainless steel cable tie installation tool for all sizes. See page C52.

## Stainless steel cable ties

### Heavy-Duty Ball-Lock mechanism – Type LS



#### Characteristics

- Self-locking – no time-consuming crimping or folding required
- Stainless steel ball in low-profile, wedge-shaped head locks tie securely in place
- Angled tail enables fast, easy insertion
- Rounded edges and smooth surfaces protect installer's hands
- Typical Applications: offshore drilling, petrochemical processing, shipbuilding, food and beverage processing and pharmaceutical processing

#### Technical information

- Material - Moulding: 304 grade stainless steel for standard applications
- Material - Moulding: 316 grade (marine-grade) stainless steel for extra corrosion resistance
- Material - Moulding: 316 grade (marine-grade) stainless steel, fully coated with low-smoke, halogen-free polyester to withstand continuous exposure to salt spray, sunlight, petroleum and chemicals
- Operating Temp. Range:  
Uncoated : -60 °C to 300 °C (-76 °F to 572 °F)  
Coated : -60 °C to 150 °C (-76 °F to 302 °F)
- Min. installation temp.: -60°C (-76°F)
- Plenum rating: AH-1

#### Heavy-Duty Ball-Lock mechanism



#### Cat. n°.

304 Grade Stainless Steel	316 Grade Stainless Steel	316 Grade Stainless Steel	Type DSG	Max. wire bundle dia.		Length		Width		Tensile Strength		Std. pkg.
Uncoated	Uncoated	Fully Polyester Coated		[mm]	[in.]	[mm]	[in.]	[mm]	[in.]	[lb]	[N]	[pcs]
LS-4.6-200A	LS-4.6-200B	YLS-4.6-200BC	2S	6 - 51	0.25 - 2.0	200	7.9	4.6	0.19	200	890	50
LS-4.6-260A	LS-4.6-260B	-	2S	6 - 70	0.25 - 2.7	260	10.2	4.6	0.19	200	890	50
LS-4.6-360A	LS-4.6-360B	YLS-4.6-360BC	2S	6 - 102	0.25 - 4.0	360	14.2	4.6	0.19	200	890	50
LS-4.6-520A	LS-4.6-520B	YLS-4.6-520BC	2S	6 - 152	0.25 - 6.0	520	20.5	4.6	0.19	200	890	50
LS-4.6-680A	LS-4.6-680B	YLS-4.6-680BC	2S	6 - 203	0.25 - 8.0	680	26.8	4.6	0.19	200	890	50
LS-4.6-840A	LS-4.6-840B	-	2S	6 - 254	0.25 - 10.0	840	33.1	4.6	0.19	200	890	50
LS-7.9-200A	LS-7.9-200B	YLS-7.9-200BC	2S	10 - 51	0.38 - 2.0	200	7.9	7.9	0.31	450	2,002	50
LS-7.9-360A	LS-7.9-360B	YLS-7.9-360BC	2S	10 - 102	0.38 - 4.0	360	14.2	7.9	0.31	450	2,002	50
LS-7.9-520A	LS-7.9-520B	YLS-7.9-520BC	2S	10 - 152	0.38 - 6.0	520	20.5	7.9	0.31	450	2,002	50
LS-7.9-680A	LS-7.9-680B	YLS-7.9-680BC	2S	10 - 203	0.38 - 8.0	680	26.8	7.9	0.31	450	2,002	50
LS-7.9-840A	LS-7.9-840B	-	2S	10 - 254	0.38 - 10.0	840	33.1	7.9	0.31	450	2,002	50
LS-7.9-1010A	LS-7.9-1010B	-	2S	10 - 304	0.38 - 12.0	1,010	39.8	7.9	0.31	450	2,002	50

Description of materials and properties: see pages C132 to C144

#### Tooling



**DAS-250**  
Hand Tool  
Adjustable tension,  
automatic cut off  
See page C53.



**CT3**  
Economical hand tool.  
See page C53.



**CT6**  
Hand Tool  
Adjustable tension,  
automatic cut off  
See page C53.

## Stainless steel cable ties

### Ty-Met stainless steel retained-tension ball-lock cable ties



#### Characteristics

- Specially formed spring crimp creates consistent tension on the tie for firm positioning
- High wave-form crimp provides positive clamping in high-vibration applications
- Crimp channel offers a path for a trace wire with protection from crushing and shorts
- Ball-lock mechanism is easy to assemble and adjust for tension

#### Technical information

- Material: Type 304 or Type 316 stainless steel
- Operating temperature: -80°C to +300°C (-112°F to +572°F)
- Certifications/ compliances : UL/EN/CSA62275 Type 2S rated for AH-1 plenum
- Applications: shipbuilding, industrial, oil and gas, heavy equipment and trucking, wind power and solar energy

#### Ty-Met stainless steel retained-tension ball-lock cable ties

Cat. n°	Type DSG	Max. wire bundle dia.		Length		Width		Tensile strength [lb]	Tensile strength [N]	Std. pkg. [pcs]
		[mm]	[in.]	[mm]	[in.]	[mm]	[in.]			
<b>Type 304 stainless steel – uncoated</b>										
RS-4.6-200A	2S	51	2	200	7.9	4.6	0.18	200	890	50
RS-4.6-260A	2S	70	2.7	260	10.2	4.6	0.18	200	890	50
RS-4.6-360A	2S	102	4	360	14.2	4.6	0.18	200	890	50
RS-4.6-520A	2S	152	6	520	20.5	4.6	0.18	200	890	50
RS-4.6-680A	2S	203	8	680	26.8	4.6	0.18	200	890	50
RS-7.9-200A	2S	51	2	200	7.9	7.9	0.31	450	2,002	50
RS-7.9-360A	2S	102	4	360	14.2	7.9	0.31	450	2,002	50
RS-7.9-520A	2S	152	6	520	20.5	7.9	0.31	450	2,002	50
RS-7.9-680A	2S	203	8	680	26.8	7.9	0.31	450	2,002	50
<b>Type 316 marine-grade</b>										
RS-4.6-200B	2S	51	2	200	7.9	4.6	0.18	200	890	50
RS-4.6-260B	2S	70	2.7	260	10.2	4.6	0.18	200	890	50
RS-4.6-360B	2S	102	4	360	14.2	4.6	0.18	200	890	50
RS-4.6-520B	2S	152	6	520	20.5	4.6	0.18	200	890	50
RS-4.6-680B	2S	203	8	680	26.8	4.6	0.18	200	890	50
RS-7.9-200B	2S	51	2	200	7.9	7.9	0.31	450	2,002	50
RS-7.9-360B	2S	102	4	360	14.2	7.9	0.31	450	2,002	50
RS-7.9-520B	2S	152	6	520	20.5	7.9	0.31	450	2,002	50
RS-7.9-680B	2S	203	8	680	26.8	7.9	0.31	450	2,002	50

Minimum bundle diameter for all cable ties listed above is 1in. (25.4mm)  
Description of materials and properties: see pages C132 to C144

#### Tooling



**DAS-250**  
Hand Tool  
Adjustable tension,  
automatic cut off  
See page C53.

## Stainless steel cable ties

### Accessories



#### Ty-Rap stainless steel mounting base

##### Characteristics

- Long-lasting, 316 stainless steel, uncoated anchor hold

##### Technical information

- Temperature range: -80°C to +300°C (-112°F to +572°F)

#### Ty-Rap stainless steel mounting base

Cat. n°.	Length L		Width W		Width A		Hole diameter		Std. pkg. [pcs]
	[mm]	[in.]	[mm]	[in.]	[mm]	[in.]	[lb]	[N]	
TCS25	57.1	2.25	25.4	1.0	31.8	1.25	0.8	3.56	100

#### Diagram

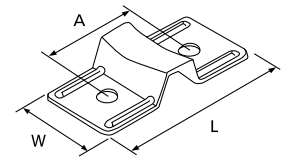

#### Identify cable bundles with permanent, stainless steel imprintable tags

##### Characteristics

- Apply stainless steel tags with stainless steel cable ties
- Easy-to-use – slip a tie through the slots in the tag and fasten with the installaton tool
- Works with ¼ in. wide ties
- Thickness: 0,015 in.

#### Ty-Rap stainless steel mounting base

Cat. n°.	Grade stainless steel		Width		Length		Std. pkg. [pcs]
			[mm]	[in.]	[mm]	[in.]	
SSID100	304		19.1	0.75	50.8	2	100
SSID102	304		19.1	0.75	88.9	3.5	100
SSID102-316	316		19.1	0.75	88.9	3.5	100

## Stainless steel cable ties

### Tooling



Cat. n°.: WTA290, Mini tie installation tool

#### Characteristics

- Hand tool to apply mini stainless steel cable ties
- Easy-to-use
- Applies tension, locks tie with the dual lock
- Cuts off band flush with top surface of buckle.

#### Technical information

- Type: Hand tool to apply mini stainless steel cable ties
- Tie: Stainless steel type SS
- Weight: 530 g (1.17 lb)
- Quantity: 1



Cat. n°.: WTA250, Standard tie installation tool

#### Characteristics

- Hand tool to apply mini stainless steel cable ties
- Easy-to-use
- Applies tension, locks tie with the dual lock
- Cuts off band flush with top surface of buckle.

#### Technical information

- Type: Standard tie installation tool
- Tie: Stainless steel type SS
- Weight: 530 g (1.17 lb)
- Quantity: 1



Cat. n°.: WTAE200, Cable tie tensioner

#### Characteristics

- Cable tie tensioner: for tensioning reusable ties and Multi-Lok ties

#### Technical information

- Type: Cable tie tensioner
- Tie: Stainless steel type Multi-Lok
- Weight: 270 g (0.6 lb)
- Quantity: 1



Cat. n°.: WTJ020, Compact free end stainless steel cable tie installation tool

#### Characteristics

- Lightweight, small-size tool for installing free-end clamps
- This tool also applies tension and has a built-in cutter.

#### Technical information

- Type: Cable tie tensioner
- Tie: Stainless steel type SSH
- Tie width: 6.4 - 9.5 mm (¼ in. - ⅜ in.)
- Weight: 500 g (1.1 lb)
- Quantity: 1



## Stainless steel cable ties

### Tooling



Cat. n°.: WTC075, Cable tie installation tool

#### Characteristics

- The lightweight, ratchet-action tool tension cuts and secures the buckle tab
- This tool also applies tension and has a built-in cutter.

#### Technical information

- Type: Standard tie installation tool
- Tie: Stainless steel type SSH
- Tie width: 6.4 - 15.88 mm ( $\frac{1}{4}$  in. -  $\frac{5}{8}$  in.)
- Weight: 1,180 g (2.6 lb)
- Quantity: 1



Cat. n°.: WTC001, Cable tie installation tool

#### Characteristics

- A drop-forged tool with tensioning capability to do all free-end clamp sizes.

#### Technical information

- Type: Cable tie tensioner:
- Tie: Stainless steel type SSH
- Tie width: 6.4 - 19.5 mm ( $\frac{1}{4}$  in. -  $\frac{3}{4}$  in.)
- Weight: 2,000 g (4.4 lb)
- Quantity: 1



Cat. n°.: WT3S

#### Characteristics

- Installs strapping ties

#### Technical information

- Type: Cable tie installation tool
- Tie: Stainless steel
- Tie width: 4.8 - 12.7 mm ( $\frac{3}{16}$  in. -  $\frac{1}{2}$  in.)
- Weight: 270 g (0.6 lb)
- Quantity: 1

## Stainless steel cable ties

### Tooling



Cat. n°.: DAS250

#### Characteristics

- Installs Ty-Rap stainless steel cable ties
- Rugged stainless steel construction
- Pistol-type installation tool
- Adjustable tension settings

#### Technical information

- Type: Hand tool
- For type of cable tie: Plastic ties, stainless steel multi-lok, ball lok and roller back lok ties
- Tie with: 7.87 mm (0.31 in.)
- Features: Adjustable tension setting, automatic cutting, rugged stainless steel construction, pistol type installation tool
- Weight: 630g (1.4 lb)



Cat. n°.: CT3

#### Characteristics

- Cost-effective tensioning tool
- Cut-off by hand-activated lever

#### Technical information

- Type: Hand tool
- For type of cable tie: Ladder type, strap type & ball lock type stainless steel ties, coated and uncoated
- Tie with: up to 12 mm
- Features: Tensioning, manual cutting
- Weight: 550 g (1.2 lb)



Cat. n°.: CT6

#### Characteristics

- Suitable for coated and uncoated ball-Lock type stainless steel ties
- Adjustable tension settings
- Automatic cutting once desired tension has been reached

#### Technical information

- Tool type: Tension setting hand tool
- For type of cable tie: Ball-lock type stainless steel ties, coated and uncoated
- Tie with: 4.6 - 7.9 mm
- Features: Adjustable tension setting, automatic cutting
- Weight: 430 g (0.9 lb)

## Stainless steel cable ties

### BAND-FAST™ system



#### Characteristics

- A ready-to-use tie, already cut and assembled with an Ear-Lok buckle
- Savings of up to 30% on project labor

#### Technical information

- Material - Moulding: 201 stainless steel

#### Cut and assembled with an Ear-Lok buckle

Cat. n°.	Material*	Width		Thickness		Length L		Dia. max. simple winding		Dia. max. double winding		Std. pkg. [pcs/box]
		[mm]	[in.]	[mm]	[in.]	[cm]	[in.]	[mm]	[in.]	[mm]	[in.]	
BFBK-500-020	201 SS	12.7	0.50	0.76	0.030	51	20	102	4	51	2	25
BFBK-500-024	201 SS	12.7	0.50	0.76	0.030	61	24	127	5	64	2.5	25
BFBK-500-027	201 SS	12.7	0.50	0.76	0.030	69	27	152	6	76	3	25
BFBK-500-034	201 SS	12.7	0.50	0.76	0.030	86	34	203	8	102	4	25
BFBK-500-041	201 SS	12.7	0.50	0.76	0.030	104	41	254	10	127	5	25
BFBK-500-048	201 SS	12.7	0.50	0.76	0.030	122	48	305	12	152	6	25
BFBK-500-055	201 SS	12.7	0.50	0.76	0.030	140	55	356	14	178	7	25
BFBK-500-069	201 SS	12.7	0.50	0.76	0.030	175	69	457	18	229	9	25
BFBK-500-076	201 SS	12.7	0.50	0.76	0.030	193	76	508	20	254	10	15
BFBK-500-090	201 SS	12.7	0.50	0.76	0.030	229	90	610	24	305	12	15
BFBK-750-020	201 SS	19.1	0.75	0.76	0.030	51	20	102	4	51	2	25
BFBK-750-024	201 SS	19.1	0.75	0.76	0.030	61	24	127	5	64	2.5	25
BFBK-750-027	201 SS	19.1	0.75	0.76	0.030	69	27	152	6	76	3	25
BFBK-750-034	201 SS	19.1	0.75	0.76	0.030	86	34	203	8	102	4	25
BFBK-750-041	201 SS	19.1	0.75	0.76	0.030	104	41	254	10	127	5	25
BFBK-750-048	201 SS	19.1	0.75	0.76	0.030	122	48	305	12	152	6	25
BFBK-750-055	201 SS	19.1	0.75	0.76	0.030	140	55	356	14	178	7	25
BFBK-750-069	201 SS	19.1	0.75	0.76	0.030	175	69	457	18	229	9	25
BFBK-750-076	201 SS	19.1	0.75	0.76	0.030	193	76	508	20	254	10	15
BFBK-750-090	201 SS	19.1	0.75	0.76	0.030	229	90	610	24	305	12	15

\* ABB reserves the right to substitute for the material a product whose specifications corrosion or mechanical resistance are equal or better.  
Description of materials and properties: see pages C132 to C144

#### Tooling



**POWER-TOOL**  
Power too.  
Rechargeable 18V  
Ultra-Lok Hand Tool  
6.7 kg (17.75 lb)  
See page C58.

#### Diagram

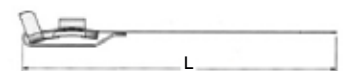

## Stainless steel cable ties

### BAND-FAST™ COLOR-IT™ system



#### Characteristics

- Luxury polyester powder coating 0.002 in. to 0.005 in. (0.05mm to 0.13mm) thick
- For exterior or interior use
- Provides excellent abrasion and UV resistance for increased durability

#### Technical information

- Material - Moulding: 201 stainless steel

#### BAND-FAST™ with Ear-Lokt buckle and COLOR-IT™- black polyester

Cat. n°.	Material*	Width		Thickness		Length L		Dia. max. simple winding		Dia. max. double winding		Std. pkg. [pcs/box]
		[mm]	[in.]	[mm]	[in.]	[cm]	[in.]	[mm]	[in.]	[mm]	[in.]	
BFBK-500-020-BK	201 SS	12.7	0.50	0.76	0.030	51	20	102	4	51	2	25
BFBK-500-024-BK	201 SS	12.7	0.50	0.76	0.030	61	24	127	5	64	2.5	25
BFBK-500-027-BK	201 SS	12.7	0.50	0.76	0.030	69	27	152	6	76	3	25
BFBK-500-034-BK	201 SS	12.7	0.50	0.76	0.030	86	34	203	8	102	4	25
BFBK-500-041-BK	201 SS	12.7	0.50	0.76	0.030	104	41	254	10	127	5	25
BFBK-500-048-BK	201 SS	12.7	0.50	0.76	0.030	122	48	305	12	152	6	25
BFBK-500-055-BK	201 SS	12.7	0.50	0.76	0.030	140	55	356	14	178	7	25
BFBK-500-069-BK	201 SS	12.7	0.50	0.76	0.030	175	69	457	18	229	9	25
BFBK-500-076-BK	201 SS	12.7	0.50	0.76	0.030	193	76	508	20	254	10	15
BFBK-500-090-BK	201 SS	12.7	0.50	0.76	0.030	229	90	610	24	305	12	15
BFBK-750-020-BK	201 SS	19.1	0.75	0.76	0.030	51	20	102	4	51	2	25
BFBK-750-024-BK	201 SS	19.1	0.75	0.76	0.030	61	24	127	5	64	2.5	25
BFBK-750-034-BK	201 SS	19.1	0.75	0.76	0.030	86	34	203	8	102	4	25
BFBK-750-041-BK	201 SS	19.1	0.75	0.76	0.030	104	41	254	10	127	5	25
BFBK-750-048-BK	201 SS	19.1	0.75	0.76	0.030	122	48	305	12	152	6	25
BFBK-750-055-BK	201 SS	19.1	0.75	0.76	0.030	140	55	356	14	178	7	25
BFBK-750-069-BK	201 SS	19.1	0.75	0.76	0.030	175	69	457	18	229	9	25
BFBK-750-076-BK	201 SS	19.1	0.75	0.76	0.030	193	76	508	20	254	10	15
BFBK-750-090-BK	201 SS	19.1	0.75	0.76	0.030	229	90	610	24	305	12	15

\* ABB reserves the right to substitute for the material a product whose specifications corrosion or mechanical resistance are equal or better.

Description of materials and properties: see pages C132 to C144

#### Tooling



**POWER-TOOL**  
Power too.  
Rechargeable 18V  
Ultra-Lok Hand Tool  
6.7 kg (17.75 lb)  
See page C58.

#### Assortment



**BK-201-500-BK**  
**BK-201-625-BK**  
**BK-201-750-BK**  
Polyester Ear-Lokt Buckle  
COLOR-IT™ deluxe  
black-IT™



**B-201-500-BK**  
**B-201-625-BK**  
**B-201-750-BK**  
Black polyester roll strap  
luxury COLOR-IT™

#### Diagram

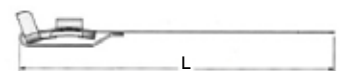

## Stainless steel cable ties

### ULTRA-LOK® system



#### Characteristics

- Installs four times faster than straps and buckles installed using hand tools
- Locking at full tension, so less slippage
- Intuitive assembly guided by corresponding arrows on the strap and buckle
- Offers good resistance to oxidation and several other moderate corrosives
- 201 ¼ hard stainless steel strap provides material strength and stronger clamping, lends itself to double winding for more resistance
- ¾ in. strap available in plastic container with housing

Cat. n°.	Material*	Width		Length		Dia. max. simple winding		Dia. max. double winding		Std. pkg. [pcs/cont.]
		[mm]	[in.]	[mm]	[in.]	[mm]	[in.]	[mm]	[in.]	
ULS-750-20	Stainless steel 201, ¼ hard	19.1	0.75	508	20	102	4	N/A	N/A	30
ULS-750-24	Stainless steel 201, ¼ hard	19.1	0.75	610	24	127	5	N/A	N/A	27
ULS-750-28	Stainless steel 201, ¼ hard	19.1	0.75	711	28	152	6	N/A	N/A	21
ULS-750-32	Stainless steel 201, ¼ hard	19.1	0.75	813	32	178	7	89	3.5	18
ULS-750-36	Stainless steel 201, ¼ hard	19.1	0.75	914	36	252	8	102	4.0	33
ULS-750-40	Stainless steel 201, ¼ hard	19.1	0.75	1,016	40	254	10	127	4.5	30
ULS-750-44	Stainless steel 201, ¼ hard	19.1	0.75	1,118	44	267	11	140	5.5	27
ULS-750-48	Stainless steel 201, ¼ hard	19.1	0.75	1,219	48	305	12	153	6.0	25
ULS-750-52	Stainless steel 201, ¼ hard	19.1	0.75	1,321	52	330	13	165	6.5	23
ULS-750-60	Stainless steel 201, ¼ hard	19.1	0.75	1,524	60	381	15	191	7.5	20
ULS-750-68	Stainless steel 201, ¼ hard	19.1	0.75	1,727	68	445	17	216	8.5	17
ULS-750-76	Stainless steel 201, ¼ hard	19.1	0.75	1,930	76	508	20	254	10.0	15
ULS-750-84	Stainless steel 201, ¼ hard	19.1	0.75	2,134	84	559	22	280	11.0	14
ULS-750-92	Stainless steel 201, ¼ hard	19.1	0.75	2,337	92	622	24	305	12.0	13
ULS-750-120	Stainless steel 201, ¼ hard	19.1	0.75	3,048	120	508	32	407	16.0	10
ULS-750-150	Stainless steel 201, ¼ hard	19.1	0.75	3,810	150	559	41	508	20.5	8
ULS-750-175	Stainless steel 201, ¼ hard	19.1	0.75	4,445	175	622	48	610	24.0	7

\* ABB reserves the right to substitute for the material a product whose specifications corrosion or mechanical resistance are equal or better.

Description of materials and properties: see pages C132 to C144

#### Tooling



#### POWER-TOOL

Power too.

Rechargeable 18V

Ultra-Lok Hand Tool

6.7 kg (17.75 lb)

See page C58.

## Stainless steel cable ties

### Roll straps and buckles



#### Roll strap BAND-IT®

Cat. n°.	Material	Width		Épaisseur		Force de rupture moyenne		Std. pkg. [pcs/box]
		[mm]	[in.]	[mm]	[in.]	[lb]	[N]	
<b>Stainless steel 201 - Uncoated</b>								
B201-500-100	Stainless steel 201	12.7	0.50	0.76	0.03	6,672	1,500	100
B201-625-100	Stainless steel 201	15.9	0.63	0.76	0.03	8,340	1,875	100
B201-750-100	Stainless steel 201	19.1	0.75	0.76	0.03	10,008	2,250	100
<b>Stainless steel 201 - Black polyester coating</b>								
B201-500-BK	Stainless steel 201	12.7	0.50	0.76	0.03	6,672	1,500	100
B201-625-BK	Stainless steel 201	15.9	0.63	0.76	0.03	8,340	1,875	100
B201-750-BK	Stainless steel 201	19.1	0.75	0.76	0.03	10,008	2,250	100
<b>Stainless steel 304 - Uncoated</b>								
B-304-625-200	Stainless steel 304	15.9	0.63	0.51	0.02	4,448	1,000	200
B-304-750-200	Stainless steel 304	19.1	0.75	0.51	0.02	5,671	1,275	200
<b>Stainless steel 316 - Uncoated</b>								
B-316-250-100	Stainless steel 316	6.4	0.25	0.51	0.02	1,779	400	100
B-316-375-100	Stainless steel 316	9.6	0.38	0.64	0.025	3,336	750	100
B-316-500-100	Stainless steel 316	12.7	0.5	0.76	0.03	5,338	1,200	100
B-316-625-100	Stainless steel 316	15.8	0.63	0.76	0.03	6,672	1,500	100
B-316-750-100	Stainless steel 316	19.1	0.75	0.76	0.03	8,007	1,800	100

\* ABB reserves the right to substitute for the material a product whose specifications corrosion or mechanical resistance are equal or better.

#### Buckle Ear-Lokt BAND-IT®



Cat. n°.	Material	Width		Std. pkg. [pcs/box]
		[mm]	[in.]	
<b>Stainless steel 201 - Uncoated</b>				
BK-201-500-100	Stainless steel 201	12.7	0.50	100
BK-201-625-100	Stainless steel 201	15.9	0.63	100
BK-201-750-100	Stainless steel 201	19.1	0.75	100
<b>Stainless steel 201 - Black polyester coating</b>				
BK-201-500-BK	Stainless steel 201	12.7	0.50	100
BK-201-625-BK	Stainless steel 201	15.9	0.63	100
BK-201-750-BK	Stainless steel 201	19.1	0.75	100
<b>Stainless steel 316 - Uncoated</b>				
BK-316-250-100	Stainless steel 316	6.4	0.25	100
BK-316-375-100	Stainless steel 316	9.6	0.38	100
BK-316-500-100	Stainless steel 316	12.7	0.5	100
BK-316-625-100	Stainless steel 316	15.8	0.63	100
BK-316-750-100	Stainless steel 316	19.1	0.75	100

\* ABB reserves the right to substitute for the material a product whose specifications corrosion or mechanical resistance are equal or better.

## Stainless steel cable ties

### Tooling



Cat. n°.: POWER-TOOL

#### Characteristics

- Designed with portability requirements in mind
- To tighten in a repetitive and uniform way
- Hangs at full voltage
- The Ultra-Lok® hitch can be installed four times faster than a conventional hitch

#### Technical information

- Type: Rechargeable 18V Ultra-Lok Hand Tool
- Type: ties in stainless steel 201
- For use with ½ in. and ¾ in. Ultra-Lok® straps and buckles
- Supplied complete with battery, charger and autofocus feature
- Weight: 6.7 kg (17.75 lb)



Cat. n°.: BAND-TOOL

#### Characteristics

- BAND-IT® tool

#### Technical information

- Type: Hand tools for strap and buckle
- For ⅜ in. to ¾ in. wide straps
- Weight: 1.8 kg (4.3 lb)



Cat. n°.: BAND-TOOL-HD

#### Characteristics

- BAND-IT® Heavy Duty tool

#### Technical information

- Type: Hand tools for strap and buckle
- For ⅜ in. to ¾ in. wide straps
- Weight: 1.8 kg (4.3 lb)



