

NOMINAL LUMENS	DELIVERED LUMENS	WATTAGE
550	558	8W

Based on 3000K, 90+ CRI. Actual wattage may vary +/- 5%

INSTALLATION

Cut hole in ceiling. Insert luminaire into opening by squeezing spring clips on both sides of luminaire. The width in ceiling needed for the driver to fit is 3".

FEATURES

Ultra-thin 1" design fits into shallow plenum spaces and other below-the-ceiling applications. 4" round adjustable slim LED luminaire engineered for new construction, remodel, or retrofit to accommodate insulated or dropped ceilings. Remote driver allows easy installation and maintenance. Canless design eliminates need for bulky housing.

LUMENS	550
CCT	27K, 30K, 35K, 40K
CRI	90+
COLOR QUALITY	3-Step MacAdam Ellipse
CONSTRUCTION	Aluminum die-cast body and trim
TRIM OPTION	Round Adjustable
TRIM COLORS	WH (White), BK (Black), BZ (Bronze), SN (Satin Nickel)
BEAM ANGLE	10 Degree
DIMMING	DIMTR (Triac)
EMERGENCY	16W high voltage inverter (remote)
LIFETIME	L70 at 50,000 Hours
PHOTOMETRIC TESTS	In Accordance with IES LM79-08, LM80 and TM-30, TM-21

- IC-rated and Air-Tight ready and may be in direct contact with insulation.
- Can be installed in shallow plenum applications.
- Can be installed in drywall or suspended ceilings.
- Flicker-free forward-phase Triac dimming down to 5%.
- New construction rough-in plates and jumper cables available.

SLIM TRIM



EXAMPLE:

RL474-550L-DIMTR-120-30K-90

TYPE	LUMEN	CCT	CRI	FINISH
RL474	<input type="checkbox"/> 550L-DIMTR-120	<input type="checkbox"/> 27K <input type="checkbox"/> 30K <input type="checkbox"/> 35K <input type="checkbox"/> 40K	<input type="checkbox"/> 90+	<input type="checkbox"/> WH - White <input type="checkbox"/> BK - Black <input type="checkbox"/> BZ - Bronze <input type="checkbox"/> SN - Satin Nickel

ACCESSORIES



RL-ACC-SLIM-1-10F
10-ft long extension



RL-ACC-SLIM-1-20F
20-ft long extension



RL-UNV-4/5/6
For use with: 4", 5", 6"

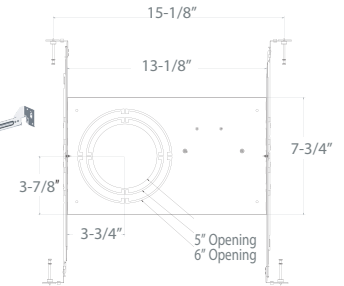

AL-ACC-SLIM-4-F-ROUGHPLATE
For 4" downlight

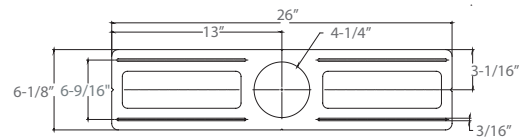
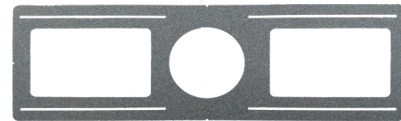
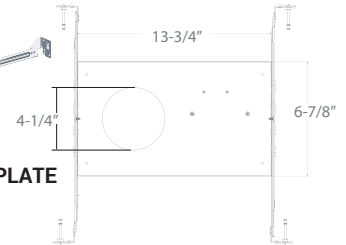

RL-ACC-SLIM-4-ROUGHPLATE
Rough-in plate for use with 4" downlights

RL-ACC-SLIM-1-10F

OPTIONS

- ☐ **RL-ACC-SLIM-1-10F** - 10ft Long Extension
- ☐ **RL-ACC-SLIM-1-20F** - 20ft Long Extension
- ☐ **RL-UNV-4/5/6** - Universal Mounting Plate for 4", 5" and 6"
- ☐ **RL-ACC-SLIM-4-ROUGHPLATE** - 4" Mounting Plate
- ☐ **AL-ACC-SLIM-4-F-ROUGHPLATE** - 4" Flanged Roughplate

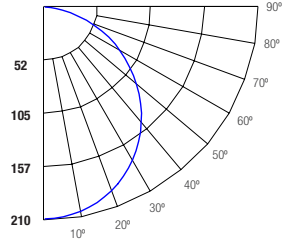
RL474-550L-DIMTR-120-30K-90-WH
TEST NO.: EL021849
INPUT WATTS: 7.9
LUMENS: 558
CRI: 90
EFFICACY: 71
CCT: 3000K
SPACING CRITERIA: 1.34
Candle Power Distribution (Candelas)

Zonal Lumens Summary

Zone	Lumens	%Lamp	%Fixt
0-20	74.00	13.30	13.30
0-30	155.73	27.90	27.90
0-40	253.69	45.50	45.50
0-60	445.39	79.80	79.80
0-80	553.68	99.20	99.20
0-90	558.08	100.00	100.00

Luminance (Average candela/M²)

Angle in Degrees	Average 0°	Average 45°	Average 90°
45	23974	23869	24552
55	22559	22732	23319
65	20808	21078	21992
75	16624	18387	19781
85	8497	0	0

Lumens Per Zone

Zone	Lumens
0-10	19.42
10-20	54.58
20-30	81.73
30-40	97.97
40-50	100.97
50-60	90.73
60-70	69.54
70-80	38.74
80-90	4.40

Candela Tabulation

0	
0	209.66
5	208.39
15	200.30
25	184.79
35	162.69
45	134.83
55	102.91
65	69.94
75	34.22
85	5.89
90	0.32

Coefficients of Utilization - Zonal Cavity Method

Effective Floor Cavity Reflectance 0.20

Cone of Light			
2	52.4	5.8	5.5
4	13.1	11.6	11
6	5.82	17.4	16.5
8	3.28	23.2	22
10	2.1	29	27.5
12	1.46	34.7	33
(FT.) Distance to Plane	(FC.) Initial Footcandle at Nadir	(FT.) Beam Vert. Spread	(FT.) Beam Horiz. Spread

BEAM DIA. MEASURED AT 50% OF NADIR F.C.

	RC	80%				70%				50%				30%			10%			0%
		RW	70%	50%	30%	10%	70%	50%	30%	10%	50%	30%	10%	50%	30%	10%	50%	30%	10%	0%
ROOM CAVITY RATIO	0	119	119	119	119	116	116	116	116	111	111	111	106	106			102	102	102	100
	1	109	105	100	97	106	102	98	95	98	95	92	94	92	89		91	88	87	85
	2	99	91	84	79	97	89	83	78	86	80	76	82	78	74		79	76	73	70
	3	90	80	72	65	88	78	71	65	75	69	64	73	67	63		70	65	62	59
	4	83	71	62	55	81	70	61	55	67	60	54	65	59	54		63	57	53	51
	5	76	63	54	48	74	62	54	47	60	53	47	58	52	46		56	51	46	44
	6	70	57	48	42	68	56	48	41	54	47	41	53	46	41		51	45	40	38
	7	65	52	43	37	63	51	43	37	49	42	36	48	41	36		47	40	36	34
	8	61	47	39	33	59	46	38	33	45	38	33	44	37	32		43	37	32	30
	9	57	43	35	30	55	43	35	29	42	34	29	40	34	29		39	33	29	27
10	53	40	32	27	52	39	32	27	38	31	27	37	31	26		37	31	26	25	

RC - Ceiling Cavity Reflectance

RW - Wall Reflectance