

NOMINAL LUMENS	DELIVERED LUMENS	WATTAGE
550	698	9W
700	932	12W

Based on 3000K, 90+ CRI. Actual wattage may vary +/- 5%

INSTALLATION

Cut hole in ceiling. Insert luminaire into opening by squeezing spring clips on both sides of luminaire. The width in ceiling needed for the driver to fit is 3".

FEATURES

4" round baffle slim LED luminaire engineered for new construction, remodel or retrofit to accommodate insulated or dropped ceilings. Baffle trim delivers glare-free comfortable illumination. Remote driver allows easy installation and maintenance. Small aperture and shallow depth are ideal for unlimited applications.

LUMENS	550, 700
CCT	27K, 30K, 35K, 40K
CRI	90+
COLOR QUALITY	3-Step MacAdam Ellipse
CONSTRUCTION	Aluminum die-cast body and trim
TRIM OPTION	Round Baffle
TRIM COLORS	WH (White) , BK(Black)
DIMMING	DIMTR (Triac)
EMERGENCY	16W high voltage inverter (remote)
LIFETIME	L70 at 50,000 Hours
PHOTOMETRIC TESTS	In Accordance with IES LM79-08, LM80 and TM-30, TM-21

- IC-rated and Air-Tight ready and may be in direct contact with insulation.
- Can be installed in shallow plenum applications.
- Can be installed in drywall or suspended ceilings.
- Flicker-free forward-phase Triac dimming down to 5%.
- New construction rough-in plates and jumper cables available.

SLIM TRIM



EXAMPLE: **RL479-550L-DIMTR-120-30K-90-WH**

TYPE	LUMEN	CCT	CRI	FINISH
RL479	<input type="checkbox"/> 550L-DIMTR-120	<input type="checkbox"/> 27K <input type="checkbox"/> 30K <input type="checkbox"/> 35K <input type="checkbox"/> 40K	<input type="checkbox"/> 90+	<input type="checkbox"/> WH-White <input type="checkbox"/> BK-Black
	<input type="checkbox"/> 700L-DIMTR-120			

ACCESSORIES



RL-ACC-SLIM-1-10F
10-ft long extension



RL-ACC-SLIM-1-20F
20-ft long extension

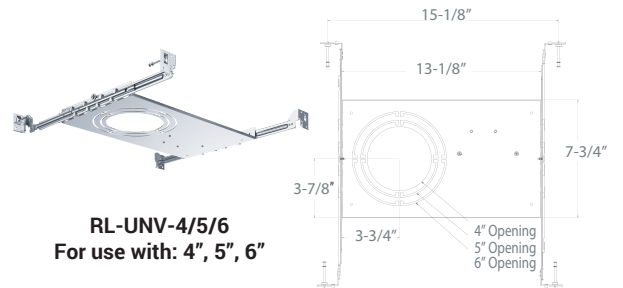

RL-UNV-4/5/6
For use with: 4", 5", 6"

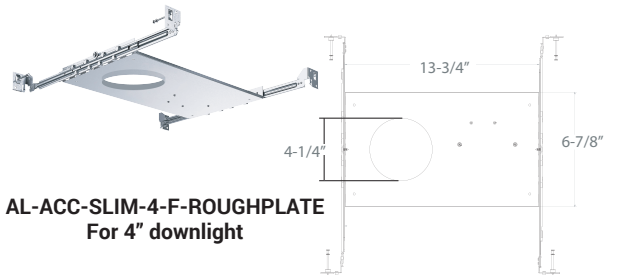

AL-ACC-SLIM-4-F-ROUGHPLATE
For 4" downlight

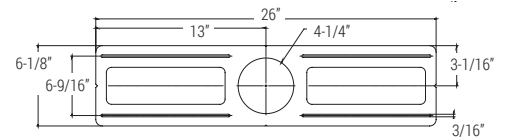

RL-ACC-SLIM-4-ROUGHPLATE
Rough-in plate for use with 4" downlight

RL-ACC-SLIM-1-10F

OPTIONS
<input type="checkbox"/> RL-ACC-SLIM-1-10F - 10ft Long Extension
<input type="checkbox"/> RL-ACC-SLIM-1-20F - 20ft Long Extension
<input type="checkbox"/> RL-UNV-4/5/6 - Universal Mounting Plate for 4", 5" and 6"
<input type="checkbox"/> RL-ACC-SLIM-4-ROUGHPLATE - 4" Mounting Plate
<input type="checkbox"/> AL-ACC-SLIM-4-F-ROUGHPLATE - 4" Flanged Roughplate

RL479-550L-DIMTR-120-30K-90-WH

TEST NO.: **EL011935**

INPUT WATTS: **9** LUMENS: **698** CRI: **90** EFFICACY: **77** CCT: **3000K**

SPACING CRITERIA: **1.18**

Candle Power Distribution (Candelas)

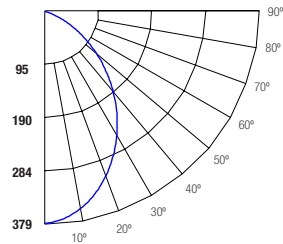

Zonal Lumens Summary

Zone	Lumens	%Lamp	%Fixt
0-20	133.20	19.10	19.10
0-30	270.82	38.80	38.80
0-40	419.62	60.10	60.10
0-60	644.57	92.40	92.40
0-80	696.94	99.90	99.90
0-90	696.96	99.90	99.90

Luminance (Average candela/M²)

Angle in Degrees	Average		
	0°	45°	90°
45	27610	28902	31027
55	19644	20985	23392
65	10007	11173	13796
75	444	539	1231
85	28	28	28

Lumens Per Zone

Zone	Lumens
0-10	35.46
10-20	97.74
20-30	137.61
30-40	148.81
40-50	131.82
50-60	93.12
60-70	45.26
70-80	7.11
80-90	0.02

Candela Tabulation

0	
0	378.40
5	372.66
15	341.11
25	289.83
35	226.85
45	158.11
55	91.25
65	34.25
75	0.93
85	0.02
90	0.03

Coefficients of Utilization - Zonal Cavity Method

Effective Floor Cavity Reflectance 0.20

Cone of Light

	(FC) Initial FootCandle at Nadir	(FT) Beam Vert. Spread	(FB) Beam Horiz. Spread
2	94.6	3.6	3.6
4	23.7	7.3	7.3
6	10.5	10.9	10.9
8	5.91	14.6	14.6
10	3.78	18.2	18.2
12	2.63	21.8	21.8

BEAM DIA. MEASURED AT 50% OF NADIR F.C.

ROOM CAVITY RATIO	RC	80%				70%				50%				30%				10%				0%			
		RW	70%	50%	30%	70%	50%	30%	10%	50%	30%	10%	50%	30%	10%	50%	30%	10%	50%	30%	10%				
0	0	119	119	119	119	116	116	116	116	111	111	111	106	106	106	102	102	102	102	102	100				
1	1	111	108	104	101	109	105	102	100	101	99	97	97	96	94	94	92	91	91	89	89				
2	2	103	97	91	86	101	95	90	85	91	87	84	88	85	82	85	82	80	80	78	78				
3	3	95	87	80	75	93	85	79	74	82	77	73	80	75	71	77	74	70	68	68	68				
4	4	88	78	71	65	86	77	70	65	75	69	64	72	67	63	70	66	62	60	60	60				
5	5	82	71	63	57	80	70	62	57	68	61	56	66	60	56	64	59	55	53	53	53				
6	6	76	65	57	51	75	64	56	51	62	55	50	60	54	50	59	54	50	48	48	48				
7	7	71	59	51	46	70	58	51	46	57	50	45	55	49	45	54	49	45	43	43	43				
8	8	67	54	47	41	65	54	46	41	52	46	41	51	45	41	50	45	41	39	39	39				
9	9	62	50	43	38	61	50	42	38	49	42	37	48	42	37	47	41	37	35	35	35				
10	10	59	47	39	34	58	46	39	34	45	39	34	44	38	34	43	38	34	32	32	32				

RC - Ceiling Cavity Reflectance

RW - Wall Reflectance

RL479-700L-DIMTR-120-30K-90-WH

TEST NO.: **EL011933**

INPUT WATTS: **11.9** LUMENS: **932** CRI: **90** EFFICACY: **78** CCT: **3000K**

SPACING CRITERIA: **1.18**

Candle Power Distribution (Candelas)

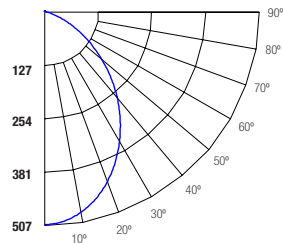

Zonal Lumens Summary

Zone	Lumens	%Lamp	%Fixt
0-20	178.46	19.10	19.10
0-30	362.62	38.90	38.90
0-40	561.51	60.20	60.20
0-60	861.41	92.40	92.40
0-80	931.14	99.90	99.90
0-90	931.16	99.90	99.90

Luminance (Average candela/M²)

Angle in Degrees	Average		
	0°	45°	90°
45	26928	27190	27893
55	19845	20243	20983
65	11084	11643	12704
75	661	889	2050
85	20	20	20

Lumens Per Zone

Zone	Lumens
0-10	47.51
10-20	130.95
20-30	184.16
30-40	198.89
40-50	175.81
50-60	124.09
60-70	60.74
70-80	8.99
80-90	0.02

Candela Tabulation

0	
0	507.27
5	501.22
15	462.89
25	396.67
35	313.45
45	222.50
55	133.01
65	54.74
75	2.00
85	0.02
90	0.03

Coefficients of Utilization - Zonal Cavity Method

Effective Floor Cavity Reflectance 0.20

Cone of Light

	(FC) Initial FootCandle at Nadir	(FT) Beam Vert. Spread	(FB) Beam Horiz. Spread
2	127	3.6	3.6
4	31.7	7.3	7.3
6	14.1	10.9	10.9
8	7.93	14.5	14.5
10	5.07	18.2	18.2
12	3.52	21.8	21.8

BEAM DIA. MEASURED AT 50% OF NADIR F.C.

ROOM CAVITY RATIO	RC	80%				70%				50%				30%				10%				0%			
		RW	70%	50%	30%	70%	50%	30%	10%	50%	30%	10%	50%	30%	10%	50%	30%	10%	50%	30%	10%				
0	0	119	119	119	119	116	116	116	116	111	111	111	106	106	106	102	102	102	102	102	100				
1	1	111	108	104	101	109	105	102	100	101	99	97	97	96	94	94	92	91	91	89	89				
2	2	103	97	91	87	101	95	90	86	91	87	84	88	85	82	85	82	80	80	78	78				
3	3	96	87	80	75	93	85	79	74	82	77	73	80	75	71	77	74	70	68	68	68				
4	4	88	78	71	65	86	77	70	65	75	69	64	72	67	63	70	66	62	60	60	60				
5	5	82	71	63	57	80	70	63	57	68	61	56	66	60	56	64	59	55	53	53	53				
6	6	76	65	57	51	75	64	56	51	62	55	50	60	54	50	59	54	50	48	48	48				
7	7	71	59	51	46	70	58	51	46	57	50	45	55	50	45	54	49	45	43	43	43				
8	8	67	54	47	41	65	54	46	41	52	46	41	51	45	41	50	45	41	39	39	39				
9	9	62	50	43	38	61	50	43	38	49	42	37	48	42	37	47	41	37	35	35	35				
10	10	59	47	39	35	58	46	39	34	45	39	34	44	38	34	43	38	34	32	32	32				

RC - Ceiling Cavity Reflectance

RW - Wall Reflectance