

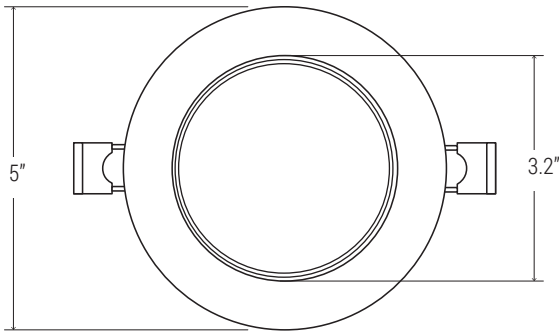

EASY 5 COLORS
SELECTOR
2700K • 3000K • 3500K • 4000K • 5000K

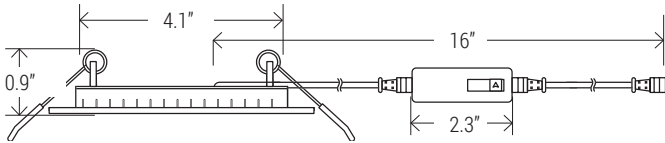
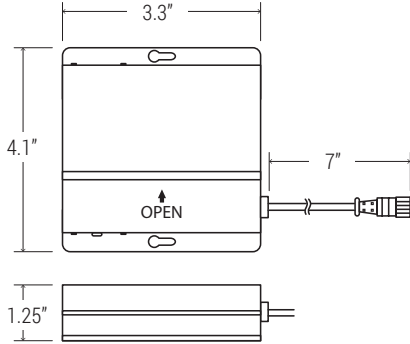

NOMINAL LUMENS	DELIVERED LUMENS	WATTAGE
850	849	12W

Based on 4000K, 90+ CRI. Actual wattage may vary +/- 5%

INSTALLATION

Cut hole in ceiling. Insert luminaire into opening by squeezing spring clips on both sides of luminaire. The width in ceiling needed for the driver to fit is 3".

You MUST seal all gaps between the ceiling and fixture with weatherproof silicone sealant. This deters moisture and water from damaging fixtures and other mechanical ceiling elements.

FEATURES

4" round baffle slim multi-CCT LED luminaire engineered for new construction, remodel or retrofit to accommodate insulated or dropped ceilings. Baffle trim delivers glare-free comfortable illumination. Easily access field-adjustable 5-Color SeleCCTor switch by lowering the luminaire from the opening. Remote driver allows easy installation and maintenance. Small aperture and shallow depth are ideal for unlimited applications.

LUMENS	850
CCT	27K/30K/35K/40K/50K
CRI	90+
COLOR QUALITY	3-Step MacAdam Ellipse
CONSTRUCTION	Aluminum die-cast body and trim
TRIM OPTION	Round Baffle
TRIM COLORS	WH (White) , BK(Black)
DIMMING	DIMTR (Triac)
EMERGENCY	16W high voltage inverter (remote)
LIFETIME	L70 at 50,000 Hours
PHOTOMETRIC TESTS	In Accordance with IES LM79-08, LM80 and TM-30, TM-21

- IC-rated and Air-Tight ready and may be in direct contact with insulation.
- Can be installed in shallow plenum applications.
- Can be installed in drywall or suspended ceilings.
- Flicker-free forward-phase Triac dimming down to 5%.
- New construction rough-in plates and jumper cables available.

SLIM TRIM



ACCESSORIES



RL-ACC-SLIM-1-10F
10-ft long extension



RL-ACC-SLIM-1-20F
20-ft long extension

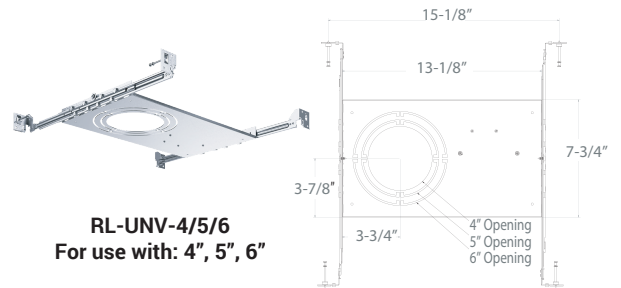

RL-UNV-4/5/6
For use with: 4", 5", 6"

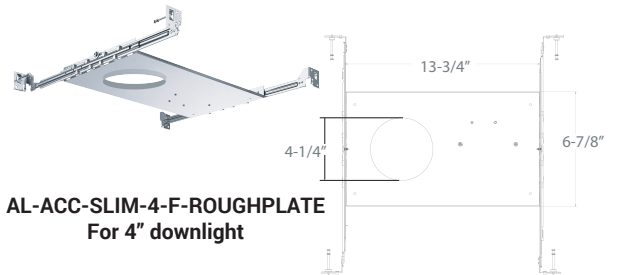

AL-ACC-SLIM-4-F-ROUGHPLATE
For 4" downlight

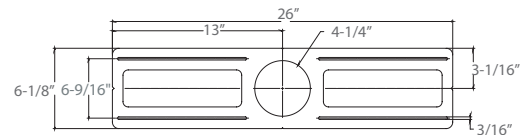

RL-ACC-SLIM-4-ROUGHPLATE
Rough-in plate for use with 4" downlights

EXAMPLE: **RL479-850L-DIMTR-120-27K/30K/35K/40K/50K-90-WH**

TYPE	LUMEN	CCT	CRI	FINISH
RL479	<input type="checkbox"/> 850L-DIMTR-120	<input type="checkbox"/> 27K/30K/35K/40K/50K	<input type="checkbox"/> 90+	<input type="checkbox"/> WH-White <input type="checkbox"/> BK-Black

RL-ACC-SLIM-1-10F

OPTIONS
<input type="checkbox"/> RL-ACC-SLIM-1-10F - 10ft Long Extension
<input type="checkbox"/> RL-ACC-SLIM-1-20F - 20ft Long Extension
<input type="checkbox"/> RL-UNV-4/5/6 - Universal Mounting Plate for 4", 5" and 6"
<input type="checkbox"/> RL-ACC-SLIM-4-ROUGHPLATE - 4" Mounting Plate
<input type="checkbox"/> AL-ACC-SLIM-4-F-ROUGHPLATE - 4" Flanged Roughplate

RL479-850L-DIMTR-120-27K-30K-35K-40K-50K-90-BK-(40K)

TEST NO.: **EL05082054**

INPUT WATTS: **11.6**

LUMENS: **849**

CRI: **90**

EFFICACY: **73**

CCT: **4000K**

SPACING CRITERIA: **1.18**

Candle Power Distribution (Candelas)

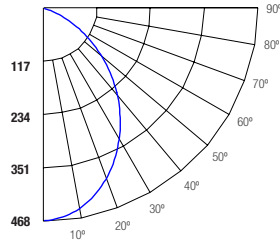

Zonal Lumens Summary

Zone	Lumens	%Lamp	%Fixt
0-20	164.57	19.4	19.4
0-30	334.29	39.4	39.4
0-40	517.45	61	61
0-60	795.05	93.7	93.7
0-80	847.77	99.9	99.9
0-90	847.79	99.9	99.9

Luminance (Average candela/M²)

Angle in Degrees	Average		
	0°	45°	90°
45	95245	97220	102749
55	66936	70153	78126
65	28081	34027	46354
75	317	370	212
85	79	79	79

Lumens Per Zone

Zone	Lumens
0-10	43.83
10-20	120.75
20-30	169.72
30-40	183.16
40-50	162.82
50-60	114.78
60-70	49.73
70-80	3
80-90	0.02

Candela Tabulation

Q	Candela
0	467.23
5	462.26
15	426.05
25	363.17
35	282.97
45	196.75
55	112.16
65	34.67
75	0.24
85	0.02
90	0.02

Coefficients of Utilization - Zonal Cavity Method
Effective Floor Cavity Reflectance 0.20

RC	80%				70%				50%				30%				10%				0%	
	70%	50%	30%	10%	70%	50%	30%	10%	50%	30%	10%	50%	30%	10%	50%	30%	10%	50%	30%	10%	0%	
0	119	119	119	119	116	116	116	116	111	111	111	106	106	106	102	102	102	100			100	
1	112	108	105	102	109	106	103	100	102	99	97	98	96	94	94	93	91	89			89	
2	104	97	92	87	101	95	90	86	92	88	84	89	85	82	86	83	80	79			79	
3	96	87	81	75	94	86	80	75	83	78	73	80	76	72	78	74	71	69			69	
4	89	79	71	66	87	78	71	65	75	69	64	73	68	64	71	66	63	61			61	
5	82	71	64	58	81	70	63	58	68	62	57	66	61	57	65	60	56	54			54	
6	77	65	57	52	75	64	57	51	62	56	51	61	55	51	59	54	50	48			48	
7	72	60	52	46	70	59	51	46	57	51	46	56	50	46	55	49	45	43			43	
8	67	55	47	42	65	54	47	42	53	46	42	52	46	41	51	45	41	39			39	
9	63	51	43	38	61	50	43	38	49	42	38	48	42	38	47	42	38	36			36	
10	59	47	40	35	58	46	40	35	46	39	35	45	39	35	44	38	34	33			33	

Cone of Light

Beam Dia. (ft.)	Beam Dia. (ft.)	Beam Dia. (ft.)	Beam Dia. (ft.)
2	162	3.1	3.1
4	42.9	6.0	6.0
6	18.7	9.1	9.1
8	10.4	12.1	12.2
10	6.78	15.0	15.2
12	4.67	18.1	18.3

(FT.) Distance to Plane (FC) Initial Footcandle at Nadir (FT.) Beam Vert. Spread (FT.) Beam Horiz. Spread

BEAM DIA. MEASURED AT 50% OF NADIR F.C.

RC - Ceiling Cavity Reflectance

RW - Wall Reflectance