

MULTI LIGHT-LEVEL CEILING MOUNT LUMINAIRE. INTEGRATED MOTION SENSOR

INSTALLATION INSTRUCTIONS

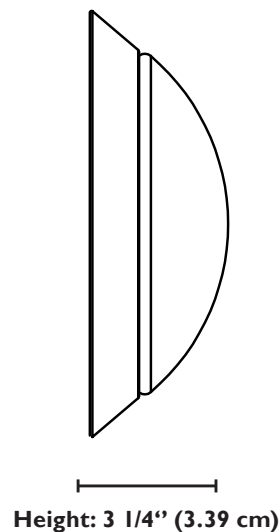

Detection zone

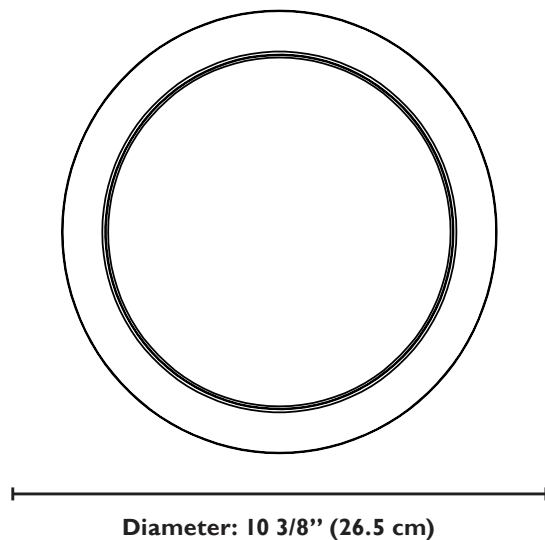
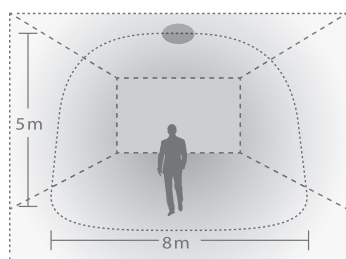

Ceiling mounting

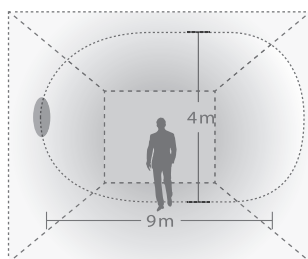

Wall mounting

IMPORTANT - READ ALL INSTRUCTIONS BEFORE INSTALLATION

- Installation and maintenance must be performed by licensed electricians only.
- To avoid risk of electric shock, make sure to turn off main power switch prior to installation or maintenance.
- Must be installed in compliance with National Electrical Code (NEC) in the US or Canadian Electrical Code in Canada.
- Ensure input voltage and frequency are compatible with the fixture. Check product manual for power requirements prior to installation.

WARNING: Risk of electric shock. Suitable for damp locations.

- Must be grounded
- Minimum 90 °C supply conductors
- Surface mounted
- This product must be installed in accordance with the applicable installation code by a person familiar with the construction and operation of the product and the hazards involved.

ELECTRICAL COMPONENTS AND CHARACTERISTICS

- Integral, high efficiency driver and power supply
- Universal AC input voltage (120-277 V)
- Nominal power factor: 0.90
- Dimming: No

MULTI LIGHT-LEVEL CEILING MOUNT LUMINAIRE. INTEGRATED MOTION SENSOR

INSTALLATION INSTRUCTIONS



Installation :

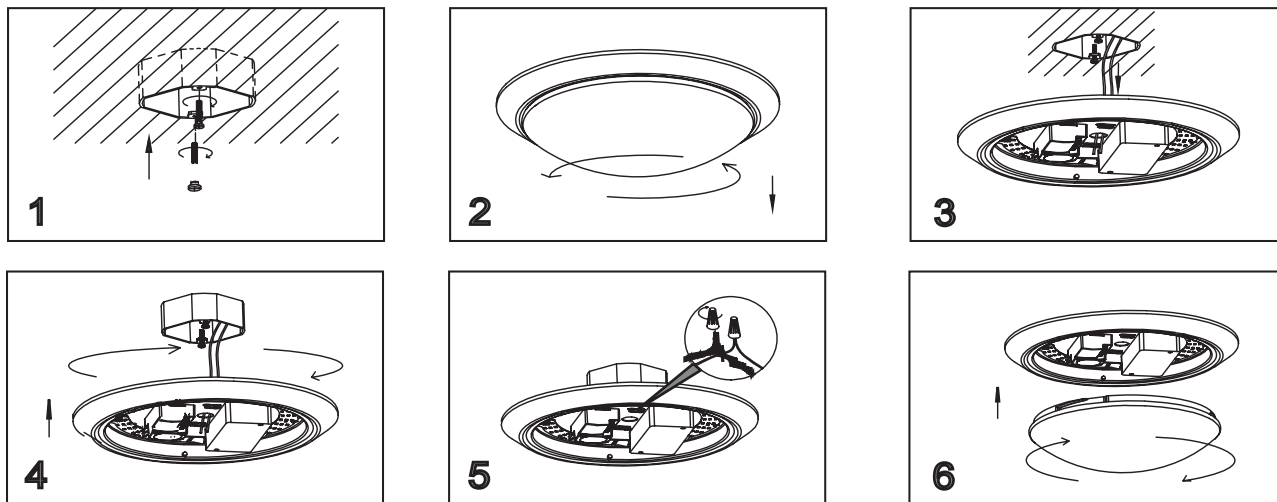

1. Place into the middle of the junction box the supplied screws.
2. Remove the diffuser.
3. Pass the electrical wires through the luminaire through the middle opening.
4. Fix the luminaire onto junction box
5. Make electrical connections.
6. Replace the diffuser.

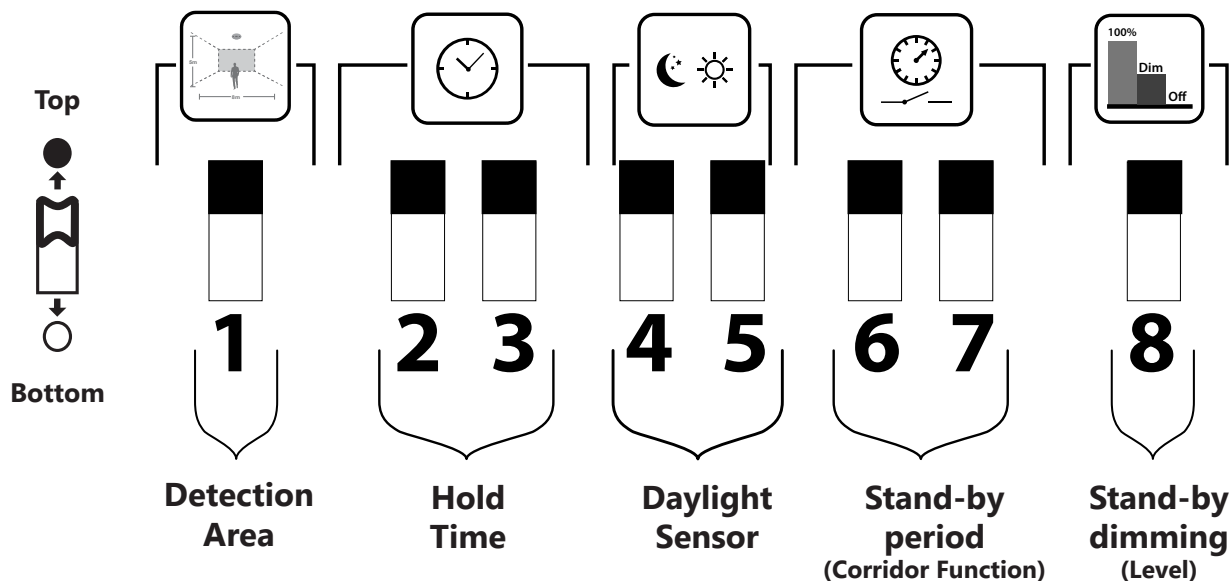

MULTI LIGHT-LEVEL CEILING MOUNT LUMINAIRE. INTEGRATED MOTION SENSOR

INSTALLATION INSTRUCTIONS

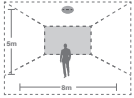

DETECTION AREA

Detection area can be reduced by 50% by selecting the combination on the DIP switches to fit precisely for each specific application.

1	
I	● 100 %
II	○ 50 %

I – 100%
II – 50%



HOLD-TIME

Hold-time means the time period you would like to keep the lmap on 100% after the person has left the detection area. Options: **5s** - 30s - 3 min - 10 min.

2		3	
I	●	●	5s
II	●	○	30s
III	○	●	3min
IV	○	○	10min

I – 5s
II – 30s
III – 3min
IV – 10min



DAYLIGHT SENSOR

The daylight threshold can be set on DIP switches, to fit for particular application. Options: **Disable** - 50 Lux - 10 Lux - 2 Lux

4		5	
I	●	●	Disable
II	●	○	50Lux
III	○	●	10Lux
IV	○	○	2 Lux

I – Disable
II – 50Lux
III – 10Lux
IV – 2Lux



STAND-BY PERIOD (CORRIDOR FUNCTION)

This is the time period you would like to keep at the low light output level before it is completely switched off in the long absence of people. Options: **0s** - 30s - 10 min - +∞
Notes: "0s" means on/off control; "+∞" means bi-level dimming control, fixture never switches off.

6		7	
I	●	●	0s
II	●	○	30s
III	○	●	10min
IV	○	○	+∞

I – 0s
II – 30s
III – 10min
IV – +∞

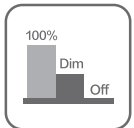

STAND-BY DIMMING LEVEL

This is the dimmed low light output level you would like to have after the hold-time in the absence of people. Options: **10%** - 30%

8	
I	● 10%
II	○ 30%

I – 10%
II – 30%

* Factory settings in **BOLD**

MAINTENANCE:

1. Clean and maintain the luminaire regularly.
2. When cleaning, use a soft cloth with non-abrasive detergent and wipe dry with a clean soft cloth.
3. Do not use any cleaners that contain alcohol, harsh chemicals or pesticides.
4. When cleaning inside the luminaire, turn off the power, and do not spray liquid cleaner directly on the LEDs, LED driver or wiring.