

MOBILE BASE



APPLICATION

Mobile bases include casters and extend beyond the front and rear of 600- and 800-mm wide modular enclosures to provide enhanced stability.

FEATURES

- The front and rear top surfaces of the base are trimmed with 3-mm thick black rubber mats
- Four non-locking casters provide a maximum load-bearing capacity of 1000 lb. (453.6 kg)

SPECIFICATIONS

- Available as standard product for 600- and 800-mm wide frames
- The base fastens to the underside of the frame and provides integral mounting of furnished casters
- Casters and mounting hardware are furnished
- Exercise care when using casters to move the enclosure
- Avoid tipping and damage to the enclosure and its contents by slowly moving the enclosure on its casters across smooth, flat flooring
- Avoid large cracks, floor displacement, seams, gravel and any other obstruction
- Never use casters while transporting an enclosure by truck on roadways
- Contact Hoffman for more information

FINISH

- Polyester powder paint; RAL 9005 textured black standard
- Custom colors available

ACCESSORIES

Mobile Base Leveling Kit

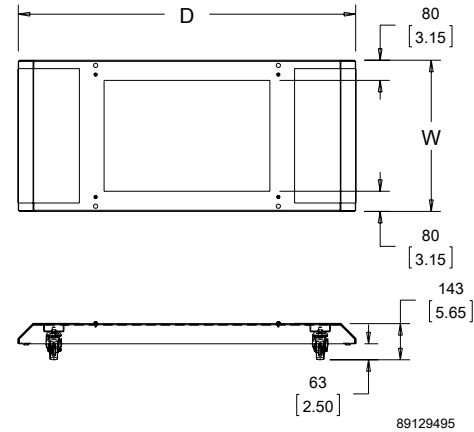

BULLETIN: P40

Standard Product

Catalog Number	W (mm)	W (in.)	D (mm)	D (in.)	Fits Frame WxD (mm)
P2BM64	600	23.6	939	37.0	600 x 400
P2BM65	600	23.6	1039	40.9	600 x 500
P2BM66	600	23.6	1139	44.8	600 x 600
P2BM68	600	23.6	1339	52.7	600 x 800
P2BM84	800	31.5	939	37.0	800 x 400
P2BM85	800	31.5	1039	40.9	800 x 500
P2BM86	800	31.5	1139	44.8	800 x 600
P2BM88	800	31.5	1339	52.7	800 x 800
P2BM810	800	31.5	1539	60.6	800 x 1000

Model	Component	Type	Width	Depth	Catalog Number
P2	B	M	8	6	= P2BM86
PROLINE G2	Base	0 = solid base 0mm 1 = fully sealed plinth P1 = plinth base 100mm P2 = plinth base 200mm GP = gland plate T = transportation base M = mobile base	mm 8 = 800 6 = 600	mm 10 = 1000 8 = 800 6 = 600 5 = 500 4 = 400	

NOTE: Not every combination is available as a standard product.

MOBILE BASE LEVELING KIT



Levelers mount in the outer corners of the Mobile Base, providing load-bearing capacity of 1000 lb. (453.6 kg).

BULLETIN: P20

Catalog Number	Description	Use with
PMBLM12	Mobile Base Leveling Kit	Mobile Base

Notes